

URBAN INFILL THREE BUILDING COMPLEX TOTALING 177,600 SF LOCATED IN MEACHAM/FOSSIL CREEK



## **NORTHEAST POINT**

6400 Wuliger Way, Suite A, North Richland Hills, TX 76180

**12,800 SF AVAILABLE, MINUTES FROM I-820**

1,660 SF OFFICE SPACE - 4,112 SF HVAC AREA - 5,395 SF WAREHOUSE - 1,633 SF MEZZANINE

1 10X10 DOCK HIGH DOOR - 1 12X10 LEVEL DOOR

(Ability to add additional Dock High Door)

FULLY SPRINKLERED - COLUMN SPACING 39'6" X

40'1"



FORREST COOK | [forrest.cook@streamrealty.com](mailto:forrest.cook@streamrealty.com) | 817.877.1310

BRETT CARLTON | [brett.carlton@streamrealty.com](mailto:brett.carlton@streamrealty.com) | 817.502.8128

Managed by:



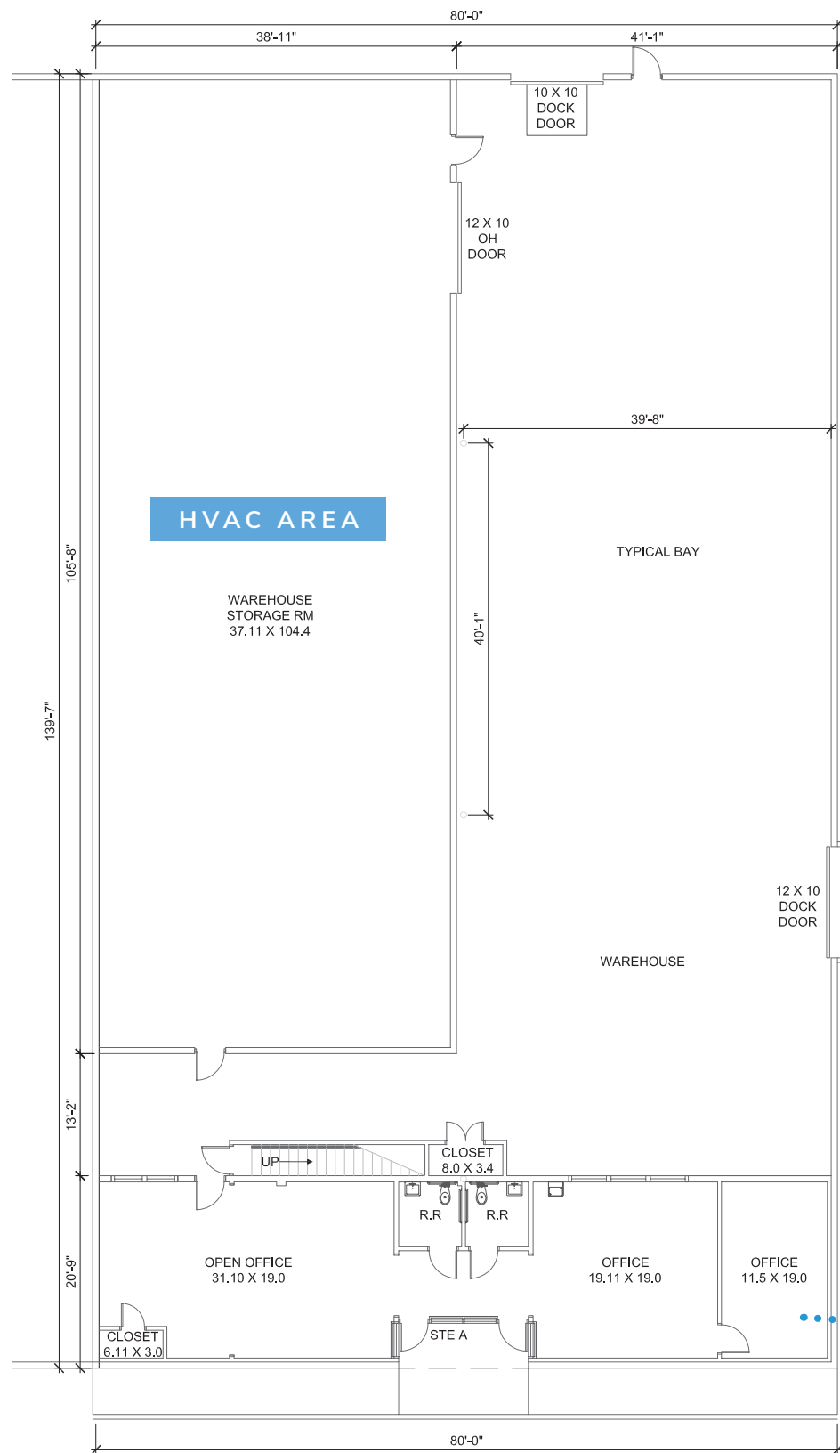

**SUITE A  
12,800 SF**



**MEZZANINE**

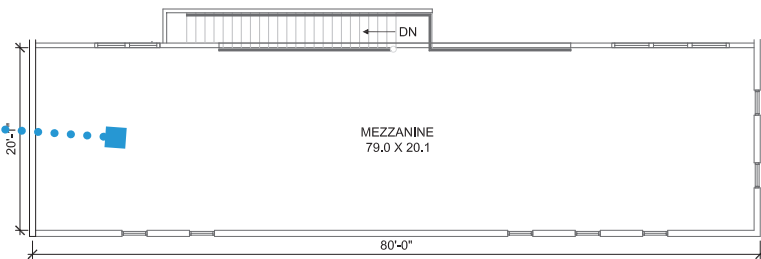

**DETAILS**

- 12,800 SF Available
  - 1,660 SF Office
  - 5,395 SF Warehouse
  - 4,112 SF HVAC Area
  - 1,633 SF Mezzanine
- 1 10x10 Dock High Door
- 1 12x10 Level Door



FORREST COOK | forrest.cook@streamrealty.com | 817.877.1310  
 BRETT CARLTON | brett.carlton@streamrealty.com | 817.502.8128

Managed by:



# 9

Miles to  
Fort Worth CBD

# 26

Miles to  
Dallas CBD

# 12

Miles to DFW  
International Airport

# 7

Miles to Meacham  
International Airport



FORREST COOK | forrest.cook@streamrealty.com | 817.877.1310  
BRETT CARLTON | brett.carlton@streamrealty.com | 817.502.8128

Managed by:

