

NEWMARK

546 Fifth Avenue

N/W/C of Fifth Avenue & West 45th Street



PLUG & PLAY
OPPORTUNITY

For Sublease

Area	Partial 20 th Floor: 2,775 RSF
Rental Rate	Upon Request
Possession	Immediate
Term	2-5 Years

Space Comments

- Full term through June 2030
- Built with 1 conference room, 2 offices, and open area for 12
- Great natural light
- 12' exposed ceilings
- Close proximity to Grand Central Station, Port Authority, Bryant Park and the 1/2/3/4/5/6/7/N/Q/R/W/B/D/F/M Subway Lines
- Furniture can be made Available
- Direct Elevator Presence

PARTIAL 20TH FLOOR: 2,775 RSF

As-Built Floor Plan

RECEPTION	1
OFFICES	2
WORKSTATION	12
CONFERENCE ROOM	1

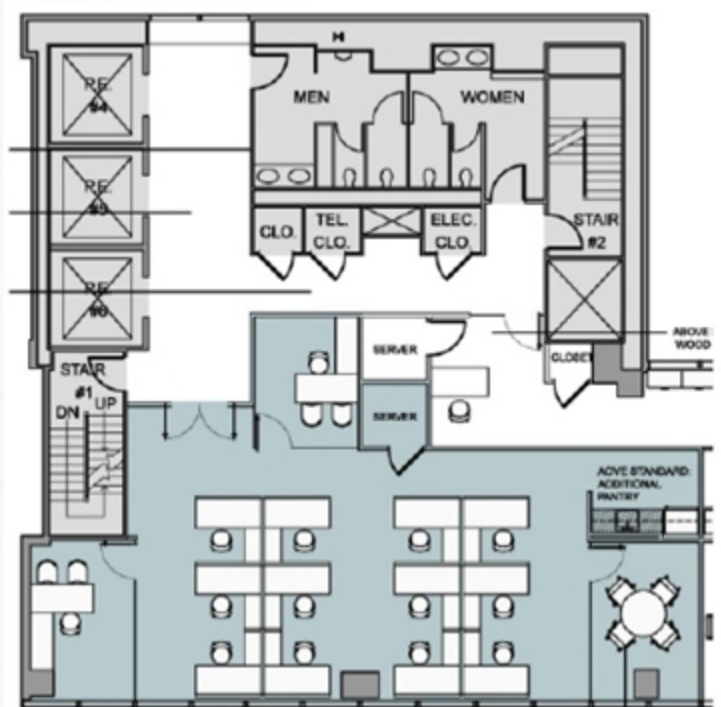

PARTIAL 20TH FLOOR: 2,775 RSF

Space Photos

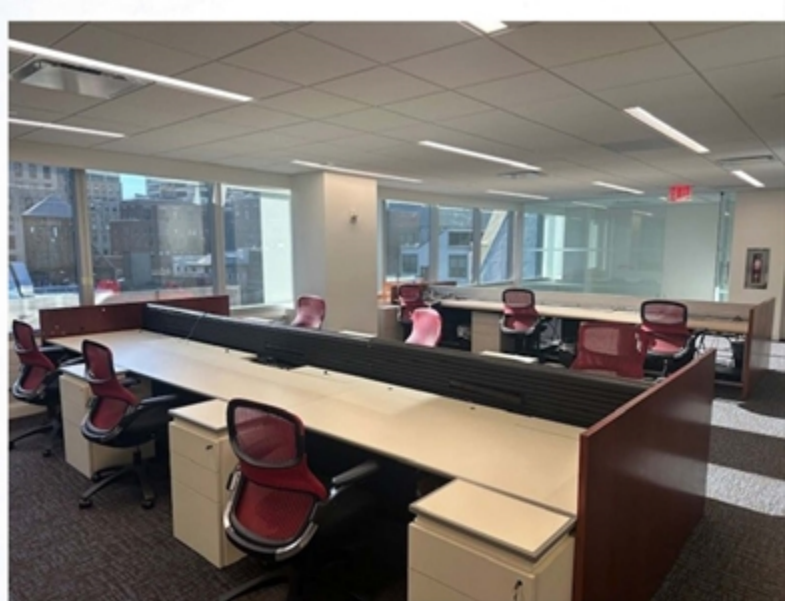

Download PDF

For information, please contact:

Andrew Sachs
Vice Chairman

t 212-372-2451
Andrew.Sachs@nrmk.com

Bill Levitsky
Senior Managing Director

t 212-372-2421
Bill.Levitsky@nrmk.com

Matthew Augarten
Associate Director

t 212-372-2388
Matthew.Augarten@nrmk.com

Harrison Ruff
Associate

t 646-9705698
Harrison.Ruff@nrmk.com

125 Park Avenue
New York, NY 10017
t 212-372-2000

nrmk.com



125 Park Avenue, New York, NY 10017 t 212-372-2000

The information contained herein has been obtained from sources deemed reliable but has not been verified and no guarantee, warranty or representation, either express or implied, is made with respect to such information. Terms of sale or lease and availability are subject to change or withdrawal without notice.

©2025 Newmark. All Rights Reserved.