

2113
E. CESAR CHAVEZ

AUSTIN, TX

EAST AUSTIN
CS-CO-MU-NP

YOUR CO HERE

2113

RENDERING

2113CESARCHAVEZ.COM

DR
DEVORA REALTY

All listing information is deemed reliable but is not guaranteed and should be independently verified.

RENDERING



2113CESARCHAVEZ.COM

DR
DEVORA REALTY

All listing information is deemed reliable but is not guaranteed and should be independently verified

2113 E. CESAR CHAVEZ

Building Specifications

BUILDING SIZE	3,090 rentable square feet of retail space
BUILDING HEIGHT	1 story · 15' building · 8' ceiling · masonry construction (1965)
SITE	0.15 AC / 6,534 SF lot · FAR 0.47 47' frontage on E Cesar Chavez St · 1 curb cut
PARKING	6 dedicated surface spaces · 1.94 / 1,000 SF · corridor walk-up & cycling trade
OUTDOOR	Side yard area available for programmed use (subject to zoning verification)
ZONING	CS-CO-MU-NP · General Commercial Services with Conditional Overlay & Mixed-Use under Neighborhood Plan
ACCESS	Walk 70 · Bike 80 · Drive 100 · Transit 50 · 24-hour access · Cap Metro bus line
OTHER	Exposed wood-joint ceiling structure Single-tenant configuration · masonry shell Flood zone B & X · not in SFHA Immediate availability · as-is delivery

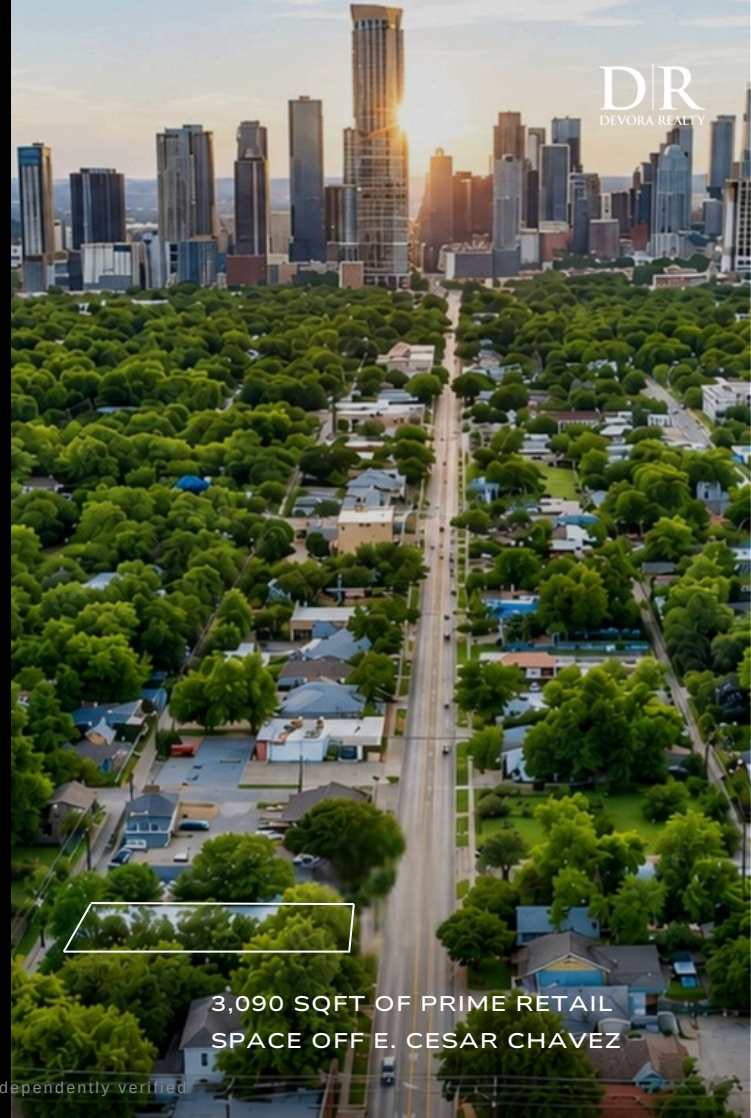

3,090 SQFT OF PRIME RETAIL
SPACE OFF E. CESAR CHAVEZ

Floorplan

2113 E Cesar Chavez St – 3,090 SF Single-Story Mixed-Use Space

Building Dimensions: Approximately 47' wide x 66' deep (single-story footprint)

The building features a flexible, open layout and can be demised into two independent $\pm 1,545$ SF units with shared restroom facilities, or leased as a single full-building tenant.

Near white-box condition allows for complete tenant buildout and customization.

Current condition: Near white-box, in-line position on major thoroughfare, 1.94 spaces/1,000 SF parking (6 surface spaces).

All listing information is deemed reliable but is not guaranteed and should be independently verified

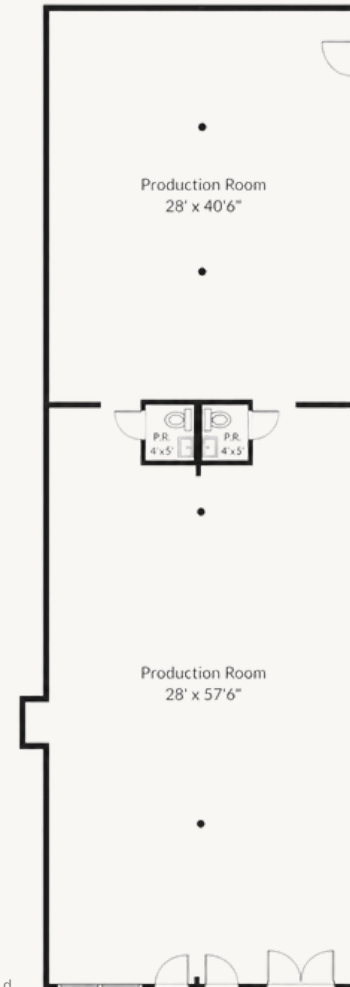

Business Key Facts

2113 E Cesar Chavez St, Austin, Texas, 78702

Drive time: 1, 3, 5 minute radii



Key Statistics

1 minute

240

Total Businesses

1,303

Total Employees

\$207M

5.3%

Unemployment Rate

11

100 or More Employees

Largest Businesses in Area

25*

\$10M+ Annual Sales Vol

Most Employees

Oracle Corporation

Headquarters

8,000

Highest sales volume

Texas Fleet Fuel

Independent

\$246M

Daytime Population

1 minute



1,347

Total Population



Urban Core
Dominant Urbanicity Type

1 minute



2,155

Total Daytime Population

Ratio of daytime to total population:

1.60

Values >1.0 mean that more

people come to the area during the day than live there.



6.0

Avg Number of Employees



1,055

Total Businesses Per Square Mile

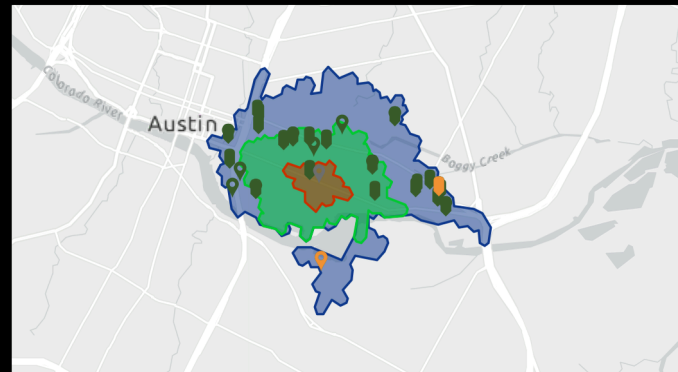

Source: This infographic contains data provided by Esri-Data Axle (2025), Esri (2025). Note: business sales volumes and employee counts are estimates provided by Data Axle. * Indicates the number of locations has reached the maximum.

Business Key Facts

2113 E Cesar Chavez St, Austin, Texas, 78702

Drive time: 1, 3, 5 minute radii



About the Workforce

1 minute



9.3%



6.9%

Trades/Skilled Labor



83.6%

Office Based

Top 3 segments by household count



D2 Trendsetters > 500 |87.3%

D5 Laptops and Lattes > 38 |6.6%

D4 Metro Renters > 35 |6.1%

Other 0 |0.0%

[View comparison table](#)

About the Community

1 minute



-0.8% ↓

Pop Growth Rate is 266.7% lower than United States



86

Wealth Index
Below 100 =lowAbove 100 =high



0.7% ↓

Housing Units Growth Rate is 20% lower than United States.

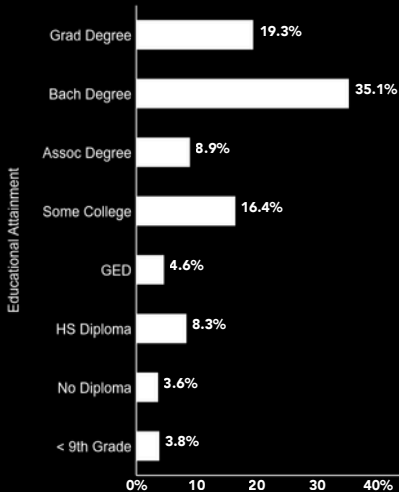

Businesses Per 1,000 Population

Business Categories	1 minute	3 minutes	5 minutes	ZIP Codes 78702 (Austin)	States Texas	United States of America United States
Restaurants	22.27	11.74	9.82	9.07	2.58	2.45
Health Care & Social Assistance	2.97	3.84	3.20	3.38	3.34	3.76
Retail	12.62	8.31	6.03	6.21	4.43	4.60
Manufacturing	5.20	3.01	2.23	2.42	1.13	1.32
Finance & Insurance	6.68	3.43	2.53	2.11	1.87	1.80
Professional & Tech Services	17.82	11.84	9.99	8.90	3.33	3.60

Source: This infographic contains data provided by Esri-Data Axle (2025), Esri (2025). Note: business sales volumes and employee counts are estimates provided by Data Axle. * Indicates the number of locations has reached the maximum.



Contact Information

JOHNNY DEVORA, CCIM
DEVORA REALTY, LLC
512.961.9084
johnnydevora@devorarealty.com
www.devorarealty.com

ADAM CADENHEAD, REALTOR®
DEVORA REALTY, LLC
512.277.9314
adamc@devorarealty.com

**FOR QUESTIONS OR
TO SCHEDULE A TOUR**