

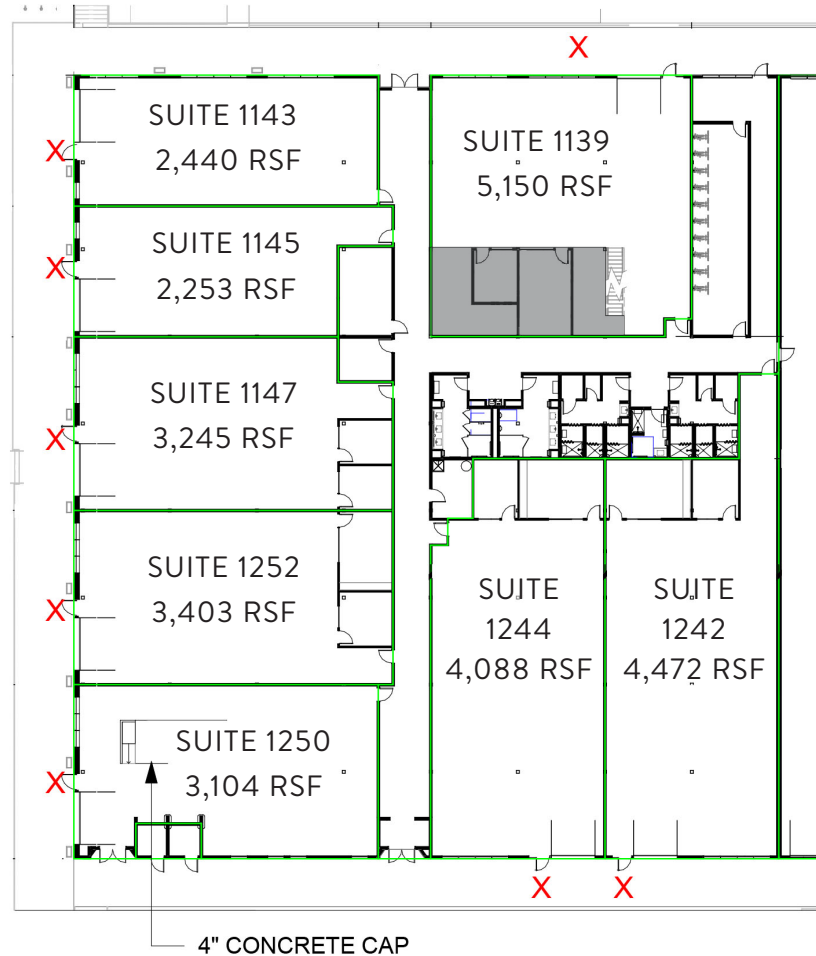

# 3875 N STEELE ST



■ = MEZZANINE

X = TENANT PRIMARY ENTRANCE

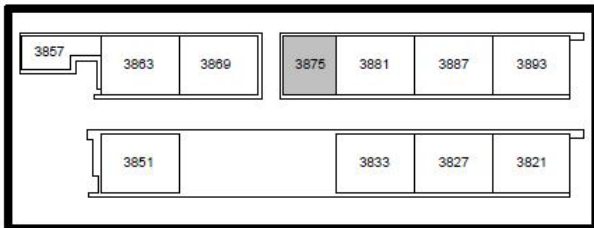

**For Leasing Information, Contact:**

**ANDREW PIEPGRAS**  
 Vice President  
 303.226.8209  
 APiepgras@LPC.com

**MARK DWYER**  
 Vice President  
 303.226.8212  
 MDwyer@LPC.com

