

# For Lease

## Regent O'Hare Business Center

901-951 Cambridge Drive, Elk Grove Village, IL

8,193 SF / Unit 925

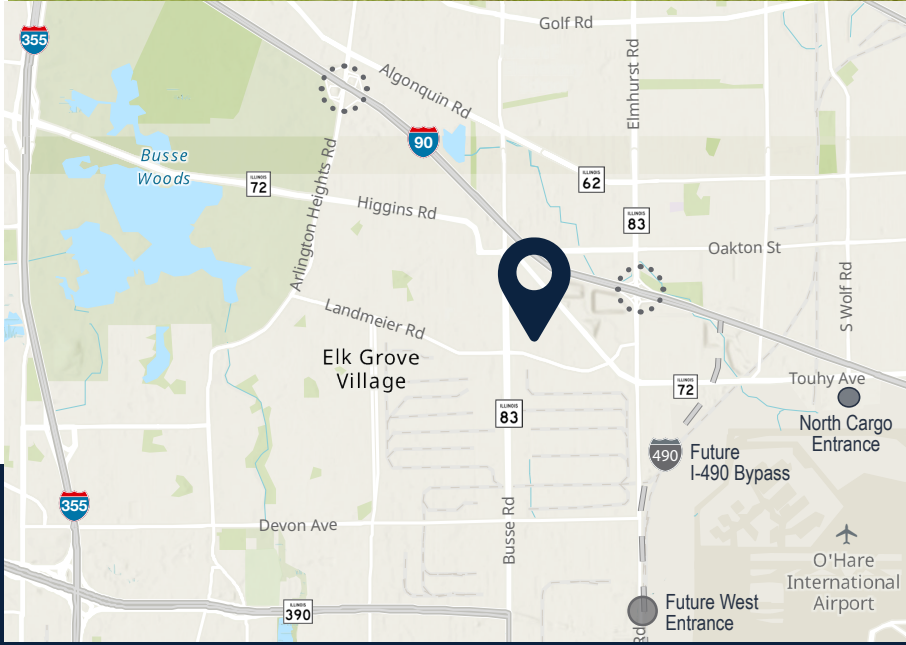

Available	8,193 SF
Loading	2 drive-in doors
Ceiling Height	18'
Office Area	±1,597 SF
Power	200 amps @ 480 volts
Car Parking	2.54 / 1,000 SF
Building SF	29,509 SF

**TERRY  
HERLIHY**

EXECUTIVE VICE PRESIDENT  
therlihy@hiffman.com  
630.693.0664



No warranty or representation, expressed or implied, is made as to the accuracy of the information contained herein, and same is submitted subject to error and omissions.

## Regent O'Hare Business Center

901-951 Cambridge Drive, Elk Grove Village, IL

8,193 SF / Unit 925

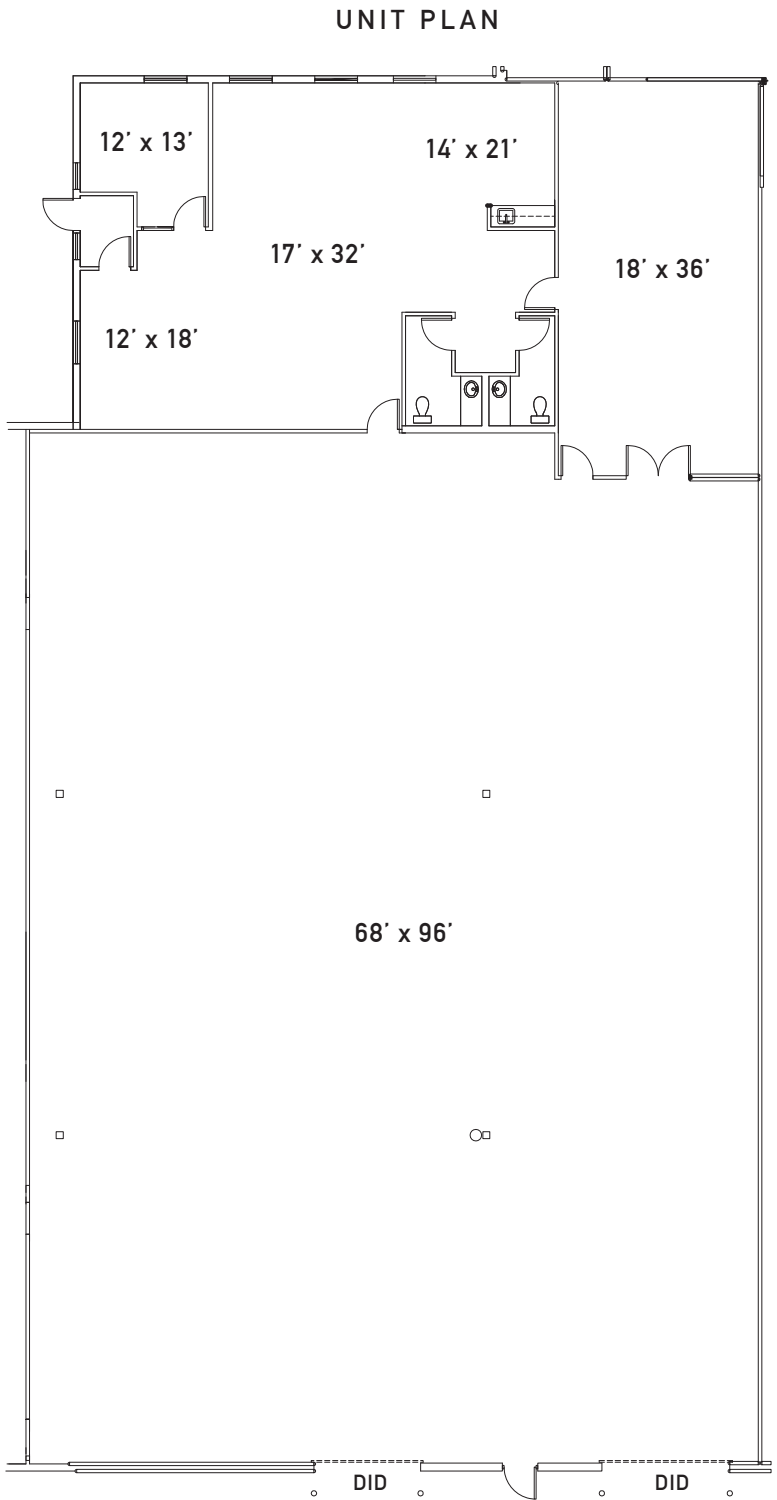
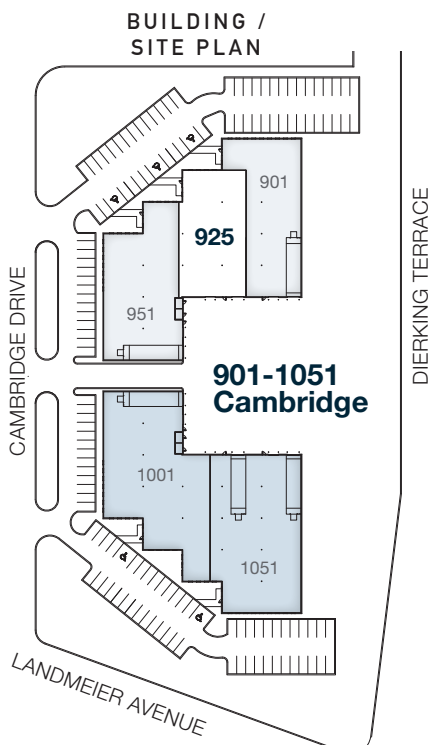

### HIGHLIGHTS

- High image property
- Institutional ownership & management

### LOCATION

- Nearby public transportation
- Near north cargo entrance and future west entrance to O'Hare Airport
- Minutes from 4-way interchange at I-90 & Elmhurst Road

No warranty or representation, expressed or implied, is made as to the accuracy of the information contained herein, and same is submitted subject to error and omissions.