



## Retail space available in prime Summerville location

- End-cap retail space for lease
- Ample surface parking available
- Located adjacent to Sawmill Village, which includes Harris Teeter, Dollar Tree, 7 Brew Coffee, and more
- Surrounded by strong demographics showing over 9% growth over the next several years
- Prime location at the intersections of Old Trolley Road, Bacons Bridge Road, and Berlin G. Parkway Extension

### Get more information

**Gregg Legerton**

Vice President

843 973 8354

[gregg.legerton@avisonyoung.com](mailto:gregg.legerton@avisonyoung.com)

# Property overview

## Property specs

Address	710 Bacons Bridge Road Summerville, SC
TMS	1450606002000
County	Dorchester
Zoning	GB - General Business
Year built	1990
Total building size	±10,064 sf
Lease type	Modified Gross*

\*Tenant pays electricity



# Floorplan

## Availabilities

Suite	Size	Lease rate	Available
D	±1,784 sf	\$30/sf/year	Now
E	±1,976 sf	\$30/sf/year	Now
D + E (Contiguous)	±3,760 sf	\$30/sf/year	Now

## Floorplan

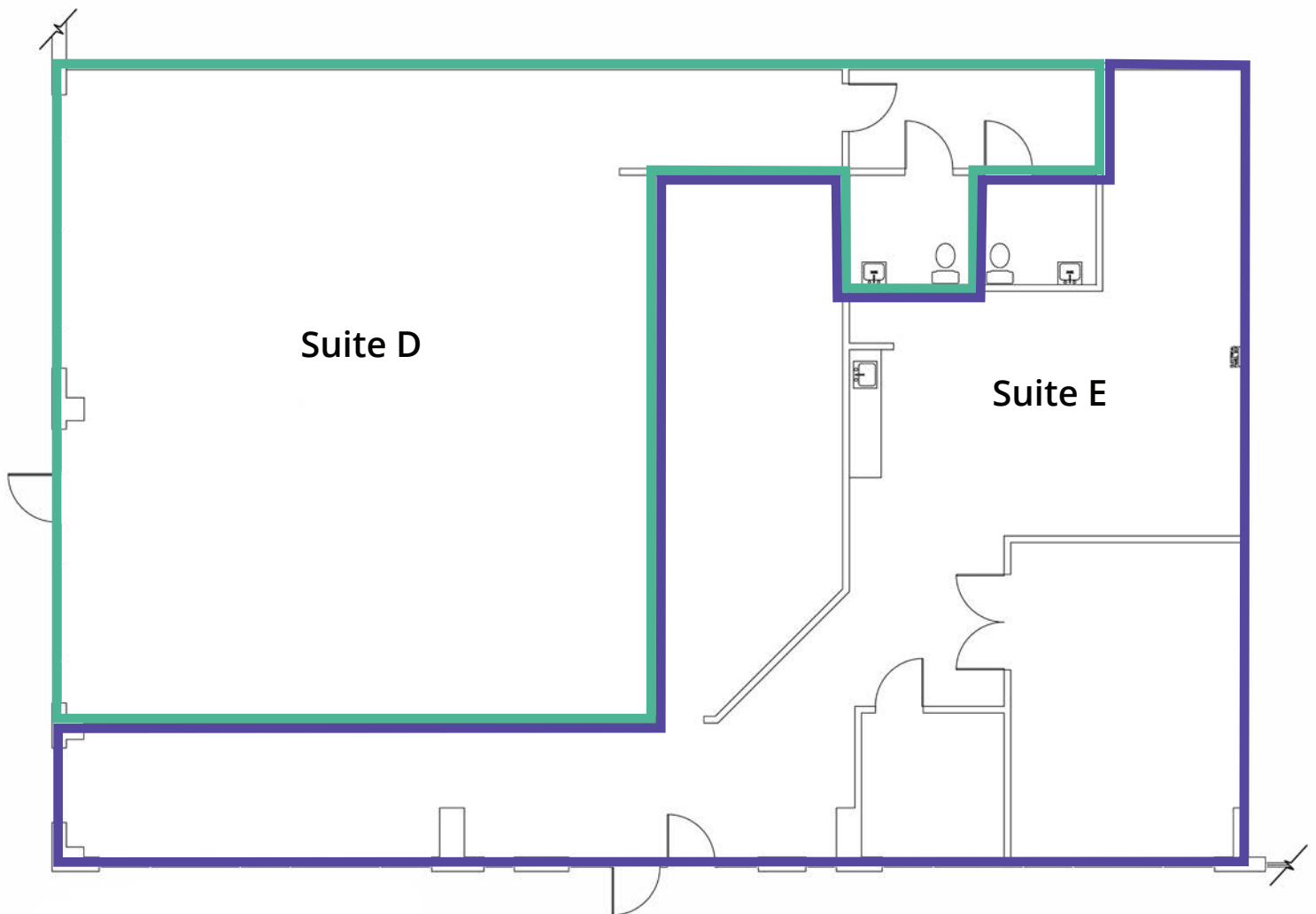

# Location

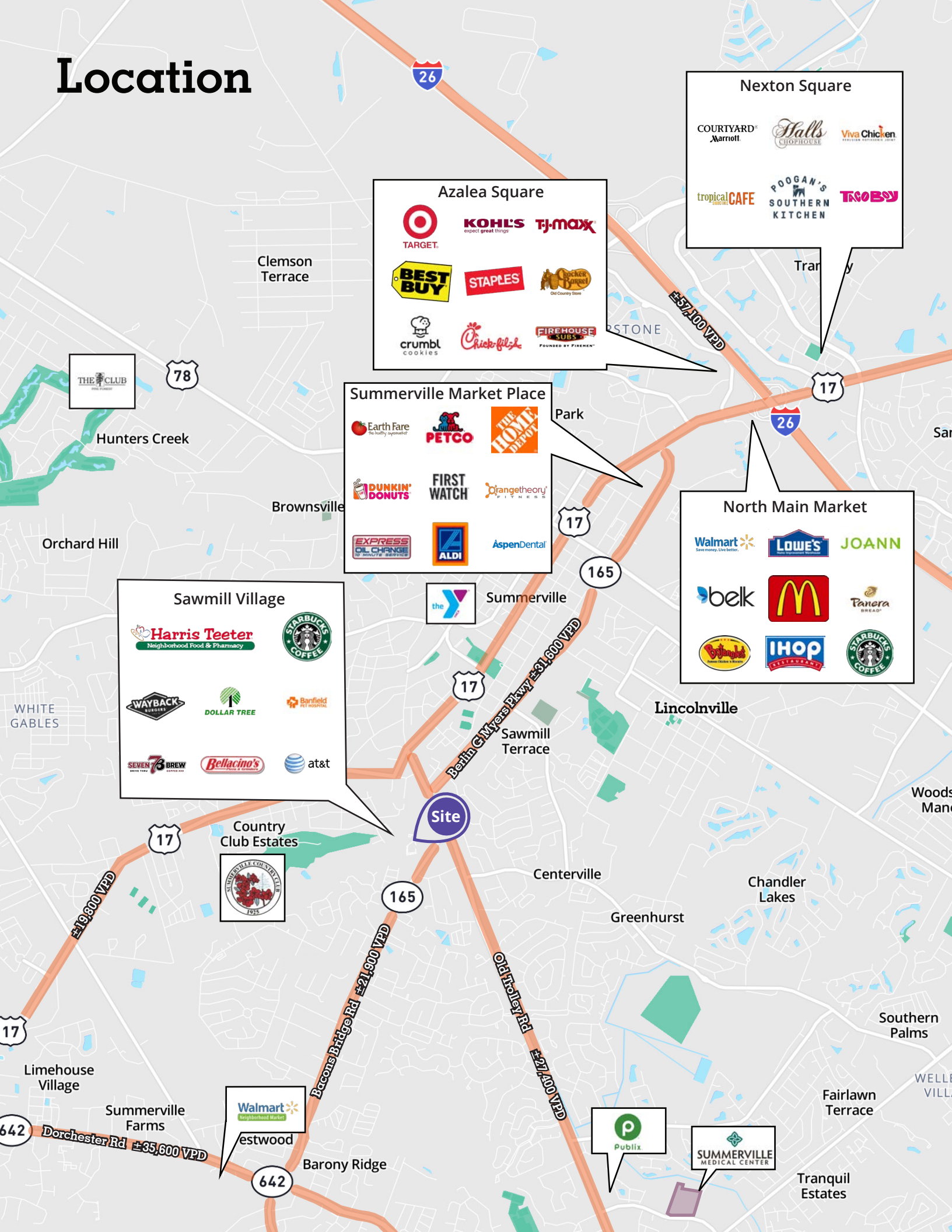

78

Hunters Creek

Orchard Hill

WHITE GABLES

**Sawmill Village**

17



Country Club Estates



Site

165

Beacons Bridge Rd ±21,900 VPD

642

Dorchester Rd ±35,600 VPD



Westwood

Barony Ridge

Summerville



the Y

Summerville

17

165

Berlin Gwyners Pkwy ±31,800 VPD

Sawmill Terrace

Centerville

Greenhurst

Chandler Lakes

Southern Palms

Fairlawn Terrace

Tranquil Estates



Publix



SUMMERVILLE MEDICAL CENTER

**Nexton Square**

**Azalea Square**

**Summerville Market Place**

**North Main Market**

# Demographics - 5 mile

710 Bacons Bridge Rd

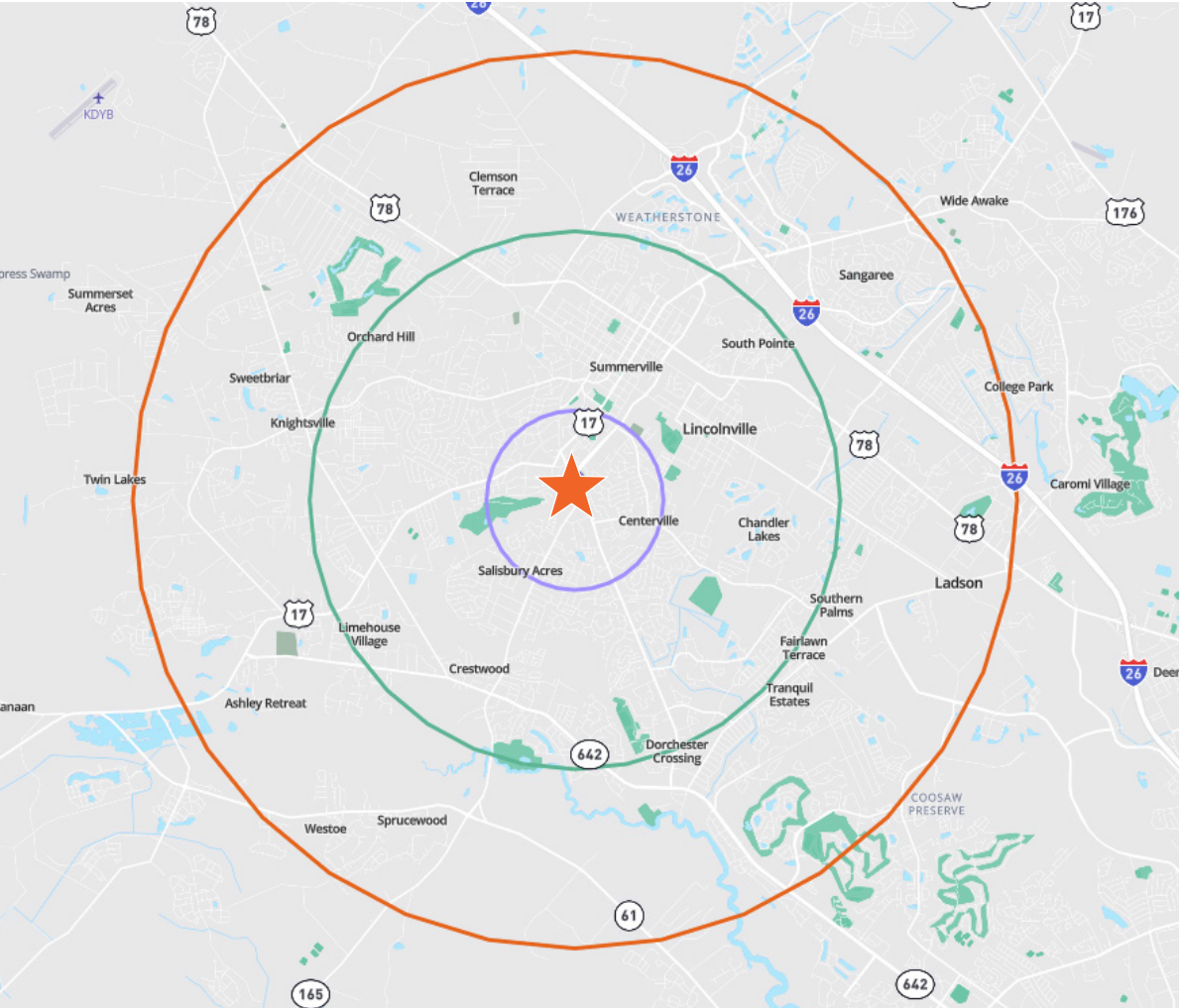

**145,627**  
POPULATION



**55,516**  
HOUSEHOLDS



**\$100,729**  
AVERAGE HH INCOME

## Get more information

**Gregg Legerton**

Vice President

843 973 8354

[gregg.legerton@avisonyoung.com](mailto:gregg.legerton@avisonyoung.com)