

**CBRE**

**150**  **VIA RENZO DRIVE  
RICHMOND HILL, ON**

---

Office Space **For Sub-lease**



## Property Details

### Available Options

1st + 2nd Floor Office  
**15,000 Sq. Ft.**

2nd Floor Office  
**9,000 Sq. Ft.**

Asking Rate  
**\$11.95 per sq. ft. net**  
*(Year 1 Rate Only)*

TMI  
**\$5.33 per sq. ft.**

Possession  
**Immediate**

Sublease Expiry  
**December 31, 2030**

Zoning  
**M1**



Furniture Available  
For Additional Cost



Immediate Access  
To Highway 404



Professionally  
Managed Facility Less  
Than 5 Years Old



Abundant Of Surface  
Level Parking



Elevator  
Access



Excellent Street  
Front Exposure

# Floor Plan

## 2nd Floor

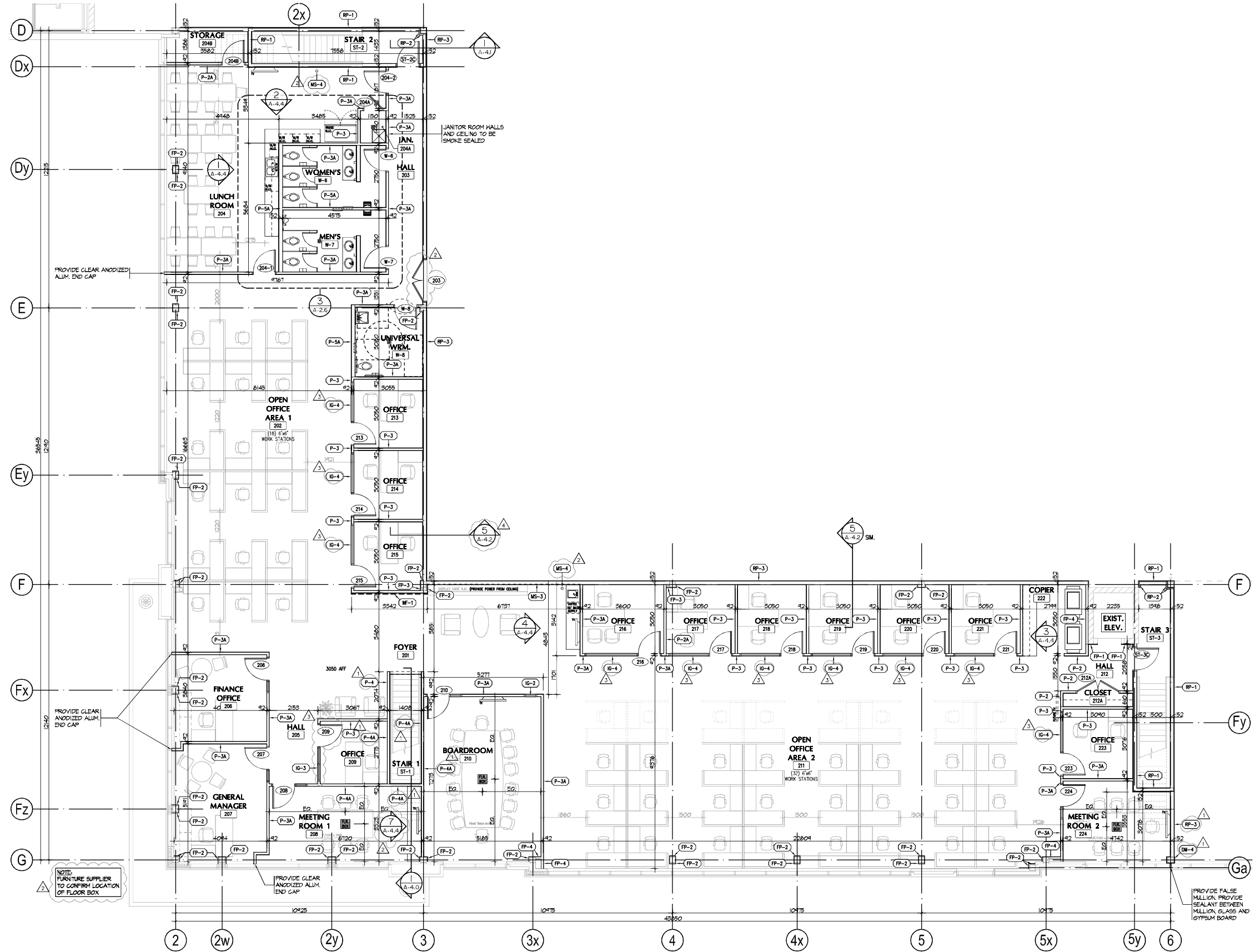

# Interior Photos



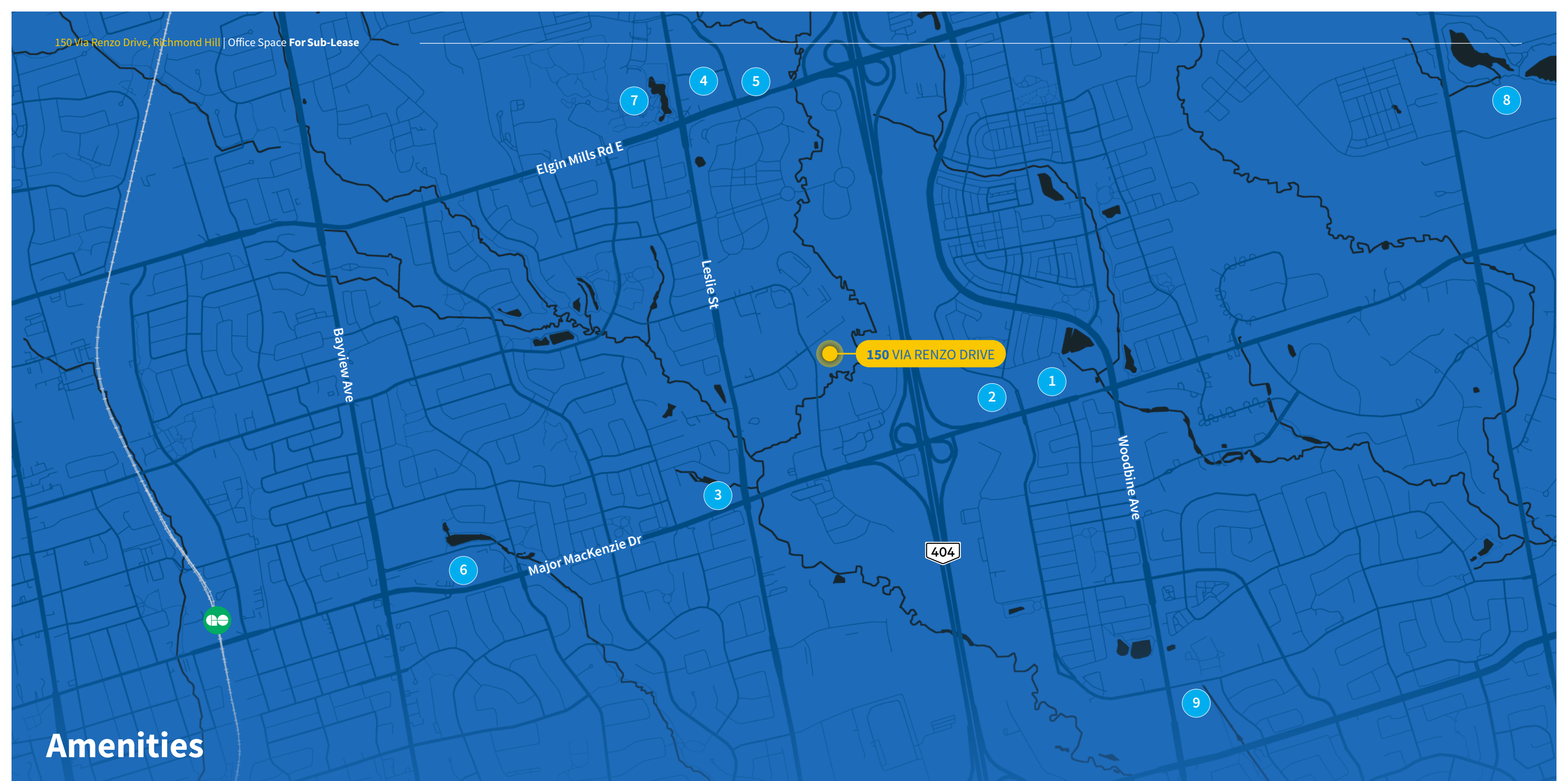

## Amenities

- 1** Canadian Tire  
Shoppers Drug Mart  
Starbucks  
Harvey's
- 2** CIBC Bank  
BMO

- 3** FreshCo  
LCBO  
RBC Royal Bank  
Tim Hortons  
Aberdeen Market  
Burger Factory

- 4** The Home Depot  
Pi Co. Pizza Bar  
Scotiabank  
Paris Baguette  
Congee House  
TD Canada Trust

- 5** Costco Wholesale  
PetSmart  
Staples  
KV Golf

- 6** Walmart  
Food Basics  
KFC  
Wendy's

- 7** Richmond Green Park
- 8** Angus Glen Golf Club

- 9** Sport Chek  
T&T Supermarket  
Tim Hortons  
Hana Don Japanese  
Cuisine & Bar



Richmond Hill GO

# 150 > VIA RENZO DRIVE RICHMOND HILL, ON

---

## Office Space For Sub-lease

### Contact Us

**Robert Ironside\***

Senior Vice President

+ 1 416 495 6260

[robert.ironside@cbre.com](mailto:robert.ironside@cbre.com)

**Craig Williamson\*\* MBA**

Senior Vice President

+ 1 416 495 6267

[craig.williamson@cbre.com](mailto:craig.williamson@cbre.com)

\*Sales Representative \*\*Broker | All Outlines Are Approximate | CBRE Limited, Brokerage | 2005 Sheppard Ave E., Suite 800, Toronto ON M2J 5B4

This disclaimer shall apply to CBRE Limited, Real Estate Brokerage, and to all other divisions of the Corporation; to include all employees and independent contractors ("CBRE"). The information set out herein, including, without limitation, any projections, images, opinions, assumptions and estimates obtained from third parties (the "Information") has not been verified by CBRE, and CBRE does not represent, warrant or guarantee the accuracy, correctness and completeness of the Information. CBRE does not accept or assume any responsibility or liability, direct or consequential, for the Information or the recipient's reliance upon the Information. The recipient of the Information should take such steps as the recipient may deem necessary to verify the Information prior to placing any reliance upon the Information. The Information may change and any property described in the Information may be withdrawn from the market at any time without notice or obligation to the recipient from CBRE. CBRE and the CBRE logo are the service marks of CBRE Limited and/or its affiliated or related companies in other countries. All other marks displayed on this document are the property of their respective owners. All Rights Reserved. Mapping Sources: Canadian Mapping Services [canadamapping@cbre.com](mailto:canadamapping@cbre.com); MapPoint, DMTI Spatial, EnviroNics Analytics, Microsoft Bing, Google Earth