

**FOR
SUBLEASE**



21,831 SF

9900
King
George
Blvd
SURREY, BC

King George Hub – Surrey City Centre



Premium Office. Prime Location. Endless Amenities.

CBRE Limited is pleased to offer a unique opportunity to sublease approximately 21,831 SF of fully built-out office space on the 5th floor of 9900 King George Boulevard (King George Hub), Surrey.

This landmark nine-storey, Class AAA mixed-use office tower, developed in 2015, offers a rare combination of high-quality finishes and strategic location—featuring secure access, efficient HVAC with zoned fan coils, tinted low-E windows with solar reflective shades, and 10' ceiling heights.

PROPERTY DETAILS

AVAILABLE AREA
21,831 SF

NET RENT
Contact Listing Agents

OPT. COST & TAXES
\$21.23 PSF per annum (2026 est.)

AVAILABILITY
Immediate

EXPIRY
November 29, 2030

PARKING
2 Stalls per 1,000 SF
at market rate

SPACE FEATURES

- + Fully Improved, Furnished and Wired office Space - Ready For Occupancy
- + Secure access
- + Efficient HVAC with zoned fan coils
- + Tinted low-E windows with solar reflective shades
- + 10' ceiling heights.



AAA OFFICE BUILDING

- + LEED Gold Standard
- + Building security system in place with card accessibility



HEALTH AND FITNESS

- + Fitness facilities
- + Bike storage
- + End-of-trip facilities



ON SITE DAYCARE

- + Kids & Company on site daycare



CONNECTIVITY

- + Directly adjacent to the King George SkyTrain Station



ON SITE RETAIL

- + 100,000 SF on site retail including Tim Horton's, Chopped Leaf, A&W, Starbucks, Coast Capital Savings, Fresh Slice, and Pita Pit, Rexall, and Save-on-Foods

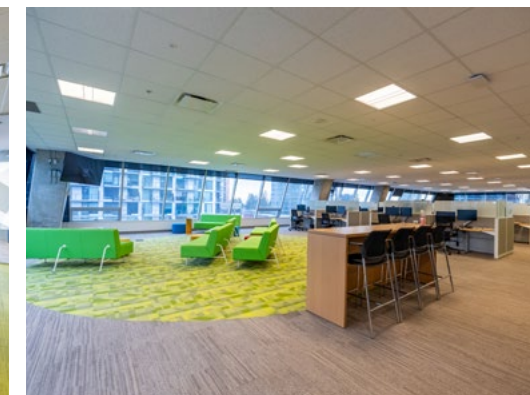

9900
King
George
Blvd

**OFFICE FOR
SUBLEASE**

Level 5

*As Built Floor Plan

21,831 SF

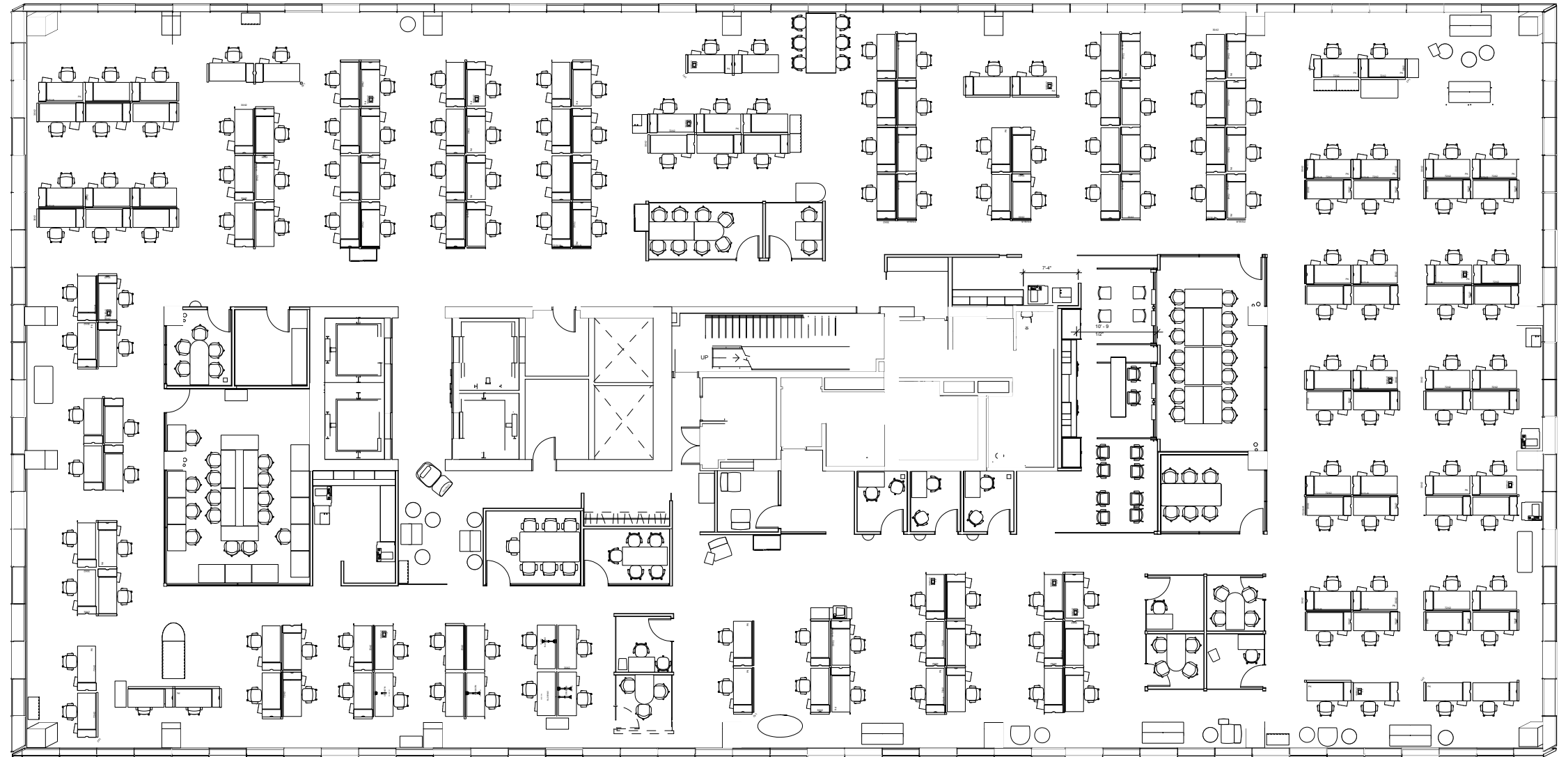

Not To Scale

*Floor plan should not be relied upon for accuracy.
All dimensions and details must be verified on site.





NEARBY AMENITIES (5 KM RADIUS)

- 34+ Cafes
- 145+ Restaurants & Bars
- 146+ Retail & Services

WALK SCORE

- 86 Walker's Paradise
- 89 Rider's Paradise
- 79 Biker's Paradise

Prime Location

Situated in the heart of Surrey City Centre, 9900 King George Boulevard offers immediate access to a vibrant and rapidly growing urban core. The property is surrounded by an abundance of amenities including retail, dining, fitness facilities, and essential services. Key landmarks such as Surrey City Hall, Holland Park, and Simon Fraser University's Surrey campus are all within walking distance, creating a dynamic environment for businesses and employees alike. Its strategic position along King George Boulevard ensures excellent visibility and connectivity to major thoroughfares, making it an ideal location for professional operations.

LUKE GIBSON

Personal Real Estate Corporation
 Senior Vice President
 Office Properties - Tenant Advisory Group
 +1 604 338 5919
 luke.gibson@cbre.com

MARCUS KEIGHRON

Personal Real Estate Corporation
 Senior Vice President
 Office Properties - Tenant Advisory Group
 +1 604 662 5143
 marcus.keighron@cbre.com



cbre.ca

This disclaimer shall apply to CBRE Limited, Real Estate Brokerage, and to all other divisions of the Corporation; to include all employees and independent contractors ("CBRE"). The information set out herein, including, without limitation, any projections, images, opinions, assumptions and estimates obtained from third parties (the "Information") has not been verified by CBRE, and CBRE does not represent, warrant or guarantee the accuracy, correctness and completeness of the Information. CBRE does not accept or assume any responsibility or liability, direct or consequential, for the Information or the recipient's reliance upon the Information. The recipient of the Information should take such steps as the recipient may deem necessary to verify the Information prior to placing any reliance upon the Information. The Information may change and any property described in the Information may be withdrawn from the market at any time without notice or obligation to the recipient from CBRE. CBRE and the CBRE logo are the service marks of CBRE Limited and/or its affiliated or related companies in other countries. All other marks displayed on this document are the property of their respective owners. All Rights Reserved.

Mapping Sources: Canadian Mapping Services canadamapping@cbre.com; DMTI Spatial, EnviroNics Analytics, Microsoft Bing, Google Earth.