

| AREA TABULATIONS: | | | |
|--|-----------------------------|--------|-----------|
| ACTUAL | SPACE | FACTOR | ADJ. SF |
| 12,048 SF | Gross First Floor | 1.0 | 12,048 SF |
| Total Gross SF of Building = | | | 12,048 SF |
| ■ | Tenant Suite Lease Space A | 1.0 | 1,478 SF |
| ■ | Tenant Suite Lease Space B | 1.0 | 1,611 SF |
| ■ | Tenant Suite Lease Space C | 1.0 | 2,063 SF |
| ■ | Tenant Suite Lease Space D | 1.0 | 2,051 SF |
| ■ | Tenant Suite Lease Space E | 1.0 | 1,658 SF |
| ■ | Tenant Suite Lease Space F | 1.0 | 3,009 SF |
| ■ | Men's and Women's Restrooms | 1.0 | 179 SF |

REVISED SF DATA: 10/17/2024

AIA RIBA
Royal Institute of British Architects

ARCHITECTURE +
Charleston + Kiawah Island + West Indies

1044 E. Montague, Ste. 201, N. Charleston, SC, 29492
Tel. N° 1-(843) 566-7881, Tm
Tel. N° 1-(843) 566-7881, Kelm
www.architecturplus.com

Firm Seal:

STATE OF SOUTH CAROLINA
ARCHITECTURE PLUS SC LLC
Charleston, SC
No. 100784
REGISTERED ARCHITECTS

Seal:

STATE OF SOUTH CAROLINA
CHARLES W. BERRY
CHARLESTON, S.C.
04243
REGISTERED ARCHITECTS

UPTOWN
CARNES CROSSROADS

Promenade Phase 2, Building 8
Carnes Crossroads
Berkeley County
Goose Creek, South Carolina

Copyright:
ALL DESIGNS AND SPECIFICATIONS DEPICTED ON THIS SHEET ARE THE PROPERTY OF ARCHITECTURE PLUS SC LLC. ANY UNAUTHORIZED USE OR REPRODUCTION IS SUBJECT TO LEGAL PROSECUTION. POSSESSION IN ANY FORM CONSTITUTES ACCEPTANCE OF THESE CONDITIONS.

Please consider the environment before printing this sheet

- Project Progression:
- Conceptual Design
 - Preliminary Review
 - Design Dev./Bidding
 - Final Review
 - Permitting
 - Construction

Developer:

URBAN CORE
ADVISORS

Sheet Title:
FLOOR PLAN

Sheet N°:
A-1.1

Project N°: 230804 03/15/2024

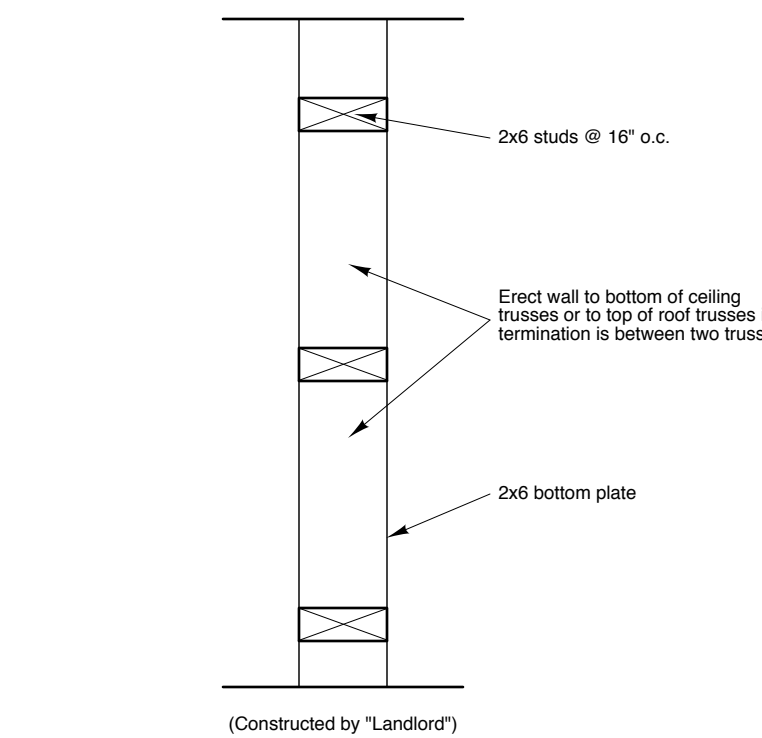

1
A-1.1 INT. DEMISING WALL PARTITION

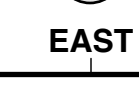
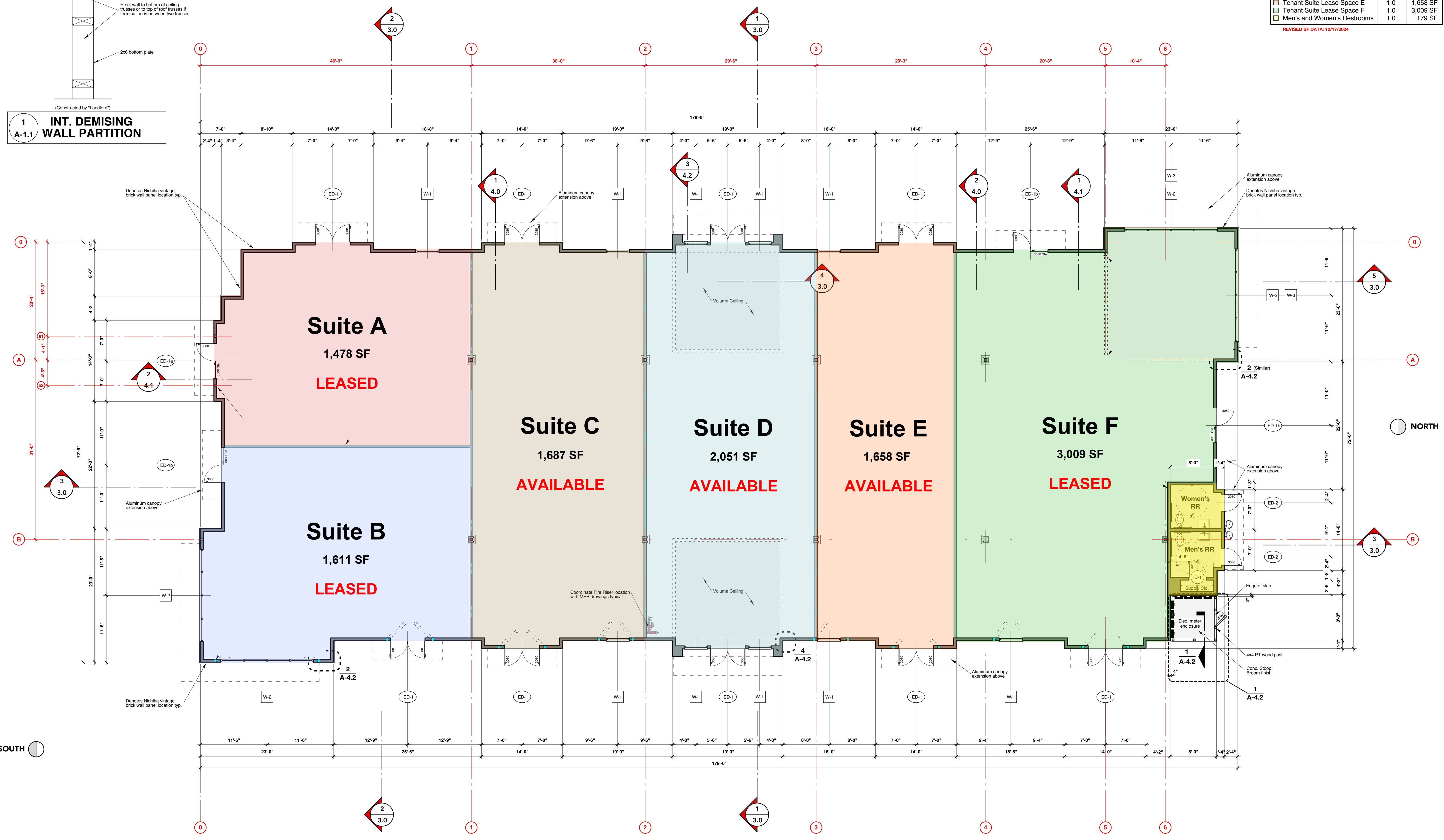

N FLOOR PLAN
BLDG. 8

Scale: 1/8" = 1'-0"

Graphic Scale: 1/8" = 1'-0"

REVISED 05/06/24
CONST. SET
03/29/2024