

**EASY I-15 ACCESS AT
7200 SOUTH AND 9000 SOUTH**



FOR LEASE: UNIT 140

9,240 SF (INCLUDES 1,600 SF OFFICE)

**8385 SOUTH ALLEN STREET
SANDY, UTAH**

KYLE MCMULLIN
Senior Director
+1 801 303 5480
kyle.mcmullin@cushwake.com



8385 SOUTH ALLEN STREET SANDY, UTAH



UNIT SIZES ARE APPROXIMATE

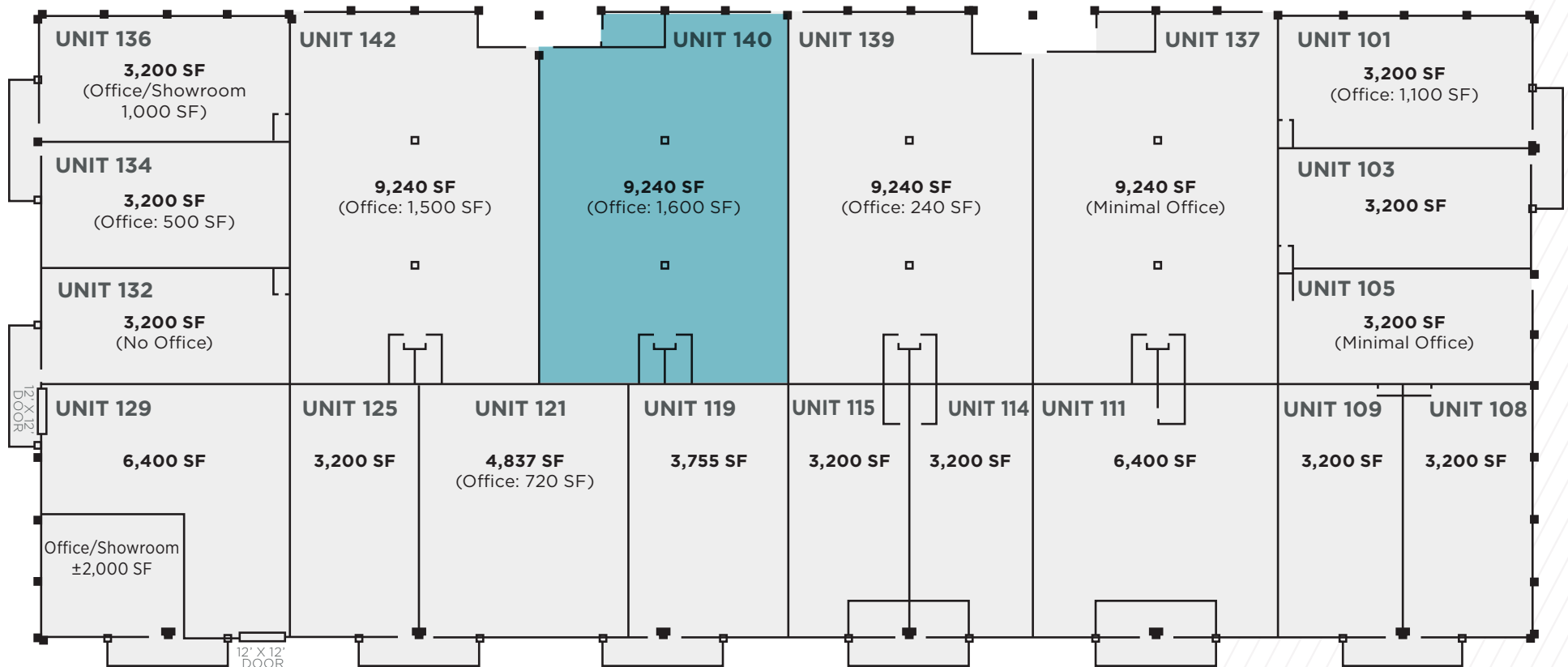

UNIT 140

- Area: 9,240 SF (Includes 1,600 SF office area)
- Lease Rate: \$10,164/Mo (\$1.10 PSF/Mo)
- CAM: \$1,570 (\$0.17/SF/Mo)
- Occupancy: October 31, 2026
- Zone: CR-PUD
- Power: 3 phase 120/480 volts
- Ceiling: 16'
- Dock high 10' by 10' overhead door
- Fire sprinklered (wet)
- Easy access to 90th South I-15 exit



KYLE MCMULLIN
Senior Director
+1 801 303 5480
kyle.mcmullin@cushwake.com



8385 SOUTH ALLEN STREET SANDY, UTAH

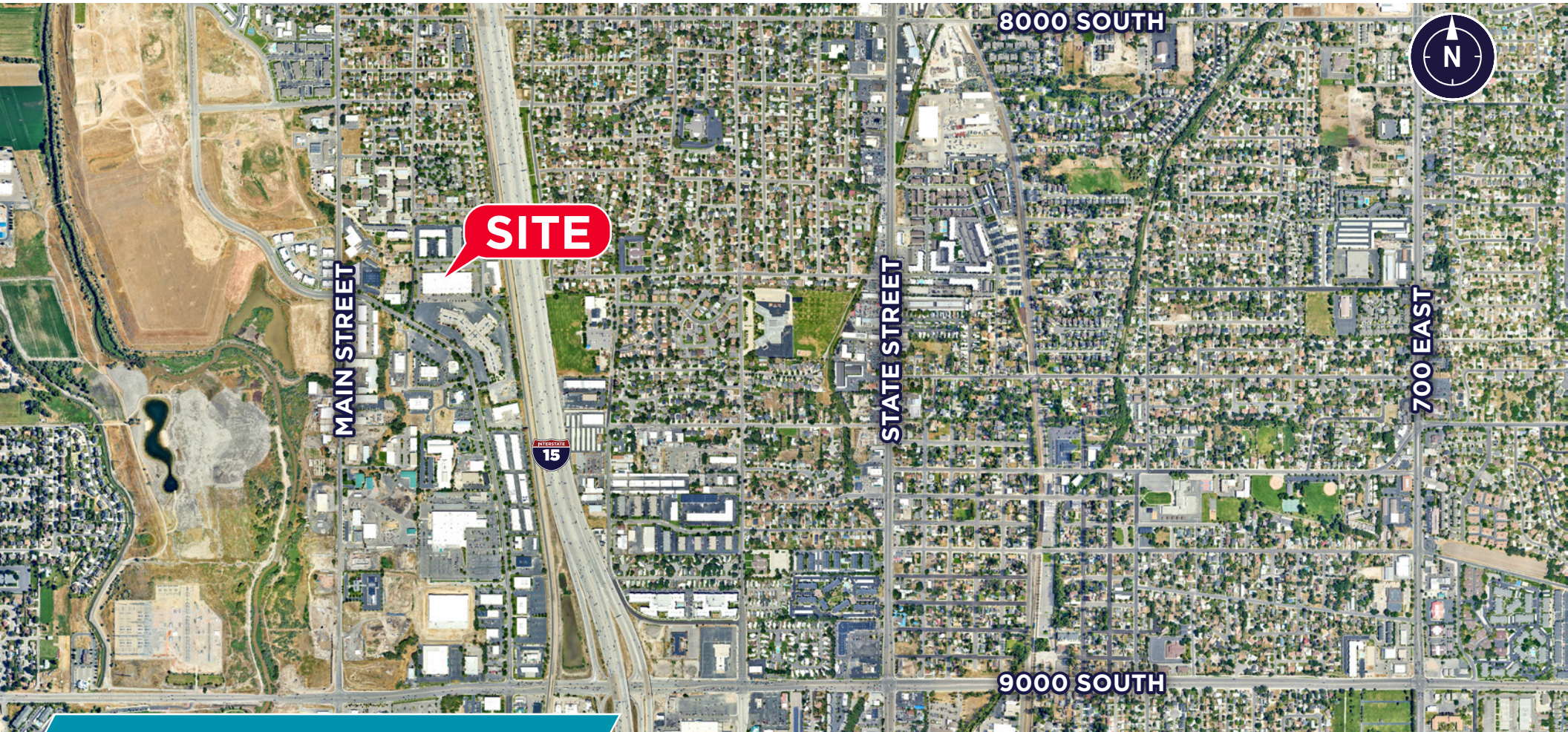

FOR MORE INFORMATION, CONTACT:

KYLE MCMULLIN
Senior Director
+1 801 303 5480
kyle.mcmullin@cushwake.com

170 South Main Street, Suite 1600
Salt Lake City, UT 84101
+1 801 322 2000
cushmanwakefield.com

©2026 Cushman & Wakefield. All rights reserved. The information contained in this communication is strictly confidential. This information has been obtained from sources believed to be reliable but has not been verified. NO WARRANTY OR REPRESENTATION, EXPRESS OR IMPLIED, IS MADE AS TO THE CONDITION OF THE PROPERTY (OR PROPERTIES) REFERENCED HEREIN OR AS TO THE ACCURACY OR COMPLETENESS OF THE INFORMATION CONTAINED HEREIN, AND SAME IS SUBMITTED SUBJECT TO ERRORS, OMISSIONS, CHANGE OF PRICE, RENTAL OR OTHER CONDITIONS, WITHDRAWAL WITHOUT NOTICE, AND TO ANY SPECIAL LISTING CONDITIONS IMPOSED BY THE PROPERTY OWNER(S). ANY PROJECTIONS, OPINIONS OR ESTIMATES ARE SUBJECT TO UNCERTAINTY AND DO NOT SIGNIFY CURRENT OR FUTURE PROPERTY PERFORMANCE.

