

**Now  
Leasing**

Executive Office Space Available at  
**The Professional Center**  
2900 S. State Street, Suites 3E, 4W & 5  
St. Joseph, MI

**Class "A"  
Office Space**



**Features**

- Professional Office Suites
- Convenient Location
- Will Sub-divide As Shown
- Barrier Free Restrooms
- Attractive, Colonial Style
- From 2,532 to 7,309/SF
- Will Remodel-to-Suit
- Municipal Water/Sewer
- City of St. Joseph
- All Entry Level Suites
- Private Offices
- Ample Free Parking

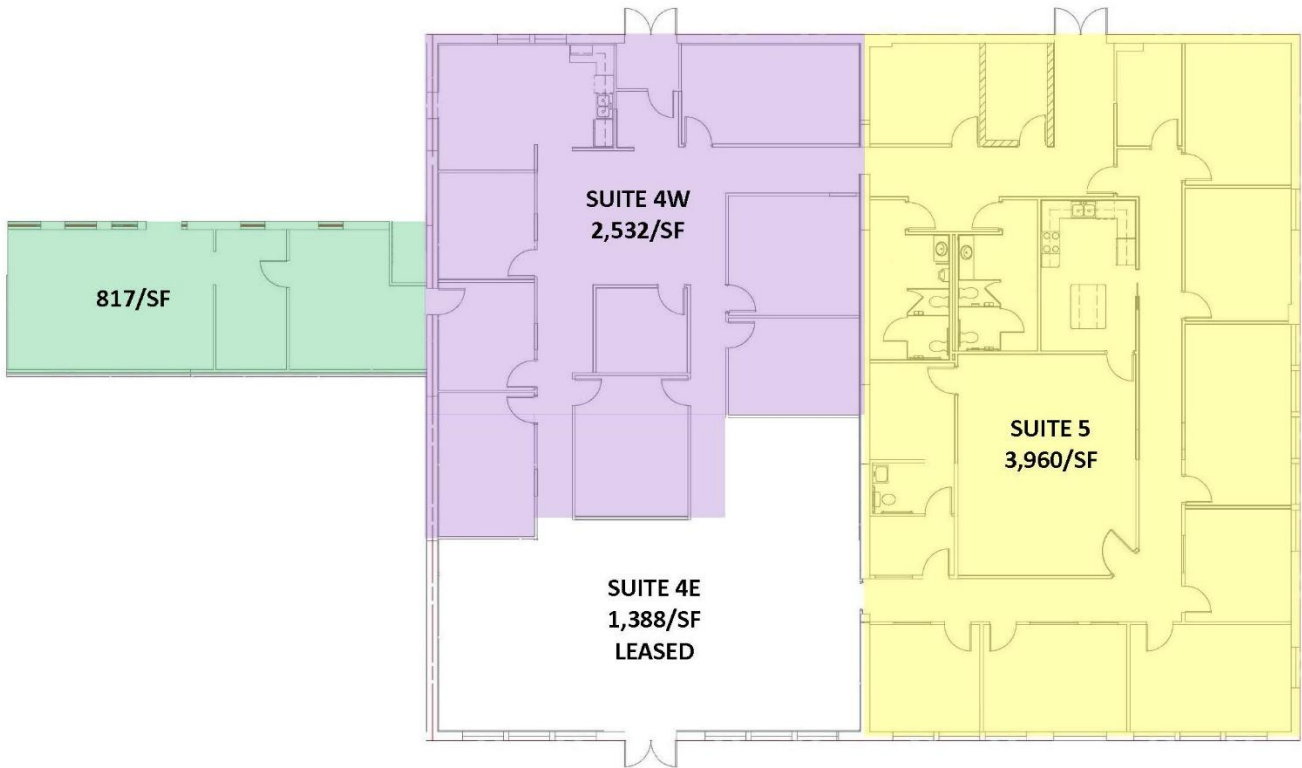

The Professional Center is ideally located for professionals looking for high visibility in the City of St. Joseph's Financial District. With 7,309/SF available, the Center offers several floor plan options.

CAM covers water, major systems, maintenance of the building exterior (snow removal, landscaping, trash removal), parking, insurances and property taxes.

**FISKARS PROPERTIES, INC.**

Offered by: James Agens, RE Broker  
1408 Whispering Trail  
Benton Harbor, MI 49022  
(269) 208-5302

