



5,250 SF AVAILABLE

2565-2579 Park Central Blvd
Suite 2569
DECATUR, GA 30035



FOR LEASE



PROPERTY INFORMATION

Total Size: 5,250 SF
Office: 899 SF
Warehouse: 4,351 SF
Loading: Two (2) Dock High Doors
Clear Height: 18'
Available: Immediately

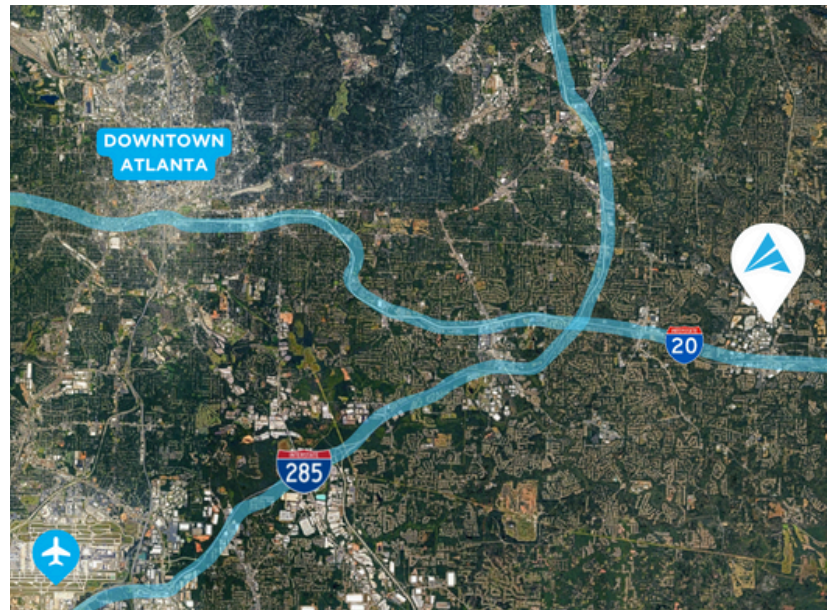

For more information, please contact:

TREY WEGHORST

Office: (770) 264-9420
Cell: (404) 276-9314
tweghorst@apexindustrialre.com

RECE MOORE

Office: (404) 574-6311
Cell: (770) 861-8140
rmoore@apexindustrialre.com



Although the information contained therein was provided from sources believed to be reliable, Apex Industrial makes no representation, expressed or implied, as to its accuracy and said information is subject to errors, omissions or changes.



5,250 SF AVAILABLE

2565-2579 Park Central Blvd
Suite 2569
DECATUR, GA 30035



FLOOR PLAN

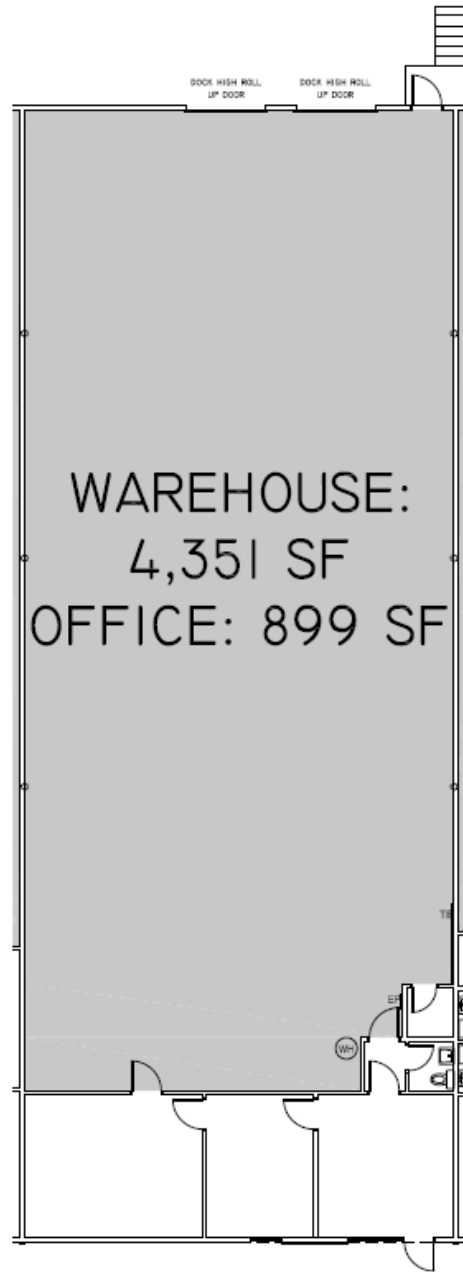

For more information, please contact:

TREY WEGHORST

Office: (770) 264-9420
Cell: (404) 276-9314
tweghorst@apexindustrialre.com

RECE MOORE

Office: (404) 574-6311
Cell: (770) 861-8140
rmoore@apexindustrialre.com



Although the information contained therein was provided from sources believed to be reliable, Apex Industrial makes no representation, expressed or implied, as to its accuracy and said information is subject to errors, omissions or changes.