

REVISIONS:

DATE	DESCRIPTION
09/16/2019	DETAILS
09/17/2019	DETAILS
10/02/2019	DRAWING REVISIONS
10/14/2019	UPDATING LIGHT

- LEGEND**
- 2' X 2' ACT CEILING GRID AND TILE
  - GWB SOFFIT CEILING
- HVAC FIXTURES**
- SUPPLY DIFFUSER

**Lighting Legend**

TYPE	SYMBOL	QTY	DESCRIPTION	LOCATION
L-1	[Symbol]	79	2X2' CEILING MOUNTED LIGHT	FOCUS & TEAM & ENCLAVE & PERSONAL ROOM & STORAGE & RESTROOM
L-2	[Symbol]	26	4" SUSPENDED LINEAR LIGHT	OPEN OFFICE & WORK CAFE
L-3	[Symbol]	8	TRACK LIGHT	OPEN TEAM & WORK CAFE & WORK ROOM
L-4	[Symbol]	40	4" RECESSED DOWNLIGHT	ELEVATOR LOBBY & CORRIDOR

**Paint Legend**

TYPE	DESCRIPTION	LOCATION
P-1	BENJAMIN MOORE COLOR NAME: WROUGHT IRON COLOR NO: SW 2124-10 SHEEN: FLAT	EXPOSED STRUCTURE OPEN CEILING

- CEILING PLAN NOTES**
1. OPEN TO STRUCTURE CEILING: THE INTENT AT THE OPEN TO STRUCTURE CEILING AREAS IS TO KEEP THE AREAS AS UNCLUTTERED AND ORDERLY AS POSSIBLE, INCLUDING BUT NOT LIMITED TO WIRING, CABLING, DUCT WORK AND SPRINKLER LINES. ALL DISCIPLINES TO COORDINATE LAYOUTS. LOCATIONS AND DESIGNS AS REQUIRED TO ACHIEVE THIS GOAL. COORDINATE WITH ARCHITECT AS REQUIRED. PAINT DARK. REFER TO FINISH PLAN.
  2. INSTALL NEW B/S ACOUSTICAL CEILING GRID, TILES & SPECIFIED LIGHT FIXTURES AS INDICATED.
  3. "EXPOSED STRUCTURE" INDICATES NO CEILING, EXPOSED TO DECK. PAINT EXPOSED STRUCTURE AREA. PLEASE SEE PAINT LEGEND FOR DETAIL INFORMATION.
  4. CENTER ACOUSTICAL PANELS OR GRID IN SPACES UNLESS OTHERWISE INDICATED.
  5. INSTALLATION OF FAST TOP CLIP (MODEL FTC3) SHALL BE PER MANUFACTURER'S RECOMMENDATION.

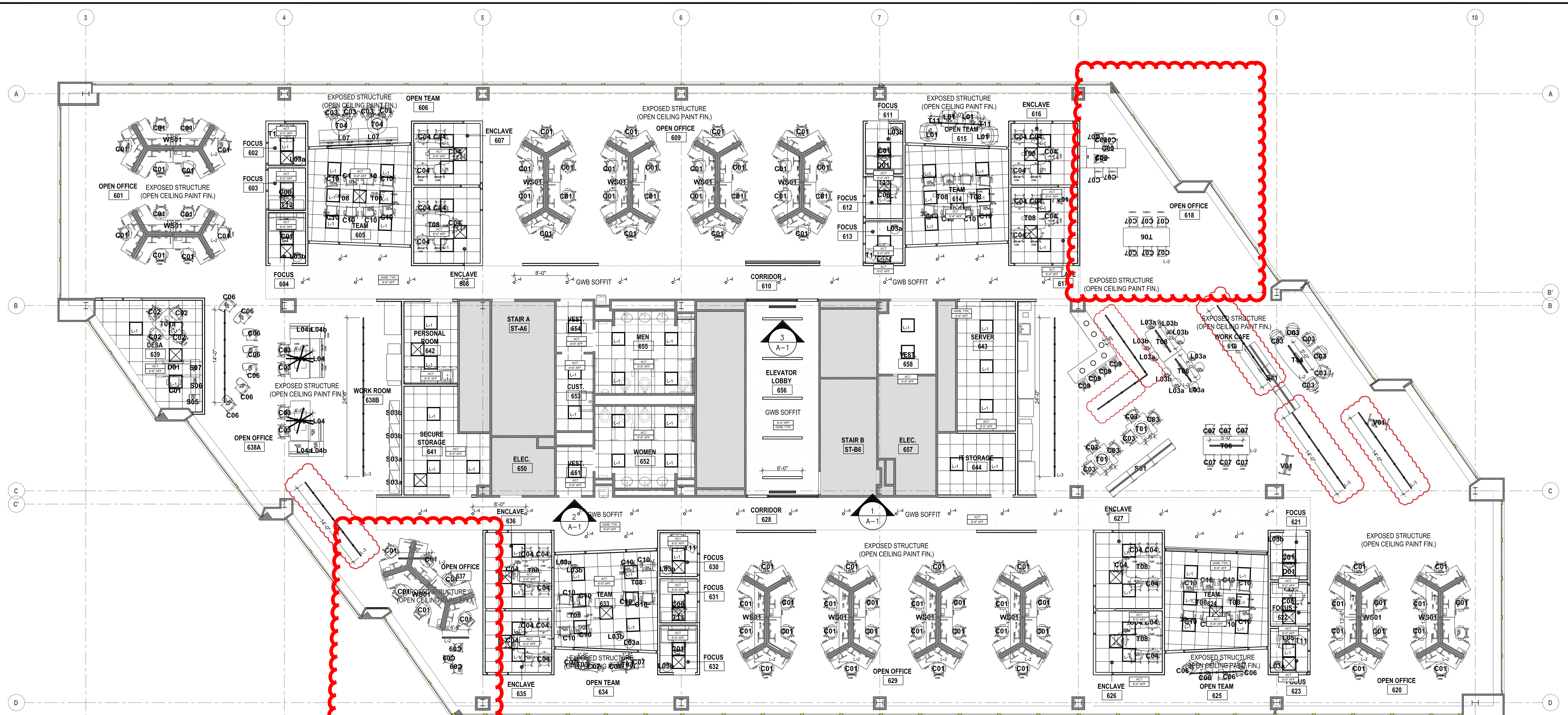

**SIXTH FLOOR CEILING PLAN**  
 1/8" = 1'-0"

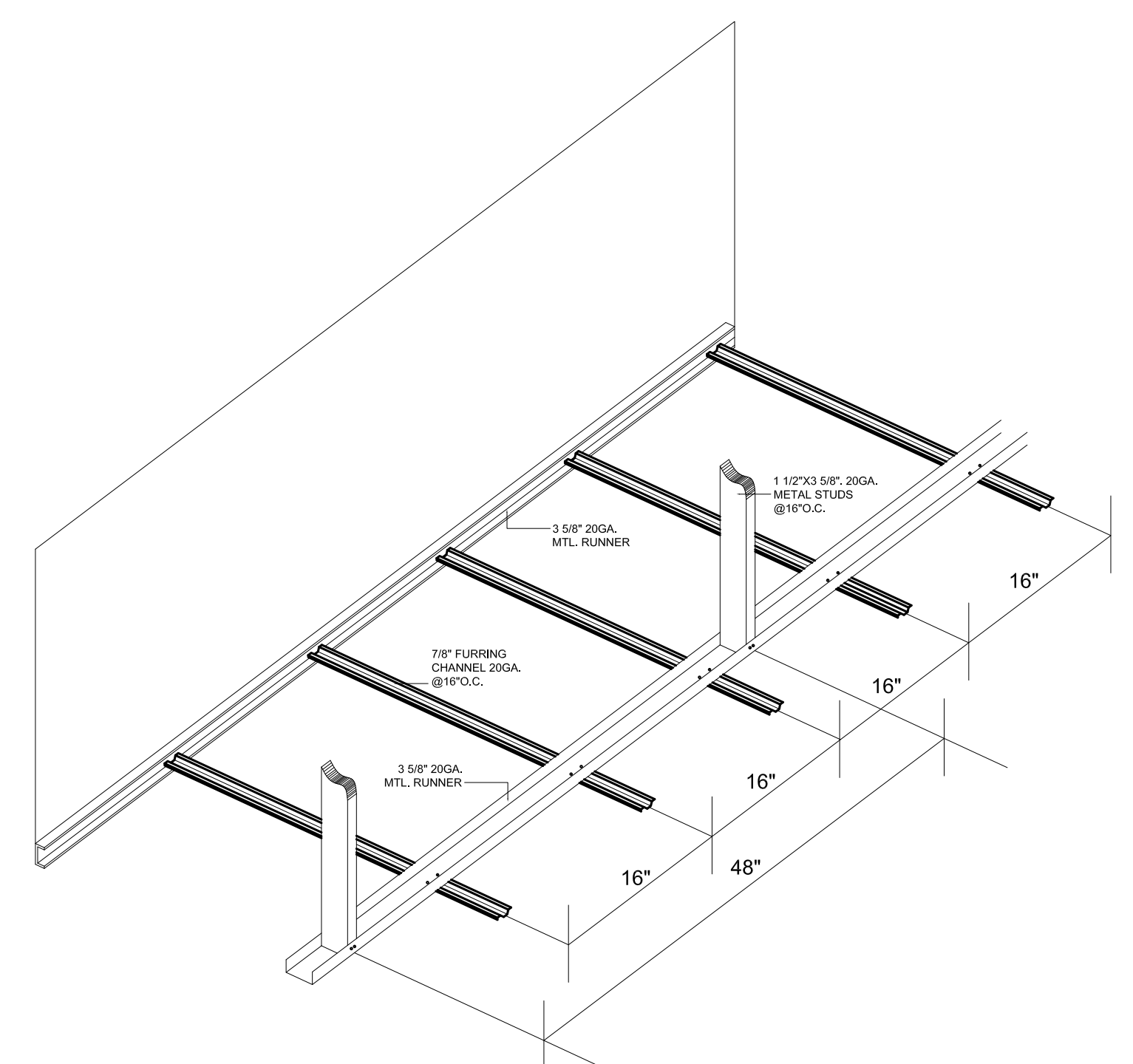

**FURRING CHANNEL CEILING SOFFIT ISOMETRIC**  
 NOT TO SCALE

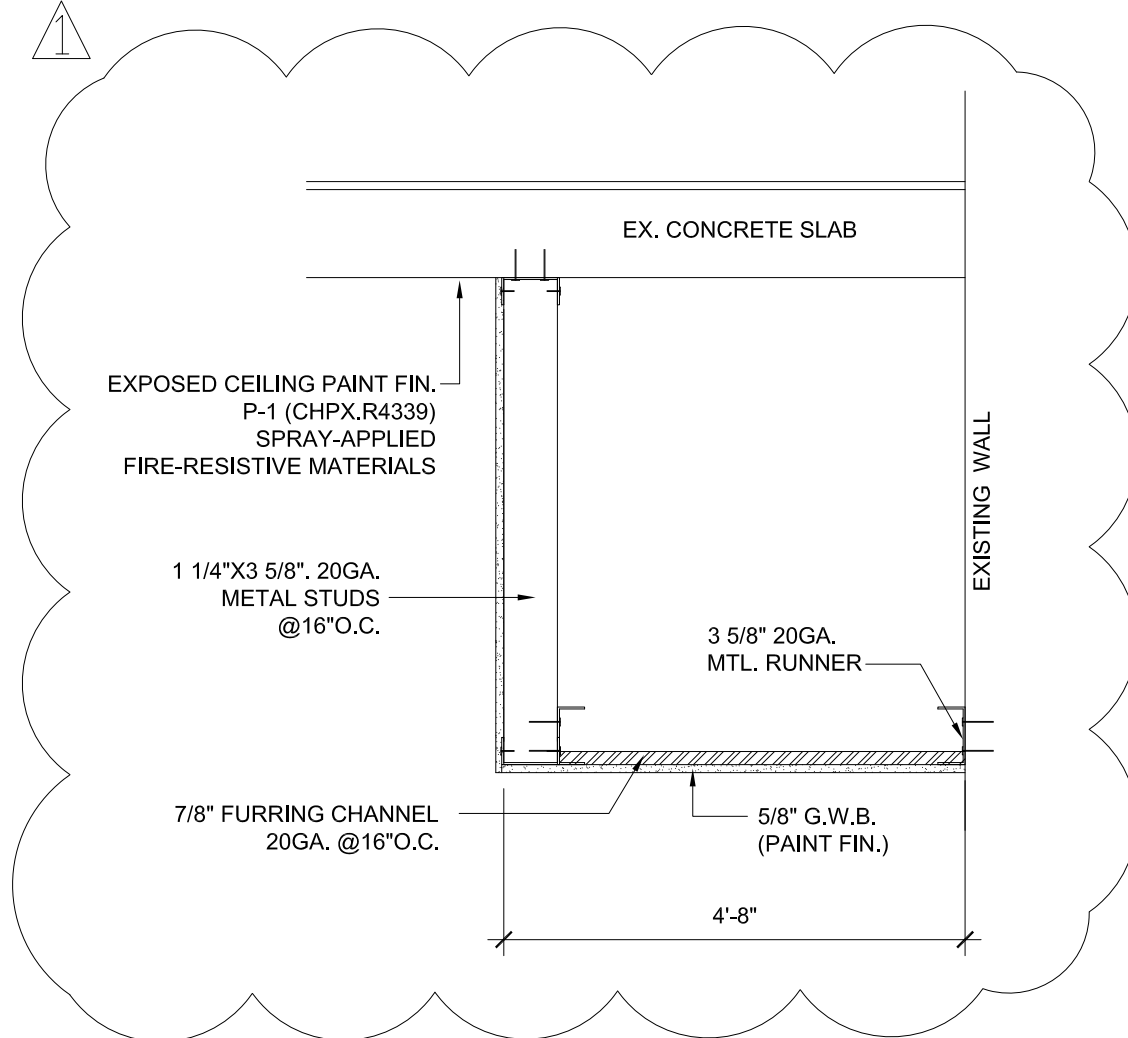

**1 HARD CEILING DETAIL**  
 SCALE: NOT TO SCALE

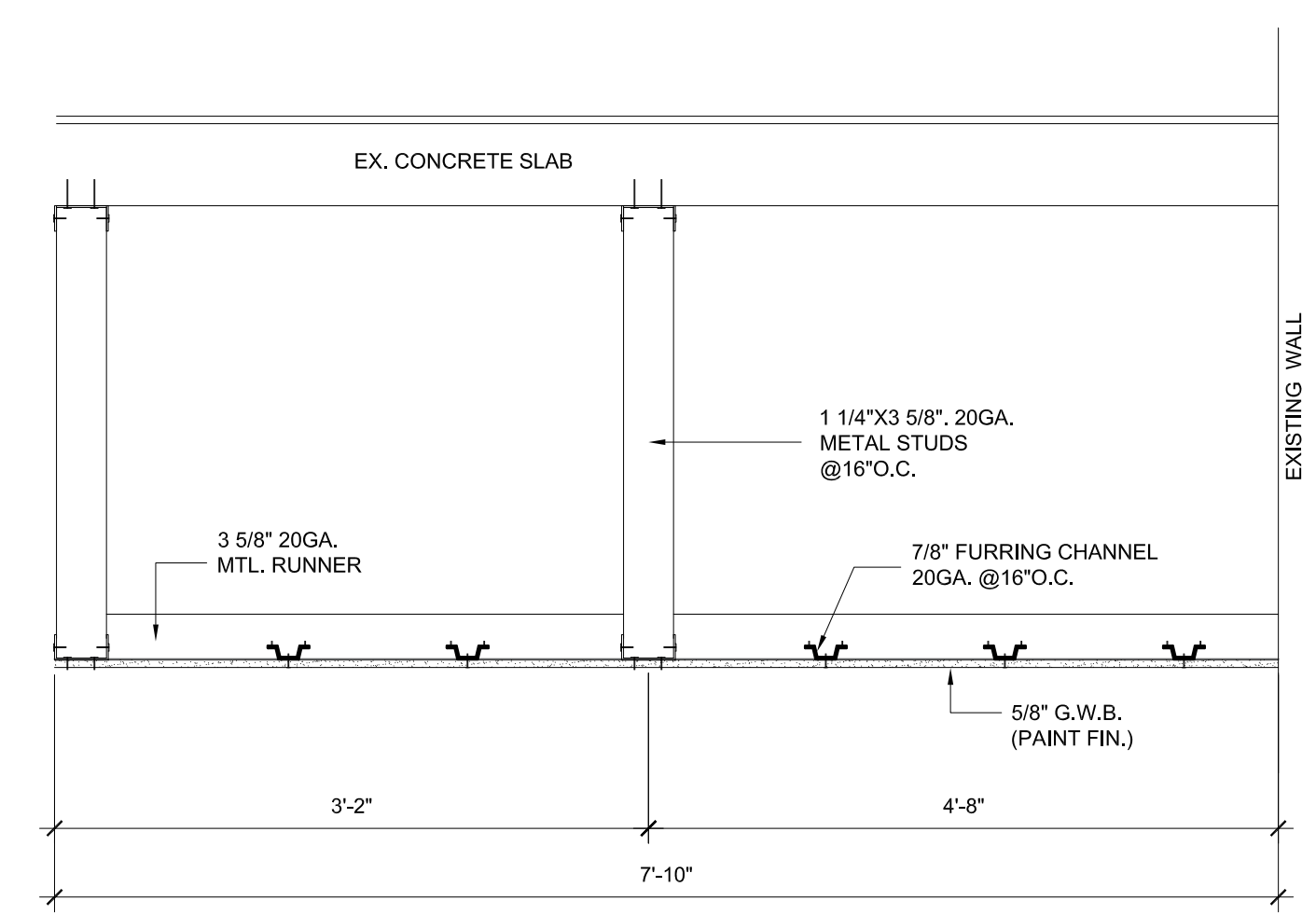

**2 HARD CEILING DETAIL**  
 SCALE: NOT TO SCALE

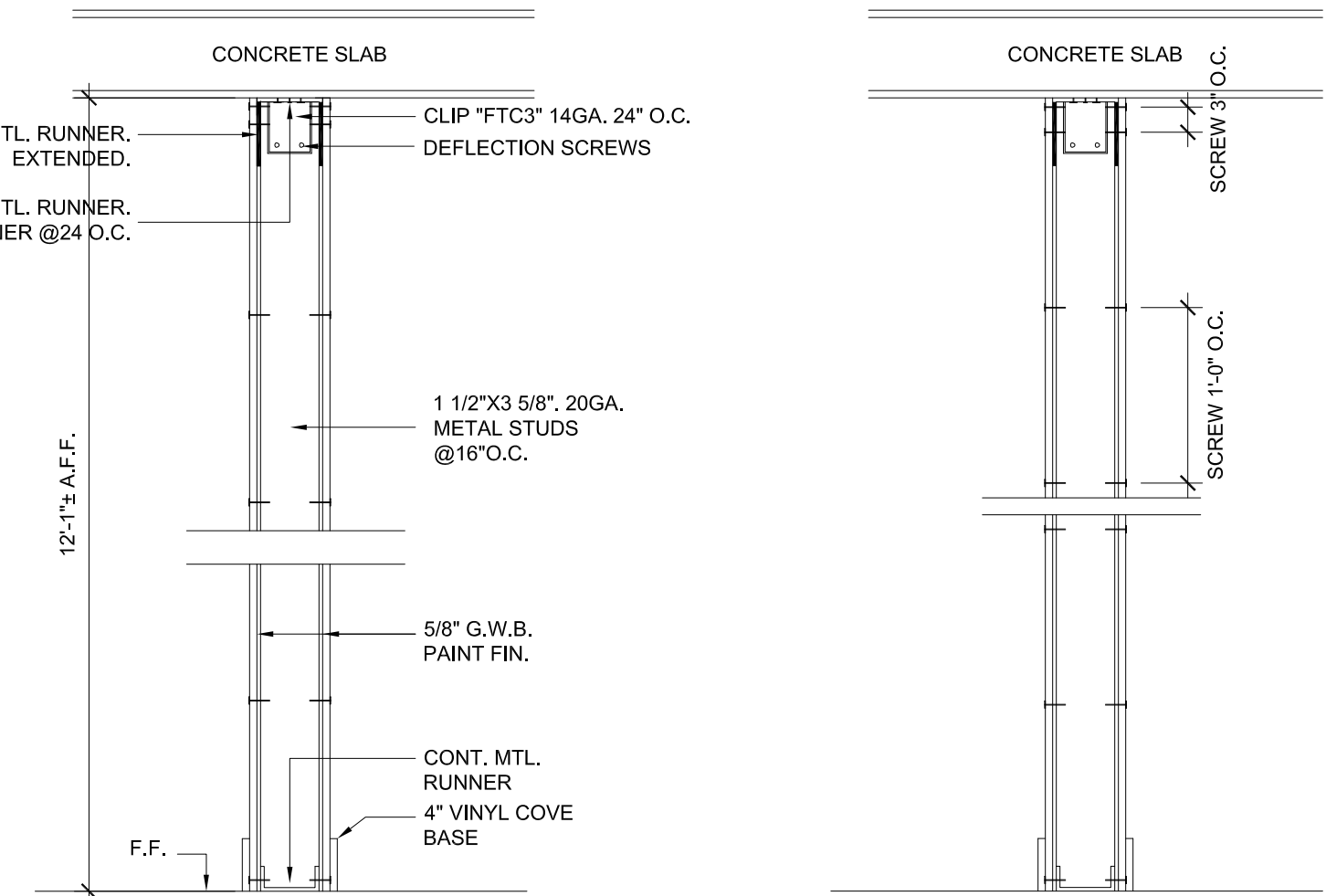

**PART. DETAIL W/CLIP / SCREW DETAIL / ALL WALL**  
 SCALE: NOT TO SCALE

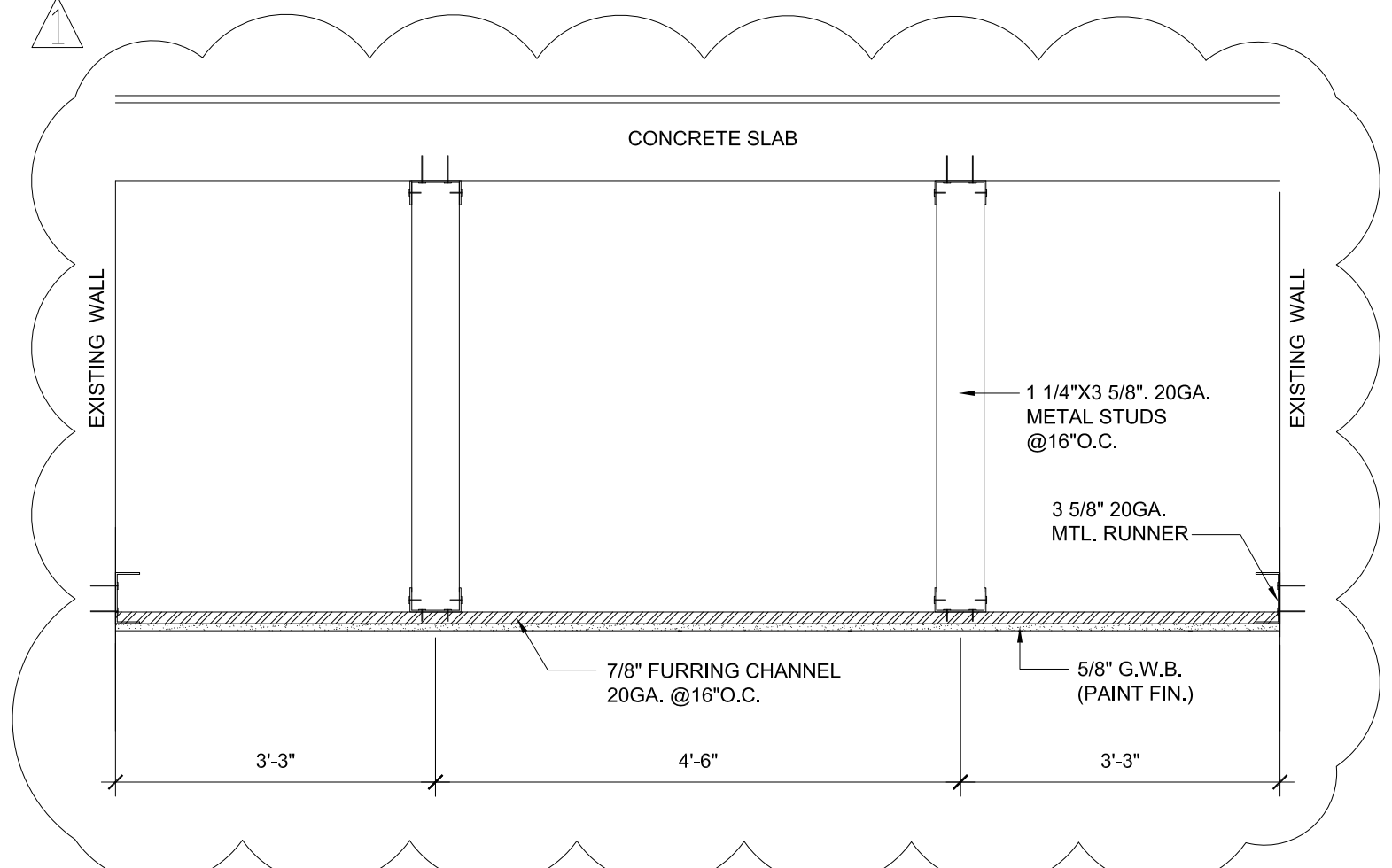

**3 HARD CEILING DETAIL - FURRING CHANNEL**  
 SCALE: NOT TO SCALE

**DETAIL NOTES**  
 INSTALLATION OF FAST TOP CLIP (MODEL FTC3) SHALL BE PER MANUFACTURER'S RECOMMENDATION.

KEY MAP:

PROJECT ADDRESS:  
 101, East Hartford, CT

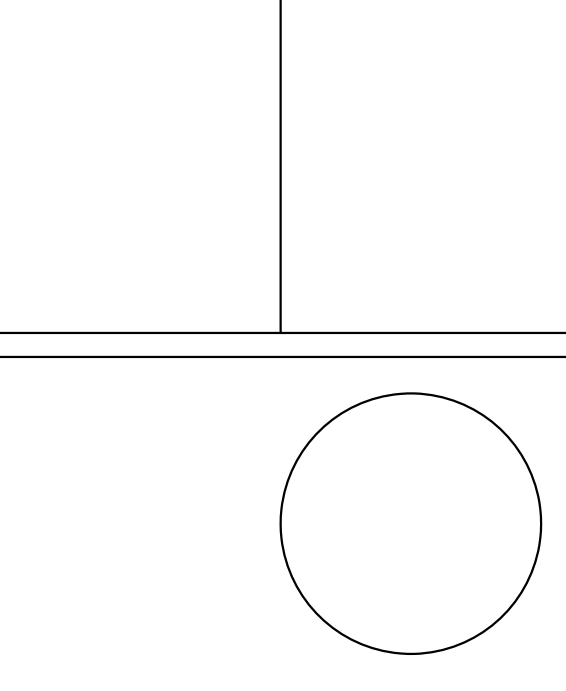

PROJECT:  
 DOOSAN FUEL CELL AMERICA  
 INTERIOR ALTERATION

DRAWING TITLE:  
 SIXTH FLOOR CEILING PLAN  
 (AMENDMENT)

PROJECT NUMBER:  
 DATE: 10/14/2019  
 DRAWN BY:  
 CHECKED BY: