



SCALE 1/16" = 1'  
H

**SOUTH BUILDING ELEVATION**

SCALE 1/8" = 1'  
H



**WEST BUILDING ELEVATION**

SCALE 1/16" = 1'  
H



SCALE 1/16" = 1'  
H

**NORTH BUILDING ELEVATION**

SCALE 1/8" = 1'  
H



**EAST BUILDING ELEVATION**

**SOUTHWEST ISOMETRIC BUILDING ELEVATION**

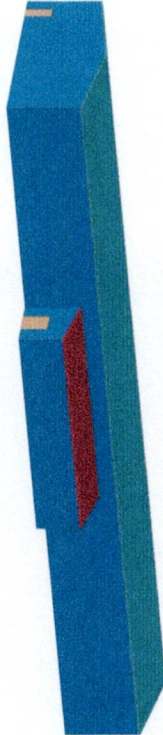

SCALE 1/16" = 1'  
H

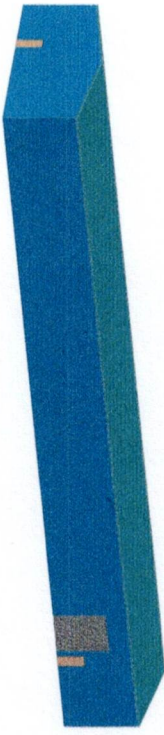

**NORTHEAST ISOMETRIC BUILDING ELEVATION**



General Notes

2	Issue for Review	X/XX
1	Issue for Review	X/XX
No.	Revisory/Issue	Date

STARS AND STRIPES ELEVATIONS

Project Name and Address  
STARS AND STRIPES  
CROW LLC  
4701 THUNDER LANE AVE  
MOBILE, OK 73068

Architect	Client
CANNIBIS	
Project Number	03
Author	CF

NUMBER	ROOM NAME	ROOM SIZE (FT <sup>2</sup> )	OCCUPANT LOAD FACTOR	OCCUPANT LOAD
101	ENTRY	138	150	1
102	TRIM ROOM	275	300	1
103	DISTING ROOM	391	300	2
104	WAREHOUSE	4,220.5	300	15
105	GROW ROOM	575.25	300	2
106	GROW ROOM	575.25	300	2

NUMBER	ROOM NAME	ROOM SIZE (FT <sup>2</sup> )	OCCUPANT LOAD FACTOR	OCCUPANT LOAD	
107	GROW ROOM	870.25	300	3	
108	GROW ROOM	870.25	300	3	
109	GROW ROOM	413	300	2	
110	GROW ROOM	413	300	2	
111	WATER ROOM	882.75	300	3	
TOTAL AREA		TOTAL BUILDING AREA	10,000	TOTAL OCC LOAD	38

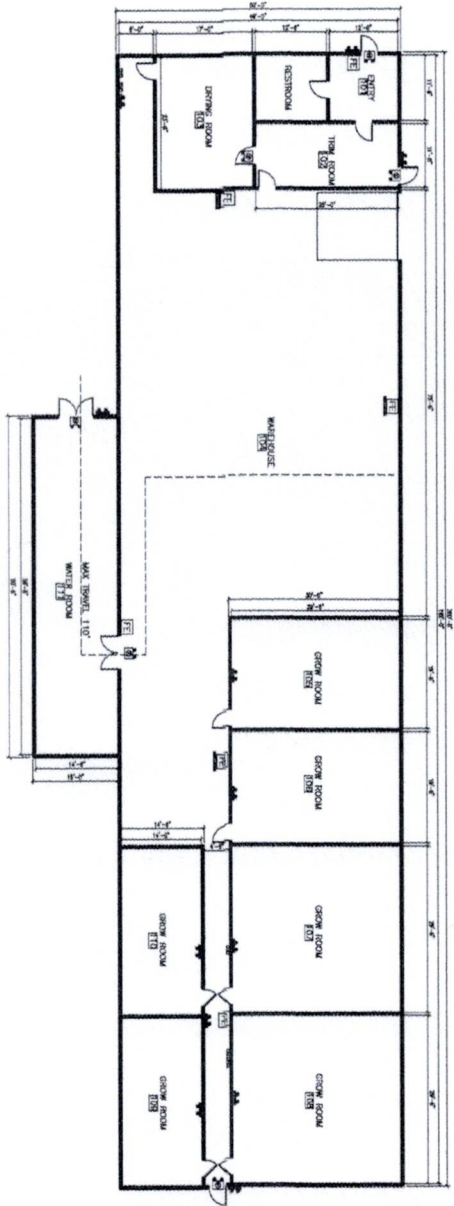

- ⊙ EXIT SIGN
- ⊕ EXIT/EMERGENCY LIGHT FIXTURE
- ⚡ EMERGENCY EGRESS LIGHTING
- ⚡ FIRE EXTINGUISHER
- ⚡ ELEC ELECTRICAL PANEL

SCALE 3/32" = 1'



General Notes

No.	Issue For Review	Date
2	Issue For Review	X/XX
1	Issue For Review	X/XX
	Revision/Issue	Date

STARS AND STRIPES  
GROW LLC  
FLOORPLAN

Project Name and Address  
STARS AND STRIPES  
GROW LLC  
4701 THUNDER LANE AVE  
NOBLE, OK 73068

Arch	Drawn	Check	Date
CANNABIS			
02			
Arch			
CP			

**Flower Room 1**

225 Amp Main Breaker  
2-5 ton condensers  
2-5 ton air handlers  
2-10kW heat strip  
2-225 Quest  
36 640W LEDs  
24-Wall fans  
7-Floor fans

**Flower Room 2**

225 Amp Main Breaker  
2-5 ton condensers  
2-5 ton air handlers  
2-10kW heat strip  
2-225 Quest  
36 640W LEDs  
24-Wall fans  
7-Floor fans

**Flower Room 2.5**

200 Amp Main Breaker  
2-2 ton mini split units  
18 LEDs  
2-Horizontal wall fans  
4-Floor fans

**Veg Room**

150 Amp Main Breaker  
2-2 ton mini split units  
24 CMH Lights  
16-Wall fans  
2-Floor fans

**Water Room**

Hyperlogic RO System  
Three layer Dionization tanks  
2500 gallon well water tank  
2500 gallon clean water tank

**Dry Room**

5 ton condenser  
5 ton air handler  
10kW heat strip

**Notes**

10,000 sq ft main building  
900 sq ft utility room  
10,900 sq ft total  
2.10 acres  
24/7 security gate  
Certificate of Occupancy  
Building Permit  
Fire Alarm Permit  
CO2 Permit