

Finish Schedule (Class-A Finishes, Typical)

- STAINED CONCRETE*
- FLOORING** throughout typical. Ceramic tile floor in Restrooms. Prep and level existing floor.
 - Walls shall be painted with two coats of latex Sherwin Williams over wall primer.
 - Base shall be 4" Rubber coved, typical, unless noted otherwise.
 - Acoustical ceiling shall be USG 2' x 2 Aurotone Natural Fissured II, 5/8", with Chicago Metallic snap-grid 211 system (Radar style with reveal edge). Gyp board ceilings and furr-downs where noted on ceiling/lighting plan shall be painted.
 - Floor in restroom shall be ceramic tile with 6" high tile base.
 - Install 4'-high ceramic tile wainscot on restroom walls. (FRP AT MDP SINK)
 - Install water resistant gypsum board at all wet walls.
 - Max 1/2" change in elevation at floor finishes.

General Notes

- Use 5/8" type "X" gypsum board at all walls.
- Verify and install 2x fire retardant wood blocking as required for mounting of wall equipment and accessories.
- Verify ANY equipment rough-ins and mounting requirements with supplier.
- Public use areas shall comply with ADA and TAS (Americans With Disabilities Act and Texas Accessibility Standards), i.e., waiting room, check-out, handicapped restrooms & operatories:
 - Clear door opening width shall be 2'8" (use 3'0" door)
 - Use commercial grade hardware with lever-type handle at 3'-0" A.F.F. (verify with existing)
 - Door opening force shall not exceed 5 pounds
 - Thresholds shall not exceed 1/2" in height
 - Door signage shall comply with ADA Section 4.30
 - Minimum door height shall be 6'8".

- A readily visible, durable sign shall be posted on the egress side, on or adjacent to the door, stating: THIS DOOR TO REMAIN UNLOCKED WHEN BUILDING IS OCCUPIED. The sign shall be in letters one inch (25 mm) high on a contrasting background at front door (per IBC Section 1008.1.8.3).
- Glazing in hazardous locations shall comply with IBC Section 2406.
- Space above ceiling is NOT used as a Return-Air plenum.
- Insulation in building shall have a flame spread not more than 25 and a smoke development rating not more than 450
- Address identifying numbers must be posted on building prior to final inspection .
- General contractor shall obtain from landlord the tenant construction guidelines and these guidelines shall be strictly adhered to for all phases of construction.
- Provide 36" wide portion of handicap accessible counter 36" A.F.F. (max) at cash/wrap or check-out counters.

Ⓣ FIRE EXTINGUISHER - 5 lbs 3A 40 BC, MOUNT 42" ABOVE FLOOR TO HANDLE, ADD SIGN ABOVE PER CITY CODE WITH TEXAS FIRE MARSHAL TAG.



5/8" GYP. BOARD ON 3 5/8" MTL. STUDS WITH R-13 INSULATION AT EXTERIOR WALLS, TYP. (FIELD VERIFY)

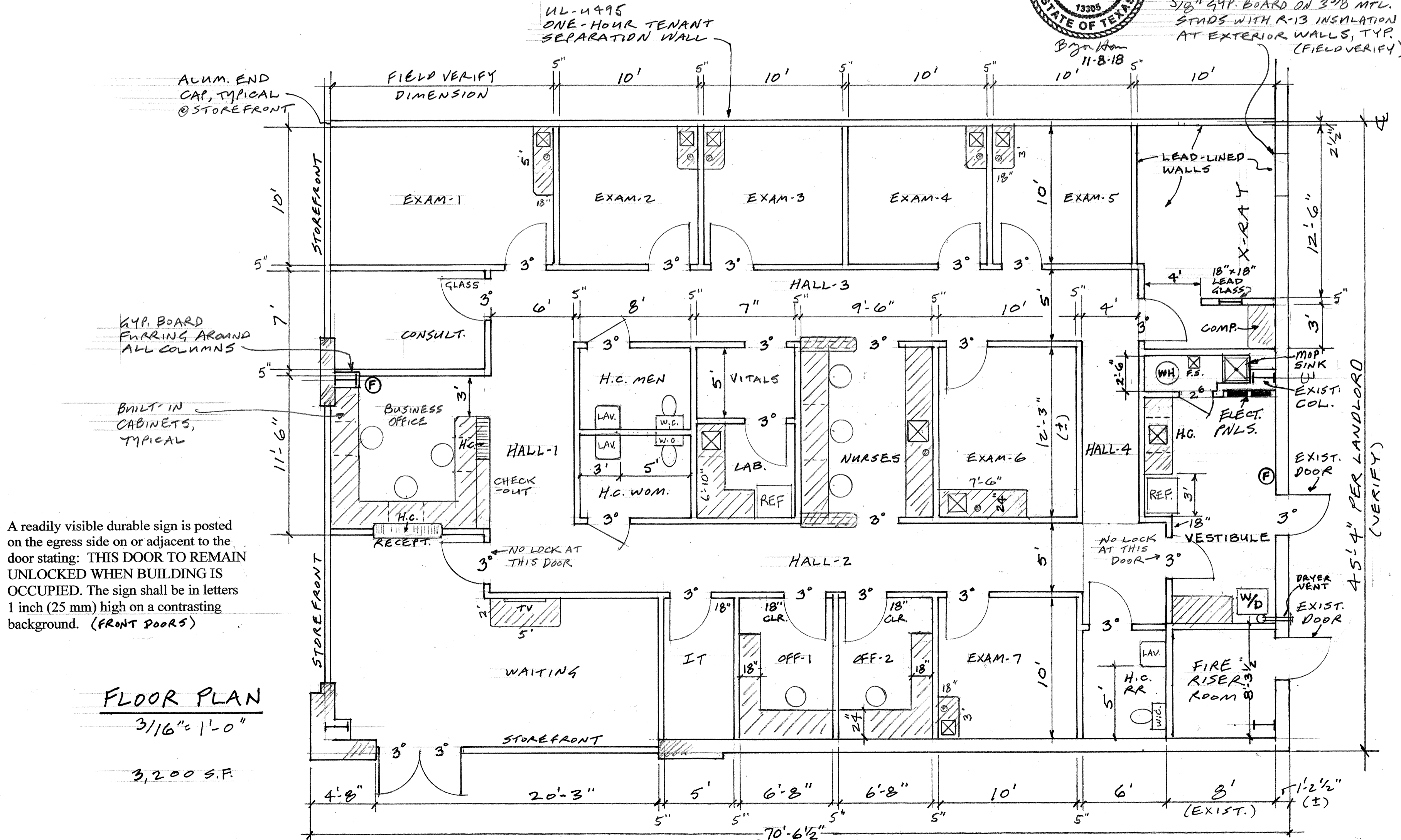

FLOOR PLAN
3/16" = 1'-0"
3,200 S.F.

SANDSTONE FAMILY MEDICINE
795 FISH CREEK THOROUGHFARE # 270
MONTGOMERY, TEXAS 77316

BRYAN HORN * ARCHITECT

