

SUITES 200 | 202 | 204
Fitted Labs - Available Now

SUITE 204: ±5,886 SF

SUITE 202: ±7,784 SF

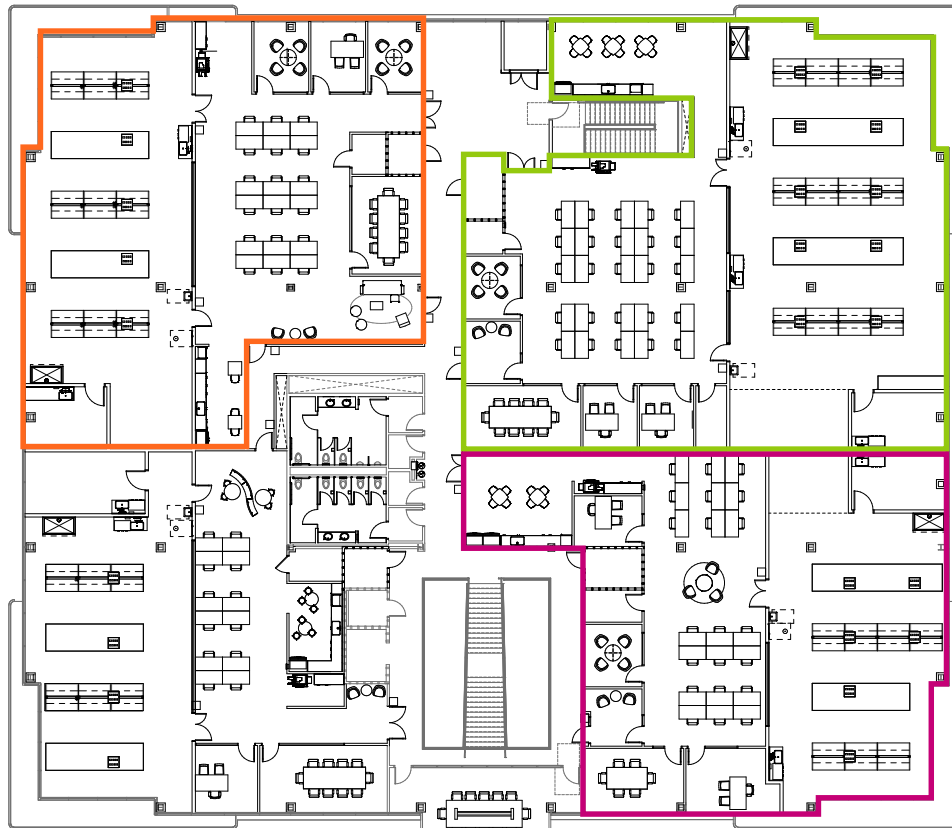

SUITE 200: ±6,445 SF

KEY PLAN

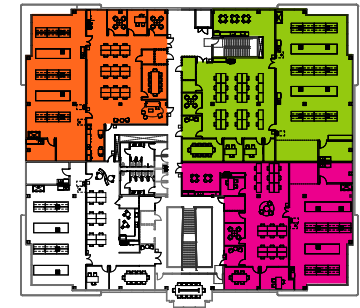

SITE PLAN

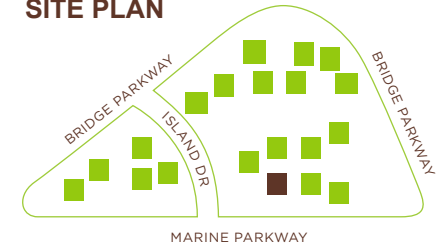

BEN PAUL
Vice Chairman
+1 650 401 2123
ben.paul@cushwake.com
LIC #01210872

MARC POPE
Vice Chairman
+1 650 401 2131
marc.pope@cushwake.com
LIC #01474483

NICK WALDSMITH
Director
+1 650 320 0244
nick.waldsmith@cushwake.com
LIC #02148008