

**EASY I-15 ACCESS AT
7200 SOUTH AND 9000 SOUTH**

**Comfort
Champions**
Heating & Air Conditioning
Carrier
801-542-7075
www.comfortchampions.com

FOR LEASE: UNIT 121

4,867 SF

**8385 SOUTH ALLEN STREET
SANDY, UTAH**

KYLE MCMULLIN

Senior Director

+1 801 303 5480

kyle.mcmullin@cushwake.com

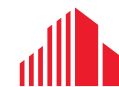

**CUSHMAN &
WAKEFIELD**

8385 SOUTH ALLEN STREET SANDY, UTAH



UNIT SIZES ARE APPROXIMATE

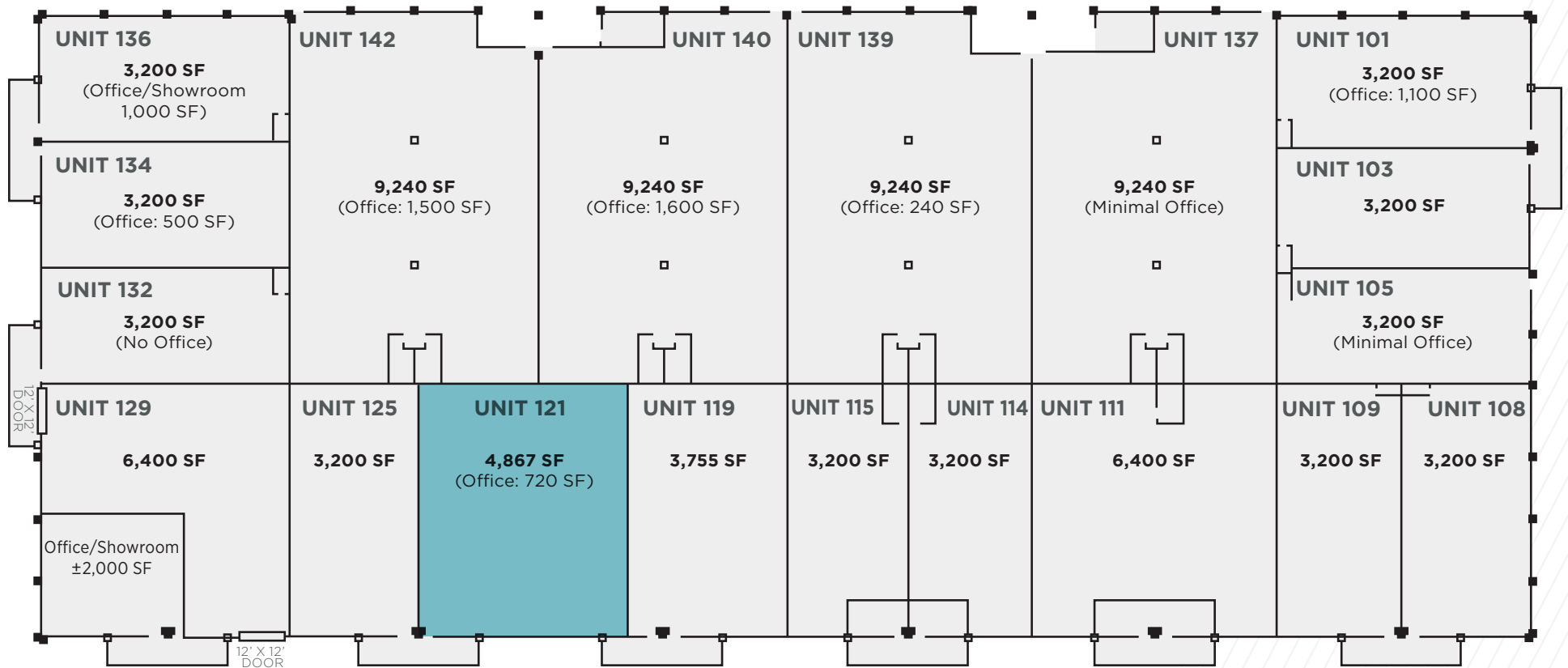

UNIT 121

- Area: 4,867 SF
- Warehouse/Manufacturing: 4,080 SF
- Office: 720 SF
- Lease Rate: \$6,084/Mo (\$1.25 PSF/Mo)
- CAM: \$828 (\$0.17/SF/Mo)
- Occupancy: October 31, 2026
- Zone: CR-PUD
- Power: Three phase service
- Ceiling: 16'
- Two Ground Level Doors: 12'x16' and 8'x9'
- Abundant Parking
- Easy access to 90th South I-15 exit



KYLE MCMULLIN
Senior Director
+1 801 303 5480
kyle.mcmullin@cushwake.com



8385 SOUTH ALLEN STREET SANDY, UTAH

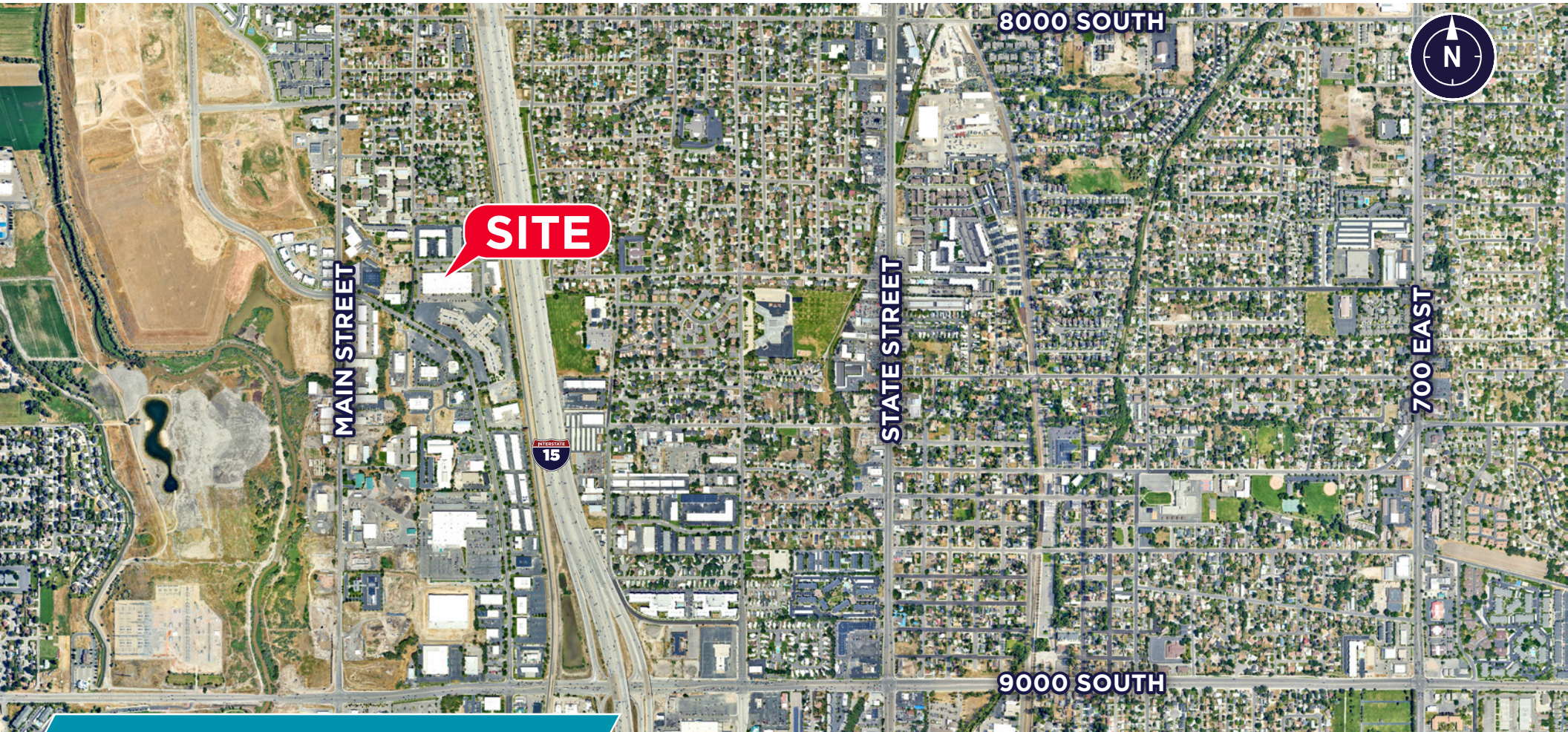

FOR MORE INFORMATION, CONTACT:

KYLE MCMULLIN
Senior Director
+1 801 303 5480
kyle.mcmullin@cushwake.com

170 South Main Street, Suite 1600
Salt Lake City, UT 84101
+1 801 322 2000
cushmanwakefield.com

©2026 Cushman & Wakefield. All rights reserved. The information contained in this communication is strictly confidential. This information has been obtained from sources believed to be reliable but has not been verified. NO WARRANTY OR REPRESENTATION, EXPRESS OR IMPLIED, IS MADE AS TO THE CONDITION OF THE PROPERTY (OR PROPERTIES) REFERENCED HEREIN OR AS TO THE ACCURACY OR COMPLETENESS OF THE INFORMATION CONTAINED HEREIN, AND SAME IS SUBMITTED SUBJECT TO ERRORS, OMISSIONS, CHANGE OF PRICE, RENTAL OR OTHER CONDITIONS, WITHDRAWAL WITHOUT NOTICE, AND TO ANY SPECIAL LISTING CONDITIONS IMPOSED BY THE PROPERTY OWNER(S). ANY PROJECTIONS, OPINIONS OR ESTIMATES ARE SUBJECT TO UNCERTAINTY AND DO NOT SIGNIFY CURRENT OR FUTURE PROPERTY PERFORMANCE.

