

savills

SUBLEASE

# Flexible Office & Warehouse Sublease

Approximately 1,000 – 13,000 SF of Space

13955 Stowe Drive, Poway, CA 92064

## SPACE PROFILE

**~1,000 – 13,000**

**RSF**

Space Size

**Withheld (~\$0.34/SF nets)**

Rate

**Immediately**

Availability

**December 2031**

Lease Term Through

## KEY HIGHLIGHTS

- 23' min clear height
- Access to 1 dock door
- Access to 1 grade level door
- .45 GPM/3,000 sprinklers
- AT&T fiber available
- LED lighting in warehouse
- Server room with HVAC
- Shared kitchen
- Shared restrooms on 1<sup>st</sup> floor
- Dedicated restrooms in the mezzanine

## BUILDING HIGHLIGHTS

- Class B industrial warehouse
- Possible power and air distribution on all columns



# Floor Plan

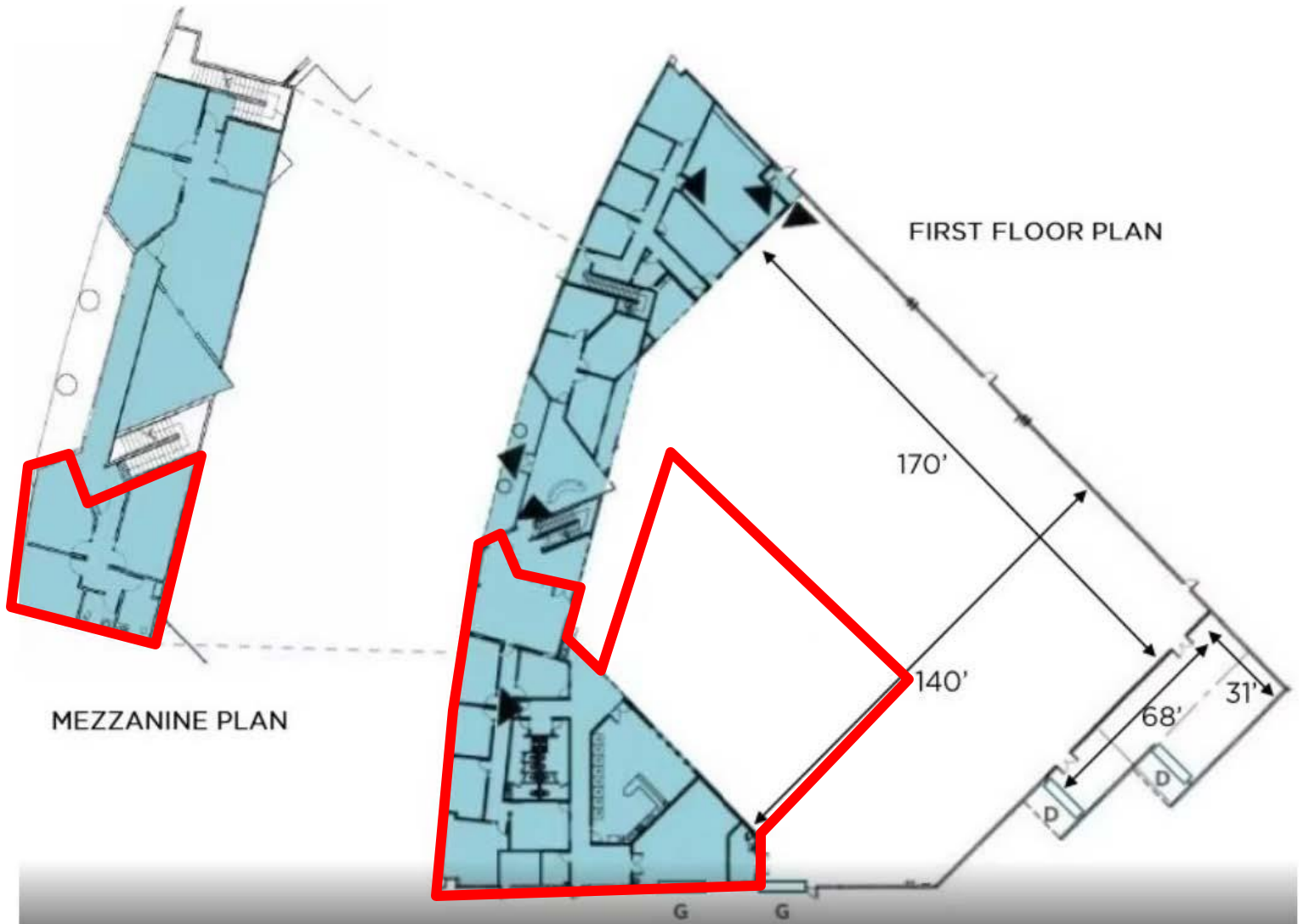

*Areas outlined in red available for sublease*

# Exterior



# Interior

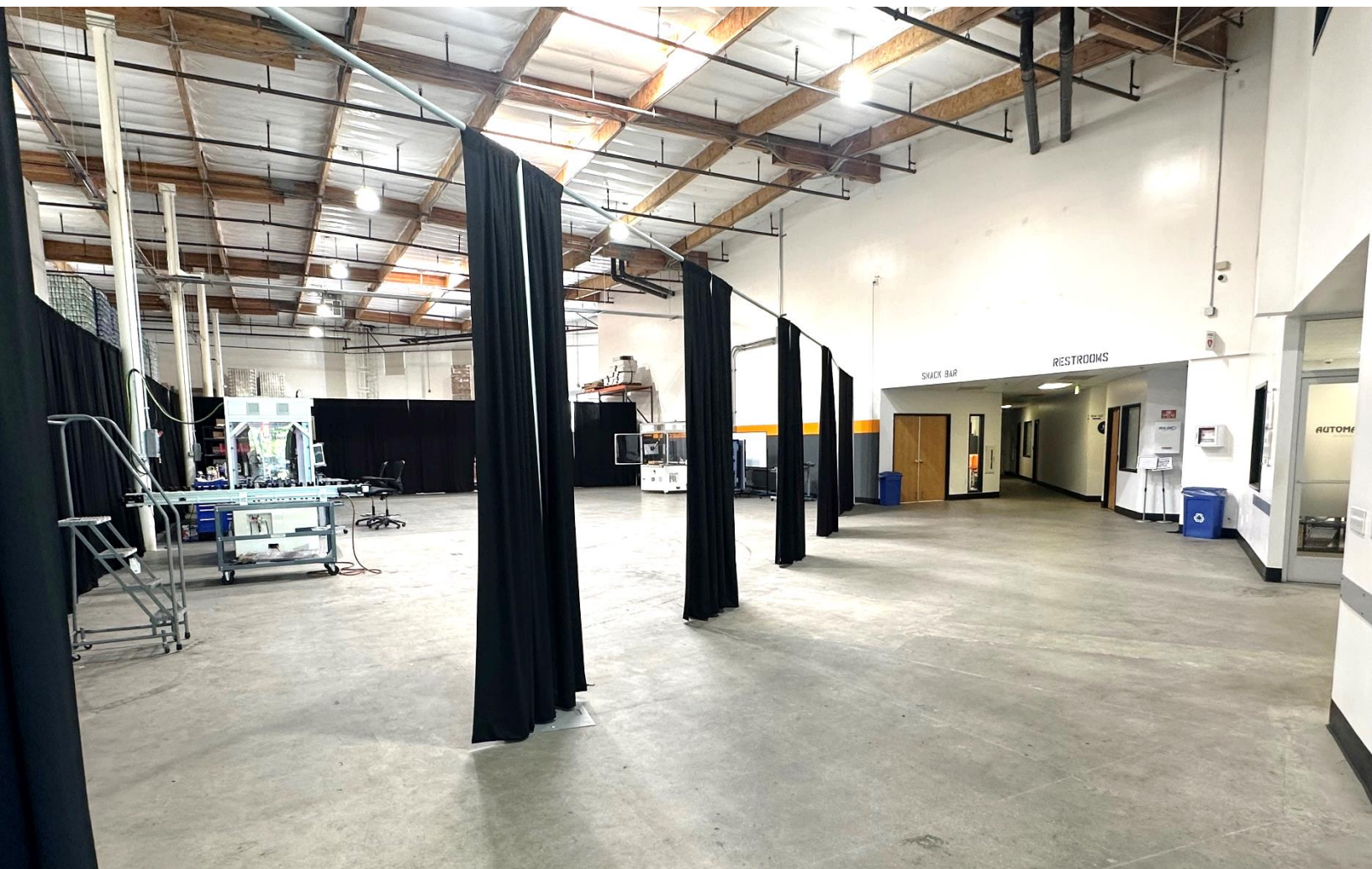
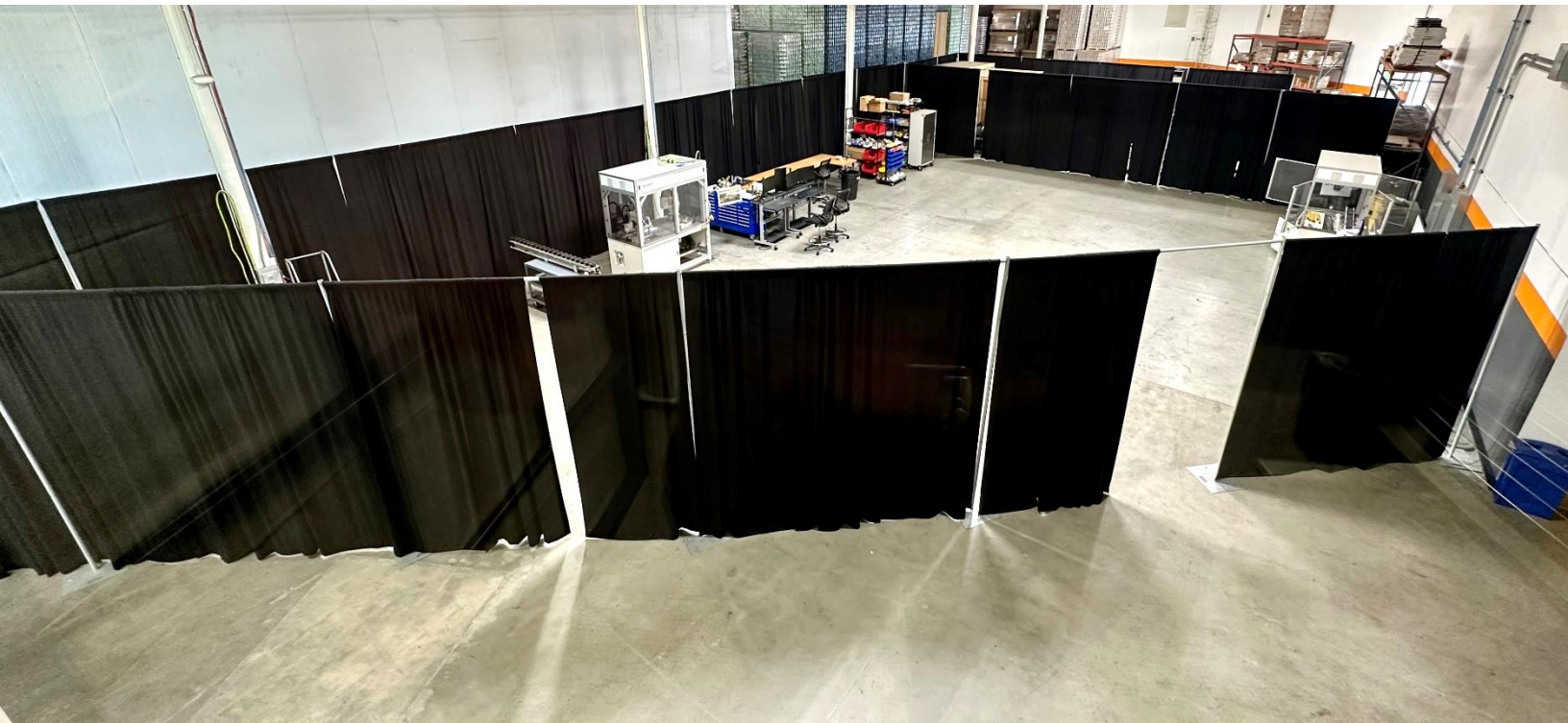

# Interior Continued



# Interior Continued

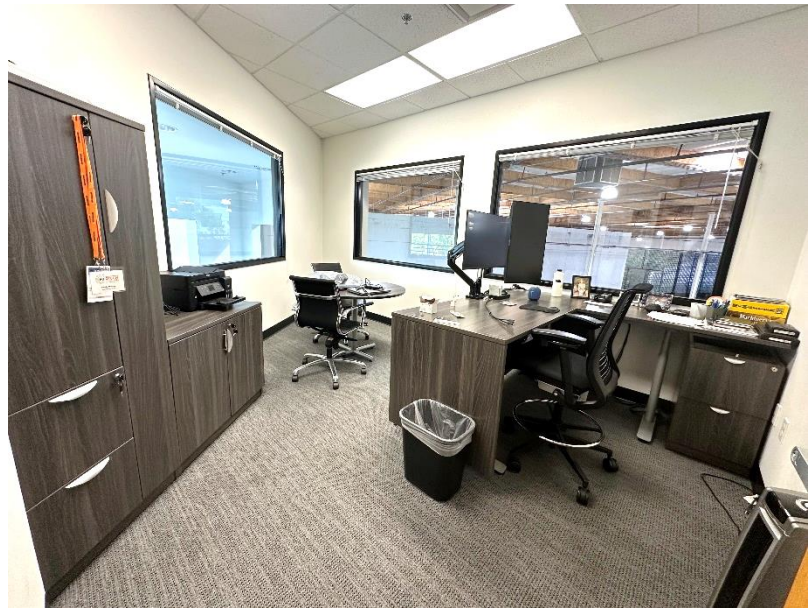

# Map Overview

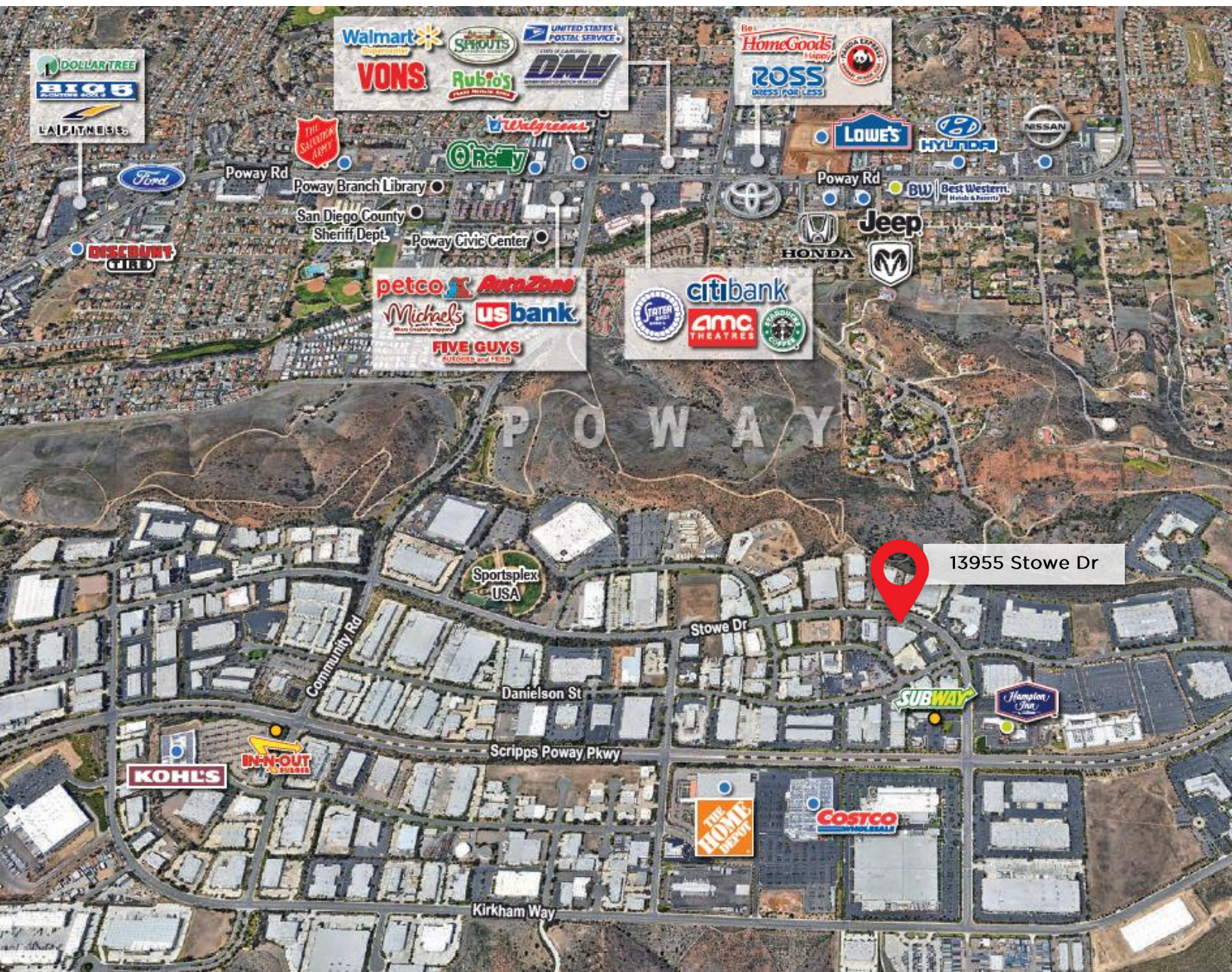

**Zach Millrood**  
+1 858 336 8660  
[zmillrood@savills.us](mailto:zmillrood@savills.us)  
License #01317277

**Louis Bickett**  
+1 858 255 9690  
[lbickett@savills.us](mailto:lbickett@savills.us)  
License #00388260

The information contained in this communication has been obtained from a variety of sources believed to be reliable but has not been verified. NO WARRANTY OR REPRESENTATION, EXPRESS OR IMPLIED, IS MADE AS TO THE CONDITION OF THE PROPERTY OR ACCURACY OR COMPLETENESS OF THE INFORMATION CONTAINED HEREIN AND SAME IS SUBMITTED SUBJECT TO ERRORS, OMISSIONS, CHANGE OF PRICE, RENTAL OR OTHER CONDITIONS, WITHDRAWAL WITHOUT NOTICE AND TO ANY SPECIFIC CONDITIONS IMPOSED BY THE PROPERTY OWNER OR LESSOR.