

CBRE

55

WATER



Space	RSF	Condition	Available
Entire 49th Floor	69,459	Raw	Immed.
Entire 23rd Floor	66,858	Raw	Immed.
Entire 22nd Floor	66,604	Raw	Immed.
Entire 21st Floor	65,636	Built	Arranged
Entire 20th Floor	65,612	Built	Arranged
Entire 19th Floor	65,446	Built	Arranged
Entire 13th Floor	64,887	Built	Immed.

SPACE / BUILDING FEATURES

- Tenant-only Cafeteria & Coffee Shop
- Two on-site parks
- In-Building Parking Garage
- Sky 55 Bar & Beer Garden
- Significant Building Infrastructure

Office Intensive Test-Fit Approx. 65,000 Rentable Sq. Ft

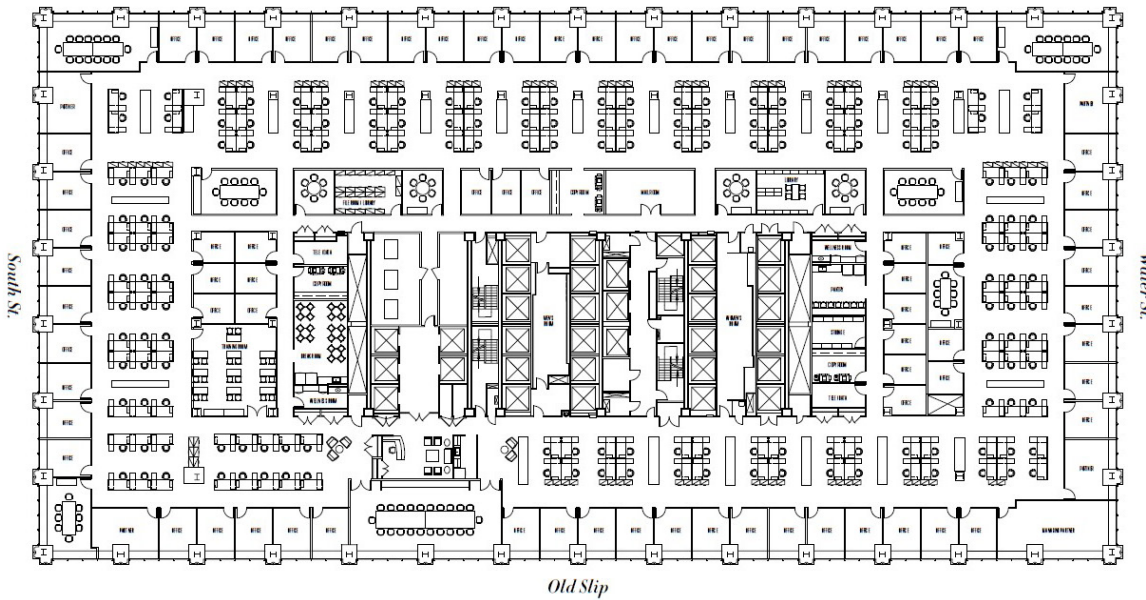

Workstations	162
Private Offices	75
Private Offices	5
Conference Rooms	11
Total Seats	242
SF Per Person	287

Open Test-Fit Approx. 65,000 Rentable Sq. Ft

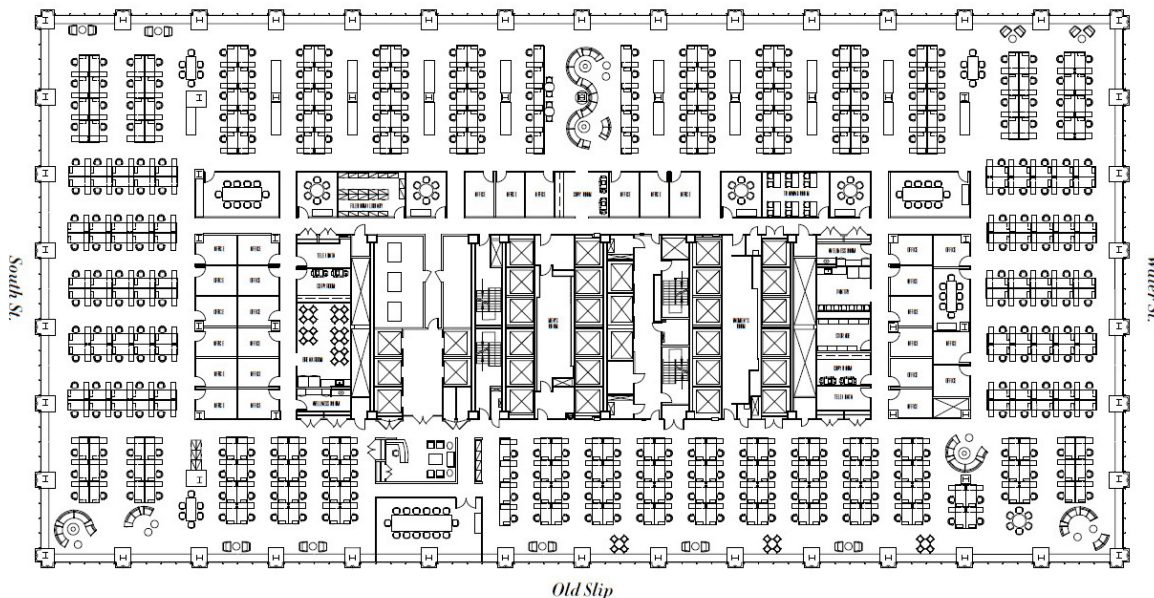

Workstations	342
Private Offices	27
Conference Rooms	8
Total Seats	369
SF Per Person	188



SOUTH LOBBY COFFEE KIOSK



CAFE 55



TENANT ONLY CAFETERIA



SKY 55 BAR & LOUNGE

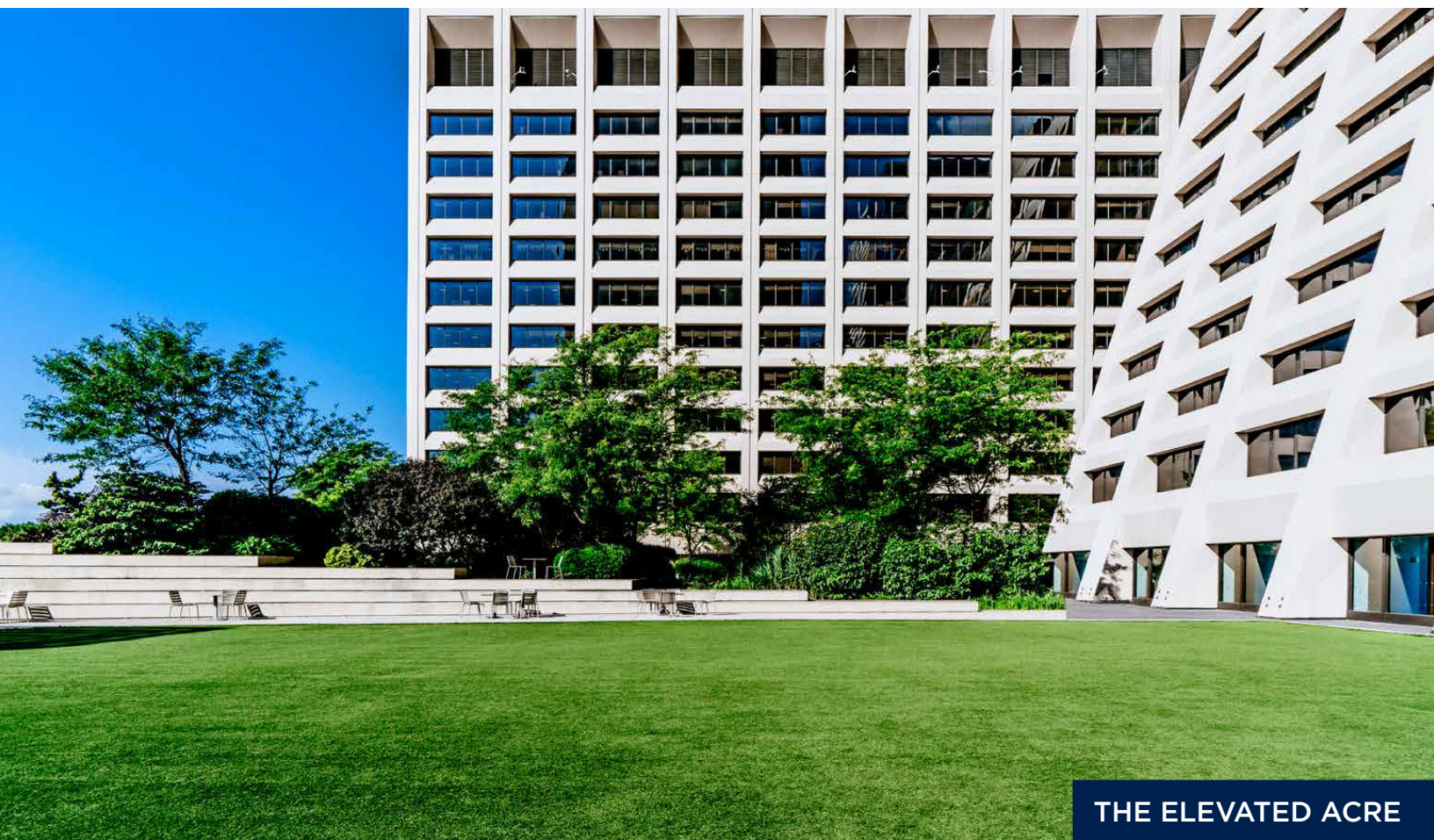

THE ELEVATED ACRE

IN THE *Neighborhood*

TRANSPORTATION

13 SUBWAYS WITHIN WALKING DISTANCE



EASY ACCESS TO NYC FERRY SYSTEM



- | | |
|------------------|----------------|
| Astoria | Rockaway |
| East River | Seastreak |
| LES | Soundview |
| NY water Taxi | South Brooklyn |
| NY Waterway - NJ | |



SAMPLE

Installation



FANTASTIC *Views*



For more information, please contact:

Howard Fiddle

+1 212 984 6525

howard.fiddle@cbre.com

Brad Gerla

+1 212 618 7066

brad.gerla@cbre.com

Evan Haskell

+1 212 984 8049

evan.haskell@cbre.com

William Hooks

+1 212 984 8004

william.hooks@cbre.com

CBRE

© 2023 CBRE, Inc. All rights reserved. This information has been obtained from sources believed reliable, but has not been verified for accuracy or completeness. You should conduct a careful, independent investigation of the property and verify all information. Any reliance on this information is solely at your own risk. CBRE and the CBRE logo are service marks of CBRE, Inc. All other marks displayed on this document are the property of their respective owners, and the use of such logos does not imply any affiliation with or endorsement of CBRE.