

# For Lease

125 W 71st Avenue

Vancouver, BC



STONEHAUS  
REALTY

32,974 SF (DEMISED) ON 0.98 ACRE LOT | INDUSTRIAL WAREHOUSE SPACE



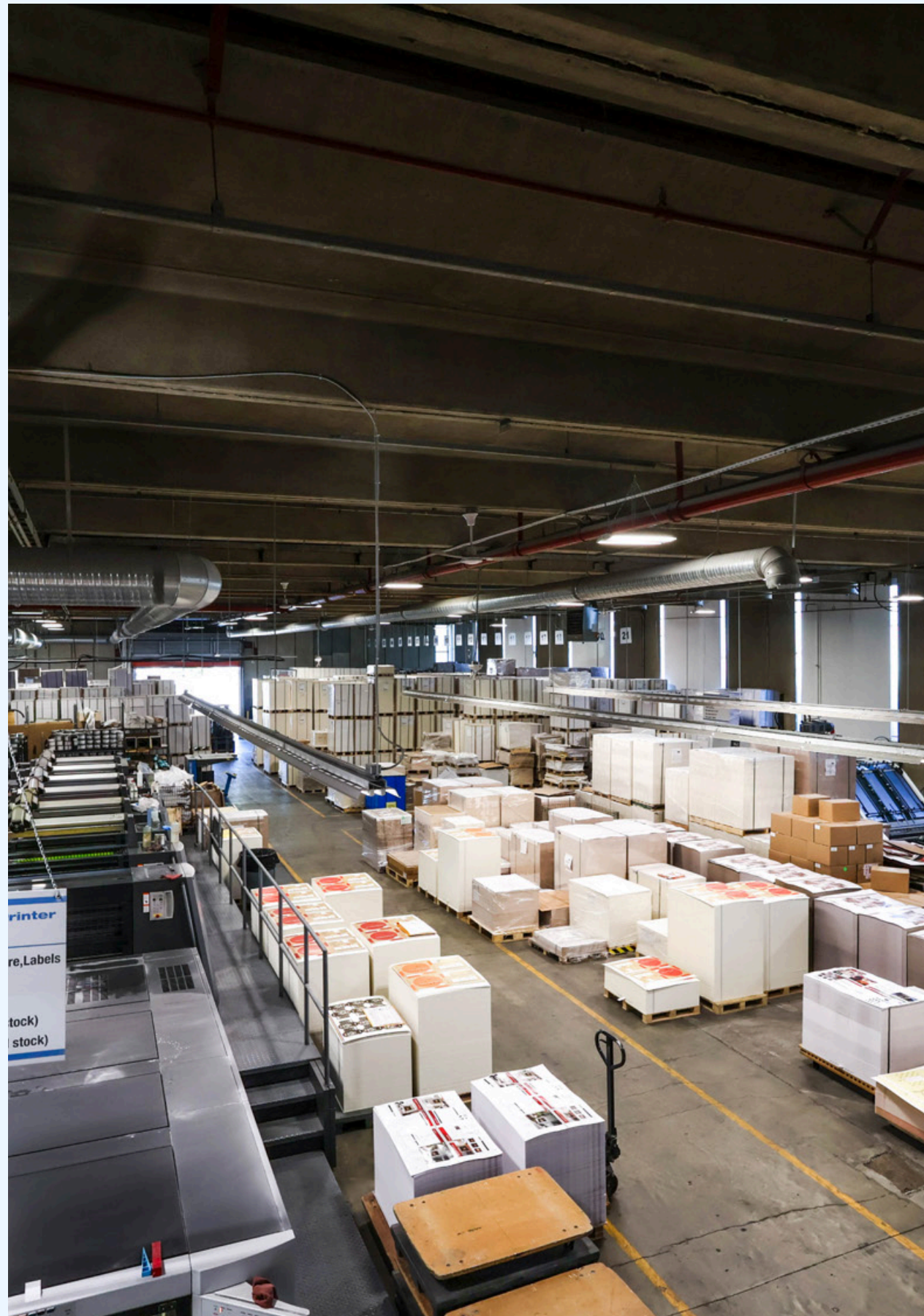

**THE OPPORTUNITY**

Iconic Properties Group presents the opportunity to lease 125 W 71st Avenue, a freestanding I-2 zoned industrial property in South Vancouver, one of the region's most land-constrained and strategically connected industrial districts. The property is currently configured as two units, offering flexibility to lease Unit A or Unit B individually, or secure the entire building. Featuring an efficient warehouse layout with approximately 20-foot clear height and approximately 13,500 SF of yard space, the property provides functional space for a range of industrial users seeking a strategic South Vancouver location.

**HIGHLIGHTS**



**FREESTANDING INDUSTRIAL OPPORTUNITY**

Lease Unit A or Unit B individually, or secure the full 32,974 SF building.



**FUNCTIONAL 32,974 SF LAYOUT**

Well-balanced warehouse, office, and mezzanine space across three levels, designed to support efficient operations and team workflow.



**EXPANSIVE 42,700 SF SITE WITH YARD AREA**

Approximate site dimensions of 427 ft x 100 ft, including ±13,500 SF of on-site yard and parking to accommodate vehicles, storage, and circulation.



**INDUSTRIAL-READY INFRASTRUCTURE**

I-2 zoning with heavy 3-phase electrical power, 1 grade-level loading doors, and 3 dock loading doors to support warehousing, distribution, and light manufacturing uses.



**STRATEGIC SOUTH VANCOUVER LOCATION**

Immediate access to Highway 91, Highway 99, YVR, and key arterial routes, enabling efficient regional and cross-border connectivity.



**TRANSIT-ACCESSIBLE FOR EMPLOYEES**

Walking distance to Marine Drive Station and close to Marine Gateway amenities, providing convenient access for staff and visitors.



# Property Overview

This freestanding industrial facility offers up to **32,974 SF of warehouse, office, and mezzanine space** on a **0.98 acre (42,700 SF) I-2 zoned site in South Vancouver**. The building is configured as **two units**, providing the flexibility to lease **Unit A** (approximately **15,000 SF**) or **Unit B** (approximately **17,974 SF**), or secure the entire premises. The property features an approximately **20-foot clear-height warehouse, ±13,500 SF of yard and front-site parking, 1 grade-level loading doors, 3 dock loading doors, and heavy 3-phase electrical service**. Originally constructed in **1963**, the building delivers functional circulation and versatile space suitable for a wide range of industrial users.

ADDRESS	125 W 71st Avenue, Vancouver, BC V5X 2X3
PID	014-141-272
ZONING	I-2
LOT DIMENSIONS & SIZE	427' x 100' 0.98 Acres (42,700 SF)
BUILDING SIZE	±15,000 SF (Unit A) ±17,974 SF (Unit B) <b>32,974 SF (Total)</b>
WAREHOUSE CLEAR HEIGHT	20'
GRADE DOORS	1
DOCK DOORS	3
PARKING	On-Site Parking Yard
PROPERTY TAX (2025)	\$145,511.00



# Location Overview

Strategically located in South Vancouver, 125 W 71st Avenue benefits from exceptional central connectivity within Metro Vancouver. The property is just a 3-minute drive or 15-minute walk to Marine Gateway Station, providing direct Canada Line access, and approximately a 25-minute drive to Downtown Vancouver. Vancouver International Airport is within a 10-minute drive, while Richmond's Brighouse district and Metropolis at Metrotown are easily accessible within 15 and 20 minutes.

Key Destination	Approx. Driving Time
1 Marine Gateway	3 minutes
2 Downtown Vancouver	25 minutes
3 YVR Airport	10 minutes
4 Richmond Brighouse	15 minutes
5 Metropolis at Metrotown	20 minutes
6 Annacis Island	30 minutes

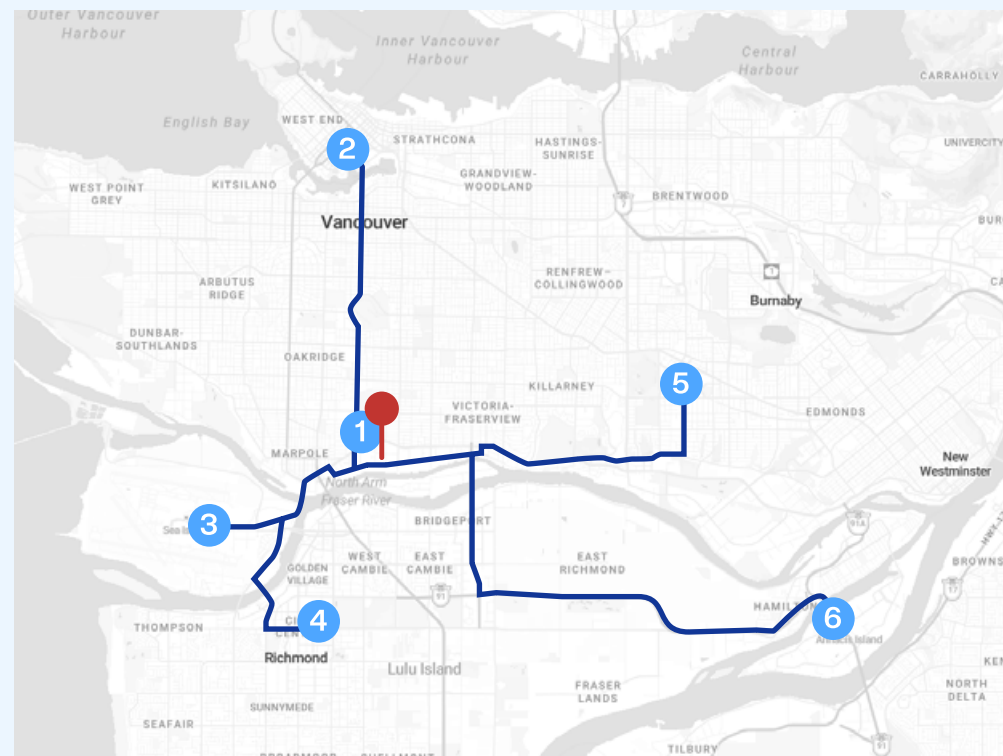
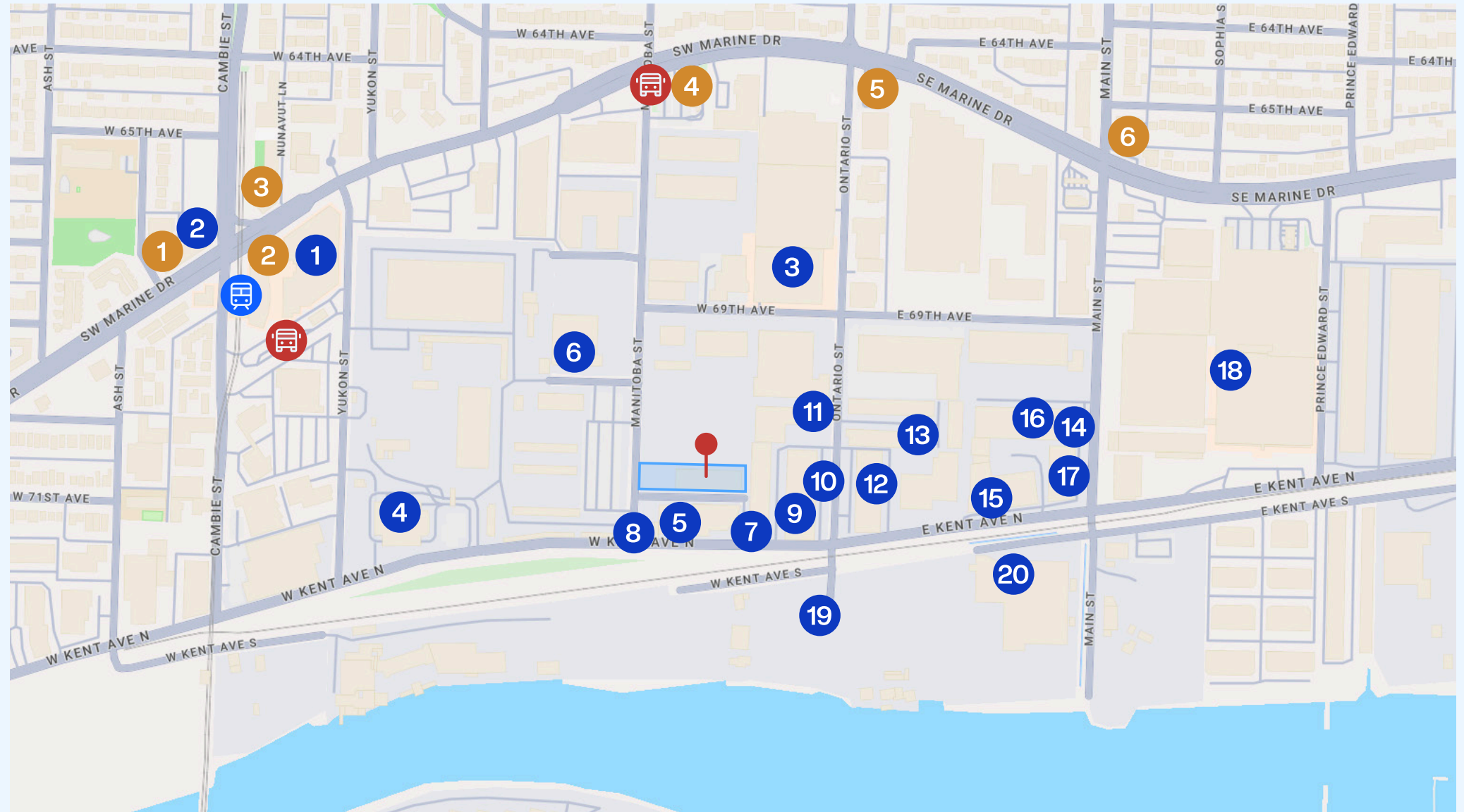

## RESTAURANTS & CAFES

1. JOY CAFE
2. Marine Gateway
  - a. A&W
  - b. Neptune Palace Seafood
  - c. Kinton Ramen
  - d. Tim Hortons
  - e. Starbucks
  - f. Dublin Crossing
  - g. Subway
3. Bubble Waffle Cafe
4. McDonald's
5. Wendy's
6. Hi Five Chicken

## RETAIL & SERVICES

1. Marine Gateway
  - a. BMO Bank of Montreal
  - b. CIBC
  - c. TD Canada Trust
  - d. RBC Royal Bank
  - e. T&T Supermarket
  - f. Shoppers Drug Mart
2. Scotiabank
3. Canadian Tire
4. Vancouver Transfer Station
5. Mainland Automotive Collision Ltd
6. Kent Metal Products Ltd
7. Kelvin Glass
8. Eburne Hauling & Loading
9. Dispensary Supply Canada
10. PJ Cabinets
11. Eatern Ltd.
12. Terra Doors Ltd
13. Inter Source Trading Corp
14. Designers Resource Centre
15. Burroughs Printing
16. Magnum Frames
17. The Empire Music Co Ltd
18. Real Canadian Superstore
19. Westcoast Cellufibre Division
20. Lionsgate Scaffolding

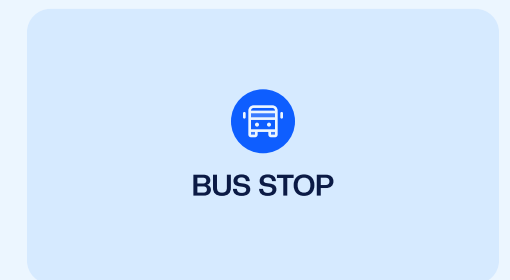
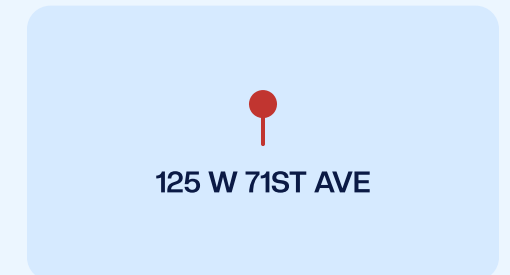

# Floor Plan

SECOND FLOOR

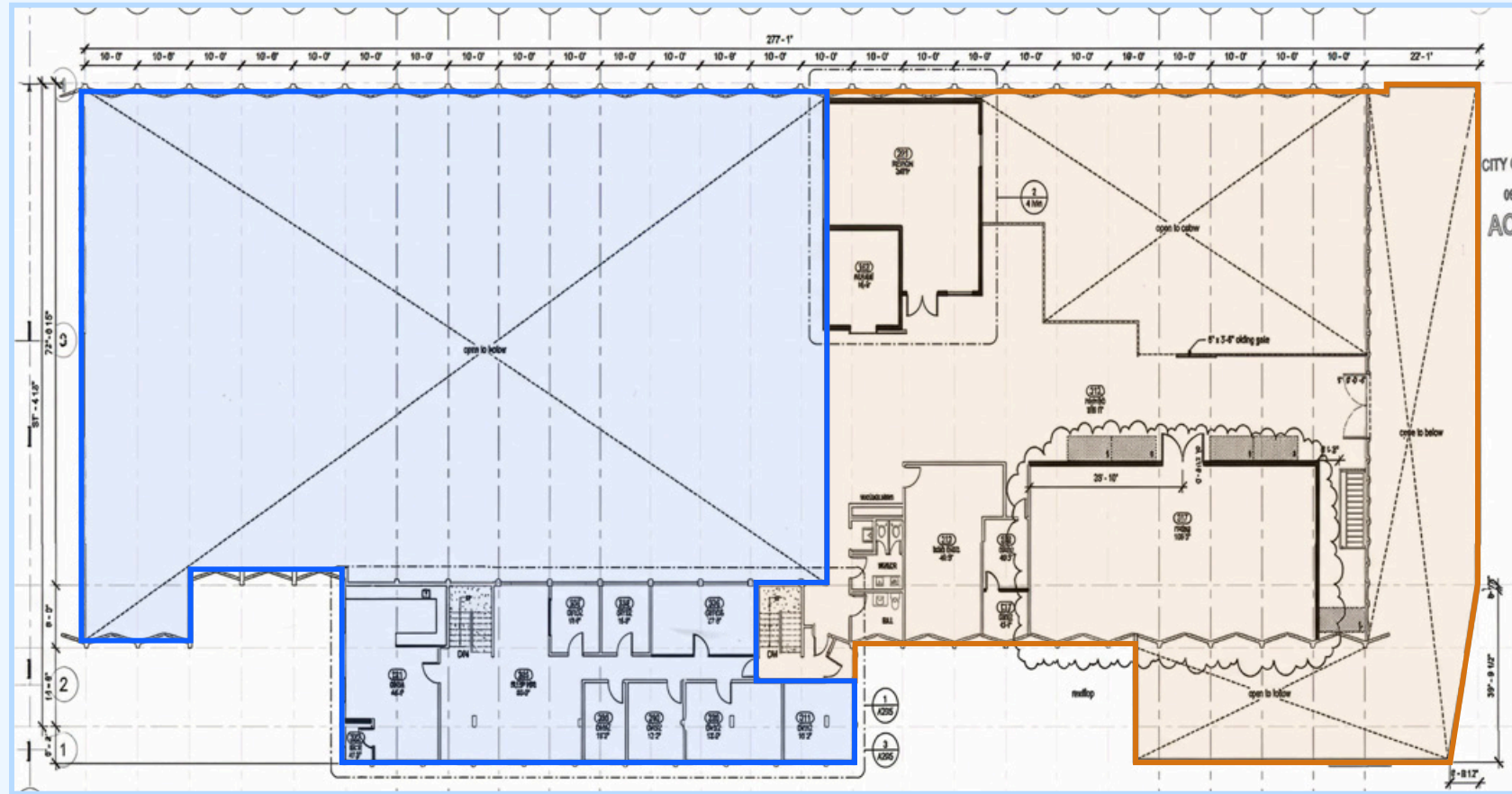

GROUND FLOOR

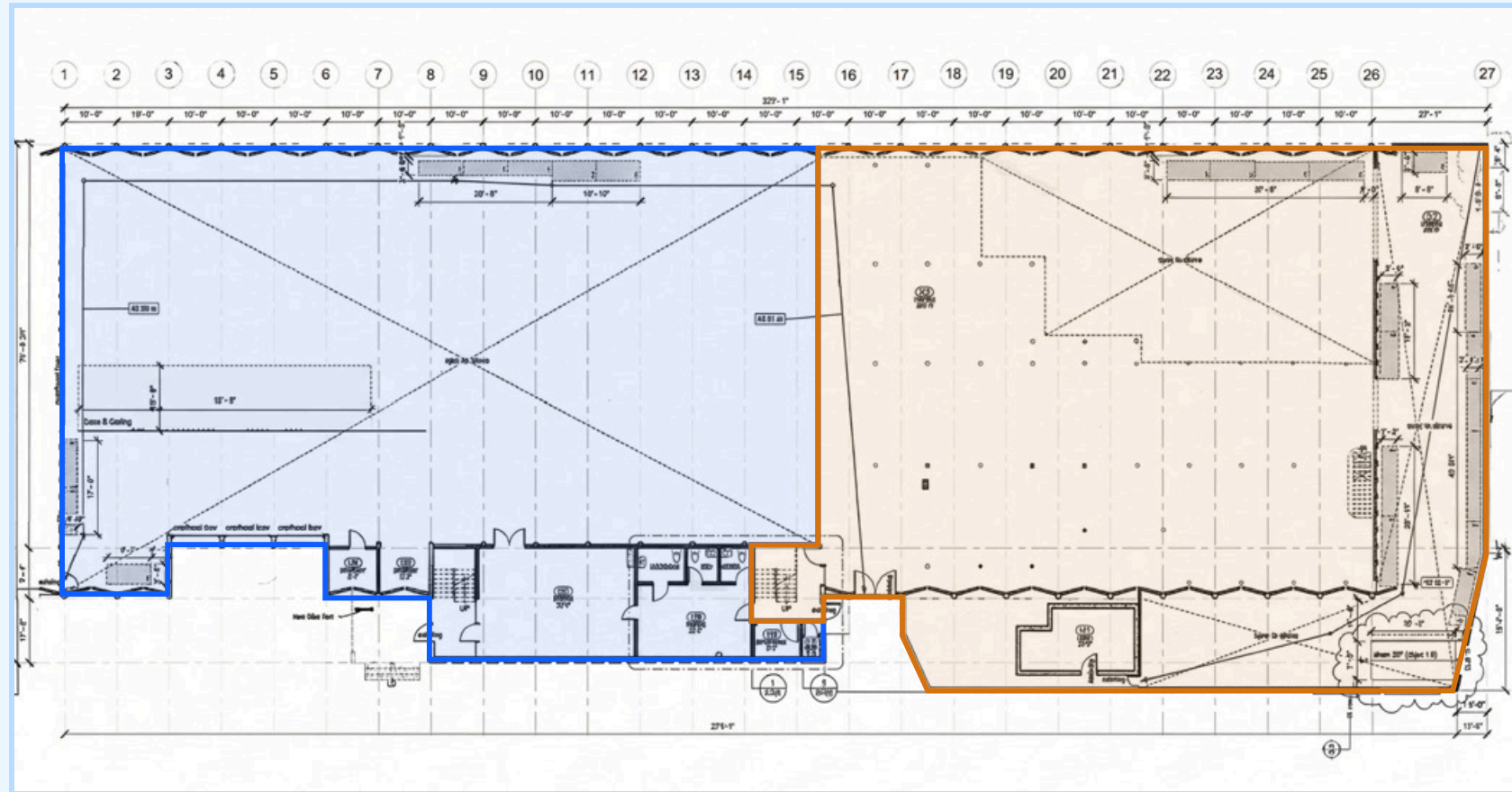

-  UNIT A
-  UNIT B

# Gallery

## UNIT A



## UNIT B





STONEHAUS  
REALTY

WWW.ICICONIC.COM

**Khash Raeisi\***, Founder  
(778) 987-7029  
khash@iciconic.com

*\*Personal Real Estate Corporation*

# NOTHING BUT ICONIC

Copyright © 2025 Iconic Properties Group by Stonehaus Realty. This document has been prepared by Iconic Properties Group for advertising and general information only. Iconic Properties Group makes no guarantees, representations or warranties of any kind, expressed or implied, regarding the information including, but not limited to, warranties of content, accuracy and reliability. Any interested party should undertake their own inquiries as to the accuracy of the information. Iconic Properties Group excludes unequivocally all inferred or implied terms, conditions and warranties arising out of this document and excludes all liability for loss and damages arising therefrom. This publication is the copyrighted property of Iconic Properties Group and/or its licensor(s).