

# 147,600 SF

**1119 West Middlesex Avenue  
Port Reading, NJ 07064**

Prologis Port Reading

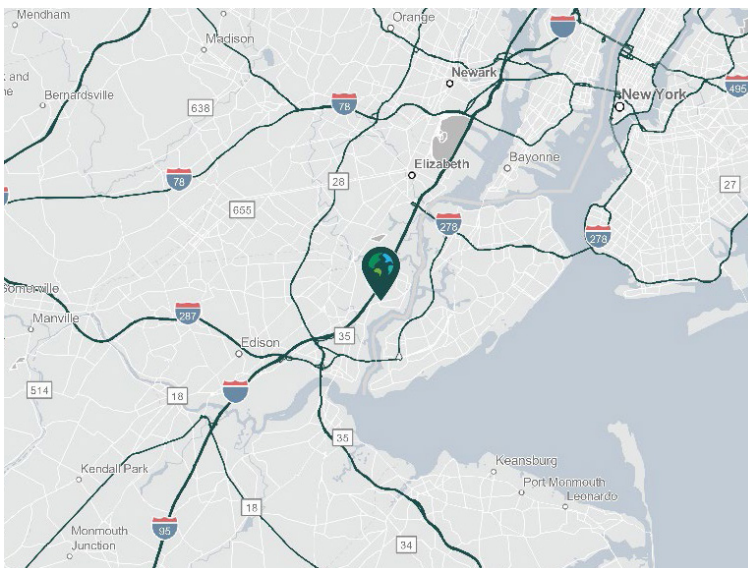

- Access to Exit 12 of the NJ Turnpike
- ±12 miles from Newark Liberty International Airport and Port Newark-Elizabeth
- NJ TRANSIT 116 & 48 bus stops along Port Reading Avenue

## Property Features

Available Space	147,600 SF
Available Office Space	1,783 SF
Clear Height	36'
Column Spacing	56' x 50'
Dock Doors	25
Drive-in Doors	1 (12' x 14')
Trailer Parking Spaces	38
Car Parking Spaces	56
Electrical Service	600 amps, 3 phase, 480/277 v
Sprinkler	ESFR
Lighting	LED motion sensor
Foreign Trade Zone	No. 49



Unlock the full potential of your warehouse with one strategic, single-source partner.

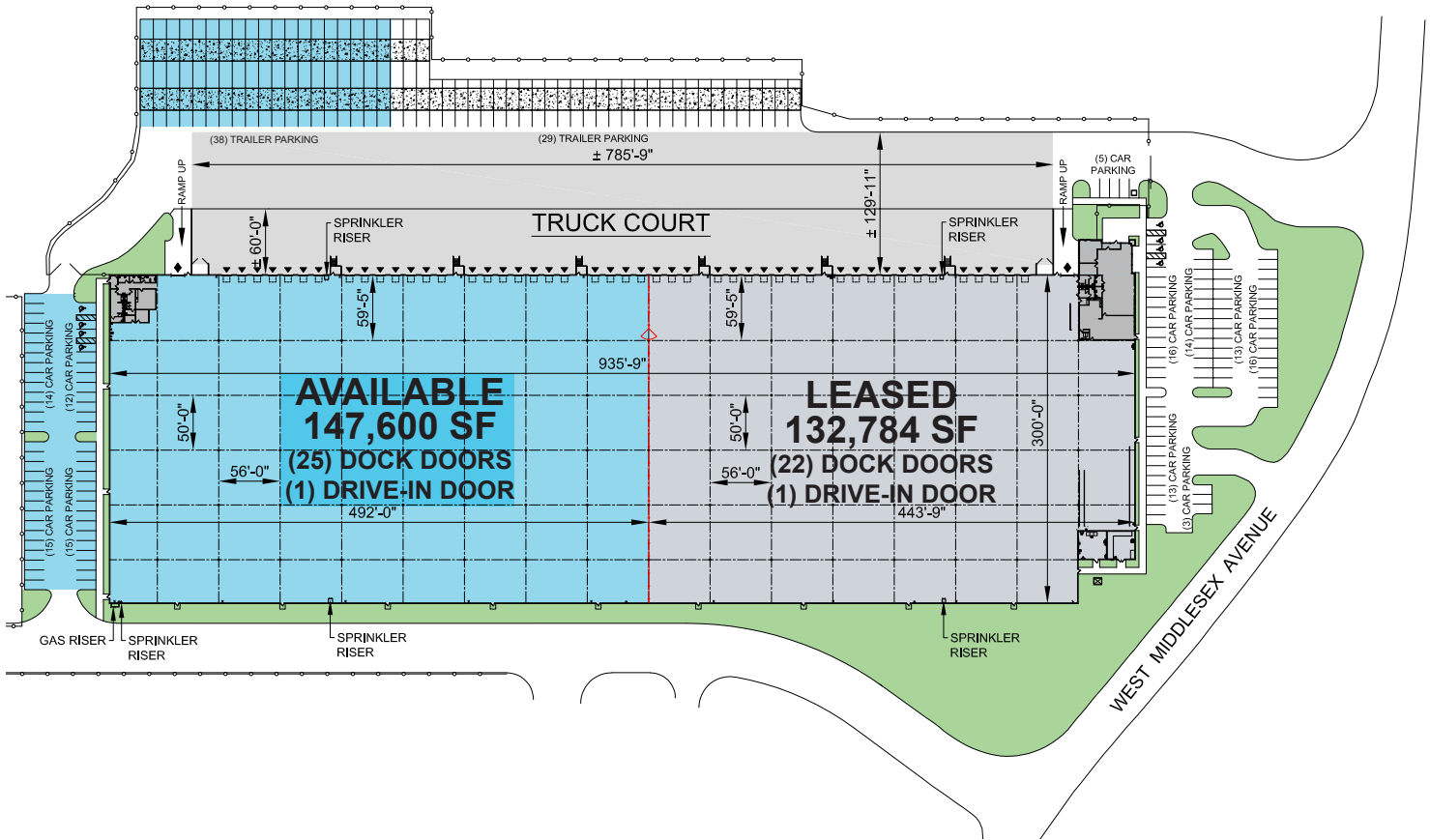

- LEASED
- AVAILABLE
- LAND
- DOCK DOOR
- DRIVE-IN DOOR

[PLDPortReading.com](http://PLDPortReading.com)



**CBRE, Inc.**  
**Thomas F. Monahan**  
 thomas.monahan@cbre.com  
 ph +1 201 712 5610

**CBRE, Inc.**  
**Larry Schifffenhau**  
 larry.schifffenhau@cbre.com  
 ph +1 201 712 5809

**CBRE, Inc.**  
**Brian Golden**  
 brian.golden@cbre.com  
 ph +1 201 712 5607

**Prologis**  
**Paul Rosen**  
 prosen@prologis.com  
 ph +1 201 635 6013  
 prologis.com