



9500 W. 49th Avenue Wheat Ridge, CO 80033

I-70 Business Park is a first-class business park located at I-70 and Independence offering excellent access, visibility and signage opportunities. This heavily landscaped business park offers office, showroom and flex spaces with flexible layout opportunities and a diverse tenant mix.

Highlights

Available SF:	4,721-14,235 SF
Office SF:	Varies per Unit
Base Rent:	\$11.50/SF NNN
2021 NNN:	Varies per Building
Loading:	Dock High & Drive-In
Clear Height:	18'-0"
Sprinkler:	Yes/Wet
Parking:	2.9:1,000
Power:	277/480V, 3-Phase
Zoning:	PID



9500 W. 49th Avenue Wheat Ridge, CO 80033

Space Plan

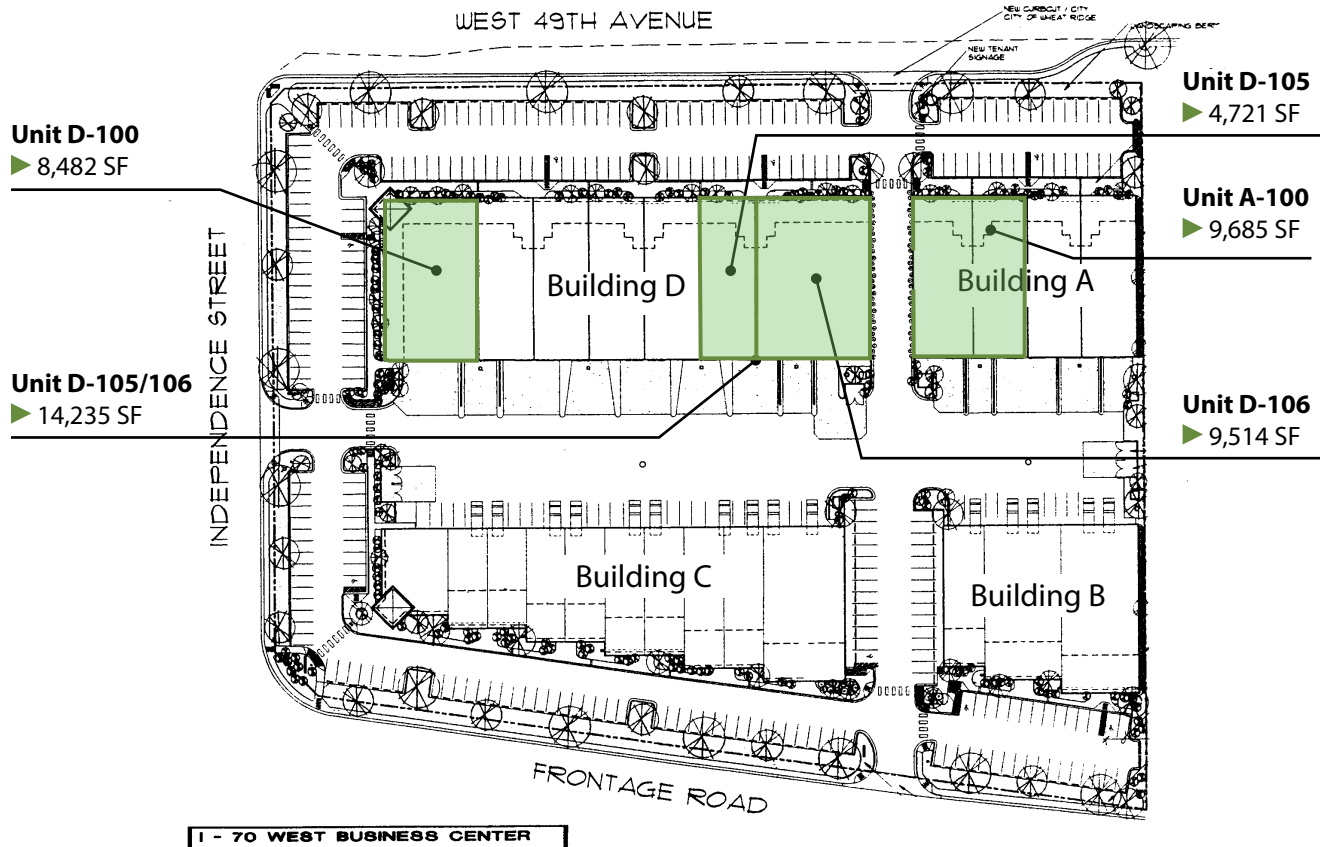

Broker Contact

T.J. Smith, SIOR
(303) 283-4576
tj.smith@colliers.com

Matt Keyerleber
(720) 284-7100
matt.keyerleber@colliers.com



www.colliers.com

Owner Contact

John Strabel
Regional Director
8200 Park Meadows Drive
Unit 8226
Lone Tree, CO 80124
Direct: (248) 894-3974
jstrabel@firstindustrial.com



www.firstindustrial.com