

Flood plain study

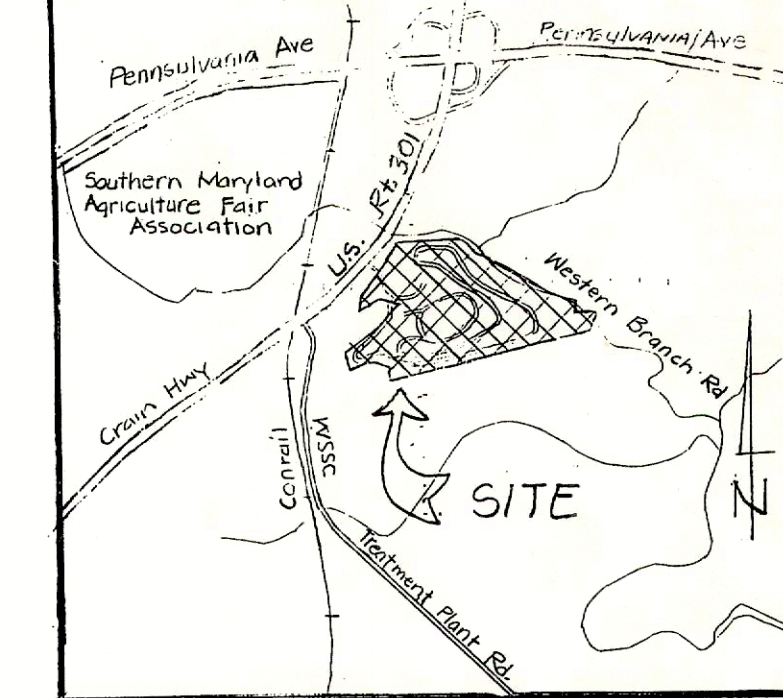

VICINITY MAP
Scale 1" = 2000'

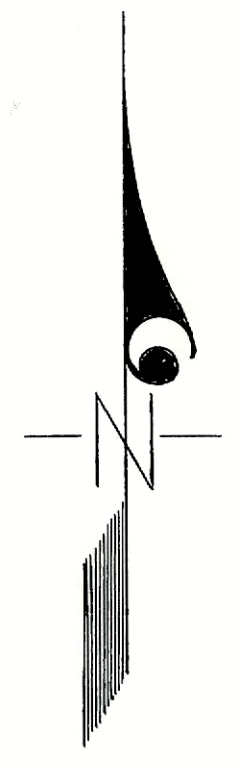
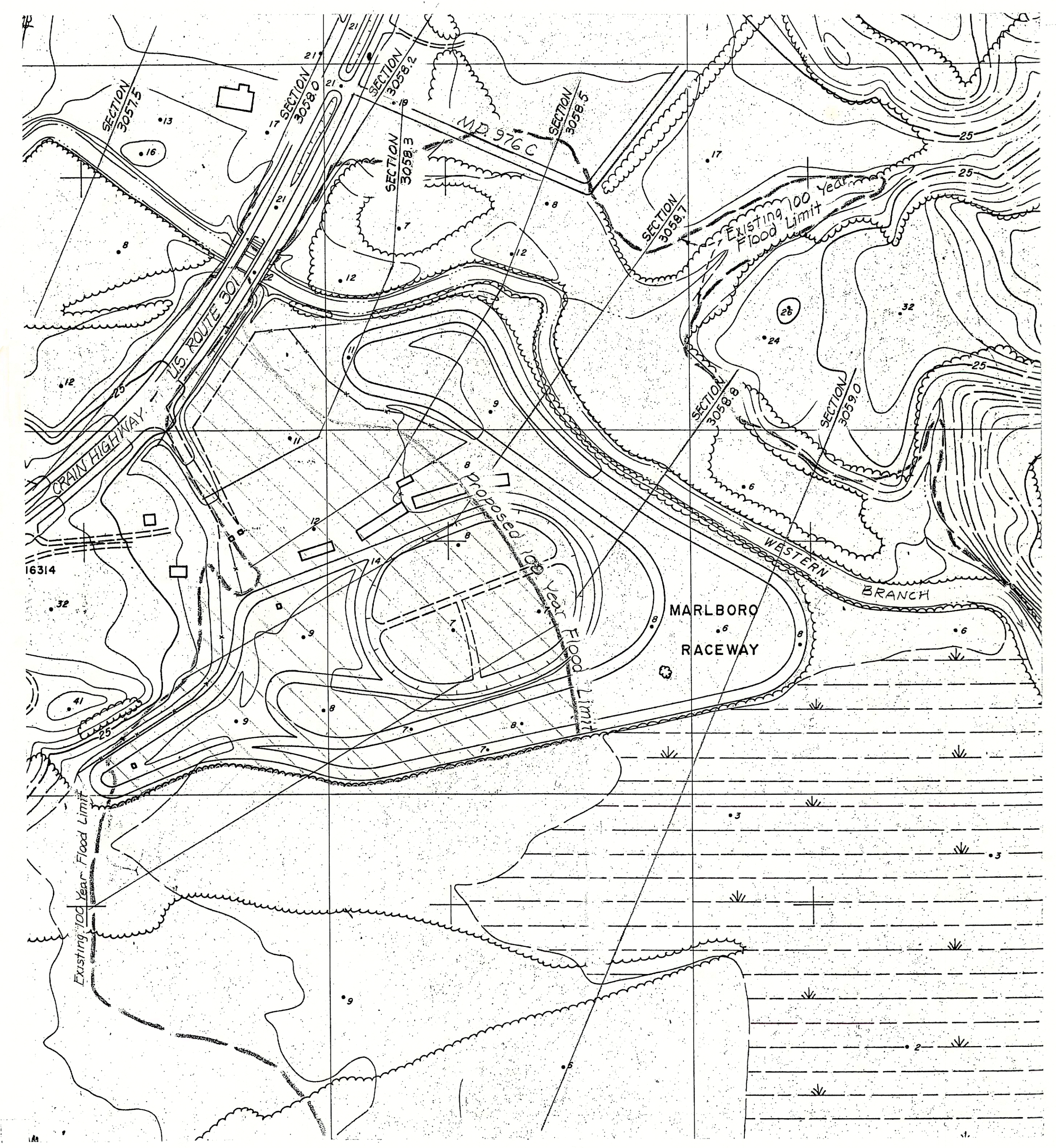

NOTES:
1. This is an exhibit to a report entitled THE EFFECT OF RECLAIMING A PORTION OF WESTERN BRANCH'S FLOOD PLAIN AT THE OLD MARLBORO RACEWAY

LEGEND

	AREA OF CUT
	AREA OF FILL
	PROPOSED INEFFECTUAL FLOW AREA
	EXISTING 100 YEAR FLOOD LIMIT
	PROPOSED 100 YEAR FLOOD LIMIT

FLOOD PLAIN STUDY
MARLBORO RACEWAY
MARLBORO DISTRICT NO 3
PRINCE GEORGE'S COUNTY, MARYLAND

Sheet 1 of 2 See Drawg No 8-003-Y for Sheet 2/2

12-26-84	Revise Flood Plain to Leave Undisturbed Stream bank in Place & Excavate Wetland Behind		
DATE	DESCRIPTION	BY	REVISIONS

ONE METRO PLAZA
8100 PROFESSIONAL PLACE, LANDOVER, MARYLAND 207
BEN DYER ASSOCIATES, INC.
Engineers / Surveyors / Planners
TELEPHONE (301) 455-9200

DRAWN BY: SER
CHECKED BY: J-69059
SCALE: 1" = 200'
DATE: Nov 1983
RECORD NO: 8-002-Y

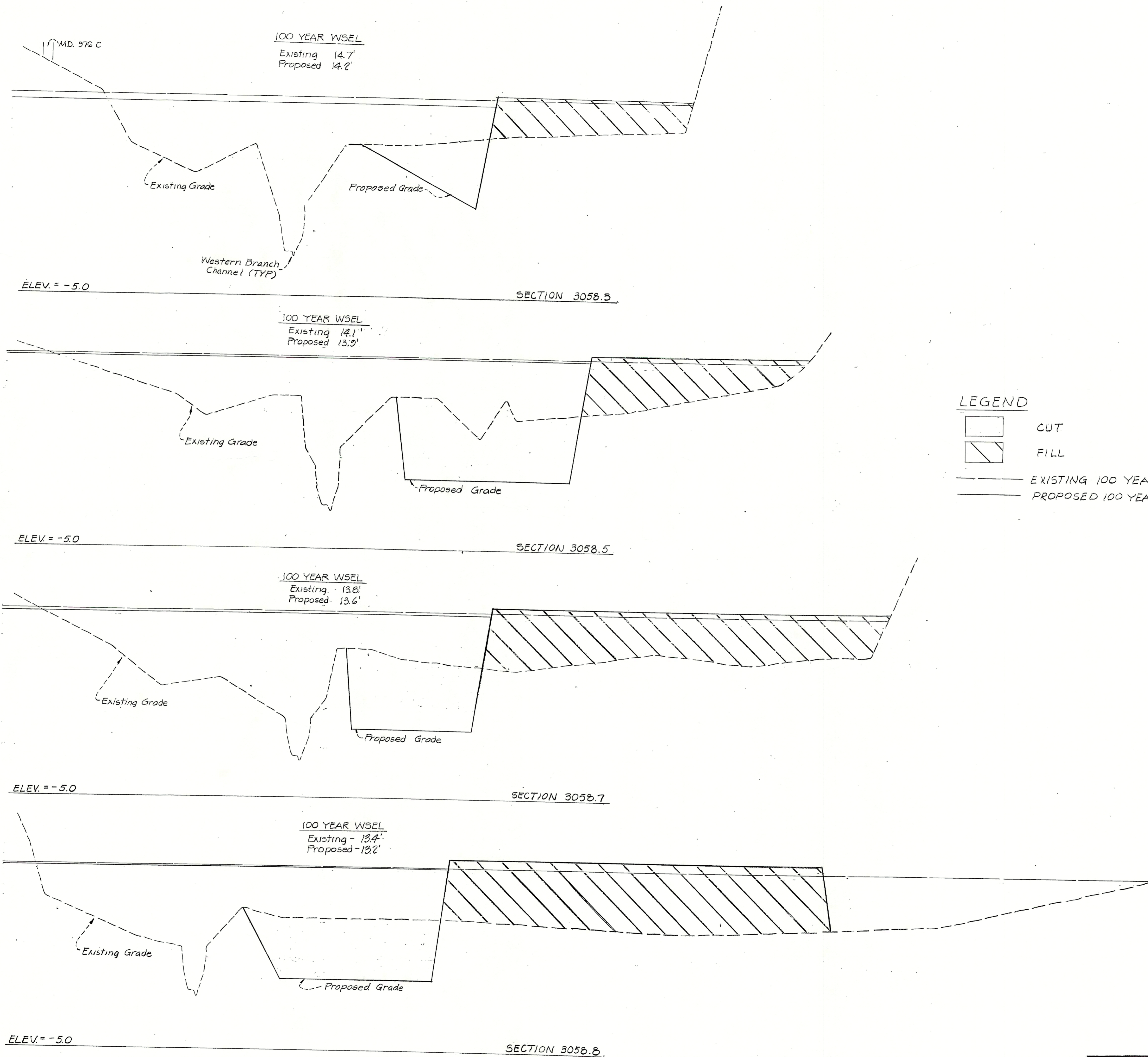

100 YEAR WSEL
Existing 14.7'
Proposed 14.2'

Western Branch Channel (TYP)

ELEV. = -5.0

SECTION 3058.3

100 YEAR WSEL
Existing 14.1'
Proposed 13.9'

ELEV. = -5.0

SECTION 3058.5

100 YEAR WSEL
Existing 13.8'
Proposed 13.6'

ELEV. = -5.0

SECTION 3058.7

100 YEAR WSEL
Existing 13.4'
Proposed 13.2'

ELEV. = -5.0

SECTION 3058.8

LEGEND

SCALE: Vertical - 1" = 5'
Horizontal - 1" = 100'

FLOOD PLAIN STUDY
MARLBORO RACEWAY
MARLBORO DISTRICT, NR 3
PRINCE GEORGE'S COUNTY, MARYLAND

Sheet 2 of 2 See Drawg B-002-Y For Sheet 1/2

12-26-84	Revised to Denote New Flood Plain Cross Sections	ONE METRO PLAZA 910 PROFESSIONAL PLACE, LANDOVER, MARYLAND 20785 ENGINEERS / SURVEYORS / PLANNERS BEN DYER ASSOCIATES, INC. TELEPHONE (301) 458-8200
DATE	DESCRIPTION	BY
	REVISIONS	