

Winter Garden Commerce Center
661 Garden Commerce Parkway
Winter Garden, FL 34787



For Lease
Suite 170 - 3,234 SF warehouse space



Property Overview

Space Highlights

Building Size

28,306 SF

Available Premises

3,234 SF

Availability Date

Aug 2026

Premises specifications

Warehouse area

3,234 SF

Building Depth

80'

Office Space

0 SF

Lighting

LED

Dock Doors

0

Sprinklers

ESFR

Grade Doors

2

Car Parking Ratio

2.28/1,000 SF

Loading

Rear

Truck Court

140' shared

Clear Height

20'

Rent

Please call for pricing

The Property

Winter Garden Commerce Center is located in the NW Orange industrial submarket and provides immediate access to the Western Beltway (State Road 429), Florida's Turnpike, and East-West Expressway (State Road 408).

Available Leased

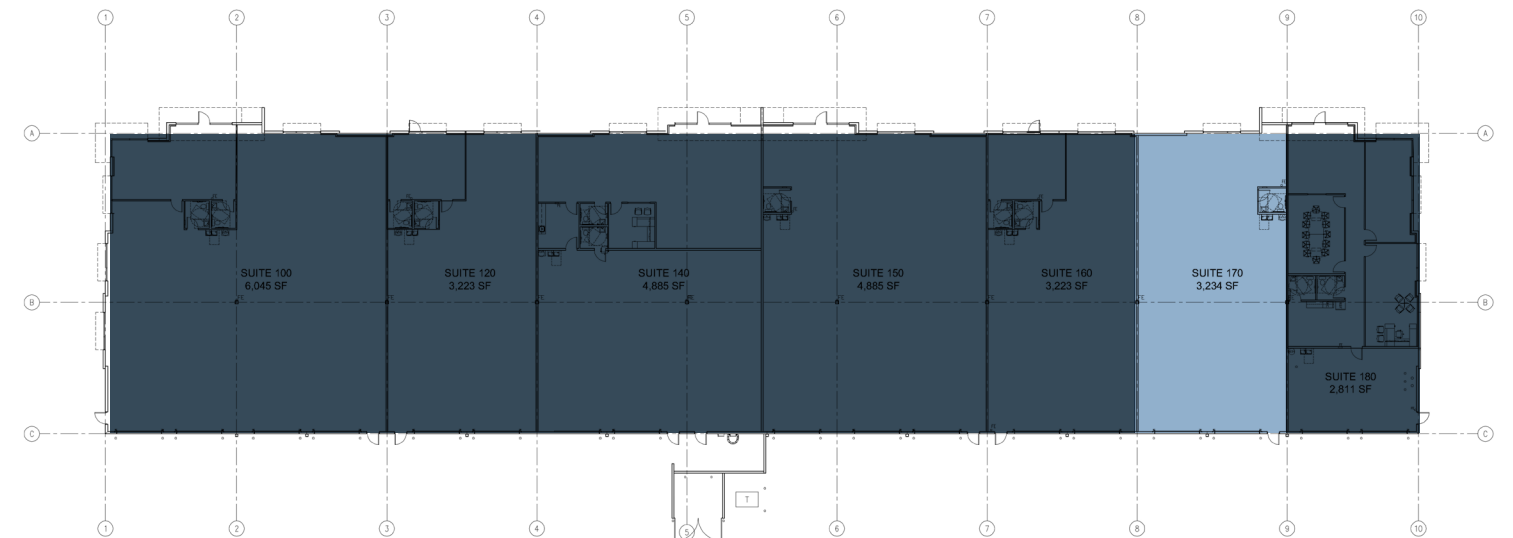

Location

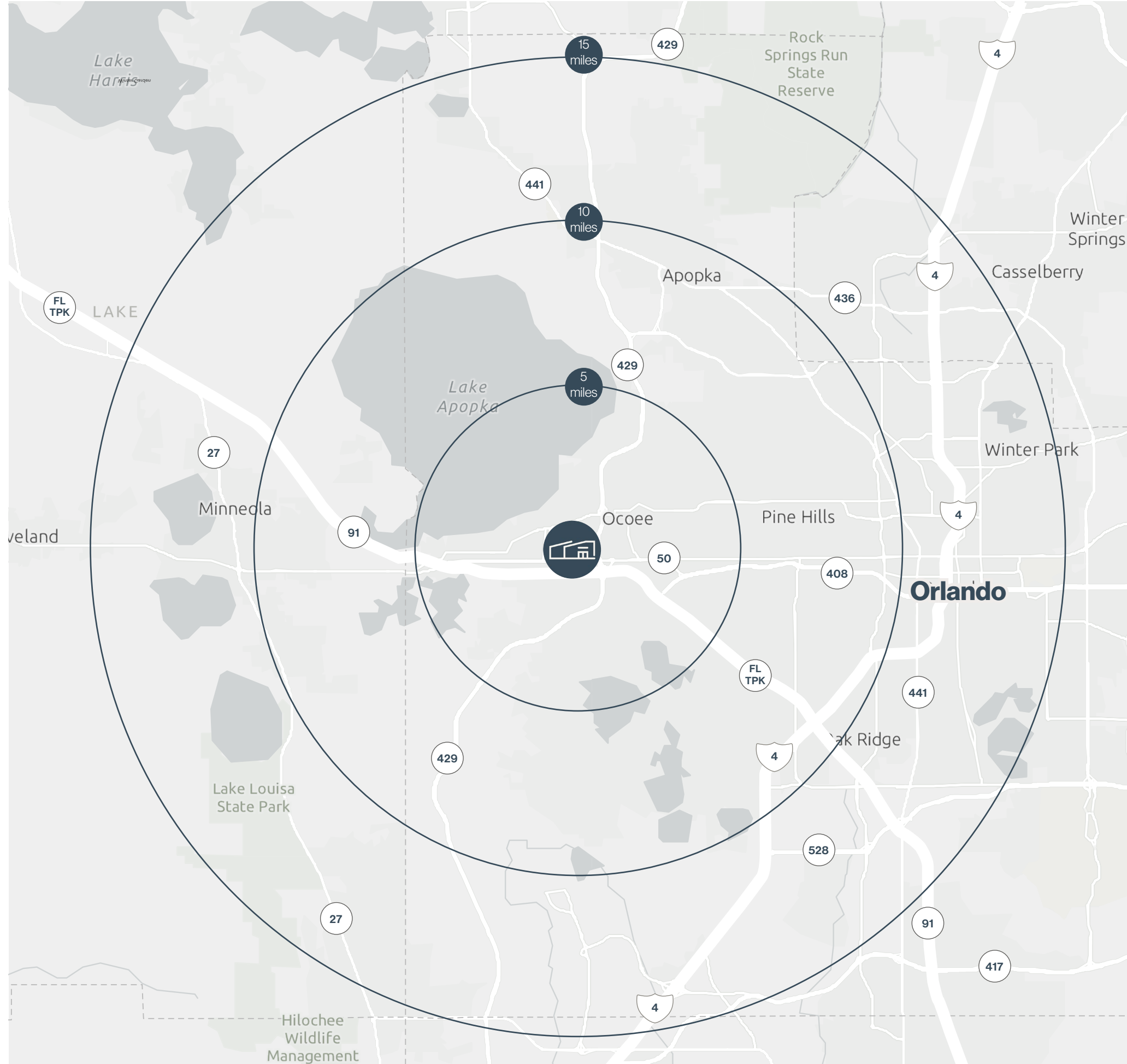

Public Transportation

Airports

Orlando International Airport
22.7 mi (27 min)

Orlando Sanford International Airport
40.0 mi (42 min)

Regional Truck Routes

- Interstate 4 (I-4)
- Florida's Turnpike (SR 91)
- SR 417 (Central Florida GreeneWay)
- SR 528 (Beachline Expressway)
- SR 429 (Western Beltway)

Orlando Designated Truck Routes

- SR 50 (Colonial Drive)
- SR 408 (East-West Expressway)
- U.S. 441 (Orange Blossom Trail)

Our Story

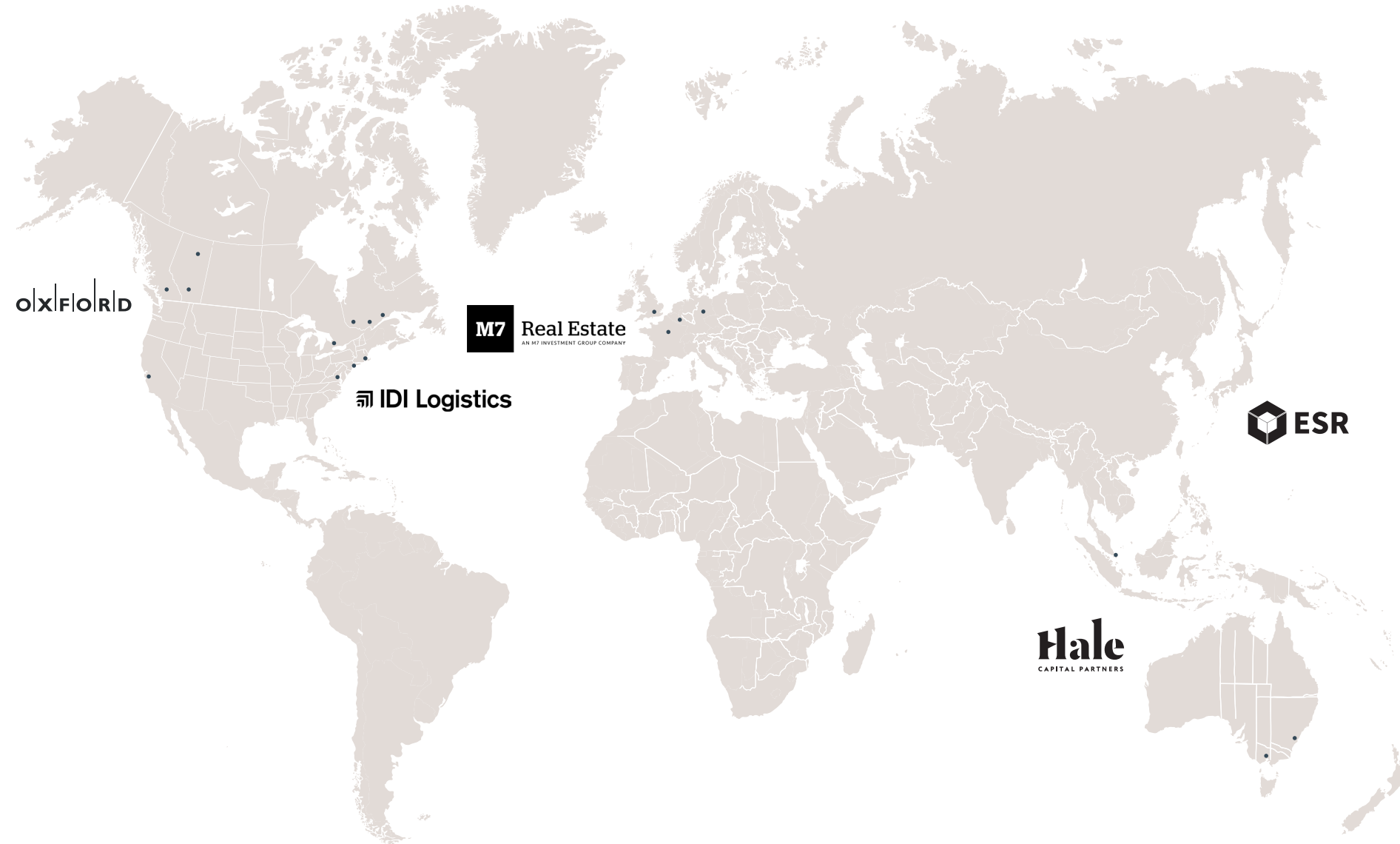

A growing, evolving Industrial portfolio

We are investing, building and buying the physical infrastructure to deliver solutions to serve the global supply chain.

Our global industrial and logistics portfolio includes high-quality warehouse, manufacturing, and distribution facilities with a robust global development pipeline. We are committed to elevating expectations of the sector, delivering sustainable, high-functioning, and flexible spaces. We continually strive to do better - finding ways to meaningfully adapt and future-proof our assets. Our state-of-the-art properties are located in major consumption and critical supply chain nodes across North America, Europe and Asia Pacific.

98.4 M
SF Global Portfolio

\$24.5B
AUM

14.1M
SF under development

About Oxford Properties

We are a leading global real estate investor, developer, and manager. Our global portfolio includes office, life sciences, industrial, retail, multifamily, hotels & alternatives and credit assets on four continents.

Our competitive advantage lies in our end-to-end- capabilities, powered by combining global knowledge with local trends and experience. Generating meaningful returns for our stakeholders. Strengthening economies and communities through real estate.

Connect with us

Cameron Montgomery

Executive Vice President
+1 407 473 4906
Cameron.Montgomery@jll.com

Matthew Halpin

Associate
+1 407 709 4788
Matthew.Halpin@jll.com

Bobby Isola, SIOR, CCIM

Executive Managing Director
+1 407 930 1804
Bobby.Isola@jll.com

