

OFFERING MEMORANDUM



GODWIN MARKETPLACE
3090-3098 Godwin Boulevard
Suffolk, VA 23434

TABLE OF CONTENTS



- I. EXECUTIVE SUMMARY**
 - Executive Summary 4
 - Investment Highlights 5
 - Location Map 6
 - Aerial Photos 7

- II. PROPERTY DESCRIPTION**
 - Property Description 12
 - Lease Summary 13
 - Tenant Overview 14
 - Merger Overview 15

- III. MARKET OVERVIEW**
 - Virginia Beach Market Overview 18
 - Demographics 19



R. Troy Parker
Managing Broker/Partner
Parker Burnell Real Estate Group
1436 South Independence Blvd., Suite 200
Virginia Beach, Virginia 23462
(O) 757.222.0111
(F) 757.222.9455
(M) 757.407.9499
troy@parkerburnell.com

Jay Burnell
Partner | Development & Brokerage
Parker Burnell Real Estate Group
1436 South Independence Blvd., Suite 200
Virginia Beach, Virginia 23462
(O) 757.222.0111
(F) 757.222.9455
(M) 757.617.3511
jay@parkerburnell.com

EXECUTIVE SUMMARY

GODWIN MARKETPLACE | SUFFOLK, VIRGINIA



EXECUTIVE SUMMARY



PURCHASE PRICE: \$10,879,895.65

CAP RATE: 5.75%

NOI: \$ 658,520.00

VACANCY (5%): (\$ 32,926.00)

ADJUSTED NOI: \$ 625,594.00

Parker Burnell is pleased to offer to qualified investors Godwin Marketplace, a ±10,797 SF building featuring two (2) ground leased outparcels (15+ years) situated on 4.201 acres of land in the affluent Planter's Station submarket of Suffolk, VA. The property is situated on the heavily trafficked Godwin Boulevard with excellent visibility - over 32,704 VPD. This Center is located across the street from a new Publix-anchored center and less than a 1/2 mile from Sentara Obici Hospital.

Godwin Marketplace is centrally located within one (1) mile from Route 58 & Route 460 in Suffolk, in a moderately populated area with over 51,232 people living within a 5-mile radius of the property. It is one of Virginia's fastest-growing cities, projected to exceed 100,000 residents before the end of 2026 and housing is expected to grow 9.20% by 2030.

Suffolk's transportation infrastructure includes several major highways, including US 13, 17, 58, 258, and 460, and is served by Interstate 664, part of the Hampton Roads Beltway. The property is located in Virginia's second largest city by land area and the 14th largest in the United States, covering 400-430 square miles.

It has three freight railroads and is being considered for a potential branch line of the Southeast High Speed Rail Corridor. Suffolk Transit provides local bus service, with connections to Hampton Roads Transit. The Monitor-Merrimac Memorial Bridge-Tunnel connects Suffolk to Newport News across the Hampton Roads harbor.

LOCATION MAP

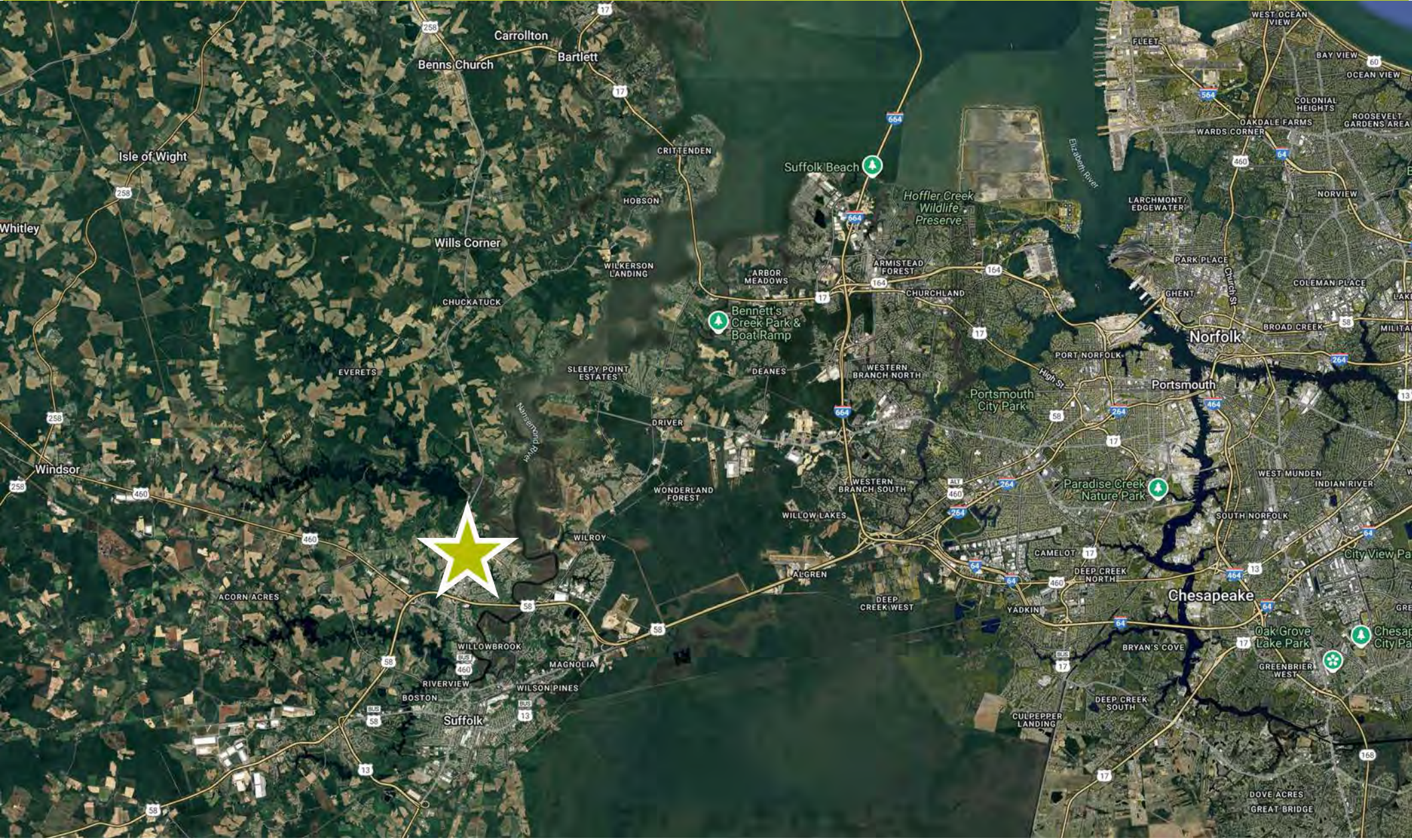

AERIAL (1 MILE)

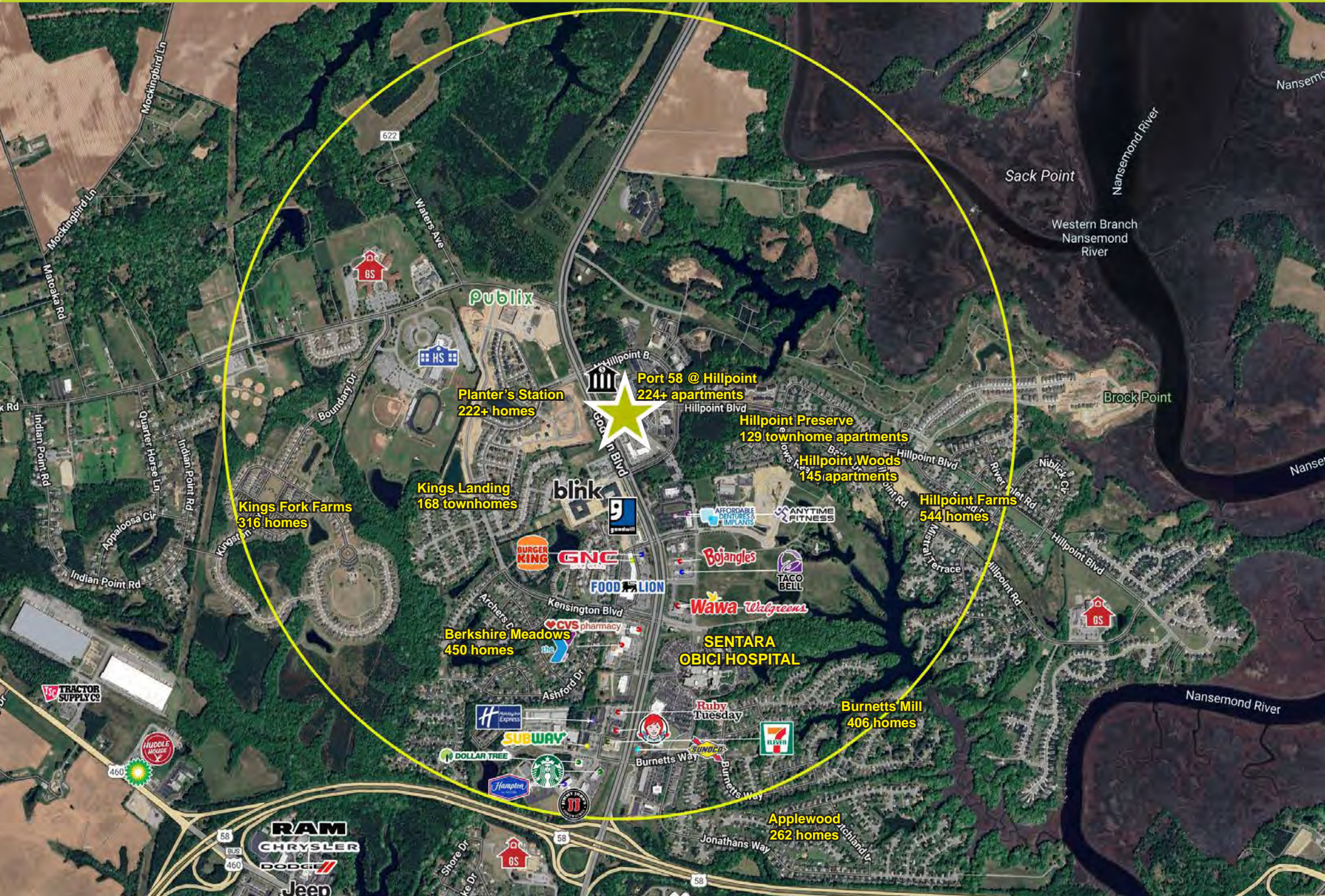

Kings Fork Farms
316 homes

Kings Landing
168 townhomes

Planter's Station
222+ homes

Port 58 @ Hillpoint
224+ apartments

Hillpoint Preserve
129 townhome apartments

Hillpoint Woods
145 apartments

Hillpoint Farms
544 homes

Berkshire Meadows
450 homes

**SENTARA
OBICI HOSPITAL**

Burnetts' Mill
406 homes

Applewood
262 homes



AERIAL (3 MILE)



AERIAL PHOTO (SOUTH)

**SENTARA
OBICI HOSPITAL**

**Berkshire Meadows
450 homes**

**The Gallery @ Godwin
255 apartments**

**Kings Landing
168 townhomes**

**Port 58 @ Hillpoint
224+ apartments**

New Media Systems, Inc.
804.359.3620
www.newmediasystems.net

AERIAL PHOTO (XWEST)



Planter's Station
222+ homes

Kings Fork High School



Publix



Port 58 @ Hillpoint
224+ apartments

SITE PLAN

LAYOUT KEY NOTES	
1	GRID CUBE
2	GRID CURB
3	4" THICK CONCRETE BURNING
4	CURVE AWKWARD
5	3" WIDE CONCERNABLE
6	OUTDOOR PATIO AREA
7	COURTYARD PAD (IN ENCLOSURE)
8	CONCRETE SHIMMER BLANK
9	8" WIDE PARKING SPAN ACCESS
10	HANDICAP SIGN (W/ CONCRETE PARKING BORDER)
11	HANDICAP SIGN (W/ DIRECTIONAL ARROW)
12	PAVING 10'x10' (W/ DIRECTIONAL ARROW)
13	PAVING 10'x10' (W/ DIRECTIONAL ARROW)
14	PAVING 10'x10' (W/ DIRECTIONAL ARROW)
15	PAVING 10'x10' (W/ DIRECTIONAL ARROW)
16	PAVING 10'x10' (W/ DIRECTIONAL ARROW)
17	PAVING 10'x10' (W/ DIRECTIONAL ARROW)
18	PAVING 10'x10' (W/ DIRECTIONAL ARROW)
19	PAVING 10'x10' (W/ DIRECTIONAL ARROW)
20	PAVING 10'x10' (W/ DIRECTIONAL ARROW)
21	PAVING 10'x10' (W/ DIRECTIONAL ARROW)
22	PAVING 10'x10' (W/ DIRECTIONAL ARROW)
23	PAVING 10'x10' (W/ DIRECTIONAL ARROW)
24	PAVING 10'x10' (W/ DIRECTIONAL ARROW)

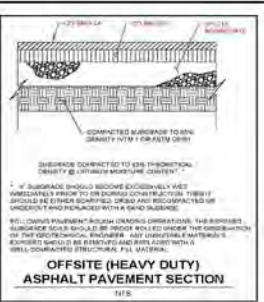
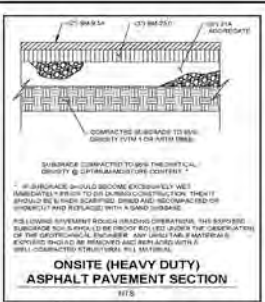
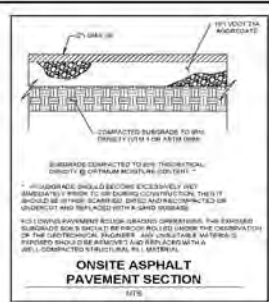
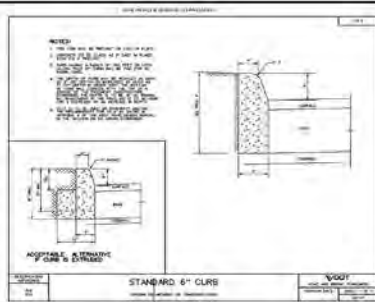

PAVEMENT LEGEND	
	ON SITE LIGHT DUTY PAVEMENT
	OFF SITE HEAVY DUTY PAVEMENT
	ON SITE HEAVY DUTY PAVEMENT
	MILL & OVERLAY
	CONCRETE PAVEMENT

GADDY

 ENGINEERING SERVICES LLC

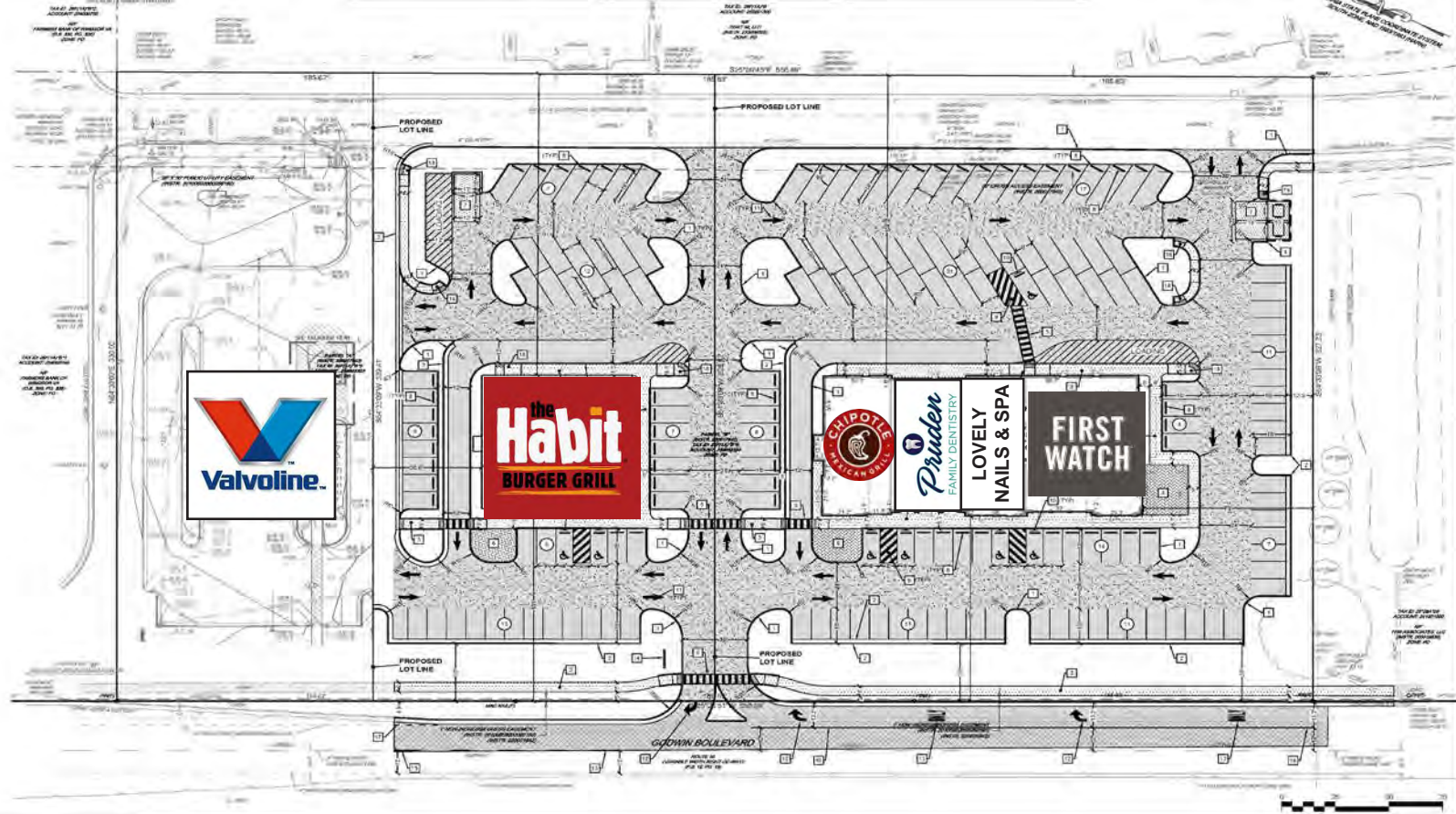

LAYOUT PLAN
 FOR
 GODWIN MARKETPLACE
 PARCELS B & C, HILLPOINT FARMS, INSTR. #200017943
 3098, 3094, & 3090 GODWIN BLVD
 SUFFOLK, VIRGINIA

C4
 SCALE: 1" = 30'

RENDERINGS



PROPERTY DESCRIPTION

GODWIN MARKETPLACE | SUFFOLK, VIRGINIA



PROPERTY DESCRIPTION



Constructed in 2025, Godwin Marketplace is a ±10,797 SF building with two (2) outparcels situated on 4.201 acres of land in the affluent Planter's Station submarket of Suffolk, VA.

This development provides a unique opportunity for investors to acquire an asset in a rapidly growing area in Suffolk, Virginia. Over 51, 232 people are living within a five mile radius of the property. Average household income within a three mile radius exceeds \$130,634.

In addition to the high average household incomes, the median value of homes are \$330,763 within a one mile radius increasing to \$363,635 within a three mile radius.

Key tenants include Valvoline, The Habit Burger Grill, Chiptole, Pruden Family Dentistry, Queen's Nail Spa by Linh, and First Watch.

LEASE SUMMARY

TENANT	SUITE	SQ. FT.	PRORATA %	LEASE START	LEASE END	ANNUAL RENT	RENT/PSF	OPTIONS
First Watch	3090-100	3,900	36.12%	12/22/2025	12/31/2035	\$156,000.00	\$40.00	3-5 year options @ 10% increases every 5 years
Queen Nails Spa by Linh	3090-110	2,004	18.56%	12/26/2025	12/31/2035	\$70,000.00	\$34.93	2-5 year options @ 2% annual increases
Pruden Family Dentistry	3090-120	2,493	23.09%	03/31/2026	03/31/2036	\$99,720.00	\$40.00	2-5 year options @ 2.5% annual increases
Chiptole	3090-130	2,400	22.23%	11/24/2025	11/30/2035	\$112,800.00	\$47.00	3-5 year options @ 10% increases every 5 years
The Habit Burger Grill	OP-3094	52,347	0.00%	04/30/2026	04/30/2046	\$125,000.00	\$2.39	4-5 year options @ 10% increases every 5 years
Valvoline	OP-3098	39,204	0.00%	04/09/2025	04/30/2040	\$95,000.00	\$2.42	3-5 year options @ 10% increases every 5 years
		10,797	100%			\$658,520.00		



TENANT OVERVIEW



Valvoline Inc. is an American retail automotive services company based in Lexington, Kentucky. It licenses the name for a number of Valvoline-labeled automotive oil, additives, and lubricants. It also owns the Valvoline Instant Oil Change, Great Canadian Oil Change and Valvoline Express Care car repair chains. As of 2023, it is the second largest oil change service provider in the United States with 10% market share and over 1,650 locations.



Habit Burger Grill is a fast-casual restaurant chain known for its charbroiled burgers and other Californian-inspired fare. Founded in Santa Barbara, California, in 1969, it has grown to over 300 locations across 14 states and internationally. The Habit is recognized for its commitment to quality, made-to-order food, including its signature Charburger cooked over an open flame. Beyond burgers, the menu includes handcrafted sandwiches, fresh salads, and creamy shakes. The Habit Burger Grill was acquired by Yum! Brands in 2020, joining the ranks of Taco Bell, KFC, and Pizza Hut, according to Nation's Restaurant News.



Chipotle Mexican Grill is a fast-casual restaurant chain known for its focus on fresh, high-quality ingredients and customizable burritos, bowls, tacos, and salads. Founded in 1993 by Steve Eells, it emphasizes "Food with Integrity," sourcing ingredients responsibly and using classic cooking techniques. Chipotle has grown from a single Denver restaurant to a global chain with over 3,700 locations, according to Statista, and is a leader in the fast-casual sector.



Suffolk dentist, Pruden Family Dentistry is a local, trusted dental practice offering a variety of dental services, including preventative care, restorative dentistry, cosmetic dentistry, and TMJ/TMD treatment.

Queen's Nail Spa by Linh

Queen's Nail Spa by Linh is a popular and well-regarded nail salon with a strong reputation for cleanliness, friendly staff, and quality nail services.



First Watch is a daytime cafe chain known for its fresh, made-to-order breakfast, brunch, and lunch offerings. They focus on using high-quality ingredients and a chef-driven menu, which changes seasonally. First Watch operates in 31 states with over 580 locations and 14,000 employees.

MARKET OVERVIEW

GODWIN MARKETPLACE | SUFFOLK, VIRGINIA



SUFFOLK MARKET SUMMARY

Suffolk is an independent city in Virginia, part of the Hampton Roads metropolitan area. It holds the distinction of being Virginia's largest city by land area and the 14th largest in the United States, covering 430 square miles.

Economy and Industry

Suffolk has a long history tied to agriculture, particularly tobacco and later peanuts. In 1912, Amedeo Obici founded the Planters Nut and Chocolate Company in Suffolk, leading to the city being known as the "Peanut Capital of the World". Today, Suffolk remains a major peanut processing center and transportation hub. The city's economy is diverse, encompassing industries like food and beverage processing, warehousing, distribution, and professional office space, benefiting from its proximity to The Port of Virginia. It also has a significant presence in the defense and technology sectors, with companies like Lockheed Martin and Raytheon, and has been dubbed "Pentagon South" due to the presence of various Navy commands and the Joint Staff Joint and Coalition Warfighting Center.

Demographics

In 2020, Suffolk's population was 94,324. It is one of Virginia's fastest-growing cities, projected to exceed 100,000 residents before 2025. As of 2023, the racial composition includes 46.5% White (non-Hispanic), 41.5% Black or African American (non-Hispanic), with smaller percentages for other racial and ethnic groups. The median household income in 2023 was \$90,089, and the poverty rate was 9.87%.

Transportation

Suffolk's transportation infrastructure includes several major highways, including US 13, 17, 58, 258, and 460, and is served by Interstate 664, part of the Hampton Roads Beltway. It has three freight railroads and is being considered for a potential branch line of the Southeast High Speed Rail Corridor. Suffolk Transit provides local bus service, with connections to Hampton Roads Transit. The Monitor-Merrimac Memorial Bridge-Tunnel connects Suffolk to Newport News across the Hampton Roads harbor.

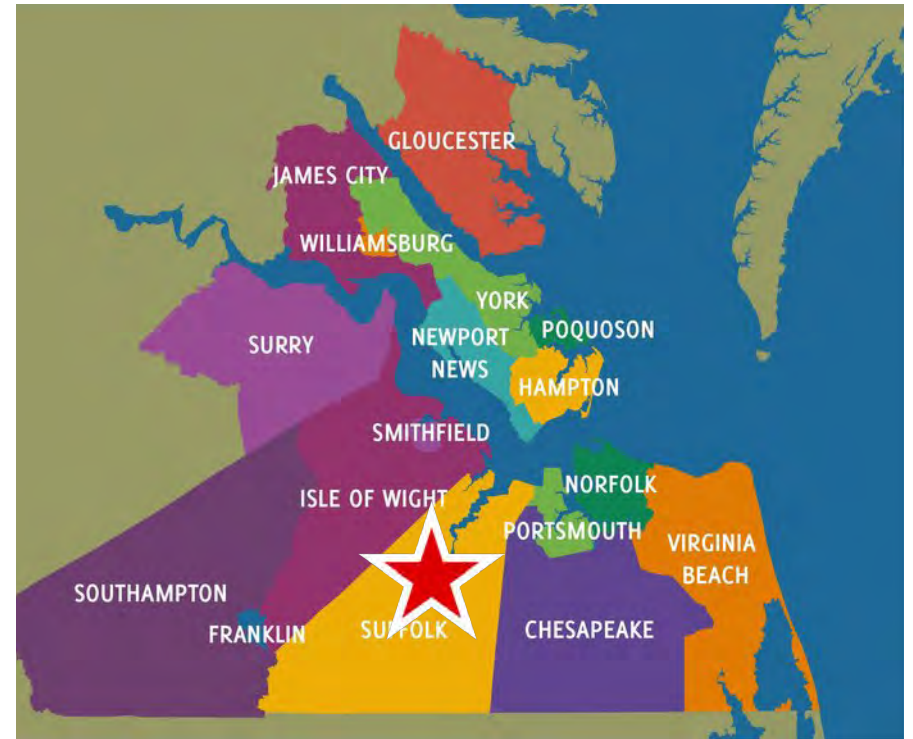

DEMOGRAPHICS

Complete Profile

2010-2020 Census, 2025 Estimates with 2030 Projections
Calculated using Weighted Block Centroid from Block Groups

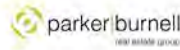

Lat/Lon: 36.7824/-76.5847

3090 Godwin Blvd Suffolk, VA 23434	1 mi radius	3 mi radius	5 mi radius	10 mi radius
Population				
Estimated Population (2025)	7,792	21,488	51,232	102,550
Projected Population (2030)	9,432	25,000	56,510	110,553
Census Population (2020)	5,978	17,172	44,660	93,580
Census Population (2010)	4,942	14,533	41,369	84,515
Projected Annual Growth (2025-2030)	1,640 4.2%	3,512 3.3%	5,278 2.1%	8,003 1.6%
Historical Annual Growth (2020-2025)	1,814 6.1%	4,316 5.0%	6,572 2.9%	8,971 1.9%
Historical Annual Growth (2010-2020)	1,036 2.1%	2,638 1.8%	3,291 0.8%	9,064 1.1%
Estimated Population Density (2025)	2,482 <i>psm</i>	760 <i>psm</i>	653 <i>psm</i>	327 <i>psm</i>
Trade Area Size	3.1 <i>sq mi</i>	28.3 <i>sq mi</i>	78.5 <i>sq mi</i>	314.0 <i>sq mi</i>
Households				
Estimated Households (2025)	2,927	7,671	19,165	38,528
Projected Households (2030)	3,570	9,062	21,280	41,838
Census Households (2020)	2,243	6,198	16,784	35,215
Census Households (2010)	1,786	5,062	15,095	30,814
Projected Annual Growth (2025-2030)	643 4.4%	1,390 3.6%	2,115 2.2%	3,310 1.7%
Historical Annual Change (2010-2025)	1,141 4.3%	2,609 3.4%	4,070 1.8%	7,714 1.7%
Average Household Income				
Estimated Average Household Income (2025)	\$119,173	\$130,634	\$106,358	\$122,534
Projected Average Household Income (2030)	\$115,118	\$125,304	\$103,465	\$118,949
Census Average Household Income (2010)	\$74,324	\$84,045	\$67,562	\$76,569
Census Average Household Income (2000)	\$55,190	\$57,014	\$44,958	\$53,041
Projected Annual Change (2025-2030)	-\$4,055 -0.7%	-\$5,330 -0.8%	-\$2,893 -0.5%	-\$3,586 -0.6%
Historical Annual Change (2000-2025)	\$63,982 4.6%	\$73,620 5.2%	\$61,400 5.5%	\$69,494 5.2%
Median Household Income				
Estimated Median Household Income (2025)	\$106,990	\$103,440	\$83,540	\$97,020
Projected Median Household Income (2030)	\$103,763	\$100,842	\$81,836	\$94,657
Census Median Household Income (2010)	\$72,793	\$75,665	\$56,903	\$65,537
Census Median Household Income (2000)	\$48,478	\$47,572	\$35,558	\$44,102
Projected Annual Change (2025-2030)	-\$3,227 -0.6%	-\$2,598 -0.5%	-\$1,704 -0.4%	-\$2,363 -0.5%
Historical Annual Change (2000-2025)	\$58,513 4.8%	\$55,867 4.7%	\$47,981 5.4%	\$52,917 4.8%
Per Capita Income				
Estimated Per Capita Income (2025)	\$44,775	\$46,735	\$39,901	\$46,131
Projected Per Capita Income (2030)	\$43,579	\$45,503	\$39,066	\$45,104
Census Per Capita Income (2010)	\$26,843	\$29,273	\$24,651	\$27,918
Census Per Capita Income (2000)	\$18,744	\$19,896	\$16,477	\$19,411
Projected Annual Change (2025-2030)	-\$1,197 -0.5%	-\$1,232 -0.5%	\$835 -0.4%	-\$1,028 -0.4%
Historical Annual Change (2000-2025)	\$26,031 5.6%	\$26,839 5.4%	\$23,424 5.7%	\$26,721 5.5%
Estimated Average Household Net Worth (2025)	\$997,599	\$1.19 M	\$998,495	\$1.22 M

© 2025, Sites USA, Chandler, Arizona, 480-491-1112. Demographic Source: Applied Geographic Solutions 5/2025, IIGER Geography, IPULLIP.
This report was produced using data from private and government sources deemed to be reliable. The information herein is provided without representation or warranty.



Complete Profile

2010-2020 Census, 2025 Estimates with 2030 Projections
Calculated using Weighted Block Centroid from Block Groups



Lat/Lon: 36.7824/-76.5847

3090 Godwin Blvd Suffolk, VA 23434	1 mi radius	3 mi radius	5 mi radius	10 mi radius
Race and Ethnicity				
Total Population (2025)	7,792	21,488	51,232	102,550
White (2025)	3,046 39.1%	10,046 46.8%	20,415 39.8%	50,770 49.5%
Black or African American (2025)	3,856 49.5%	9,421 43.8%	26,977 52.7%	42,590 41.6%
American Indian or Alaska Native (2025)	28 0.4%	67 0.3%	132 0.3%	285 0.3%
Asian (2025)	277 3.5%	567 2.6%	846 1.7%	2,409 2.3%
Hawaiian or Pacific Islander (2025)	7 -	17 -	26 -	67 -
Other Race (2025)	150 1.9%	316 1.5%	651 1.3%	1,436 1.4%
Two or More Races (2025)	428 5.5%	1,054 4.9%	2,185 4.3%	4,992 4.9%
Population < 18 (2025)	1,962 25.2%	5,006 23.3%	12,179 23.8%	24,126 23.5%
White Not Hispanic	655 33.4%	1,973 39.4%	3,958 32.5%	10,188 42.2%
Black or African American	963 49.1%	2,208 44.1%	6,648 54.6%	10,230 42.4%
Asian	69 3.5%	162 3.2%	210 1.7%	528 2.2%
Other Race Not Hispanic	121 6.2%	300 6.0%	701 5.8%	1,601 6.6%
Hispanic	154 7.9%	362 7.2%	661 5.4%	1,580 6.5%
Not Hispanic or Latino Population (2025)	7,283 93.5%	20,287 94.4%	48,903 95.5%	97,365 94.9%
Not Hispanic White	2,939 40.4%	9,773 48.2%	19,909 40.7%	49,527 50.9%
Not Hispanic Black or African American	3,800 52.2%	9,275 45.7%	26,667 54.5%	42,020 43.2%
Not Hispanic American Indian or Alaska Native	15 0.2%	39 0.2%	83 0.2%	177 0.2%
Not Hispanic Asian	277 3.8%	557 2.7%	810 1.7%	2,346 2.4%
Not Hispanic Hawaiian or Pacific Islander	6 -	12 -	20 -	50 -
Not Hispanic Other Race	18 0.2%	41 0.2%	108 0.2%	227 0.2%
Not Hispanic Two or More Races	229 3.2%	590 2.9%	1,306 2.7%	3,017 3.1%
Hispanic or Latino Population (2025)	509 6.5%	1,200 5.6%	2,329 4.5%	5,185 5.1%
Hispanic White	108 21.1%	273 22.7%	505 21.7%	1,243 24.0%
Hispanic Black or African American	56 11.0%	146 12.2%	309 13.3%	570 11.0%
Hispanic American Indian or Alaska Native	13 2.6%	28 2.3%	49 2.1%	108 2.1%
Hispanic Asian	-	9 0.8%	36 1.6%	63 1.2%
Hispanic Hawaiian or Pacific Islander	1 0.2%	5 0.4%	7 0.3%	17 0.3%
Hispanic Other Race	133 26.0%	275 22.9%	543 23.3%	1,209 23.3%
Hispanic Two or More Races	199 39.1%	464 38.7%	879 37.8%	1,975 38.1%
Not Hispanic or Latino Population (2020)	5,552 92.9%	16,230 94.5%	42,833 95.9%	89,431 95.6%
Hispanic or Latino Population (2020)	426 7.1%	942 5.5%	1,826 4.1%	4,148 4.4%
Not Hispanic or Latino Population (2010)	4,686 94.8%	14,025 96.5%	40,310 97.4%	82,283 97.4%
Hispanic or Latino Population (2010)	256 5.2%	508 3.5%	1,058 2.6%	2,233 2.6%
Not Hispanic or Latino Population (2030)	8,574 90.9%	23,042 92.2%	52,824 93.5%	102,944 93.1%
Hispanic or Latino Population (2030)	858 9.1%	1,959 7.8%	3,686 6.5%	7,609 6.9%
Projected Annual Growth (2025-2030)	349 13.7%	758 12.6%	1,357 11.7%	2,424 9.3%
Historical Annual Growth (2010-2020)	170 6.6%	434 8.5%	768 7.3%	1,916 8.6%

© 2025, Sites USA, Chandler, Arizona, 480-491-1112. Demographic Source: Applied Geographic Solutions 5/2025, IIGER Geography, IPULLIP.
This report was produced using data from private and government sources deemed to be reliable. The information herein is provided without representation or warranty.

DEMOGRAPHICS

Complete Profile

2010-2020 Census, 2025 Estimates with 2030 Projections
 Calculated using Weighted Block Centroid from Block Groups

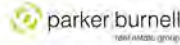

Lat/Lon: 36.7824/-76.5847

3090 Godwin Blvd Suffolk, VA 23434	1 mi radius	3 mi radius	5 mi radius	10 mi radius
Total Age Distribution (2025)				
Total Population	7,792	21,488	51,232	102,550
Age Under 5 Years	526 6.7%	1,379 6.4%	3,231 6.3%	6,331 6.2%
Age 5 to 9 Years	607 7.8%	1,430 6.7%	3,389 6.6%	6,791 6.6%
Age 10 to 14 Years	529 6.8%	1,361 6.3%	3,387 6.6%	6,772 6.6%
Age 15 to 19 Years	503 6.5%	1,299 6.0%	3,349 6.5%	6,445 6.3%
Age 20 to 24 Years	488 6.3%	1,220 5.7%	2,993 5.8%	5,520 5.4%
Age 25 to 29 Years	581 7.5%	1,482 6.9%	3,391 6.6%	6,190 6.0%
Age 30 to 34 Years	693 8.9%	1,852 8.6%	3,886 7.6%	7,354 7.2%
Age 35 to 39 Years	683 8.8%	1,769 8.2%	3,767 7.4%	7,673 7.5%
Age 40 to 44 Years	597 7.7%	1,626 7.6%	3,490 6.8%	7,045 6.9%
Age 45 to 49 Years	472 6.1%	1,284 6.0%	2,919 5.7%	5,918 5.8%
Age 50 to 54 Years	465 6.0%	1,286 6.0%	3,135 6.1%	6,472 6.3%
Age 55 to 59 Years	411 5.3%	1,304 6.1%	3,433 6.7%	6,746 6.6%
Age 60 to 64 Years	384 4.9%	1,230 5.7%	3,317 6.5%	6,798 6.6%
Age 65 to 69 Years	326 4.2%	994 4.6%	2,701 5.3%	5,590 5.5%
Age 70 to 74 Years	212 2.7%	667 3.1%	1,843 3.6%	4,261 4.2%
Age 75 to 79 Years	164 2.1%	579 2.7%	1,376 2.7%	3,188 3.1%
Age 80 to 84 Years	84 1.1%	349 1.6%	877 1.7%	1,952 1.9%
Age 85 Years or Over	68 0.9%	377 1.8%	747 1.5%	1,505 1.5%
Median Age	33.9	36.9	37.3	38.6
Age 19 Years or Less	2,165 27.8%	5,469 25.5%	13,356 26.1%	26,338 25.7%
Age 20 to 64 Years	4,774 61.3%	13,053 60.7%	30,331 59.2%	59,716 58.2%
Age 65 Years or Over	853 10.9%	2,966 13.8%	7,545 14.7%	16,496 16.1%
Female Age Distribution (2025)				
Female Population	4,147 53.2%	10,542 49.1%	26,199 51.1%	52,404 51.1%
Age Under 5 Years	278 6.7%	700 6.6%	1,596 6.1%	3,090 5.9%
Age 5 to 9 Years	321 7.7%	713 6.8%	1,658 6.3%	3,244 6.2%
Age 10 to 14 Years	262 6.3%	644 6.1%	1,620 6.2%	3,292 6.3%
Age 15 to 19 Years	221 5.3%	590 5.6%	1,586 6.1%	3,096 5.9%
Age 20 to 24 Years	233 5.6%	531 5.0%	1,462 5.6%	2,687 5.1%
Age 25 to 29 Years	308 7.4%	707 6.7%	1,672 6.4%	3,093 5.9%
Age 30 to 34 Years	359 8.7%	867 8.2%	2,026 7.7%	3,896 7.4%
Age 35 to 39 Years	356 8.6%	830 7.9%	1,867 7.1%	3,880 7.4%
Age 40 to 44 Years	322 7.8%	779 7.4%	1,793 6.8%	3,569 6.8%
Age 45 to 49 Years	270 6.5%	655 6.2%	1,564 6.0%	3,105 5.9%
Age 50 to 54 Years	270 6.5%	680 6.5%	1,703 6.5%	3,417 6.5%
Age 55 to 59 Years	222 5.4%	664 6.3%	1,797 6.9%	3,535 6.7%
Age 60 to 64 Years	223 5.4%	634 6.0%	1,720 6.6%	3,541 6.8%
Age 65 to 69 Years	188 4.5%	556 5.3%	1,487 5.7%	3,016 5.8%
Age 70 to 74 Years	127 3.1%	355 3.4%	1,011 3.9%	2,324 4.4%
Age 75 to 79 Years	97 2.3%	319 3.0%	776 3.0%	1,754 3.3%
Age 80 to 84 Years	50 1.2%	173 1.6%	504 1.9%	1,105 2.1%
Age 85 Years or Over	40 1.0%	145 1.4%	358 1.4%	761 1.5%
Female Median Age	35.3	37.8	38.5	39.7
Age 19 Years or Less	1,083 26.1%	2,646 25.1%	6,459 24.7%	12,723 24.3%
Age 20 to 64 Years	2,563 61.8%	6,347 60.2%	15,605 59.6%	30,722 58.6%
Age 65 Years or Over	502 12.1%	1,549 14.7%	4,135 15.8%	8,959 17.1%

© 2025, Sites USA, Chandler, Arizona. 480-491-1112. Demographic Source: Applied Geographic Solutions 5/2025, HESLI Geography - RHULLER
 This report was produced using data from private and government sources deemed to be reliable. The information herein is provided without representation or warranty.



Complete Profile

2010-2020 Census, 2025 Estimates with 2030 Projections
 Calculated using Weighted Block Centroid from Block Groups

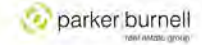

Lat/Lon: 36.7824/-76.5847

3090 Godwin Blvd Suffolk, VA 23434	1 mi radius	3 mi radius	5 mi radius	10 mi radius
Male Age Distribution (2025)				
Male Population	3,645 46.8%	10,946 50.9%	25,033 48.9%	50,146 48.9%
Age Under 5 Years	247 6.8%	680 6.2%	1,635 6.5%	3,240 6.5%
Age 5 to 9 Years	285 7.8%	717 6.5%	1,731 6.9%	3,546 7.1%
Age 10 to 14 Years	267 7.3%	718 6.6%	1,767 7.1%	3,480 6.9%
Age 15 to 19 Years	283 7.8%	709 6.5%	1,764 7.0%	3,348 6.7%
Age 20 to 24 Years	255 7.0%	690 6.3%	1,530 6.1%	2,834 5.7%
Age 25 to 29 Years	272 7.5%	775 7.1%	1,719 6.9%	3,097 6.2%
Age 30 to 34 Years	334 9.2%	985 9.0%	1,860 7.4%	3,457 6.9%
Age 35 to 39 Years	328 9.0%	939 8.6%	1,900 7.6%	3,793 7.6%
Age 40 to 44 Years	276 7.6%	848 7.7%	1,697 6.8%	3,476 6.9%
Age 45 to 49 Years	202 5.5%	629 5.7%	1,355 5.4%	2,813 5.6%
Age 50 to 54 Years	195 5.3%	606 5.5%	1,432 5.7%	3,055 6.1%
Age 55 to 59 Years	189 5.2%	640 5.8%	1,636 6.5%	3,211 6.4%
Age 60 to 64 Years	160 4.4%	595 5.4%	1,597 6.4%	3,258 6.5%
Age 65 to 69 Years	138 3.8%	438 4.0%	1,215 4.9%	2,574 5.1%
Age 70 to 74 Years	84 2.3%	312 2.8%	831 3.3%	1,937 3.9%
Age 75 to 79 Years	67 1.8%	260 2.4%	601 2.4%	1,434 2.9%
Age 80 to 84 Years	34 0.9%	176 1.6%	373 1.5%	847 1.7%
Age 85 Years or Over	28 0.8%	232 2.1%	389 1.6%	745 1.5%
Male Median Age	32.4	36.1	36.1	37.5
Age 19 Years or Less	1,083 29.7%	2,823 25.8%	6,897 27.6%	13,615 27.2%
Age 20 to 64 Years	2,211 60.7%	6,706 61.3%	14,727 58.8%	28,994 57.8%
Age 65 Years or Over	351 9.6%	1,417 12.9%	3,409 13.6%	7,537 15.0%
Males per 100 Females (2025)				
Overall Comparison	88	104	96	96
Age Under 5 Years	89 47.1%	97 49.3%	102 50.6%	105 51.2%
Age 5 to 9 Years	89 47.0%	100 50.1%	104 51.1%	109 52.2%
Age 10 to 14 Years	102 50.5%	112 52.7%	109 52.2%	106 51.4%
Age 15 to 19 Years	128 56.1%	120 54.6%	111 52.7%	108 52.0%
Age 20 to 24 Years	110 52.3%	110 56.5%	105 51.1%	105 51.3%
Age 25 to 29 Years	88 46.9%	110 52.3%	103 50.7%	100 50.0%
Age 30 to 34 Years	93 48.2%	114 53.2%	92 47.9%	89 47.0%
Age 35 to 39 Years	92 47.9%	113 53.1%	102 50.4%	98 49.4%
Age 40 to 44 Years	86 46.2%	109 52.1%	95 48.6%	97 49.3%
Age 45 to 49 Years	75 42.8%	96 48.0%	87 46.4%	91 47.5%
Age 50 to 54 Years	72 41.9%	89 47.1%	84 45.7%	89 47.2%
Age 55 to 59 Years	85 46.0%	96 49.1%	91 47.7%	91 47.6%
Age 60 to 64 Years	72 41.8%	94 48.4%	93 48.1%	92 47.9%
Age 65 to 69 Years	73 42.2%	79 44.1%	82 45.0%	85 46.1%
Age 70 to 74 Years	66 39.8%	88 46.7%	82 45.1%	83 45.5%
Age 75 to 79 Years	69 40.9%	81 44.9%	77 43.6%	82 45.0%
Age 80 to 84 Years	69 40.8%	101 50.3%	74 42.5%	77 43.4%
Age 85 Years or Over	71 41.7%	160 61.5%	105 52.1%	98 49.5%
Age 19 Years or Less	100 50.0%	107 51.6%	107 51.6%	107 51.7%
Age 20 to 39 Years	95 48.6%	115 53.6%	100 49.9%	97 49.3%
Age 40 to 64 Years	78 43.9%	97 49.3%	90 47.4%	92 47.9%
Age 65 Years or Over	70 41.7%	92 47.8%	87 45.2%	84 45.7%

© 2025, Sites USA, Chandler, Arizona. 480-491-1112. Demographic Source: Applied Geographic Solutions 5/2025, HESLI Geography - RHULLER
 This report was produced using data from private and government sources deemed to be reliable. The information herein is provided without representation or warranty.

DEMOGRAPHICS

Complete Profile

2010-2020 Census, 2025 Estimates with 2030 Projections
Calculated using Weighted Block Centroid from Block Groups



Lat/Lon: 36.7824/-76.5847

3090 Godwin Blvd Suffolk, VA 23434	1 mi radius	3 mi radius	5 mi radius	10 mi radius
Household Type (2025)				
Total Households	2,927	7,671	19,165	38,528
Households with Children	1,198 40.9%	2,885 37.6%	6,827 35.6%	13,633 35.4%
Average Household Size	2.7	2.7	2.6	2.6
Household Density per Square Mile	932	271	244	123
Population Family	6,358 81.6%	17,183 80.0%	41,819 81.6%	85,658 83.5%
Population Non-Family	1,426 18.3%	3,190 14.8%	8,071 15.8%	15,267 14.9%
Population Group Quarters				
Family Households	2,036 69.6%	5,493 71.6%	13,422 70.0%	27,495 71.4%
Married Couple Households	1,547 76.0%	4,390 79.9%	8,823 65.7%	19,849 72.2%
Other Family Households with Children	489 24.0%	1,104 20.1%	4,599 34.3%	7,646 27.8%
Family Households No Children	1,196 58.7%	2,880 52.4%	6,813 50.8%	13,612 49.5%
Married Couple with Children	786 65.7%	2,082 72.3%	3,948 57.9%	9,028 66.3%
Other Family Households with Children	410 34.3%	799 27.7%	2,865 42.1%	4,584 33.7%
Family Households No Children	840 41.3%	2,613 47.6%	6,609 49.2%	13,882 50.5%
Married Couple No Children	751 90.6%	2,308 88.3%	4,875 73.8%	10,821 77.9%
Other Family Households No Children	79 9.4%	305 11.7%	1,734 26.2%	3,062 22.1%
Non-Family Households	891 30.4%	2,178 28.4%	5,743 30.0%	11,033 28.6%
Non-Family Households with Children	2 0.2%	5 0.2%	14 0.2%	21 0.2%
Non-Family Households No Children	889 99.8%	2,173 99.8%	5,729 99.8%	11,012 99.8%
Average Family Household Size	3.1	3.1	3.1	3.1
Average Family Income	\$149,443	\$156,772	\$127,989	\$142,455
Median Family Income	\$127,714	\$122,279	\$100,676	\$114,488
Average Non-Family Household Size	1.6	1.5	1.4	1.4
Marital Status (2025)				
Population Age 15 Years or Over	6,130	17,318	41,225	82,657
Never Married	1,899 31.0%	5,047 29.1%	14,277 34.6%	26,063 31.5%
Currently Married	3,202 52.2%	9,231 53.3%	18,884 45.8%	41,732 50.5%
Previously Married	1,029 16.8%	3,040 17.6%	8,064 19.6%	14,862 18.0%
Separated	242 23.5%	801 26.4%	1,960 24.3%	3,387 22.8%
Widowed	437 42.5%	1,031 33.9%	2,642 32.8%	4,656 31.3%
Divorced	350 34.0%	1,207 39.7%	3,463 42.9%	6,819 45.9%
Educational Attainment (2025)				
Adult Population Age 25 Years or Over	5,139	14,798	34,883	70,692
Elementary (Grade Level 0 to 8)	62 1.2%	215 1.5%	1,264 3.6%	1,999 2.8%
Some High School (Grade Level 9 to 11)	179 3.5%	503 3.4%	1,946 5.6%	3,357 4.7%
High School Graduate	1,155 22.5%	3,599 24.3%	9,475 27.2%	18,829 26.6%
Some College	1,336 26.0%	3,391 22.9%	8,140 23.3%	15,697 22.2%
Associate Degree Only	676 13.1%	1,943 13.1%	3,801 10.9%	7,388 10.5%
Bachelor Degree Only	1,000 19.5%	3,168 21.4%	6,406 18.4%	14,453 20.4%
Graduate Degree	731 14.2%	1,980 13.4%	3,852 11.0%	8,984 12.7%
Any College (Some College or Higher)	3,743 72.8%	10,482 70.8%	22,199 63.6%	46,508 65.8%
College Degree + (Bachelor Degree or Higher)	1,731 33.7%	5,148 34.8%	10,258 29.4%	23,438 33.2%

©2025 Siter USA, Chandler, Arizona 480-494-1112 Demographic Source: Applied Geographic Solutions 5/2025, TIGER Geography - IPUSA19
This report was produced using data from private and government sources deemed to be reliable. The information herein is provided without representation or warranty.



Complete Profile

2010-2020 Census, 2025 Estimates with 2030 Projections
Calculated using Weighted Block Centroid from Block Groups



Lat/Lon: 36.7824/-76.5847

3090 Godwin Blvd Suffolk, VA 23434	1 mi radius	3 mi radius	5 mi radius	10 mi radius
Housing				
Total Housing Units (2025)	3,093	8,171	20,904	41,728
Total Housing Units (2020)	2,394	6,642	18,357	37,761
Historical Annual Growth (2020-2025)	700 5.8%	1,528 4.6%	2,547 2.8%	3,967 2.1%
Housing Units Occupied (2025)	2,927 94.6%	7,671 93.9%	19,165 91.7%	38,528 92.3%
Housing Units Owner-Occupied	1,932 66.0%	5,664 73.8%	12,115 63.2%	27,261 70.8%
Housing Units Renter-Occupied	995 34.0%	2,007 26.2%	7,050 36.8%	11,266 29.2%
Housing Units Vacant (2025)	166 5.4%	499 6.1%	1,739 8.3%	3,200 7.7%
Household Size (2025)				
Total Households	2,927	7,671	19,165	38,528
1 Person Households	553 18.9%	1,534 20.0%	4,378 22.8%	8,689 22.6%
2 Person Households	1,090 37.2%	2,774 36.2%	6,594 34.4%	13,346 34.6%
3 Person Households	541 18.5%	1,390 18.1%	3,534 18.4%	7,036 18.3%
4 Person Households	410 14.0%	1,120 14.6%	2,607 13.6%	5,351 13.9%
5 Person Households	223 7.6%	551 7.2%	1,248 6.5%	2,533 6.6%
6 Person Households	69 2.4%	182 2.4%	495 2.6%	972 2.5%
7 or More Person Households	42 1.4%	120 1.6%	309 1.6%	600 1.6%
Household Income Distribution (2025)				
HH Income \$200,000 or More	319 10.9%	1,044 13.6%	1,933 10.1%	5,104 13.2%
HH Income \$150,000 to \$199,999	564 19.3%	1,231 16.0%	1,960 10.2%	4,882 12.7%
HH Income \$125,000 to \$149,999	260 8.9%	641 8.4%	1,679 8.8%	3,543 9.2%
HH Income \$100,000 to \$124,999	355 12.1%	830 10.8%	1,919 10.0%	4,026 10.4%
HH Income \$75,000 to \$99,999	322 11.0%	963 12.6%	2,288 11.9%	4,702 12.2%
HH Income \$50,000 to \$74,999	371 12.7%	1,195 15.6%	2,978 15.5%	5,756 14.9%
HH Income \$35,000 to \$49,999	257 8.8%	571 7.4%	1,700 8.9%	3,052 7.9%
HH Income \$25,000 to \$34,999	108 3.7%	400 5.2%	1,481 7.7%	2,640 6.9%
HH Income \$15,000 to \$24,999	226 7.7%	379 4.9%	1,242 6.5%	1,853 4.8%
HH Income \$10,000 to \$14,999	33 1.1%	95 1.2%	613 3.2%	1,011 2.6%
HH Income Under \$10,000	111 3.8%	323 4.2%	1,372 7.2%	1,979 5.1%
Household Vehicles (2025)				
Households 0 Vehicles Available	99 3.4%	225 2.9%	1,335 7.0%	2,139 5.6%
Households 1 Vehicle Available	920 31.4%	1,905 24.8%	5,751 30.0%	10,519 27.3%
Households 2 Vehicles Available	1,339 45.7%	3,348 43.6%	7,165 37.4%	14,558 37.8%
Households 3 or More Vehicles Available	570 19.5%	2,193 28.6%	4,914 25.6%	11,312 29.4%
Total Vehicles Available	5,525	16,116	36,860	78,663
Average Vehicles per Household	1.9	2.1	1.9	2.0
Owner-Occupied Household Vehicles	4,271 77.3%	13,263 82.3%	27,515 74.6%	62,985 80.1%
Renter-Occupied Household Vehicles	22 0.4%	73 0.5%	233 0.6%	328 0.4%
Average Vehicles per Renter-Occupied Household	1.3	1.4	1.3	1.4
Travel Time (2025)				
Worker Base Age 16 years or Over	3,308	9,237	23,169	48,205
Travel to Work in 14 Minutes or Less	328 9.9%	1,213 13.1%	3,593 15.5%	7,025 14.6%
Travel to Work in 15 to 29 Minutes	711 21.5%	1,826 19.8%	5,594 24.1%	13,070 27.1%
Travel to Work in 30 to 59 Minutes	1,831 55.3%	4,844 52.4%	10,507 45.3%	20,500 42.5%
Travel to Work in 60 Minutes or More	220 6.7%	719 7.8%	1,740 7.5%	2,967 6.2%
Work at Home	218 6.6%	634 6.9%	1,735 7.5%	4,644 9.6%
Average Minutes Travel to Work	34.4	33.3	30.5	29.6

©2025 Siter USA, Chandler, Arizona 480-494-1112 Demographic Source: Applied Geographic Solutions 5/2025, TIGER Geography - IPUSA19
This report was produced using data from private and government sources deemed to be reliable. The information herein is provided without representation or warranty.

DEMOGRAPHICS

Complete Profile

2010-2020 Census, 2025 Estimates with 2030 Projections
 Calculated using Weighted Block Centroid from Block Groups



Lat/Lon: 36.7824/-76.5847

3090 Godwin Blvd Suffolk, VA 23434	1 mi radius	3 mi radius	5 mi radius	10 mi radius
Transportation To Work (2025)				
Worker Base Age 16 years or Over	3,308	9,237	23,169	48,205
Drive to Work Alone	2,666 80.6%	7,743 83.8%	18,725 80.8%	38,512 79.9%
Drive to Work in Carpool	380 11.5%	777 7.9%	1,921 8.3%	3,740 7.8%
Travel to Work by Public Transportation	29 0.9%	55 0.6%	245 1.1%	286 0.6%
Drive to Work on Motorcycle	14 0.4%	22 0.2%	32 0.1%	91 0.2%
Bicycle to Work	-	1	72 0.3%	75 0.2%
Walk to Work	-	4	228 1.0%	435 0.9%
Other Means	1	51 0.6%	211 0.9%	423 0.9%
Work at Home	218 6.6%	634 6.9%	1,735 7.5%	4,644 9.6%
Daytime Demographics (2025)				
Total Businesses	226	747	1,853	3,701
Total Employees	4,555	10,115	18,700	31,418
Company Headquarter Businesses	4 1.7%	15 2.0%	38 2.0%	69 1.9%
Company Headquarter Employees	55 1.2%	779 7.7%	2,161 11.6%	2,965 9.4%
Employee Population per Business	20.1 to 1	13.5 to 1	10.1 to 1	8.5 to 1
Residential Population per Business	34.5 to 1	28.8 to 1	27.6 to 1	27.7 to 1
Adj. Daytime Demographics Age 16 Years or Over	6,781	16,772	34,345	61,217
Labor Force				
Labor Population Age 16 Years or Over (2025)	6,014	17,021	40,486	81,234
Labor Force Total Males (2025)	2,781 46.2%	8,676 51.0%	19,524 48.2%	39,158 48.2%
Male Civilian Employed	1,535 55.2%	4,701 54.2%	11,438 58.6%	23,824 60.8%
Male Civilian Unemployed	114 4.1%	291 3.4%	522 2.7%	800 2.0%
Males in Armed Forces	406 14.6%	870 10.0%	1,292 6.6%	2,447 6.2%
Males Not in Labor Force	726 26.1%	2,813 32.4%	6,271 32.1%	12,086 30.9%
Labor Force Total Females (2025)	3,233 53.8%	8,345 49.0%	20,962 51.8%	42,076 51.8%
Female Civilian Employed	1,773 54.8%	4,536 54.4%	11,731 56.0%	24,383 57.9%
Female Civilian Unemployed	69 2.1%	143 1.7%	506 2.4%	829 2.0%
Females in Armed Forces	74 2.3%	256 3.1%	378 1.8%	781 1.9%
Females Not in Labor Force	1,317 40.7%	3,410 40.9%	8,345 39.8%	16,083 38.2%
Unemployment Rate	182 3.0%	434 2.6%	1,029 2.5%	1,629 2.0%
Occupation (2025)				
Occupation Population Age 16 Years or Over	3,308	9,237	23,169	48,205
Occupation Total Males	1,535 46.4%	4,701 50.9%	11,437 49.4%	23,822 49.4%
Occupation Total Females	1,773 53.6%	4,536 49.1%	11,731 50.6%	24,383 50.6%
Management, Business, Financial Operations	497 15.0%	1,742 18.9%	3,872 16.7%	8,934 18.5%
Professional, Related	1,064 32.2%	2,891 31.3%	6,650 28.7%	13,696 28.4%
Service	630 19.0%	1,349 14.6%	4,136 17.9%	7,819 16.2%
Sales, Office	627 19.0%	1,691 18.3%	3,420 14.8%	7,549 15.7%
Farming, Fishing, Forestry	1	33 0.4%	73 0.3%	157 0.3%
Construction, Extraction, Maintenance	129 3.9%	402 4.3%	1,144 4.9%	2,854 5.9%
Production, Transport, Material Moving	359 10.9%	1,129 12.2%	3,874 16.7%	7,195 14.9%
White Collar Workers	2,189 66.2%	6,325 68.5%	13,942 60.2%	30,179 62.6%
Blue Collar Workers	1,119 33.8%	2,912 31.5%	9,227 39.8%	18,026 37.4%

©2025, Sites USA, Chandler, Arizona, 480-481-1112. Demographic Source: Applied Geographic Solutions S/2025, TIGER Geography - HPULLB
 This report was produced using data from private and government sources deemed to be reliable. The information herein is provided without representation or warranty.



Complete Profile

2010-2020 Census, 2025 Estimates with 2030 Projections
 Calculated using Weighted Block Centroid from Block Groups



Lat/Lon: 36.7824/-76.5847

3090 Godwin Blvd Suffolk, VA 23434	1 mi radius	3 mi radius	5 mi radius	10 mi radius
Units in Structure (2025)				
Total Units	2,927	7,671	19,165	38,528
1 Detached Unit	1,953 66.7%	5,761 75.1%	13,250 69.1%	27,012 70.1%
1 Attached Unit	332 11.3%	597 7.8%	1,212 6.3%	3,101 8.0%
2 Units	14 0.5%	52 0.7%	523 2.7%	622 1.6%
3 to 4 Units	160 5.5%	285 3.7%	1,173 6.1%	1,756 4.6%
5 to 9 Units	67 2.1%	105 1.4%	297 1.6%	568 1.5%
10 to 19 Units	85 2.9%	169 2.2%	658 3.4%	1,197 3.1%
20 to 49 Units	24 0.8%	151 2.0%	333 1.7%	952 2.5%
50 or More Units	272 9.3%	435 5.7%	1,242 6.5%	2,127 5.5%
Mobile Home or Trailer	25 0.9%	116 1.5%	478 2.5%	1,194 3.1%
Other Structure	-	-	-	-
Homes Built By Year (2025)				
Homes Built 2020 or later	231 7.5%	677 8.3%	1,639 7.8%	3,068 7.4%
Homes Built 2010 to 2019	724 23.4%	1,669 20.4%	2,804 13.4%	6,068 14.5%
Homes Built 2000 to 2009	729 23.6%	1,751 21.4%	3,274 15.4%	7,485 17.9%
Homes Built 1990 to 1999	728 23.5%	1,343 16.4%	2,557 12.2%	5,316 12.7%
Homes Built 1980 to 1989	210 6.8%	713 8.7%	2,336 11.2%	4,438 10.6%
Homes Built 1970 to 1979	116 3.8%	422 5.2%	1,516 7.3%	3,273 7.8%
Homes Built 1960 to 1969	60 1.9%	528 6.5%	1,487 7.1%	3,365 8.1%
Homes Built 1950 to 1959	77 2.5%	252 3.1%	1,158 5.5%	1,983 4.8%
Homes Built 1940 to 1949	56 1.8%	140 1.7%	1,027 4.9%	1,399 3.4%
Homes Built Before 1939	47 1.5%	176 2.2%	1,416 6.9%	2,134 5.1%
Median Age of Homes	24.8 yrs	28.6 yrs	37.7 yrs	35.3 yrs
Home Values (2025)				
Owner Specified Housing Units	1,932	5,664	12,115	27,261
Home Values \$1,000,000 or More	10 0.5%	66 1.2%	120 1.0%	372 1.4%
Home Values \$750,000 to \$999,999	13 0.7%	110 1.9%	219 1.8%	581 2.1%
Home Values \$500,000 to \$749,999	146 7.6%	549 9.7%	1,139 9.4%	3,293 12.1%
Home Values \$400,000 to \$499,999	331 17.1%	1,423 25.1%	2,802 23.1%	6,293 23.1%
Home Values \$300,000 to \$399,999	751 38.9%	1,728 30.5%	3,028 25.0%	7,082 26.0%
Home Values \$250,000 to \$299,999	251 13.0%	683 12.1%	1,178 9.7%	2,844 10.4%
Home Values \$200,000 to \$249,999	245 12.7%	579 10.2%	1,616 13.3%	3,203 11.7%
Home Values \$175,000 to \$199,999	16 0.8%	52 0.9%	217 1.8%	398 1.5%
Home Values \$150,000 to \$174,999	15 0.8%	160 2.8%	727 6.0%	1,043 3.8%
Home Values \$125,000 to \$149,999	1	13 0.2%	57 0.5%	110 0.4%
Home Values \$100,000 to \$124,999	4 0.2%	27 0.5%	248 2.0%	321 1.2%
Home Values \$90,000 to \$99,999	9 0.5%	29 0.5%	100 0.8%	109 0.4%
Home Values \$80,000 to \$89,999	2	5	86 0.7%	195 0.7%
Home Values \$70,000 to \$79,999	-	1	18 0.2%	68 0.2%
Home Values \$60,000 to \$69,999	-	-	3	3
Home Values \$50,000 to \$59,999	2	9 0.2%	83 0.7%	122 0.4%
Home Values \$35,000 to \$49,999	105 5.4%	161 2.8%	255 2.1%	469 1.7%
Home Values \$25,000 to \$34,999	22 1.2%	33 0.6%	52 0.4%	160 0.6%
Home Values \$10,000 to \$24,999	7 0.3%	10 0.2%	47 0.4%	163 0.6%
Home Values Under \$10,000	3 0.2%	25 0.4%	119 1.0%	431 1.6%
Owner-Occupied Median Home Value	\$330,763	\$363,635	\$341,589	\$357,519
Renter-Occupied Median Rent	\$1,313	\$1,405	\$1,122	\$1,227

©2025, Sites USA, Chandler, Arizona, 480-481-1112. Demographic Source: Applied Geographic Solutions S/2025, TIGER Geography - HPULLB
 This report was produced using data from private and government sources deemed to be reliable. The information herein is provided without representation or warranty.

DEMOGRAPHICS

Complete Profile

2010-2020 Census, 2025 Estimates with 2030 Projections
 Calculated using Weighted Block Centroid from Block Groups

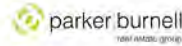

Lat/Lon: 36.7824/-76.5847

3090 Godwin Blvd Suffolk, VA 23434	1 mi radius	3 mi radius	5 mi radius	10 mi radius
Total Annual Consumer Expenditure (2025)				
Total Household Expenditure	\$335.21 M	\$892.96 M	\$1.97 B	\$4.31 B
Total Non-Retail Expenditure	\$169.24 M	\$449.07 M	\$979.86 M	\$2.16 B
Total Retail Expenditure	\$165.98 M	\$443.89 M	\$992.54 M	\$2.14 B
Alcoholic Beverages	\$2.06 M	\$5.44 M	\$11.92 M	\$26.11 M
Apparel	\$6.2 M	\$16.35 M	\$36.34 M	\$78.73 M
Contributions	\$10.75 M	\$28.59 M	\$60.95 M	\$136.54 M
Education	\$7.65 M	\$20.3 M	\$43.78 M	\$97.19 M
Entertainment	\$19.18 M	\$50.57 M	\$112.74 M	\$243.72 M
Food Away From Home	\$14.75 M	\$38.94 M	\$86.22 M	\$187.34 M
Grocery	\$21.78 M	\$56.79 M	\$133.89 M	\$276.77 M
Health Care	\$18.65 M	\$50.32 M	\$126.29 M	\$257.31 M
Household Furnishings and Equipment	\$8.92 M	\$23.57 M	\$51.95 M	\$113.3 M
Household Operations	\$6.25 M	\$16.49 M	\$36.98 M	\$79.61 M
Miscellaneous Expenses	\$5.73 M	\$15.12 M	\$33.44 M	\$72.74 M
Personal Care	\$4.29 M	\$11.22 M	\$26.03 M	\$54.48 M
Shelter	\$53.01 M	\$136.53 M	\$317.91 M	\$665.58 M
Tax and Retirement	\$86.59 M	\$233.8 M	\$473.31 M	\$1.11 B
Tobacco and Related	\$1.58 M	\$4.07 M	\$10.68 M	\$20.38 M
Transportation	\$52.31 M	\$144.45 M	\$314.15 M	\$689.74 M
Utilities	\$15.52 M	\$40.41 M	\$95.82 M	\$197.19 M
Monthly Household Consumer Expenditure (2025)				
Total Household Expenditure	\$9,543	\$9,700	\$8,577	\$9,313
Total Non-Retail Expenditure	\$4,818 50.5%	\$4,878 50.3%	\$4,261 49.7%	\$4,674 50.2%
Total Retail Expenditures	\$4,725 49.5%	\$4,822 49.7%	\$4,316 50.3%	\$4,639 49.8%
Alcoholic Beverages	\$59 0.6%	\$59 0.6%	\$52 0.6%	\$56 0.6%
Apparel	\$176 1.8%	\$178 1.8%	\$158 1.8%	\$170 1.8%
Contributions	\$306 3.2%	\$311 3.2%	\$265 3.1%	\$295 3.2%
Education	\$218 2.3%	\$221 2.3%	\$190 2.2%	\$210 2.3%
Entertainment	\$546 5.7%	\$549 5.7%	\$490 5.7%	\$527 5.7%
Food Away From Home	\$420 4.4%	\$423 4.4%	\$375 4.4%	\$405 4.4%
Grocery	\$620 6.5%	\$617 6.4%	\$582 6.8%	\$599 6.4%
Health Care	\$531 5.6%	\$547 5.6%	\$549 6.4%	\$557 6.0%
Household Furnishings and Equipment	\$254 2.7%	\$256 2.6%	\$226 2.6%	\$245 2.6%
Household Operations	\$178 1.9%	\$179 1.8%	\$161 1.9%	\$172 1.8%
Miscellaneous Expenses	\$163 1.7%	\$164 1.7%	\$145 1.7%	\$157 1.7%
Personal Care	\$122 1.3%	\$122 1.3%	\$113 1.3%	\$118 1.3%
Shelter	\$1,509 15.8%	\$1,483 15.3%	\$1,382 16.1%	\$1,440 15.5%
Tax and Retirement	\$2,465 25.8%	\$2,540 26.2%	\$2,058 24.0%	\$2,399 24.0%
Tobacco and Related	\$45 0.5%	\$44 0.5%	\$46 0.5%	\$44 0.5%
Transportation	\$1,489 15.6%	\$1,569 16.2%	\$1,366 15.9%	\$1,492 16.0%
Utilities	\$442 4.6%	\$439 4.5%	\$417 4.9%	\$427 4.6%

©2025, Sites USA, Chandler, Arizona, 480-491-1112. Demographic Source: Applied Geographic Solutions S2025, IHSER Geography - PRULL9
 This report was prepared using data from private and government sources deemed to be reliable. The information herein is provided without representation or warranty.

DISCLAIMER

The information contained in the Offering Memorandum is proprietary and strictly confidential. It is furnished solely for the purpose of considering the purchase of Godwin Marketplace located at 3090-3098 Godwin Boulevard in Suffolk, VA (the "Property") and is not to be used for any other purposes. This information should not, under any circumstances, be made available or disclosed to any third party without the express written consent of Parker Burnell Real Estate Group or Owner, or used for any purpose whatsoever other than to evaluate the possible purchase of the Property. Parker Burnell Real Estate Group nor the Owner make any representation or warranty, express or implied, as to the accuracy or completeness of the information contained herein, and nothing contained herein is or shall be relied upon as a promise or representation as to the future performance of the Property. This Offering Memorandum may include certain statements and estimates by Parker Burnell Real Estate Group with respect to the future performance of the Property. These Assumptions may or may not be proven to be correct, and there can be no assurance that such estimates will be achieved. Parker Burnell Real Estate Group and the Owner disclaim any and all liability for representations or warranties, expressed or implied, contained in or omitted from this Offering Memorandum, or any other written or oral communication transmitted or made available to the recipient. The recipient shall be entitled to rely solely on those representations and warranties that may be made to it in any final, fully executed and delivered Real Estate Purchase and Sale Agreement between it and the Owner. The information contained herein is subject to change without notice and the recipient of these materials shall not look to Owner or Parker Burnell Real Estate Group, nor any of their officers, employees, representatives, independent contractors, or affiliates, for the accuracy or completeness thereof. Recipients of this Offering Memorandum are advised and encouraged to conduct their own comprehensive review and analysis of the Property. This Offering Memorandum is a solicitation of interest only and is not an offer to sell the Property. The Owner expressly reserves the right, at its sole discretion, to reject any or all expressions of interest to purchase the Property and expressly reserves the right, at its sole discretion, to terminate discussions with any entity at any time with or without notice. The Owner shall have no legal commitment of obligation to an entity reviewing this Offering Memorandum or making an offer to purchase the Property unless and until the Owner executes and delivers a signed Real Estate Purchase and Sale Agreement on terms acceptable to Owner, in Owner's sole discretion. By submitting an offer, a prospective purchaser will be deemed to have acknowledged the foregoing and agreed to release Owner and Parker Burnell Real Estate Group from any liability with respect hereto.



R. Troy Parker
Managing Broker/Partner
Parker Burnell Real Estate Group
1436 South Independence Blvd., Suite 200
Virginia Beach, Virginia 23462
(O) 757.222.0111
(F) 757.222.9455
(M) 757.407.9499
troy@parkerburnell.com

Jay Burnell
Partner | Development & Brokerage
Parker Burnell Real Estate Group
1436 South Independence Blvd., Suite 200
Virginia Beach, Virginia 23462
(O) 757.222.0111
(F) 757.222.9455
(M) 757.617.3511
jay@parkerburnell.com