

OXFORD CENTER

3548 W 8th St, Los Angeles, CA 90005



Highlights:

- Ground floor and Second floor spaces available for lease
- Conveniently located in Koreatown near Western Avenue & 8th Street
- Plenty of parking on site
- Elevator access
- Excellent visibility on 8th Street
- Across the street from The Rise Koreatown, a 364-unit apartment building (currently under construction)

Asking:

- Ground Floor Asking Rate: \$3.75/sf
- Second Floor Asking Rate: \$2.75/sf
- NNN: approx. \$1.00/sf



Ryan Oh
(213) 804-7548
roh@cbcwilshire.com
BRE 01082638

JW Baelly
(818) 321-6373
jw@cbcwilshire.com
BRE 01865026

Sang Joshua Lee
(213) 369-3014
slee@cbcwilshire.com
BRE 01980982

Alice Oh
(213) 925-6069
aoh@cbcwilshire.com
BRE 02129043



OXFORD CENTER

3548 W 8th St, Los Angeles, CA 90005



Coldwell Banker Commercial Wilshire Properties have obtained the information in this brochure from sources that they believe to be reliable. However, they have not verified its accuracy and make no guarantee, warranty or representation about it. It is submitted subject to the possibility of errors, omissions, change of price, rental or other conditions, prior sale, lease or financing, or withdrawal without notice. Coldwell Banker Commercial Wilshire Properties has included projections, opinions, assumptions or estimates for example only, and they may not represent current or future performance of the property. You and your tax and legal advisors should conduct your own investigation of the property and transaction.

OXFORD CENTER

3548 W 8th St, Los Angeles, CA 90005

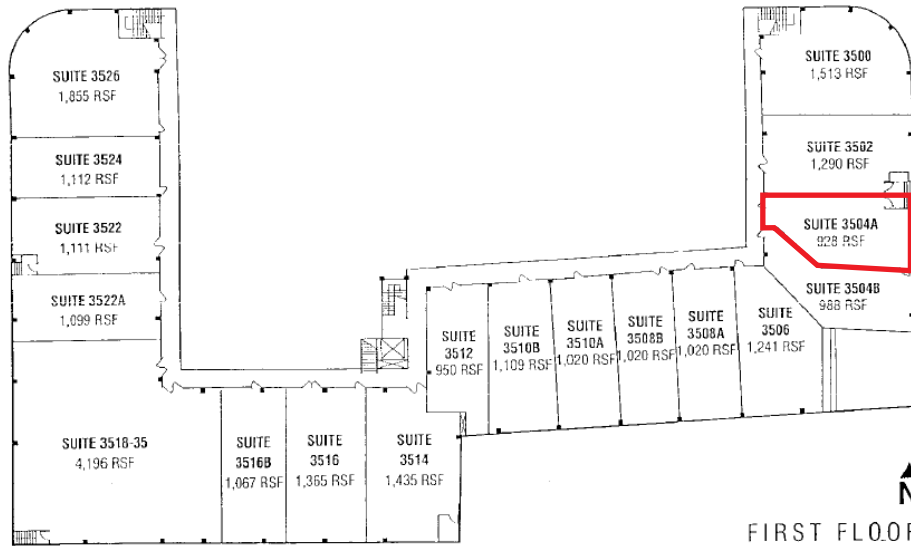

First Floor Tenants:

Suite 3526: Honey Night
Suite 3524: Hook Me Roll
Suite 3522: Thank Pho
Suite 3522A: K&C Hair
Suite 3520: Jung Kwan Jang Ginseng Shop
Suite 3518: Clinica Humanitaria Medical
Suite 3516B: Hyo Yeon Lau & Steve Lau
Suite 3616: Two Zone Chicken
Suite 3514: Potions & Poisons
Suite 3512: I Love Boba
Suite: 3510B: Shila Jewelry
Suite 3510A: Creamistry
Suite 3508B: Vitamin Outlet
Suite 3508A & 3506: Cconma Shopping Mall
Suite 3504B: **Vacant (988 sf)**
Suite 3504A: Shipping Company (proposed)
Suite 3502: Liquor Market
Suite 3500: Slurping Ramen

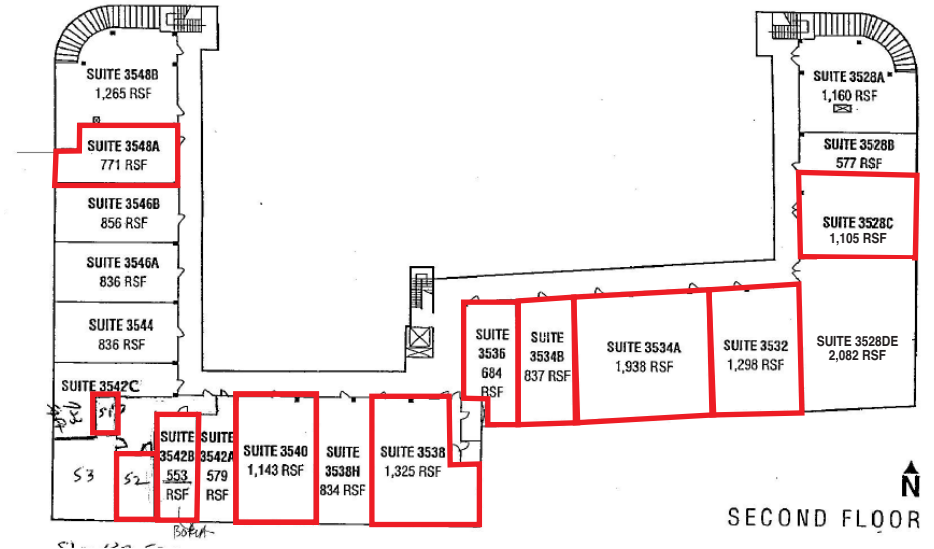

Second Floor Tenants:

Suite 3548B: Pilates
Suites 3548A: **Vacant (771 sf)**
Suite 3546B: Hyun Dai Amiwon
Suite 3546A: Tattoo
Suite 3544: Dentistry
Suite 3542C: Serrano Inc.
Storage 51: **Vacant (137 sf)**
Storage 52: **Vacant (403 sf)**
Storage 53
Suite 3542B: **Vacant (553 sf)**
Suite 3542A: Massage
Suite 3540: **Vacant (1,143 sf)**
Suite 3538H: Money Gram
Suite 3538: **Vacant (1,325 sf)**
Suite 3536: **Vacant (684 sf)**
Suite 3534B: **Vacant (837 sf)**
Suite 3534A: **Vacant (1,938 sf)**
Suite 3532: **Vacant (1,298 sf)**

Suite 3528E: Rudolph & Sletten, Inc.
Suite 3528C: **Vacant (1,105 sf)**
Suite 3528B: Dress Shop
Suite 3528A: Vape Shop

OXFORD CENTER

3548 W 8th St, Los Angeles, CA 90005



Demographics:

- 42,684**
Vehicles per day on Western Ave
- 113,052**
Population (1-mile radius)
- 669,654**
Population (3-mile radius)
- \$47,089**
Median HH Income (1-mile radius)
- \$49,602**
Median HH Income (3-mile radius)
- 37.7**
Median Age

Coldwell Banker Commercial Wilshire Properties have obtained the information in this brochure from sources that they believe to be reliable. However, they have not verified its accuracy and make no guarantee, warranty or representation about it. It is submitted subject to the possibility of errors, omissions, change of price, rental or other conditions, prior sale, lease or financing, or withdrawal without notice. Coldwell Banker Commercial Wilshire Properties has included projections, opinions, assumptions or estimates for example only, and they may not represent current or future performance of the property. You and your tax and legal advisors should conduct your own investigation of the property and transaction.