

UNIT 3 TO LET

6,039 ft² (561 m²)



SECURE
YARD



TO BE
REFURBISHED



GOOD TRANSPORT
CONNECTIONS TO M25 &
CENTRAL LONDON



www.ipif.com/biltonroad

INDUSTRIAL / WAREHOUSE UNIT TO LET

BILTON ROAD INDUSTRIAL ESTATE
MANOR ROAD, ERITH, KENT, DA8 2AN

IPIF



LOCATION

The Bilton Road Industrial Estate is located off Manor Road in an established industrial location. The A2016 provides direct access to the Dartford Northern Relief Road to the east and subsequently Junction 1 of the M25 approximately five miles distant. To the west the A206 provides access to Greenwich and the A102(M) into Central London.

DESCRIPTION

This established industrial estate comprises of a number of detached brick built units many of which sit within their own secure sites. Generally constructed around steel portal frames or with trussed roofs the properties offer traditional industrial or warehouse space with clear internal heights up to 6 metres and loading access from the yard. Each building benefits from an office area and staff WC facilities. Individual details of the specific units are available below.

SPECIFICATION

- 3.5m clear internal height
- Gated rear yard with shared access
- 3x roller shutter doors
- LED lighting throughout
- Seperate male & female WCs

ACCOMMODATION

Available accommodation comprises of the following gross internal areas:

| UNIT 3 | M ² | FT ² | EPC |
|--------------|----------------|-----------------|-------------------|
| GF Warehouse | 469 | 5,052 | Minimum Target: B |
| GF Office | 92 | 987 | |
| Total | 561 | 6,039 | |

LEASE TERMS

The units are available on a new full repairing and insuring lease.

BUSINESS RATES

Interested parties are advised to contact London Borough of Bexley to confirm actual rates liability.

SERVICE CHARGE

A service charge is levied for the upkeep and maintenance of the common areas. Further details are available upon request.

LEGAL COSTS

Each party will be responsible for their own legal costs.

VAT

All figures quoted are exclusive of VAT, which is applicable on all IPIF Estates.

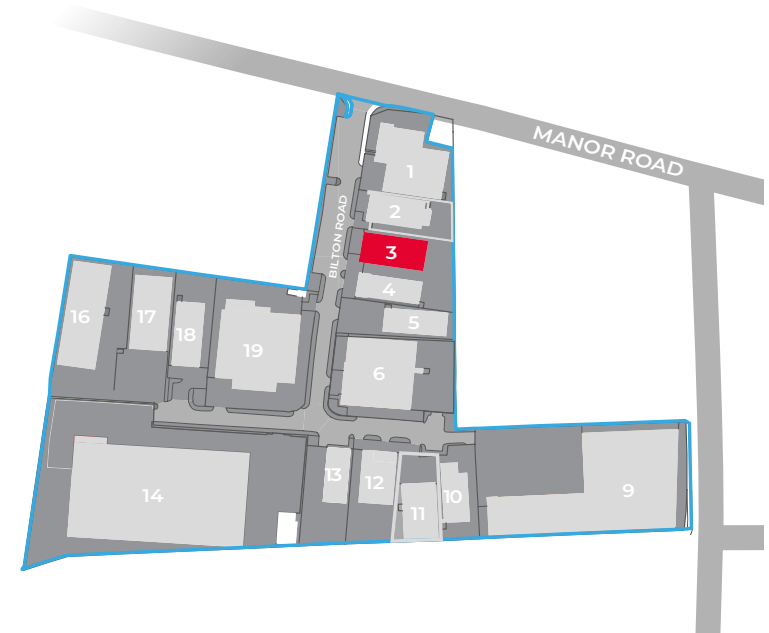

On behalf of the landlord

IPIF
0800 804 8600
www.ipif.com

Lewis Callanan
lewis.callanan@ipif.co.uk

Ryan
01322 285 588
ryan.com/agency

Tom Booker
tom.booker@ryan.com
07584 237 141

Christopher Birch
christopher.birch@ryan.com
07966 681 951