

11800-11850 BELDEN CT.

UNIT #11850

LIVONIA, MICHIGAN

INDUSTRIAL FOR LEASE

6,125 Square Feet Available



**SIGNATURE
ASSOCIATES**
KNOW SIGNATURE | KNOW RESULTS

BELDEN INDUSTRIAL PARK



PROPERTY FEATURES

- 6,125 square feet available (north half)
- 1,700 square feet of office / showroom
- 16' clear height in warehouse
- (1) 12x14 grade level door
- Zoned M-1
- Office area features large open area with one large executive office/conference room, showroom, and kitchen
- Facility has been completely renovated
- Warehouse features new epoxy floor, painted block walls with grey dado and new LED light fixtures
- Lease Rate: \$7.95/sq. ft. NNN



For more information, please contact:

GARY SALLEN

(248) 948 0105

gsallen@signatureassociates.com

SIGNATURE ASSOCIATES

One Towne Square, Suite 1200

Southfield, MI 48076

www.signatureassociates.com

Site Plan

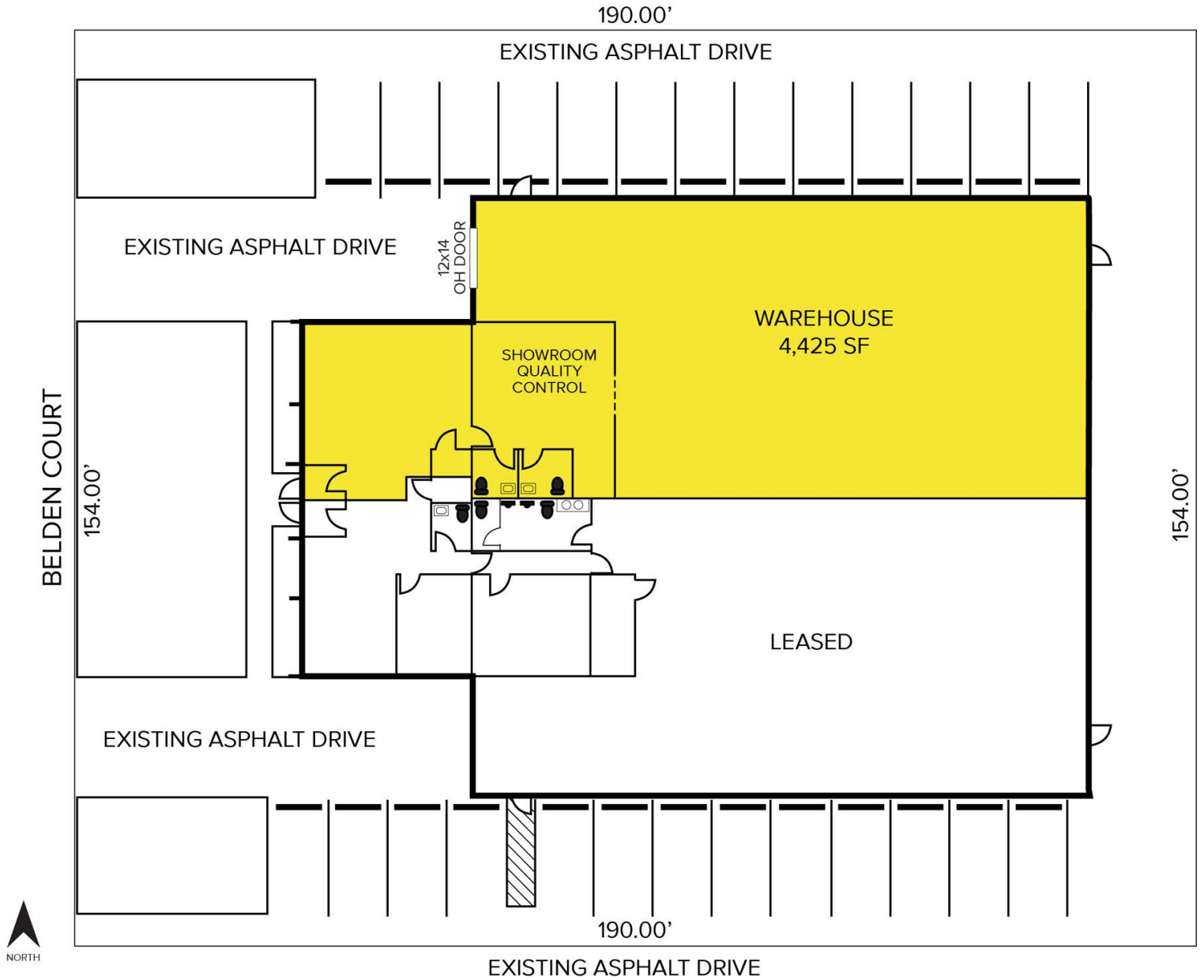

For more information, please contact:

GARY SALLEN
(248) 948 0105
gsallen@signatureassociates.com

SIGNATURE ASSOCIATES
One Towne Square, Suite 1200
Southfield, MI 48076
www.signatureassociates.com

11800-11850 Belden Ct. Unit #11850 - Livonia, MI

Industrial For Lease

6,125
Square Feet
AVAILABLE

Aerial



For more information, please contact:

GARY SALLEN
(248) 948 0105
gsallen@signatureassociates.com

SIGNATURE ASSOCIATES
One Towne Square, Suite 1200
Southfield, MI 48076
www.signatureassociates.com