

6501 WESTON

OFFICE FOR LEASE
CARY, NC



NAI TRI PROPERTIES

6501 WESTON

DETAILS

Located in Cary's premiere office neighborhood, 6501 Weston Parkway offers abundant nearby amenities including access to 100+ miles of Greenways for walking, running, and biking. Nearby companies include SAS, MetLife, Verizon, Deutsche Bank, Biologics, John Deere and more.

- ADDRESS** 6501 Weston Parkway, Cary NC 27513
- AVAILABLE SPACE** Suite 200 - 32,917 RSF
Suite 350 - ~12,500 RSF, divisible to 3,000 RSF
- RENTAL RATE** \$29.75, Full Service
- PARKING** 4 per 1,000 square feet
- FEATURES**
- NEW lobby refresh
 - NEW alfresco gathering space
 - Monument & Building signage available
 - Showers on 1st floor
 - 2 passenger elevators
 - Dock high loading dock
 - Multi-purpose trails with connection to Lake Crabtree and Umstead State Park
 - Amenity-rich environment including Park West Village and The Arboretum at Weston

CONTACT
ROBIN ROSEBERRY ANDERS, SIOR 919.369.6713 randers@triprop.com
LEE BISHOP 919.609.6331 lbishop@triprop.com
THOMAS FLYNN 704.999.8504 tflynn@triprop.com

NAI TRI PROPERTIES





CONTACT

ROBIN ROSEBERRY ANDERS, SIOR
LEE BISHOP
THOMAS FLYNN

919.369.6713
919.609.6331
704.999.8504

randers@triprop.com
lbishop@triprop.com
tflynn@triprop.com

NAI TRI PROPERTIES

6501 WESTON

SECOND FLOOR



SUITE 200
32,917 RSF



CLICK OR
SCAN FOR
VIRTUAL
TOUR

CONTACT

ROBIN ROSEBERRY ANDERS, SIOR 919.369.6713 randers@triprop.com
LEE BISHOP 919.609.6331 lbishop@triprop.com
THOMAS FLYNN 704.999.8504 tflynn@triprop.com



6501 WESTON

THIRD FLOOR

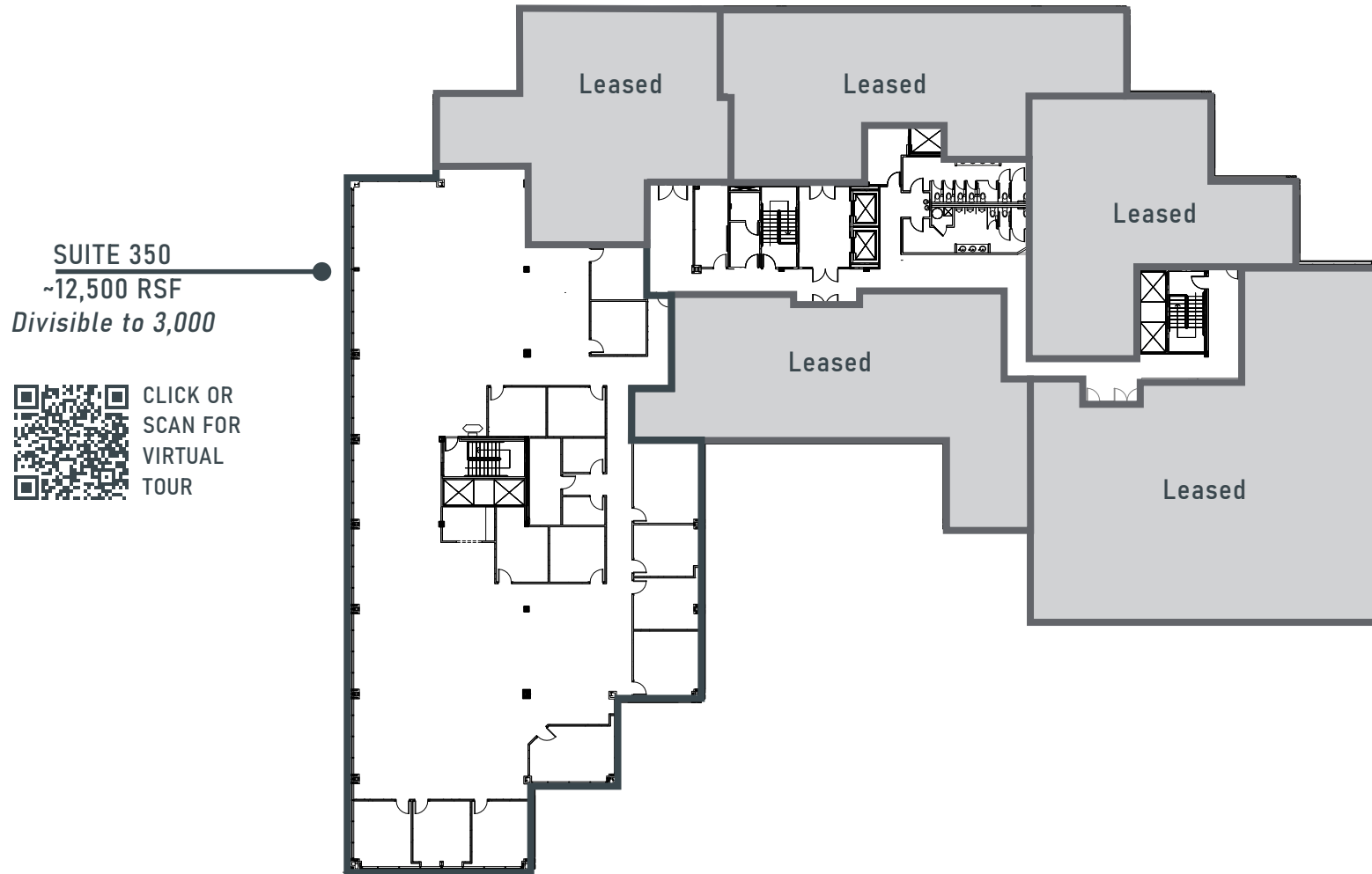

CONTACT

ROBIN ROSEBERRY ANDERS, SIOR
LEE BISHOP
THOMAS FLYNN

919.369.6713 randers@triprop.com
919.609.6331 lbishop@triprop.com
704.999.8504 tflynn@triprop.com

6501 WESTON CONNECTIVITY



LAKE CRABTREE COUNTY PARK

NORWELL BLVD

WESTON PARKWAY

6501 WESTON
PARKWAY



CONTACT

| | | |
|------------------------------|--------------|---------------------|
| ROBIN ROSEBERRY ANDERS, SIOR | 919.369.6713 | randers@triprop.com |
| LEE BISHOP | 919.609.6331 | lbishop@triprop.com |
| THOMAS FLYNN | 704.999.8504 | tflynn@triprop.com |

NAI TRI PROPERTIES

6501 WESTON

AMENITIES

FOOD

Alpaca Peruvian Chicken
 Another Broken Egg Café
 B.GOOD
 Bad Daddy's Burger
 Blaze Pizza
 Bottles & Cans Beer & Wine Shop
 Buffalo Wild Wings
 CAVA
 Chili's Grill
 Chipotle
 Domino's Pizza
 Eastern China
 Firebirds
 Guasaca
 Happycakes Cupcakery
 Hipoke
 Hot Breads Café
 Jasmin & Olivz
 Kilwins Morrisville
 Los Magueyes, Fajita House
 Marco's Pizza
 Meeple's Brew
 Panera Bread
 Penn Station East Coast Subs
 Potbelly Sandwich
 Rise
 Ruckus Pizza
 Smoothie King
 Starbucks
 Swagat Indian
 Taipei Café
 Wendy's
 Which Wich
 Winestore

SERVICES & SHOPPING

AMC Park Place 16 Cinema
 Bath & Body Works
 BB&T
 Buybuy Baby
 Carter's
 Chico's
 Cosmo Spa and Nails
 CPR Cell Phone Repair
 Deluxe Cleaners
 Faby-lous Hair
 Home Goods
 LOFT
 Massage Envy
 Michaels
 Park West Nail Spa
 Park West Village 14 Cinema
 PetSmart
 Post Office
 Rack Room Shoes
 Ross Dress For Less
 Rush Cycle
 Salon Lofts
 Scout & Molly's
 Sola Salon Studios
 Soma
 T.J. Maxx
 Target
 The UPS Store
 T-Mobile
 Ulta Beauty
 Versona
 White House Black Market

FITNESS

Excel Body Fitness
 O2 Fitness
 Orangetheory Fitness

CONTACT

| | | |
|------------------------------|--------------|---------------------|
| ROBIN ROSEBERRY ANDERS, SIOR | 919.369.6713 | randers@triprop.com |
| LEE BISHOP | 919.609.6331 | lbishop@triprop.com |
| THOMAS FLYNN | 704.999.8504 | tflynn@triprop.com |

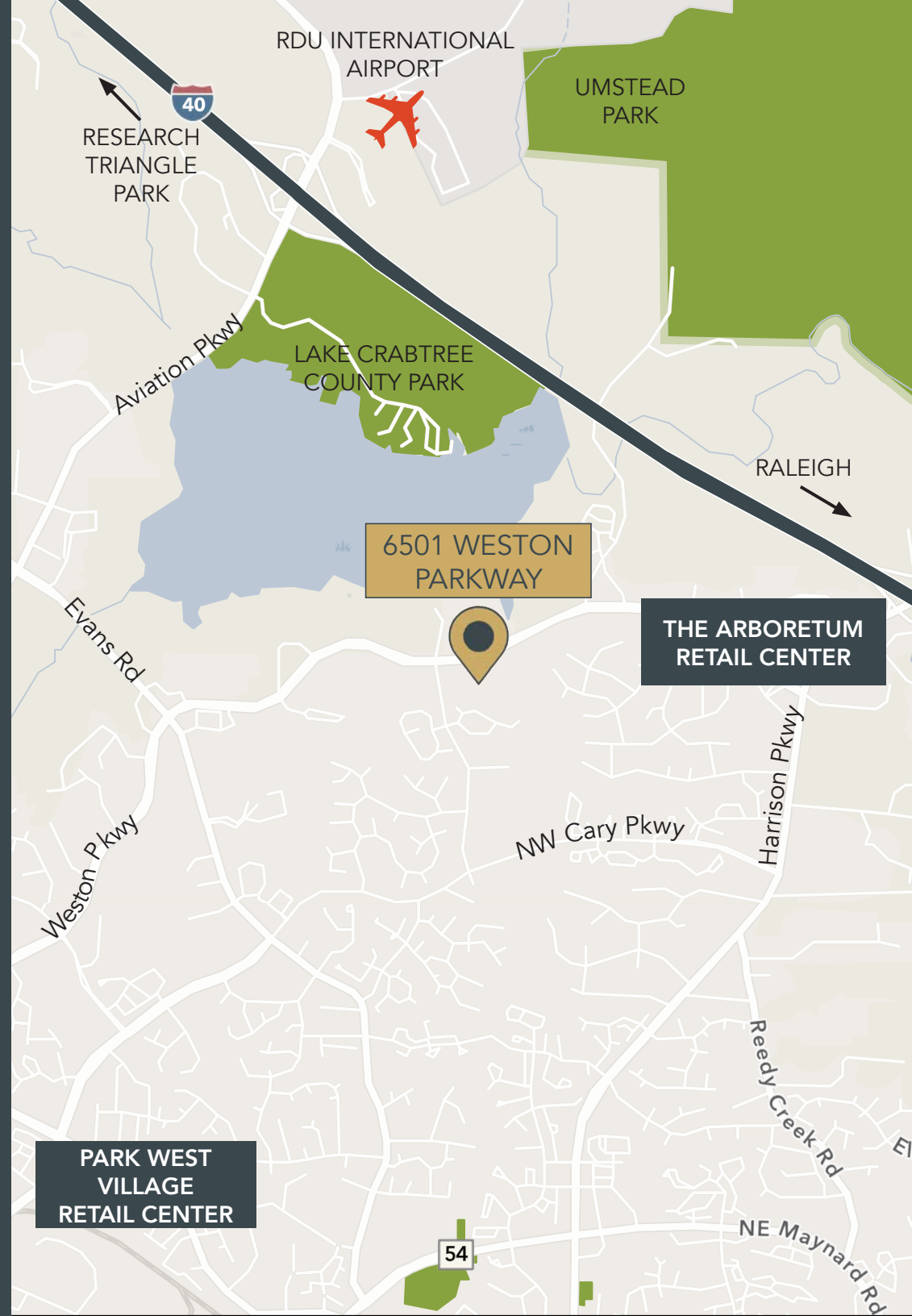

6501 WESTON

THE TRIANGLE AREA

AIRPORT

RDU International Airport 5.2 Miles

RESEARCH HUBS & MAJOR UNIVERSITIES

Research Triangle Park 9 Miles
Duke University 18.1 Miles
NC State University 8.6 Miles
UNC Chapel Hill 17.8 Miles
Centennial Campus 10 Miles

SURROUNDING AREAS

Morrisville 1.1 Miles
Downtown Durham 16.4 Miles
Chapel Hill 21.1 Miles
Downtown Raleigh 13.5 Miles

CONTACT

ROBIN ROSEBERRY ANDERS, SIOR 919.369.6713 randers@triprop.com
LEE BISHOP 919.609.6331 lbishop@triprop.com
THOMAS FLYNN 704.999.8504 tflynn@triprop.com

NAI TRI PROPERTIES

