

406 S. Broad

Sketch

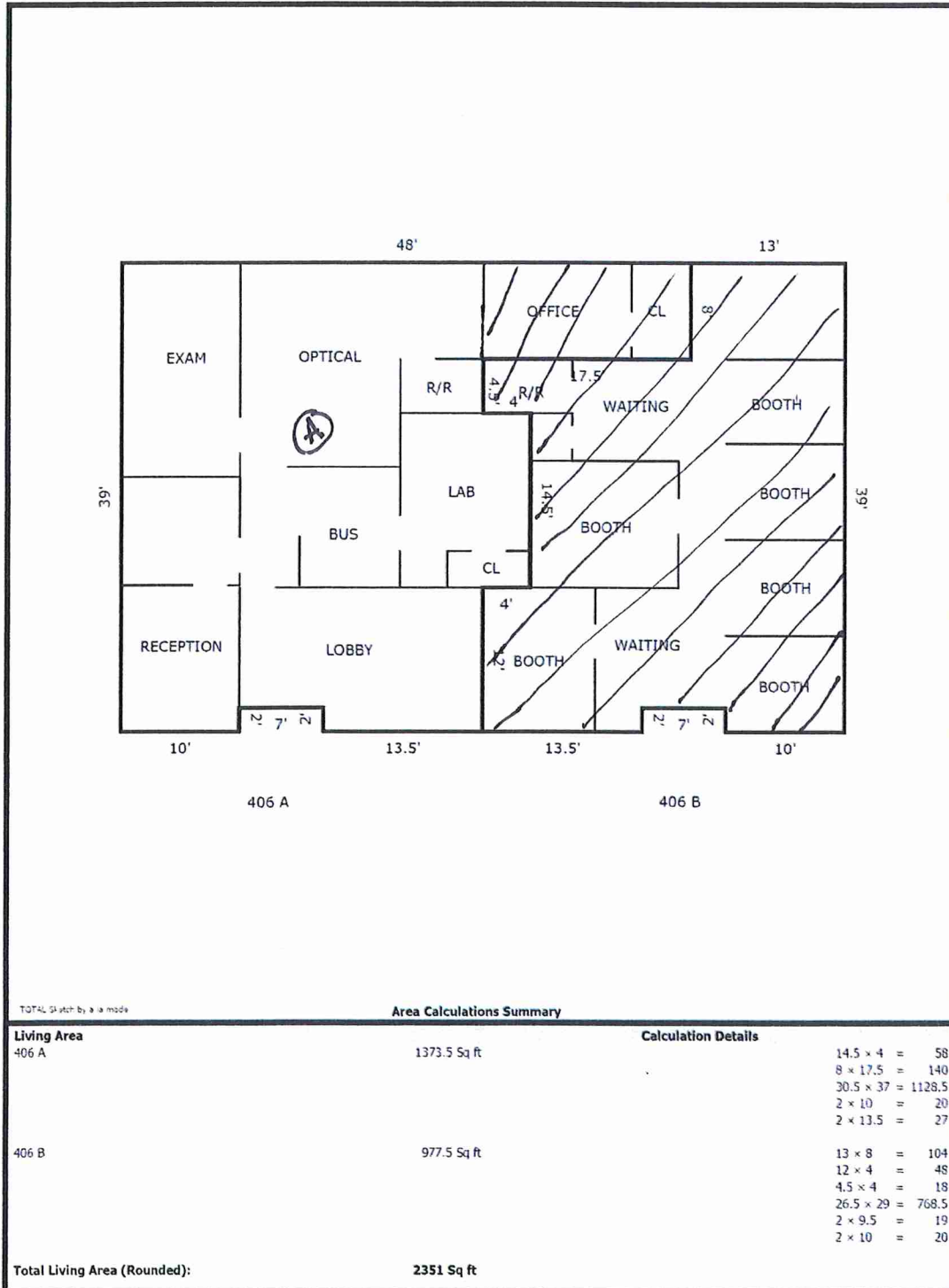

TOTAL Sketch by a la mode

Area Calculations Summary

Living Area	Area	Calculation Details
406 A	1373.5 Sq ft	$14.5 \times 4 = 58$ $8 \times 17.5 = 140$ $30.5 \times 37 = 1128.5$ $2 \times 10 = 20$ $2 \times 13.5 = 27$
406 B	977.5 Sq ft	$13 \times 8 = 104$ $12 \times 4 = 48$ $4.5 \times 4 = 18$ $26.5 \times 29 = 768.5$ $2 \times 9.5 = 19$ $2 \times 10 = 20$
Total Living Area (Rounded):	2351 Sq ft	

TOTAL Sketch software by a la mode technologies, llc. 1-800-alamode