

REDBIRD INDUSTRIAL PARK

4303 Shilling Way | Dallas, Texas 75237



11,130 SF FOR LEASE

PROPERTY HIGHLIGHTS

- Building size: 74,373 SF
- Available SF: 11,130 SF
- Clear height: 20'
- Year built: 1979
- Fully sprinklered
- Easy access to major thoroughfares
- Institutionally owned



Canon Shoultz
972.280.8328
cshoultz@holtlunsford.com

CONTACT
Luke Floyd
972.585.5109
lfloyd@holtlunsford.com

REDBIRD INDUSTRIAL PARK

4303 Shilling Way | Dallas, Texas 75237

FLOOR PLAN

11,130 SF FOR LEASE

SUITE HIGHLIGHTS

- 11,130 SF available
- 1,244 SF office
- One (1) overhead door
- One (1) ramped door
- 20' clear height

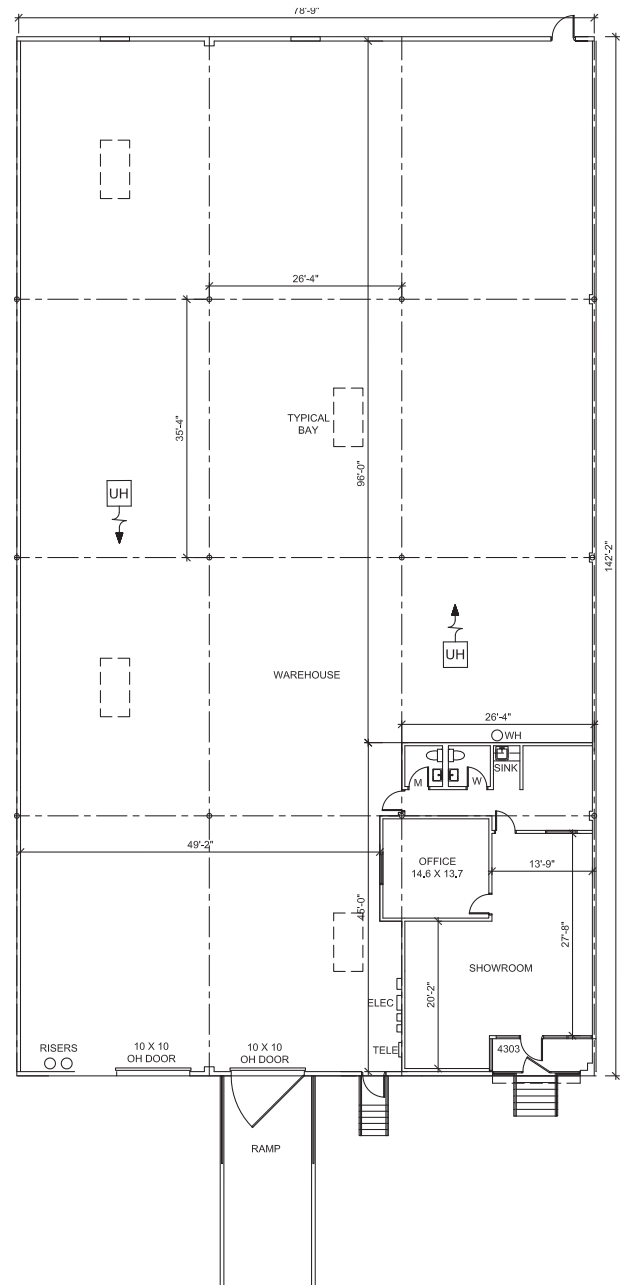

SITE PLAN



Canon Shoultz
972.280.8328
cshoultz@holtlunsford.com

CONTACT
Luke Floyd
972.585.5109
lfloyd@holtlunsford.com

