

High-end creative sublease with exterior decks & new finishes

FOR SUBLEASE 2623 Camino Ramon, San Ramon CA

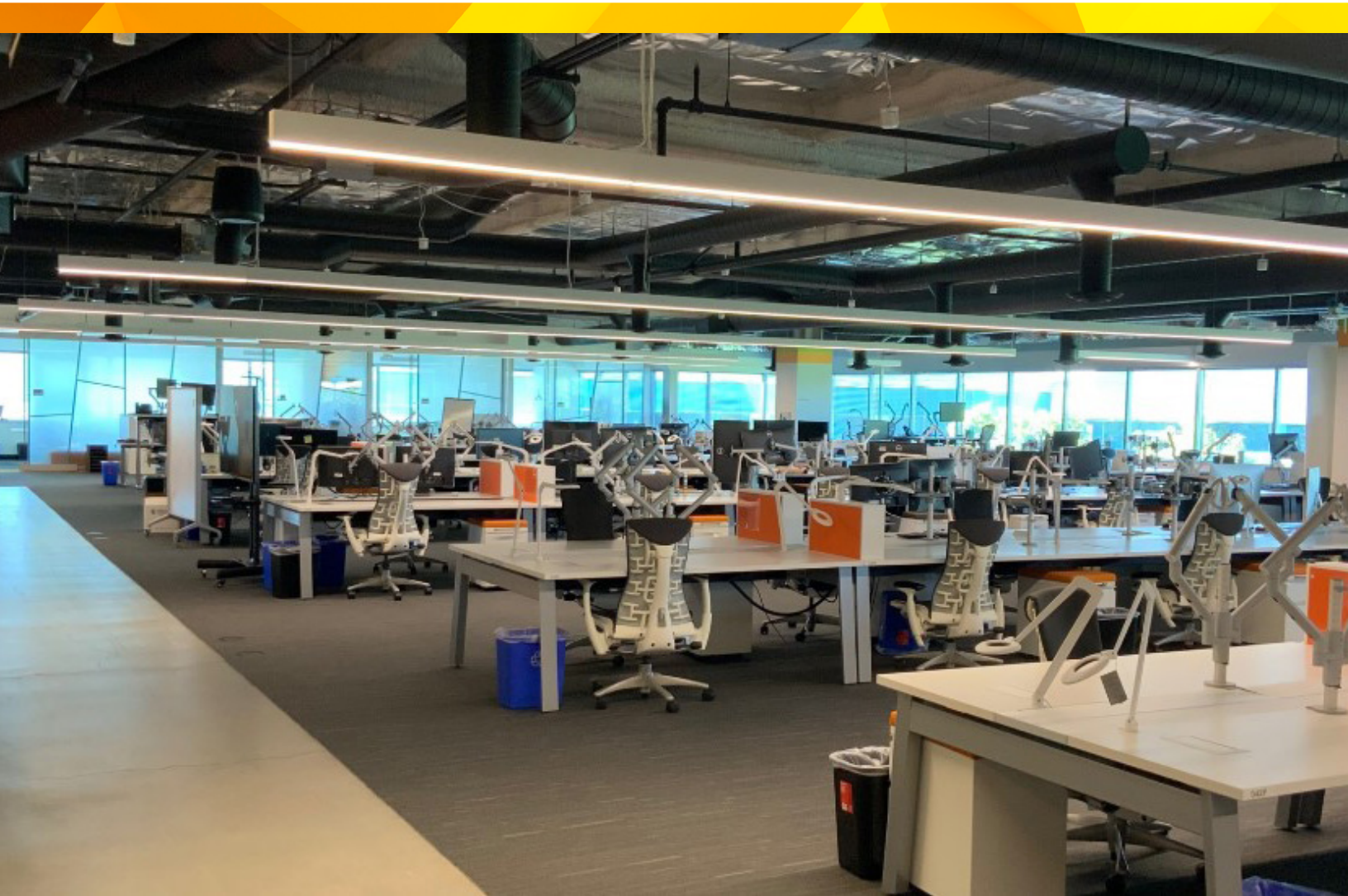

SPACE PROFILE

48,915 RSF (Divisible to 10,000 RSF)
Total SF

5th
Floor

\$2.00 PSF
Rental rate

Immediate
Availability

9/30/2028
Term



KEY HIGHLIGHTS

- High end creative sublease with exterior decks and brand new finishes
- Top Floor, Space can be divisible on a shared basis.
- Full plug and play with brand new furniture
- Creative design and high end finishes throughout
- Multiple large exclusive outdoor decks
- Mount Diablo views
- 5 minute walk to City Center Bishop Ranch

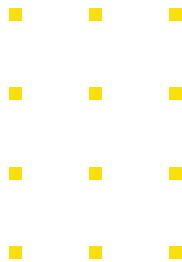

5TH FLOOR 48,915 SF Total Available

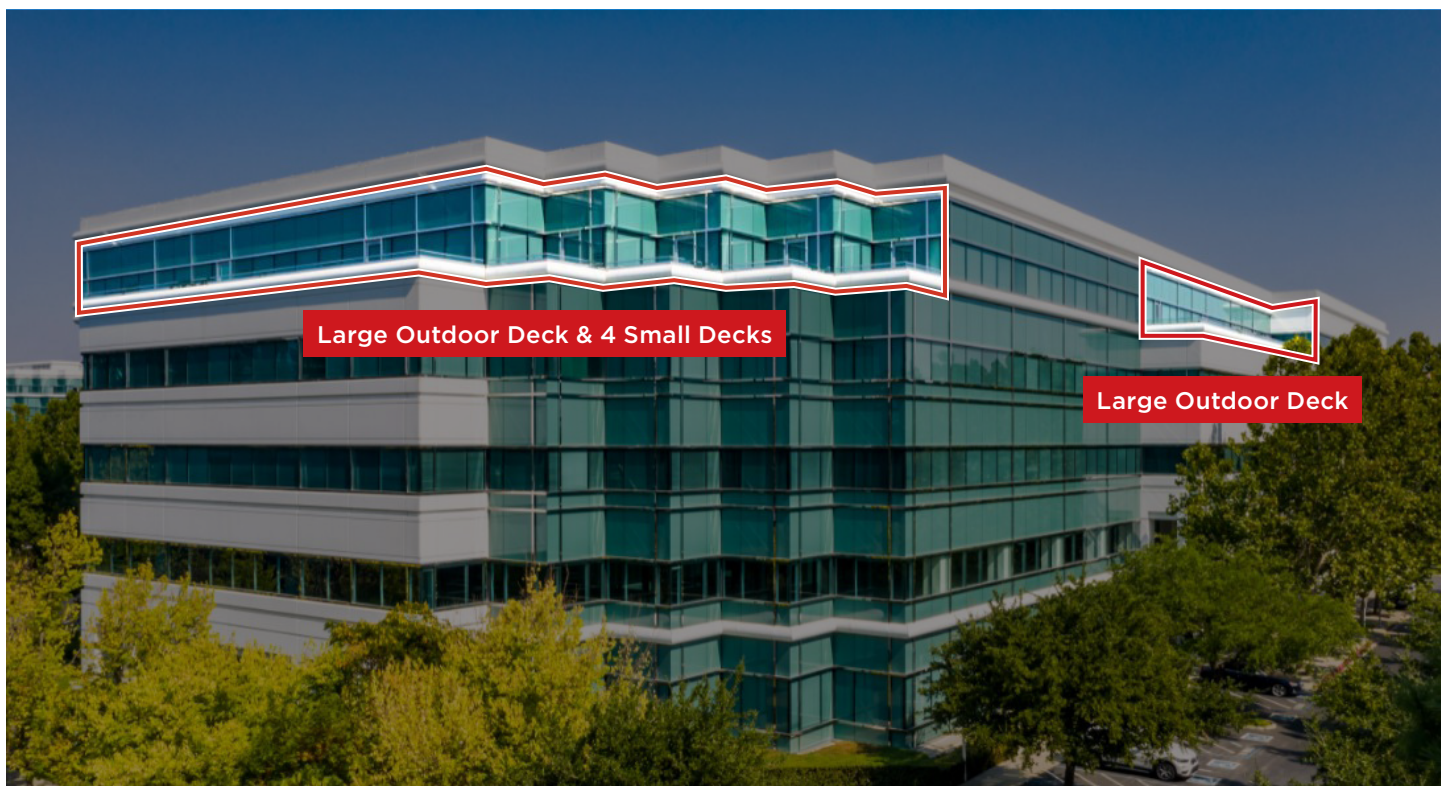
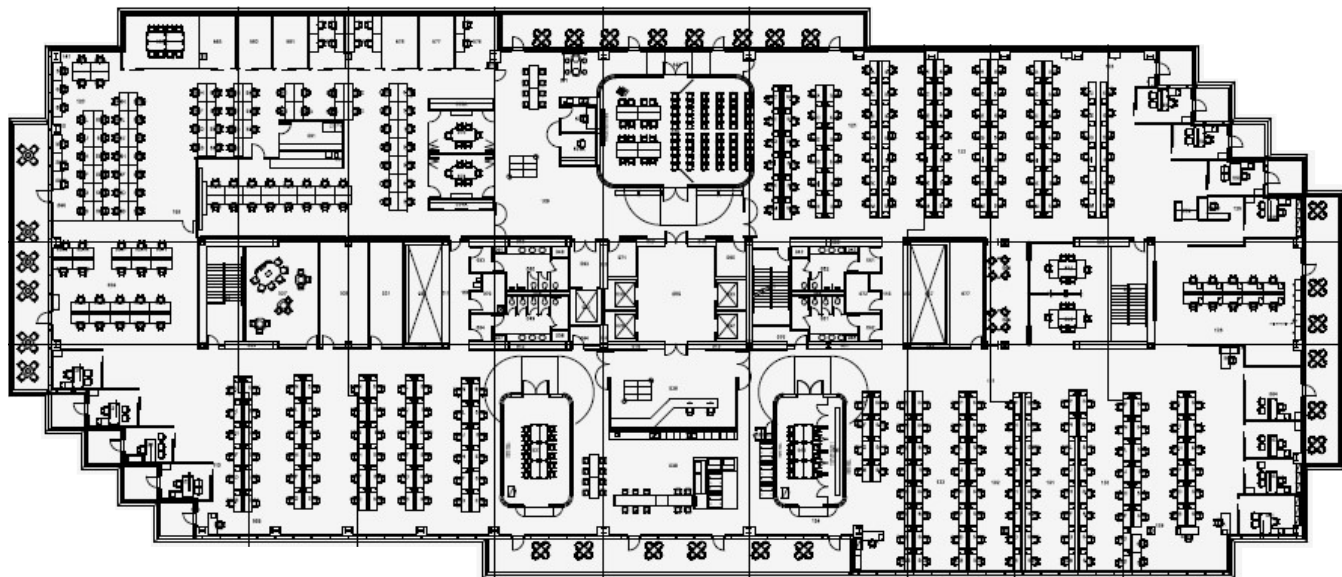

Mike McCandless
+1 415 617 9645
mmccandless@savills.us
License 01379739

Denis Karas
+1 415 617 9646
dkaras@savills.us
License 02099334

savills The information contained in this communication has been obtained from a variety of sources believed to be reliable but has not been verified. NO WARRANTY OR REPRESENTATION, EXPRESS OR IMPLIED, IS MADE AS TO THE CONDITION OF THE PROPERTY OR ACCURACY OR COMPLETENESS OF THE INFORMATION CONTAINED HEREIN AND SAME IS SUBMITTED SUBJECT TO ERRORS, OMISSIONS, CHANGE OF PRICE, RENTAL OR OTHER CONDITIONS, WITHDRAWAL WITHOUT NOTICE AND TO ANY SPECIFIC CONDITIONS IMPOSED BY THE PROPERTY OWNER OR LESSOR.