



Rawson Avenue Business Center II

E Rawson Avenue at S Millers Way
Oak Creek, WI 53154

About the Property

Rawson Avenue Business Center II consists of more than 152,800 square feet of office/retail and flex/R&D space. The business center is located just east of E Rawson Avenue and S Howell Avenue, just 2 miles east of Interstate 94. The project offers great visibility to the busy Howell Avenue corridor.



For more information on Rawson Avenue Business Center II, visit: sjpi.com/rawson2



Total SF Available:
2,944 up to 12,032 SF

New flex/R&D with 18 ft. clear height and drive-in loading

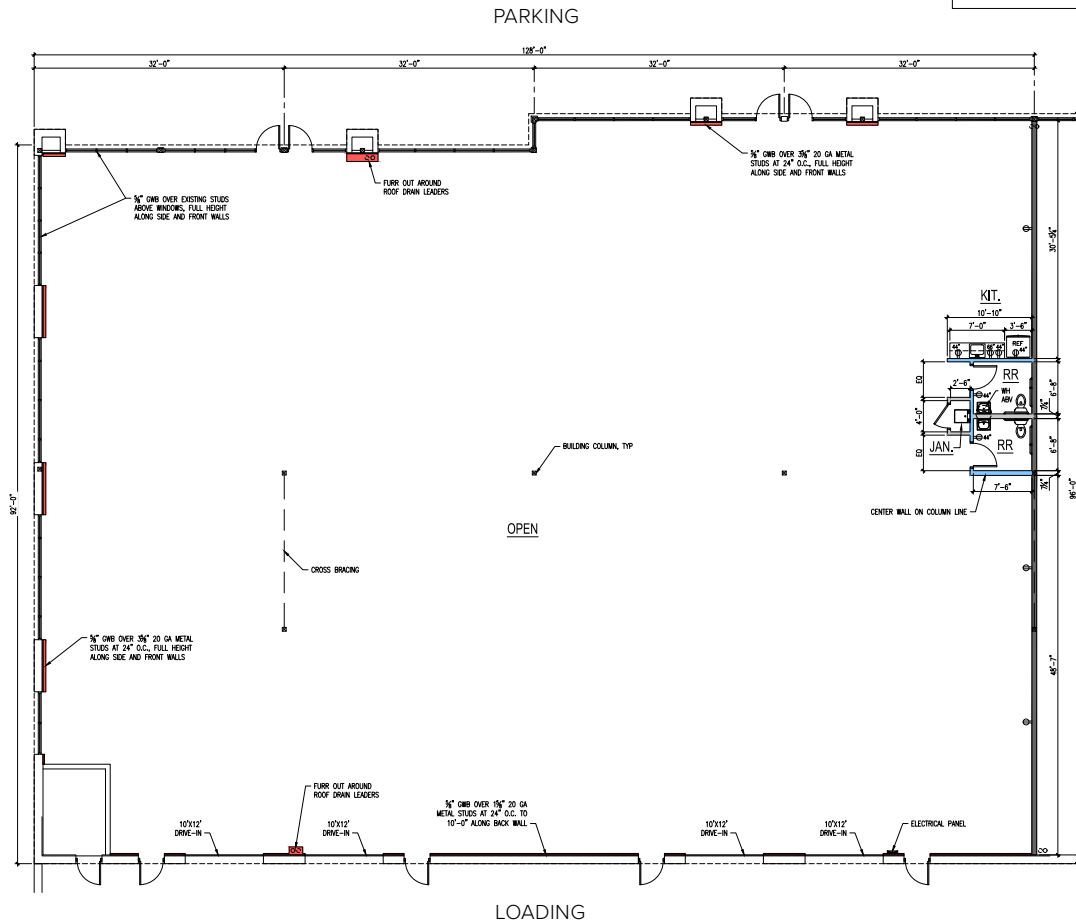
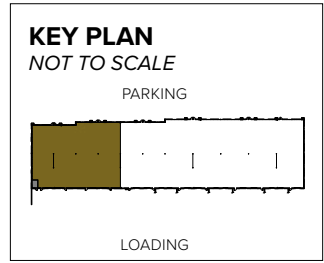

Note: This space plan is subject to existing field conditions. This drawing is proprietary and the exclusive property of St. John Properties, Inc. Any duplications, distribution, or other unauthorized use is strictly prohibited.

Specifications

Office/Retail Buildings

7126 S Millers Way 38,280 SF

Building Specifications

Ceiling Height 16 ft. clear minimum

Parking 4 per 1,000 SF

Loading Dock or drive-in

Zoning LM-1 PUD

Flex/R&D Buildings

7198 S Millers Way 38,176 SF

7236 S Millers Way 38,176 SF

7308 S Millers Way 38,176 SF

Building Specifications

Ceiling Height 18 ft. clear minimum

Parking 4 per 1,000 SF

Loading Dock or drive-in

Zoning LM-1 PUD

Availabilities

Flex/Office Space at Rawson Avenue Business Center II

2,880–23,400 sq. ft.	7126 S. Millers Way	Ste. 103-110	New office/retail with 16 ft. clear heights, dock and drive-in loading; good visibility off of E. Rawson Avenue
Up to 12,032 sq. ft.	7198 S. Millers Way	Ste. 201-204	New flex/R&D with 18 ft. clear height and drive-in loading
Up to 20,000 sq. ft.	7198 S. Millers Way	Ste. 207-211	New flex/R&D with 18 ft. clear height and dock/drive-in loading
Up to 38,176 sq. ft.	7236 S. Millers Way	Ste. 301-311	Coming soon! New flex/R&D with 18 ft. clear height and dock/drive-in loading
Up to 38,176 sq. ft.	7308 S. Millers Way	Ste. 401-412	Coming soon! New flex/R&D with 18 ft. clear height and dock/drive-in loading

Contact Us

Gregory Fax

Regional Partner, Wisconsin

GFax@sjpi.com | 262.524.0100

Wisconsin Regional Office:

2000 Pewaukee Road | Suite A

Waukesha, WI 53188



262.524.0100 | SJPI.COM/WISCONSIN