



Office Space For Lease

Building Highlights

- > High speed internet access available
- > Individual HVAC units
- > Highly visible and accessible at the confluence I-25, US-36, and I-76
- > Responsive, professional management

For more information please visit:
www.clearcreekleasing.com

Clear Creek Business Center

6810 N. Broadway | J/N | Denver, CO 80221

Suite Information

Unit:	J/N
Size:	Unit J - 5,746 SF Unit N - 2,419 SF Total - 8,165 SF
Office:	60%
Lease Rate:	Negotiable
Est. 2026 Op. Ex.:	\$7.01/SF
Zoning:	PUD
Parking:	2.7:1,000 SF parking ratio
Sprinkler:	No
Available:	Immediately

For Lease

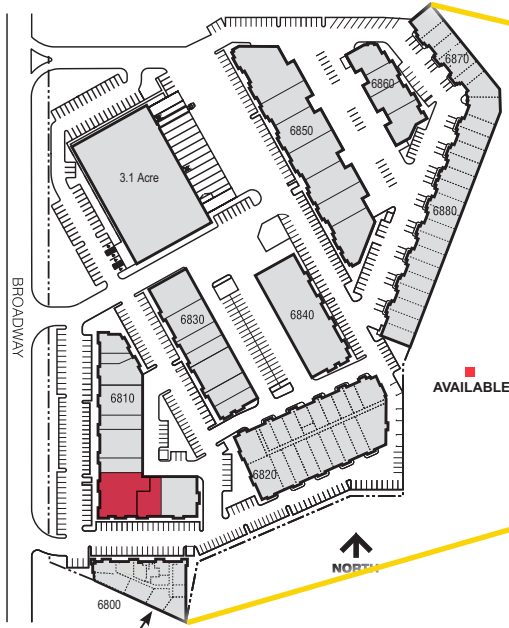

Floor Plan | J/N

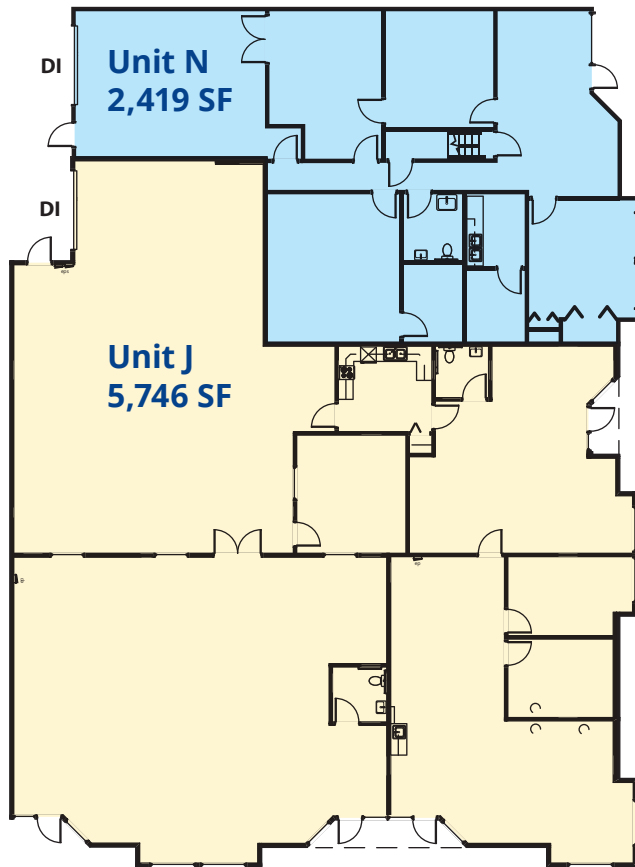

Contact us:

T.J. Smith, SIOR

Principal
+1 303 283 4576
tj.smith@colliers.com

Matt Keyerleber

Principal
+1 720 284 7100
matt.keyerleber@colliers.com



BROKERAGE
DISCLOSURE

Colliers

4643 S. Ulster Street, Suite 1000
Denver, CO 80237
P: +1 303 745 5800
F: +1 303 745 5888