

FOR LEASE

CHESTERFIELD MEADOWS

6411-6551 Centralia Road | Chesterfield, VA 23832



S.L. NUSBAUM
REALTY CO.



BOB BUTCHER

Senior Vice President

C. 804.387.8194

O. 804.320.7600

bbutcher@slnusbaum.com

ANDREW THACKER

Vice President

C. 804.357.6075

O. 804.320.7600

athacker@slnusbaum.com

NATHAN SHOR

Senior Vice President | Partner

C. 804.539.7404

O. 804.944.2399

nshor@slnusbaum.com

PROUD PARTNER

XTEAM

RETAIL ADVISORS

PROPERTY SUMMARY

CHESTERFIELD MEADOWS

6411-6551 Centralia Road | Chesterfield, VA 23832



S.L. NUSBAUM
REALTY CO.

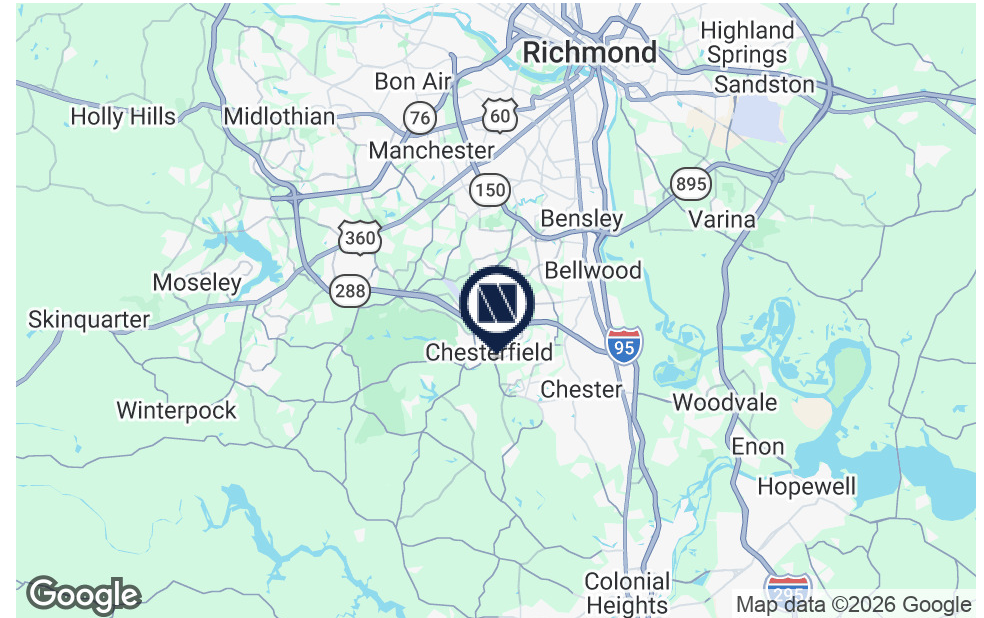

OFFERING SUMMARY

Lease Rate:	Contact Agents
Building Size:	167,146 SF
Available SF:	1,750 - 2,500 SF

DEMOGRAPHICS

	1 MILE	3 MILES	5 MILES
Total Population	5,419	31,148	87,841
Daytime Population	9,735	31,427	79,853
Total Households	2,052	11,878	32,639
Average HH Income	\$81,240	\$104,645	\$101,108

PROPERTY OVERVIEW

Located at the signalized intersection of Centralia Road and Iron Bridge Road

PROPERTY HIGHLIGHTS

- A thriving trade area - less than one mile from Chesterfield County Courthouse complex
- Daytime employment $\pm 7,399$ within 1 mile; $\pm 16,111$ within 3 miles; $\pm 33,407$ within 5 miles
- Located in the highly sought after residential growth corridor
- Features excellent access and exposure on Centralia and Iron Bridge Roads and close proximity to Rt. 288

SITE PLAN

CHESTERFIELD MEADOWS

6411-6551 Centralia Road | Chesterfield, VA 23832



S.L. NUSBAUM
REALTY CO.

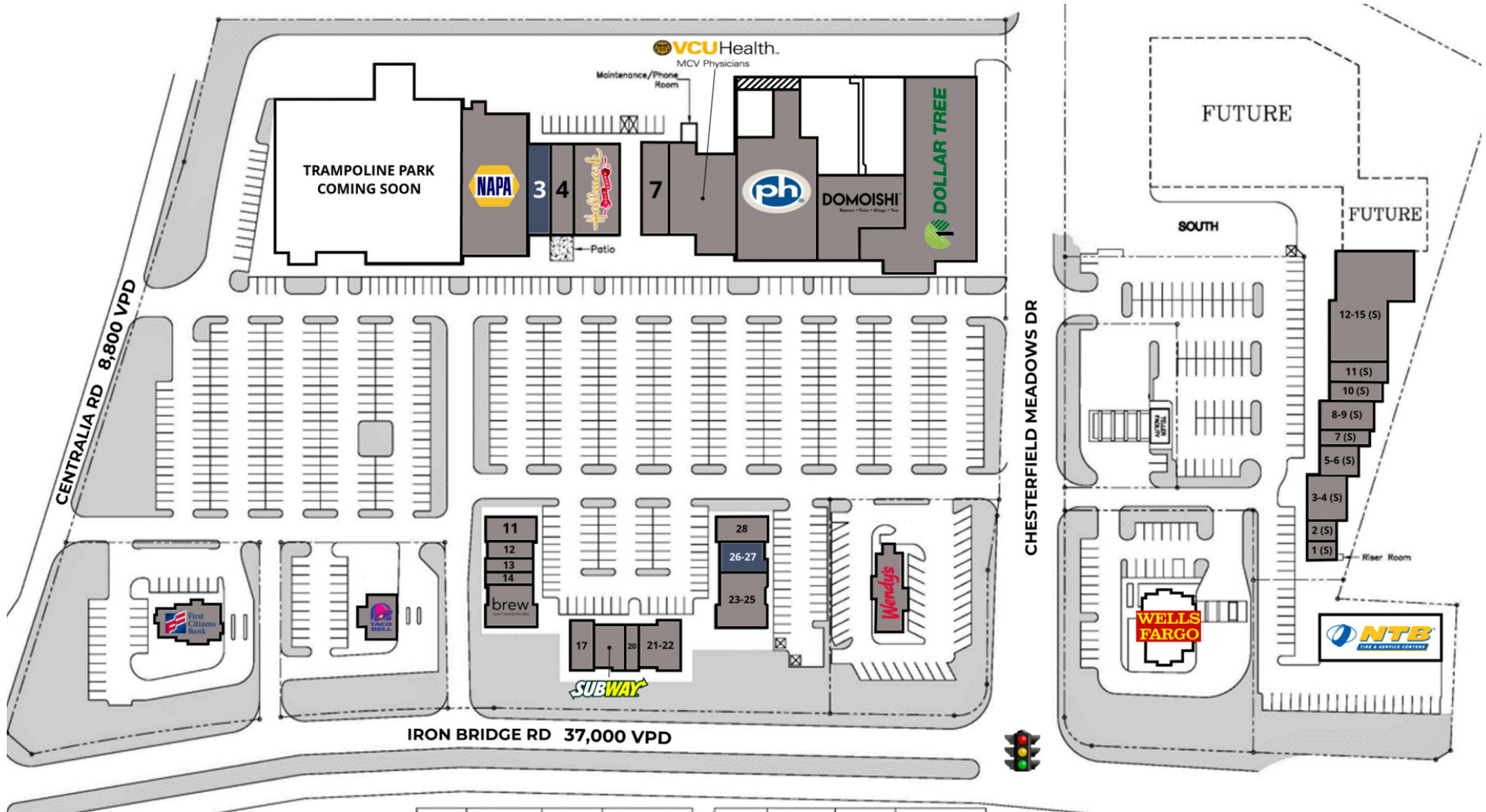

LEGEND

- Available
- Unavailable

VACANCY OVERVIEW

CHESTERFIELD MEADOWS

6411-6551 Centralia Road | Chesterfield, VA 23832



S.L. NUSBAUM
REALTY CO.



AVAILABLE SPACES

	SUITE	TENANT	SIZE
■	3	Available	2,500 SF
■	26-27	Available	1,750 SF

TRADE AREA

CHESTERFIELD MEADOWS

6411-6551 Centralia Road | Chesterfield, VA 23832



S.L. NUSBAUM
REALTY CO.



ADDITIONAL PHOTOS

CHESTERFIELD MEADOWS

6411-6551 Centralia Road | Chesterfield, VA 23832



S.L. NUSBAUM
REALTY CO.



CONTACT INFORMATION

CHESTERFIELD MEADOWS

6411-6551 Centralia Road | Chesterfield, VA 23832



S.L. NUSBAUM

REALTY CO.

BOB BUTCHER

Senior Vice President

C. 804.387.8194

O. 804.320.7600

bbutcher@slnusbaum.com

ANDREW THACKER

Vice President

C. 804.357.6075

O. 804.320.7600

athacker@slnusbaum.com

NATHAN SHOR

Senior Vice President | Partner

C. 804.539.7404

O. 804.944.2399

nshor@slnusbaum.com

COMMITMENT. INTEGRITY. EXCELLENCE. SINCE 1906.

Serving the Southeast and Mid-Atlantic region for well over a century, S.L. Nusbaum Realty Co. continues to provide a comprehensive experience for our clients and customers in all aspects of the multifamily and commercial real estate industry.

[CLICK HERE TO LEARN MORE](#)

PROUD PARTNER

XTEAM

RETAIL ADVISORS

[CLICK HERE TO LEARN MORE](#)

DISCLAIMER:

No warranty or representation, expressed or implied, is made to the accuracy or completeness of the information contained herein, and same is submitted subject to errors, omissions, change of price, rental or other conditions, withdrawal without notice, and to any special listing conditions imposed by the property owner(s). As applicable, we make no representation as to the condition of the property (or properties) in question or the property's (or properties') compliance with applicable laws, regulations, and codes.