

SUITE 130

1700 PERIMETER PARK DRIVE | MORRISVILLE, NC 27560

conceptual suite layout

1700 PERIMETER

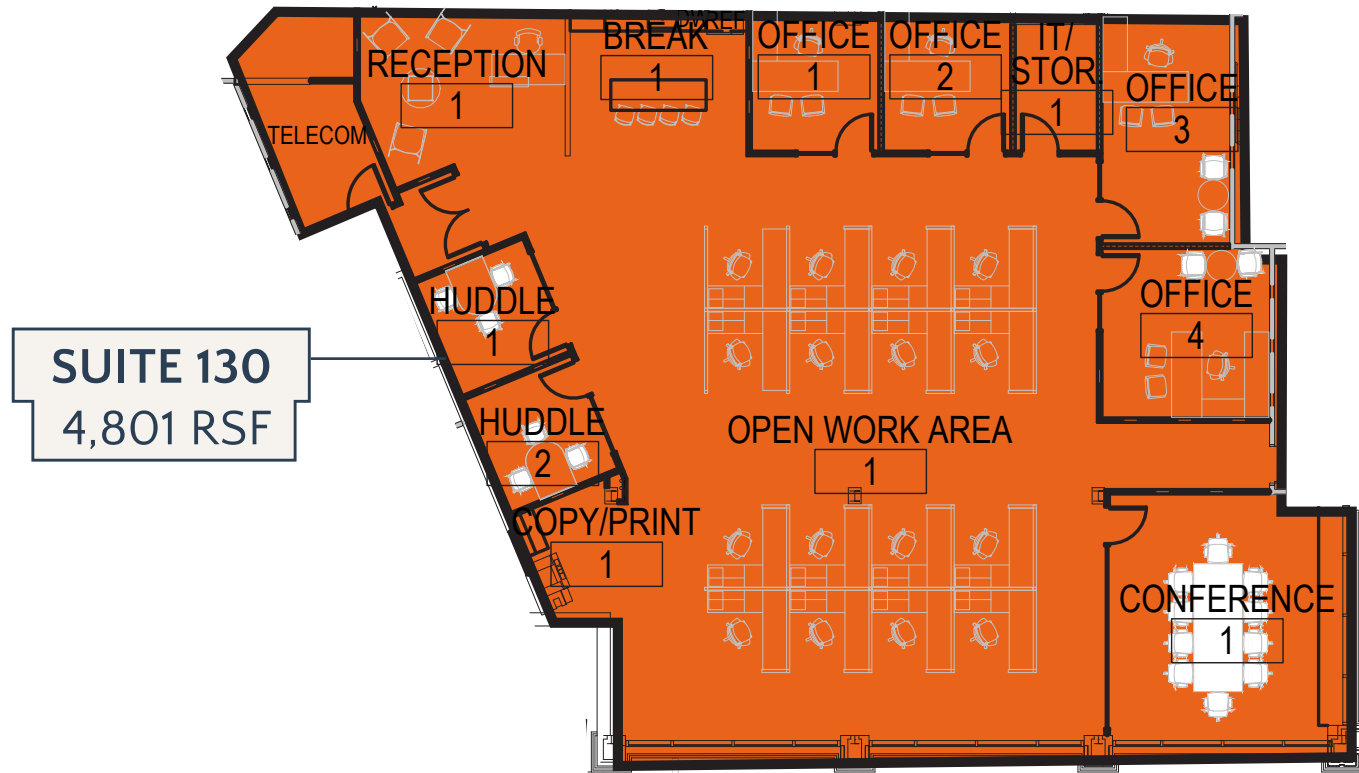

LEASING CONTACTS

William Allen

Managing Partner

919.415.4390 | wallen@trinity-partners.com

Alex Dunn

Director, Office Leasing

919.415.4405 | adunn@trinity-partners.com