

Continues - See Sheet 7

- LEGEND**
- Existing Major Contour
 - - - Existing Minor Contour
 - Proposed Major Contour
 - Proposed Minor Contour
 - ➔ Major Flood Routing
 - ➔ Drainage Arrow
 - FF = Finished Floor
 - PG = Proposed Grade
 - SW = Sidewalk
 - TC = Top of Curb
 - T.C. = Top of Casting
 - TP = Top of Pavement
 - TW = Top of Wall

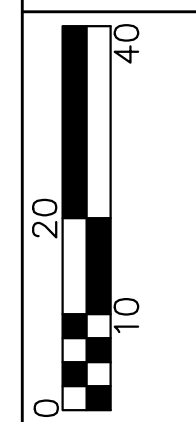

CALCULATED	DLS	CHECKED
		CES

SITE GRADING PLAN

**THOMAS COMMERCIAL
2656 NORTH COLUMBUS STREET**

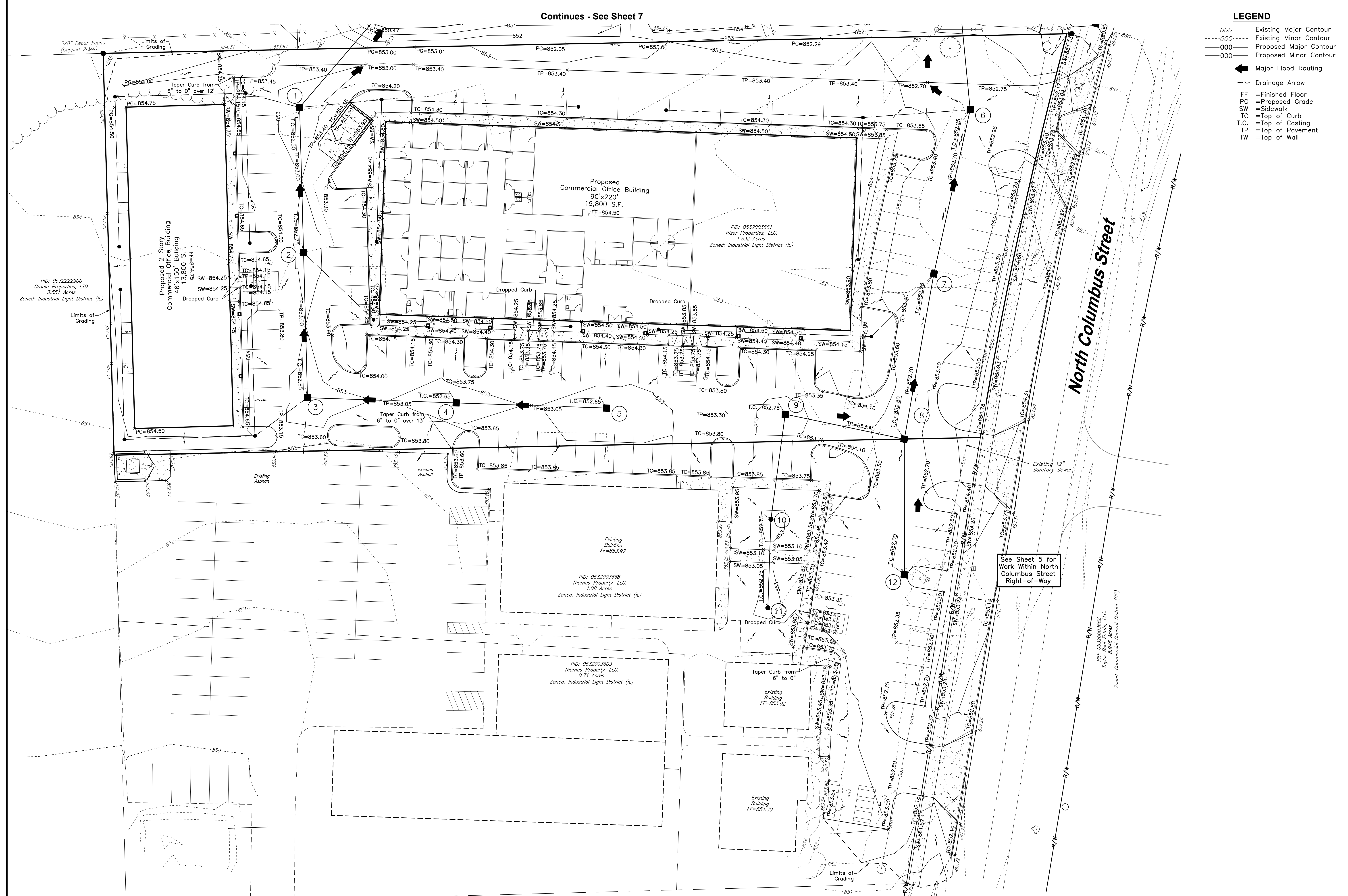

PID: 053222900
Cronin Properties, LTD.
3.551 Acres
Zoned: Industrial Light District (IL)

Proposed 2-Story
Commercial Office Building
46' x 150'
13,800 S.F.
FF=854.75
SW=854.25
Dropped Curb

Proposed
Commercial Office Building
90' x 220'
19,800 S.F.
FF=854.50

PID: 0532003661
Riser Properties, LLC.
1.832 Acres
Zoned: Industrial Light District (IL)

Dropped Curb

Dropped Curb

Taper Curb from
6" to 0" over 13'

See Sheet 5 for
Work Within North
Columbus Street
Right-of-Way

PID: 0532003668
Thomas Property, LLC.
1.08 Acres
Zoned: Industrial Light District (IL)

PID: 0532003603
Thomas Property, LLC.
0.71 Acres
Zoned: Industrial Light District (IL)

Taper Curb from
6" to 0"

PID: 0532003607
Taylor Real Estate, LLC.
8.946 Acres
Zoned: Commercial General District (CG)

North Columbus Street

Existing 12" Sanitary Sewer

Existing Building
FF=853.92

Existing Building
FF=854.30

Existing Asphalt

Existing Asphalt

Limits of Grading

Limits of Grading

5/8" Rebar Found
(Capped 2LM)