

877 Stewart Avenue
Garden City, NY 11530

2,600 Sq. Ft. Medical Condominium for Sale
A Single Story Building on a 4.3 Acre Campus
Located in the Heart of Garden City's Medical
Corridor



Located within the 55,665 sq ft University Professional Plaza, a professionally managed medical office complex situated on approximately 4.65 acres.

Exclusive Brokers

Richard A. Diller, Associate Broker

✉ rad6785mail.com

📞 516.639.0021

Leonard Spitale, Associate Broker

✉ lenspitale@yahoo.com

📞 516.661.6049

Charles Rutenberg Realty, Inc. Commercial Brokerage & Advisory Services

Property Highlights

- Six Treatment Rooms
- Three Private Windowed Offices
- Central Admin & Reception Suite
- Private Rest Room
- Staff- Break Room
- Excellent Parking for Patients & Staff
- Exceptional Access to Highways
- Surrounded by Hospitals, Specialists & Support Services
- Strong Demographics & Steady Area Growth
- Public Transportation and Shopping
- We will provide a Personalized Rent vs Ownership Spreadsheet if requested.
- Asking Price: \$1,188,000 – Negotiable

All information is from sources deemed reliable and is subject to errors, omissions, change of price, terms, prior sales and withdrawals. All parties of interest should do their own independent verifications. Photos are enhanced









- Patient Waiting Area

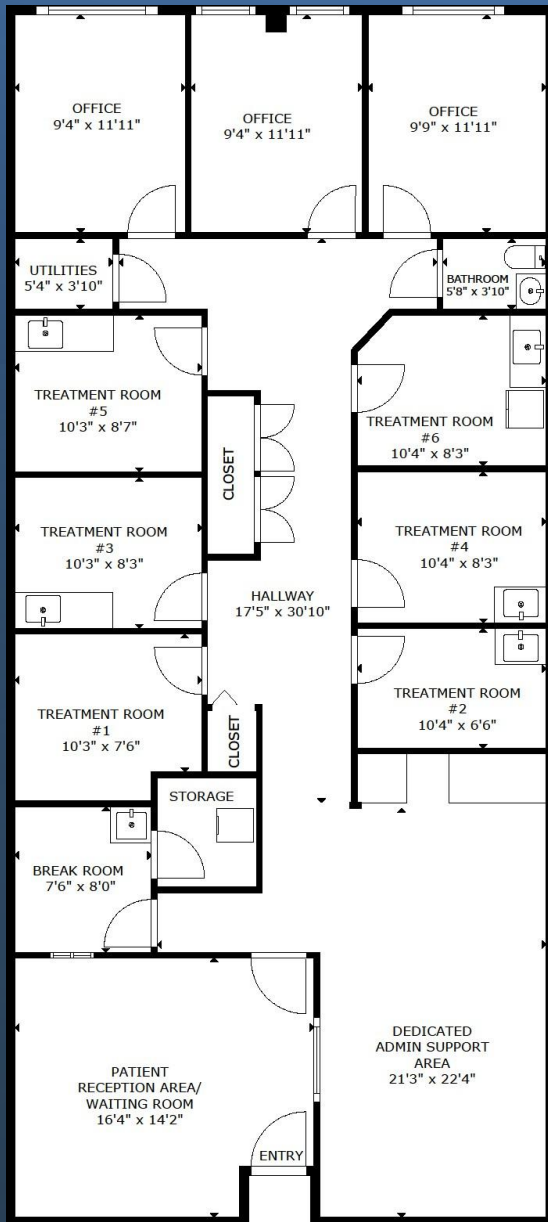

FLOOR PLAN

GROSS INTERNAL AREA
FLOOR PLAN: 1,901 sq. ft

SIZES AND DIMENSIONS ARE APPROXIMATE, ACTUAL MAY VARY.



**Charles Rutenberg Realty, Inc.
255 Executive Drive
Suite 104
Plainview, New York
11743**

**Investment Sales,
Leasing and
Advisory Services**

Exclusive Brokers

Richard A. Diller, Associate Broker

✉ rad6785@gmail.com

☎ **516.639.0021**

Leonard Spitale, Associate Broker

✉ lenspitale@yahoo.com

☎ **516.661.6049**

Charles Rutenberg Realty, Inc. Commercial Brokerage & Advisory Services
