

The Savills logo consists of a solid yellow square positioned above the word "savills" in a lowercase, sans-serif font.A photograph of the storefront for "edible" in Chicago. The building is made of red brick. The storefront features a white sign with a colorful Easter basket icon and the word "edible" in red, lowercase letters. Below the sign is a dark grey awning over a glass entrance. The windows on either side of the entrance display various floral arrangements. Two white, cylindrical columns flank the entrance. A manhole cover is visible on the sidewalk in front of the entrance.

edible

RETAIL AVAILABLE

1251 S. MICHIGAN AVE

CHICAGO, IL

1,230 Square Feet For Lease



THE OPPORTUNITY

Easily accessible retail space available on South Michigan Avenue at the base of a 400+ unit apartment tower.

Steps from Roosevelt Road and the Red, Orange and Green CTA train lines

Co-tenancy with many national and local concepts.

FLOORPLAN

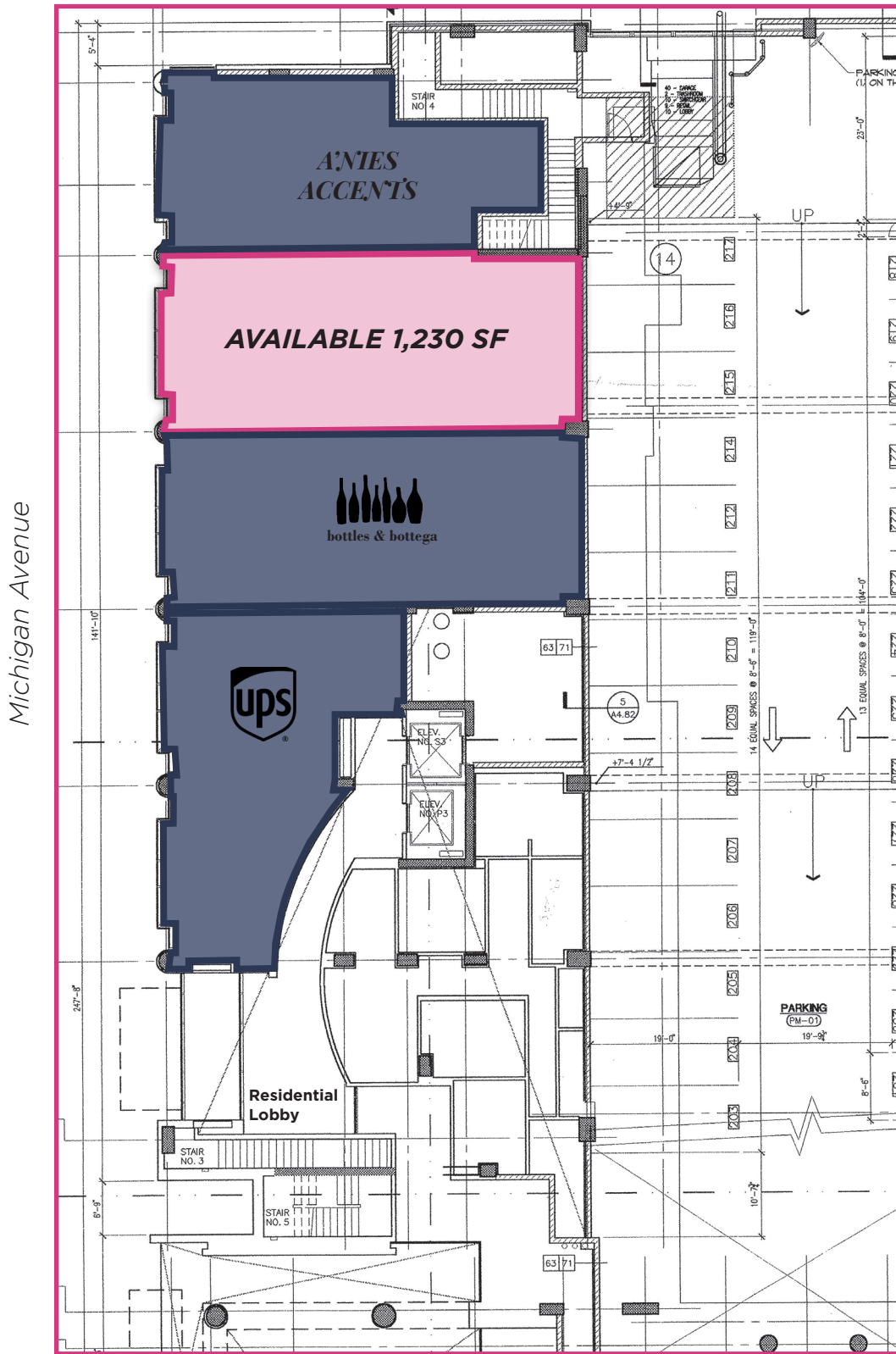



PHIL GOLDING
+1 312 404 6673
pgolding@savills.us

KIMBERLY WISKUP
+1 312 595 2917
kwiskup@savills.us



[savills.us](https://www.savills.us)