

CBRE

LBALogistics 

**5350 WEST
HAROLD GATTY DRIVE
SALT LAKE CITY, UT 84116**



**123,800 SF
SPACE FOR LEASE**

123,800 SF
SPACE FOR LEASE

SITE PLAN

HAROLD GATTY DRIVE

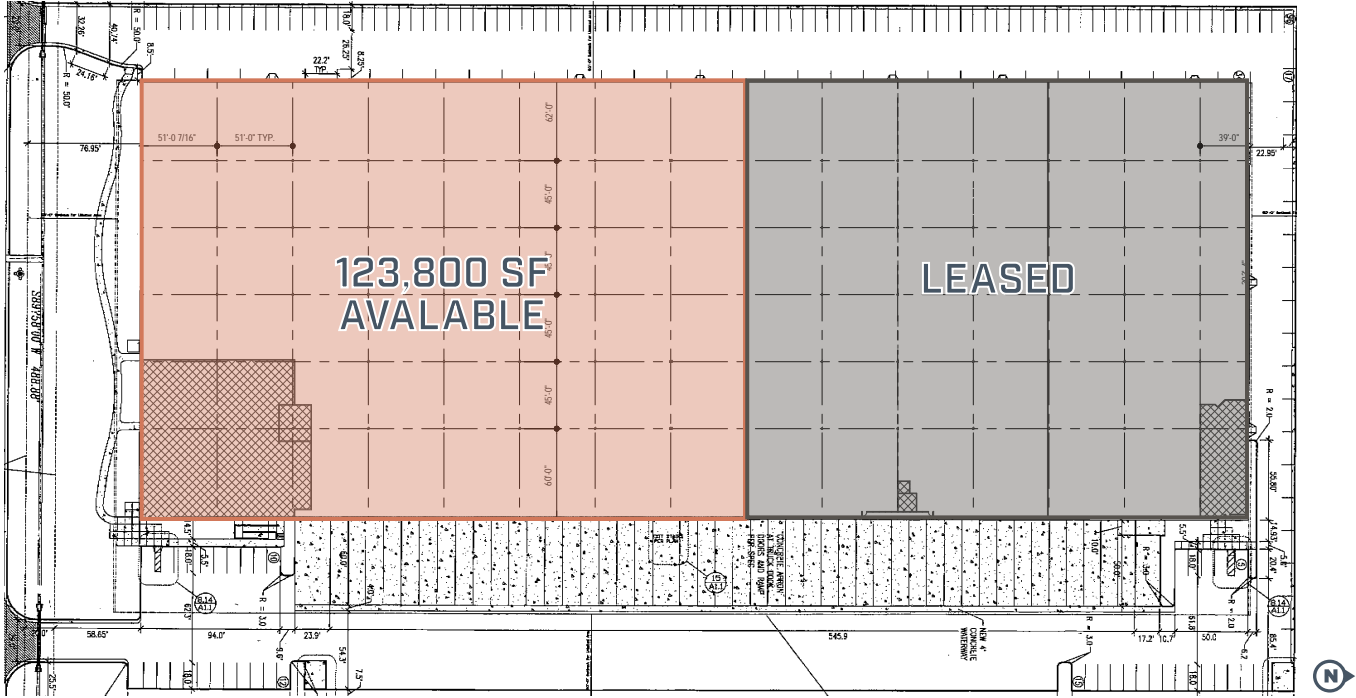

Building Size:	228,800 sq. ft
Available:	123,800 sq. ft. Office: ±11,500 sq. ft.
Building Depth:	303' 4"
Clear Height:	26'
Loading:	20 Dock High Doors (9' x 10') - All Equipped with Pit Levelers; 19 Include Dock Seals 1 Ground Level Door (12' x 14')
Column Spacing:	45' x 51'
Power:	1,000 Amps, 277/480 Volt, 3 Phase (Subject to Tenant Verification)
Lighting:	Existing T-5 Lighting to be upgraded to LED
Heating:	Gas Forced Air
Fire Suppression:	Wet System
Truck Court:	120' Deep
Construction Type:	Concrete Tilt
Year Built:	1997
Zoning:	M-1, Light Manufacturing

HIGHLIGHTS



5350 WEST HAROLD GATTY DRIVE
SALT LAKE CITY, UT 84116



LOCATION



123,800 SF
SPACE FOR LEASE

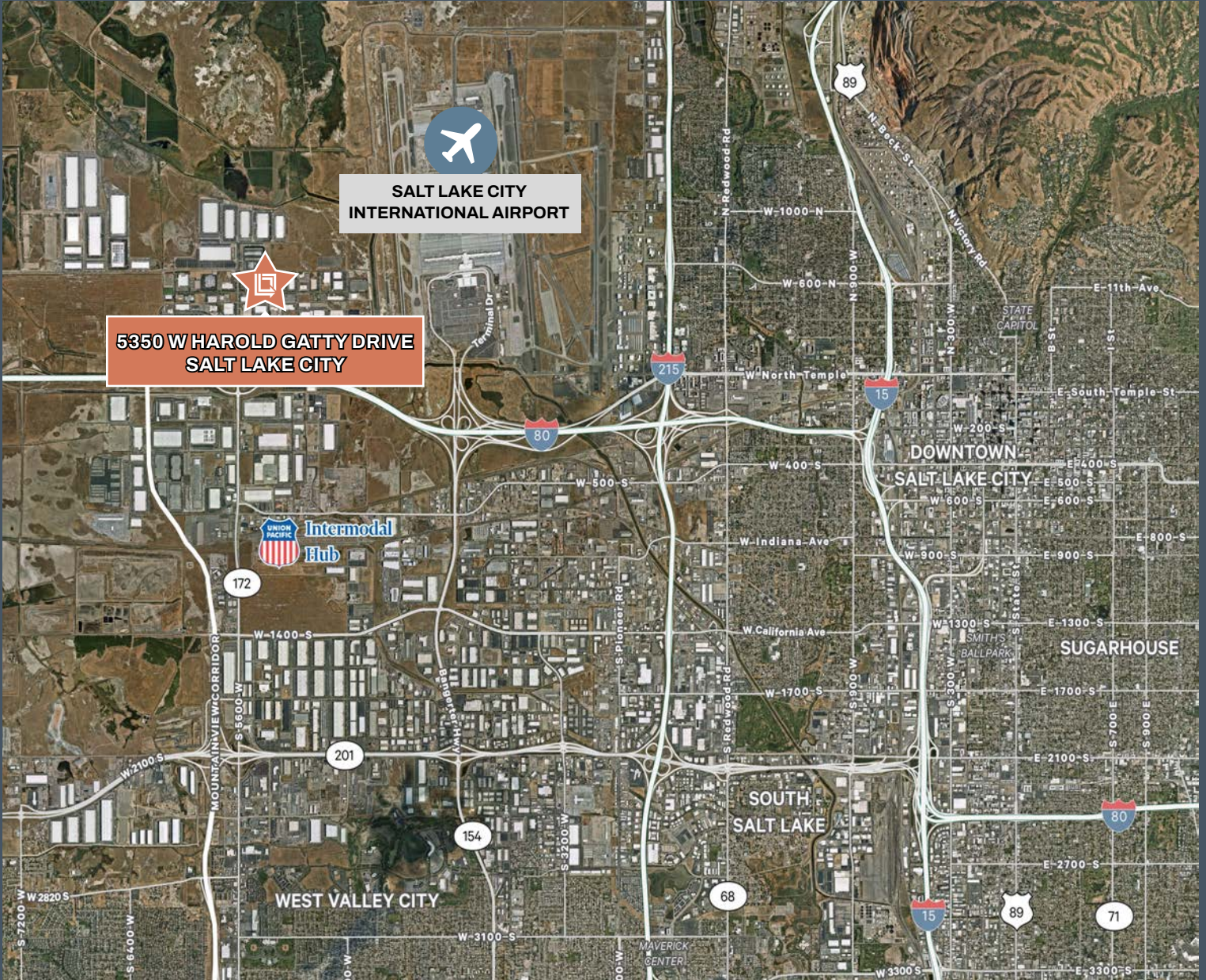

LBA Logistics 

CBRE

MATT MCAFEE

Senior Vice President
+1 801 869 8023
matt.mcafee@cbre.com

TOM DISCHMANN

Executive Vice President
+1 801 243 9411
tom.dischmann@cbre.com

CHRIS LIDDELL

Senior Vice President
+1 801 869 8007
chris.liddell@cbre.com

JEFF RICHARDS

Executive Vice President
+1 801 869 8007
jeff.richards@cbre.com

© 2025 CBRE, Inc. All rights reserved. This information has been obtained from sources believed reliable but has not been verified for accuracy or completeness. CBRE, Inc. makes no guarantee, representation or warranty and accepts no responsibility or liability as to the accuracy, completeness, or reliability of the information contained herein. You should conduct a careful, independent investigation of the property and verify all information. Any reliance on this information is solely at your own risk.

www.cbre.com/saltlakecity