

**Joel Cumplido**  
505.670.3328  
joel@garsagroup.com

**Jonathon Rivera**  
505.913.0957  
jonathon@garsagroup.com

# FOR SALE & LEASE

## Restaurant/Retail Space in Downtown Santa Fe

223 & 225 Johnson St. Santa Fe, NM 87501

**AVAILABLE**

±1,300 - ±3,000 SF | Land: ±0.25 Ac.

**SALE PRICE**

\$1,950,000

**LEASE RATE**

\$3,000-10,000/Month + NN

**ZONING**

BCD | Business Capital District



# PROPERTY OVERVIEW

**Joel Cumplido**  
505.670.3328  
joel@garsagroup.com

**Jonathon Rivera**  
505.913.0957  
jonathon@garsagroup.com



## AVAILABLE

- Unit 223: ±1,700 SF – *Restaurant*
- Unit 225: ±1,300 SF – *Retail*
- Total: ±3,000 SF
- Land: ±0.25 Ac.

## SALE PRICE

\$1,950,000

## LEASE RATE

- Unit 223: \$7,000/month + NN
- Unit 225: \$3,000/month + NN
- Unit 223 & 225:  
\$10,000/month + NN

## ZONING

BCD | Business Capital District

## HIGHLIGHTS

- A hard-to-find restaurant opportunity
- FF&E included
- Fenced patio seating and bar area
- Front retail space available
- Desirable location in downtown
- Liquor license available separately
- 5 parking spaces – Extra space see advisor
- Surrounded by:
  - Museums
  - Hotels & vacation rentals
  - Galleries
  - Professional offices
  - Retail business

**SALE/LEASE** Restaurant/Retail Space in Downtown Santa Fe



# MARKET AERIAL

**Joel Cumplido**  
505.670.3328  
joel@garsagroup.com

**Jonathon Rivera**  
505.913.0957  
jonathon@garsagroup.com



223 & 225 Johnson St. Santa Fe, NM 87501



2025 Forecasted by ESRI

Demographics	1 Mile	3 Mile	5 Mile
Total Population	8,249	37,014	65,492
Average HH Income	\$122,586	\$129,429	\$126,738
Total Business	1,936	4,366	5,636
Total Employees	22,787	52,517	65,155

**SALE/LEASE** Restaurant/Retail Space in Downtown Santa Fe



# FLOOR PLAN

**Joel Cumplido**  
505.670.3328  
joel@garsagroup.com

**Jonathon Rivera**  
505.913.0957  
jonathon@garsagroup.com

## AVAILABLE

- Unit 223: ±1,700 SF – *Restaurant*
- Unit 225: ±1,300 SF – *Retail*
- Total: ±3,000 SF
- Land: ±0.25 Ac.

Unit 223: \$7,000/month + NN

Unit 225: \$3,000/month + NN

Unit 223 & 225: \$10,000/month + NN

Sale Price: \$1,950,000

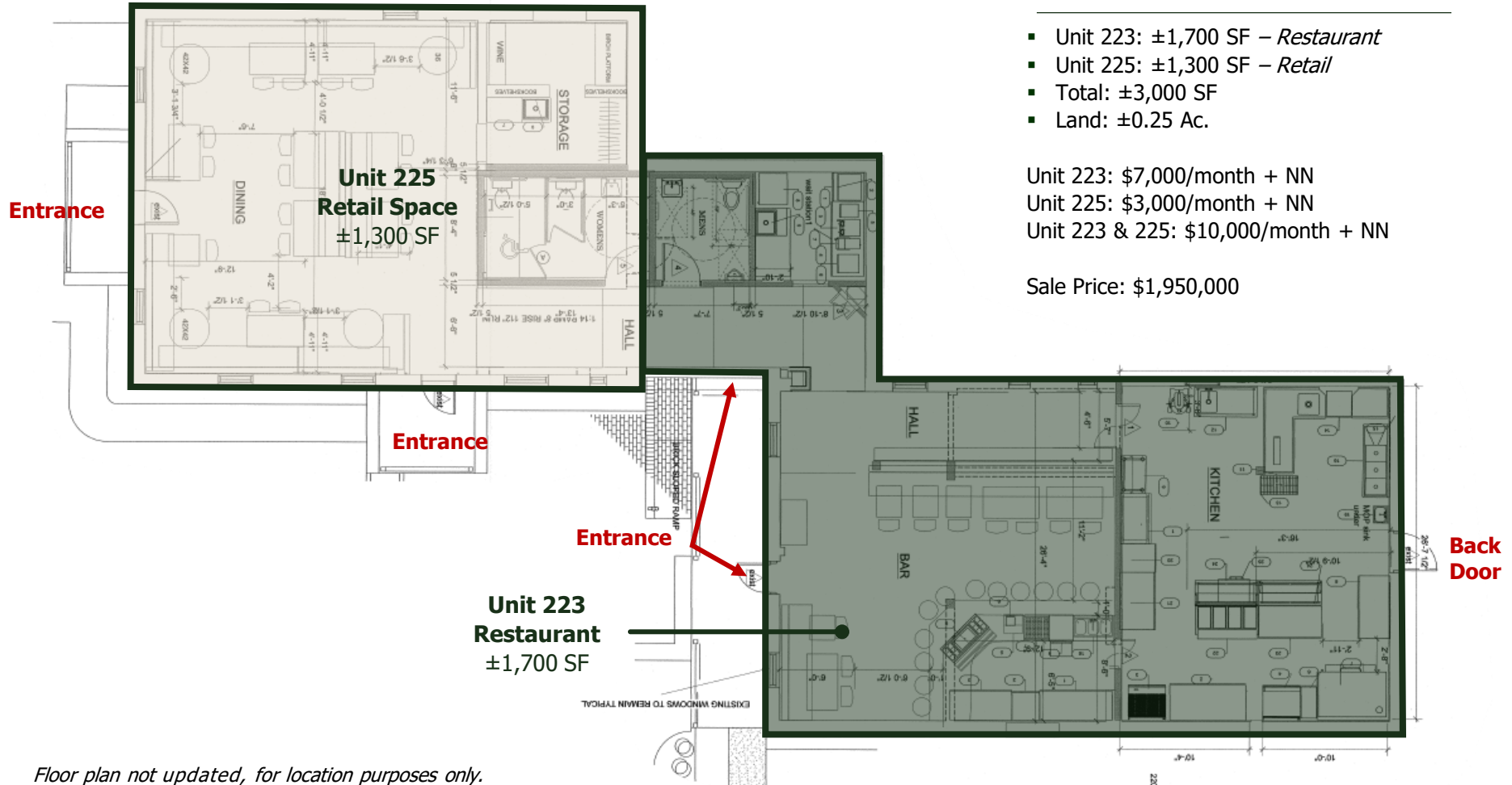

Floor plan not updated, for location purposes only.

223 & 225 Johnson St. Santa Fe, NM 87501

**SALE/LEASE** Restaurant/Retail Space in Downtown Santa Fe



# PHOTOS

**Joel Cumplido**  
505.670.3328  
joel@garsagroup.com

**Jonathon Rivera**  
505.913.0957  
jonathon@garsagroup.com



The information contained in this flyer is believed reliable. While we do not doubt the accuracy, we have not verified it and make no guarantee, warranty or representation about it. It is your responsibility to independently confirm its accuracy and completeness. Any projection, opinion, assumption or estimated uses are for example only and do not represent the current or future performance of the property. The value of this transaction to you depends on many factors which should be evaluated by your tax, financial, and legal counsel. You and your counsel should conduct a careful independent investigation of the property to determine that it is suitable to your needs.

505.473.3434  
www.garsagroup.com  
418 Cerrillos Rd. | Suite 11  
Santa Fe, NM 87501

