



The small white building was a temporary modular sales office used during construction, and is no longer on the property. A new owner/tenant has the option to bring it back during completion of construction.

Auto Dealership Property

SALE PRICE: \$6,500,000

LEASE RATE: \$45,000 PER MONTH + NNN

2030 & 2052 FULTON AVENUE · SACRAMENTO, CA

For sale or lease

MIKE LUCA, SIOR
Senior Managing Director
Mike.Luca@jll.com
+1 916 214 0466
RE Lic. 01447904

DOMINIC SMITH
Vice President
Dominic.Smith@jll.com
+1 916 995 9396
RE Lic. 02106714

RJ JIMENEZ
Senior Associate
RJ.Jimenez@jll.com
+1 916 440 1837
RE Lic. 02248675

Features

- **Shop building: ±12,978 SF**
With new 12' slab areas poured for new vehicle lifts, including lights in the slab.
Vehicle lifts positions: 12 (1 additional position with alignment rack).
Some new lifts, tool boxes and other equipment on site and available for separate purchase.
- **Showroom building: ±6,890 SF**
- **±2.99 acre site (4 contiguous parcels)**
Parcel 1 = 279-0140-043-0000 | ±1.00 acres
Parcel 2 = 279-0140-071-0000 | ±0.90 acres
Parcel 3 = 279-0140-078-0000 | ±0.33 acres
Parcel 4 = 279-0140-079-0000 | ±0.75 acres
- **±395' of frontage on Fulton Avenue**
- **Renovation work**
Property is mid-renovation (work started in late 2024) and was planned to be a luxury auto sales and service center. A new owner/tenant could continue the renovation and have the project completed by end of 2026.
- **Plans and permits**
Sale price includes approximately \$500,000 in plans and permits (plans by Gensler).
- **Electrical switchgear**
Electrical switchgear in each building has been replaced (two (2), 800 Amp panels).
- **Plumbing has been replaced in both buildings**
- **Grade-level roll up doors: two (2)**
- **Parking spaces: ±190**
- **Showroom ceiling height: ±18'**
- **Natural Gas service: PG&E**
- **Fire sprinklers (new risers partially paid for)**
- **New parking lot lights**

- **Monument sign**
Corner of Fulton Ave & Cottage Way, plus two additional monument signs on Fulton Avenue.
- **Existing Billboard**
2-sided billboard sign leased to Outfront. North side is current in use by the current owner.
- **Fulton Ave at Cottage Way: ±60,240 ADT**



Plans

Complete plan set available for the current project.

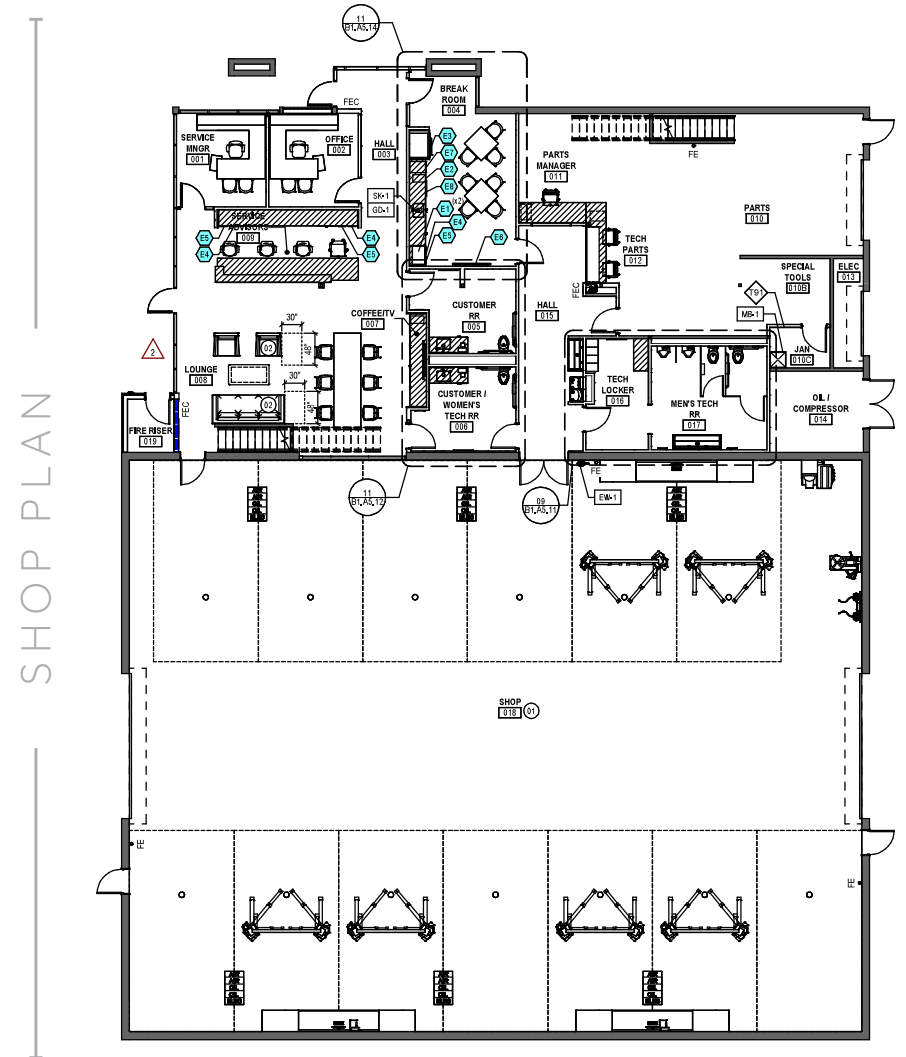
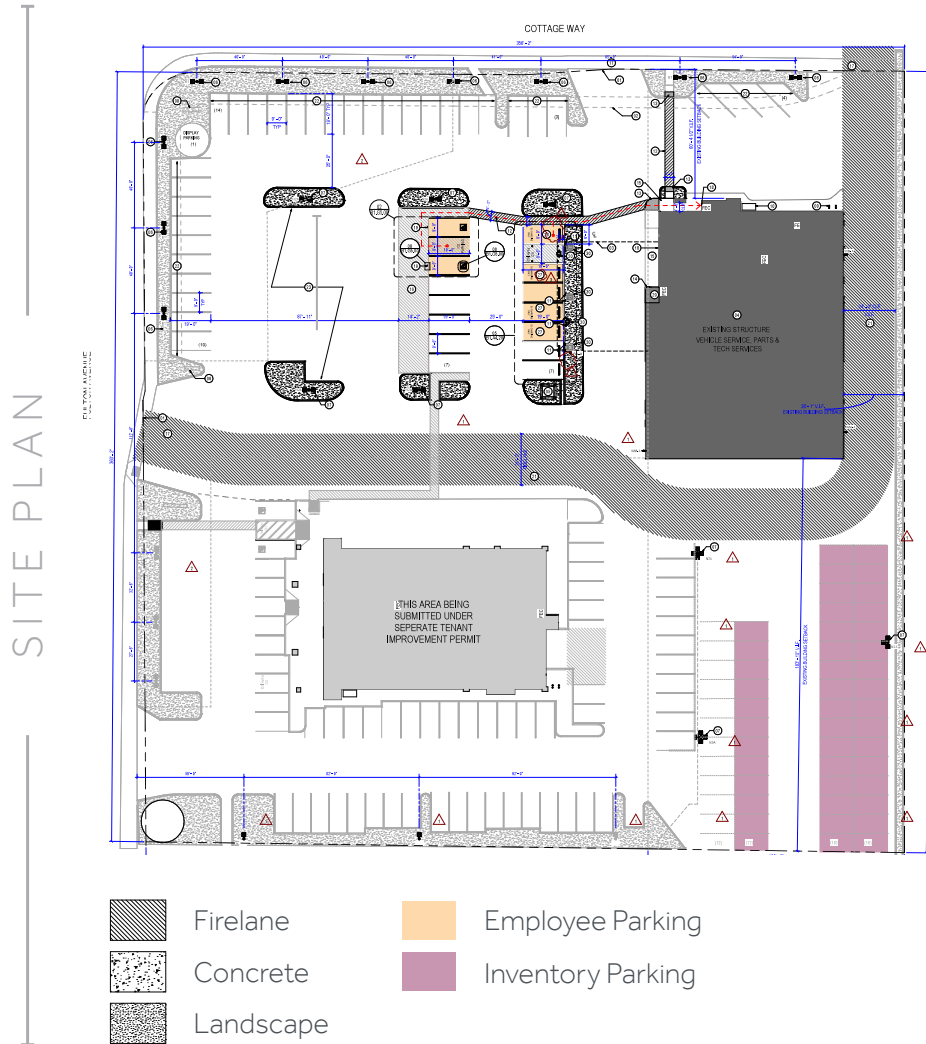

MAPS NOT TO SCALE

Photos



Proximity

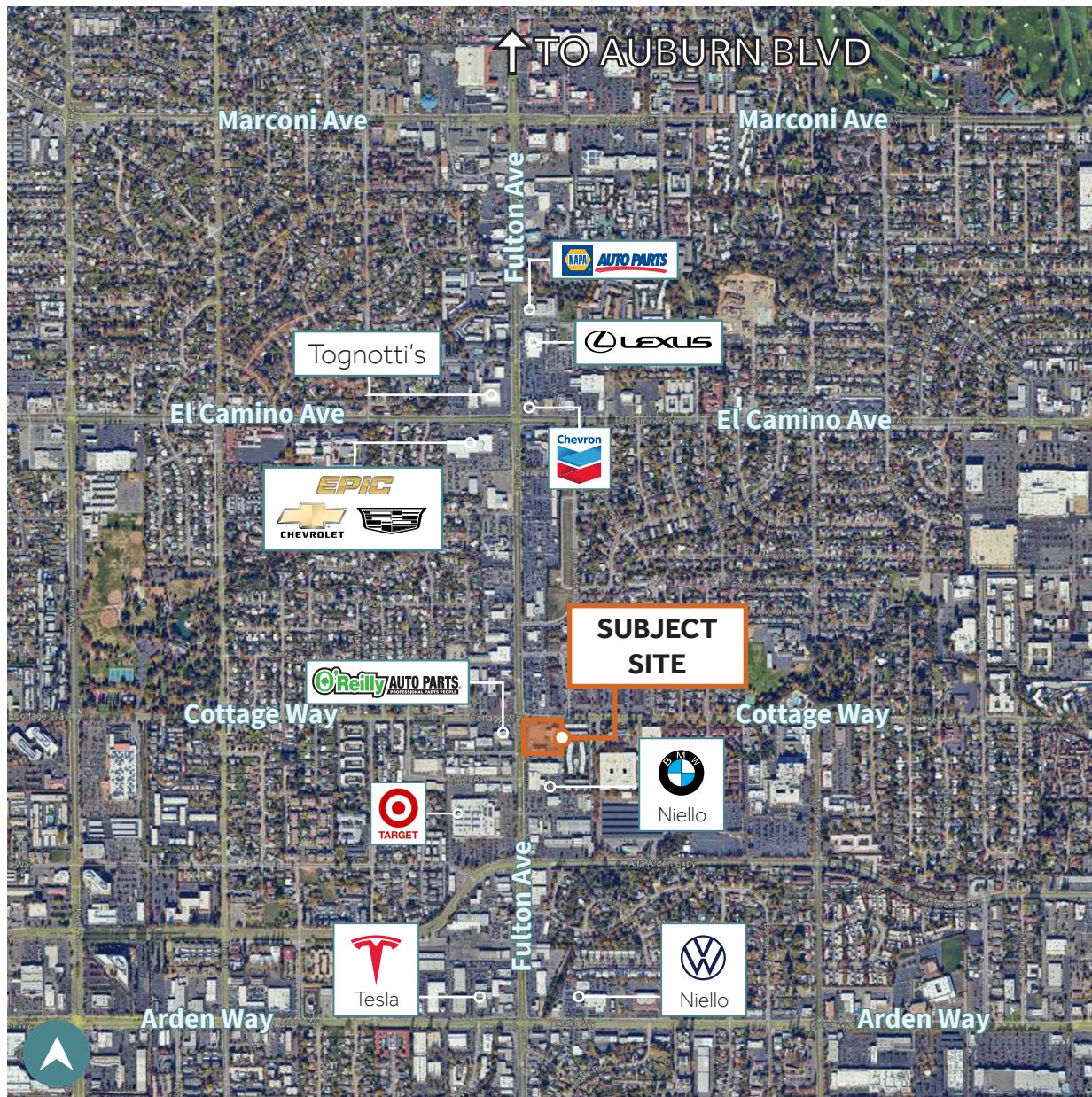

NOT SHOWN ON MAP

FULTON AVENUE NORTH

Sacramento Chrysler Dodge Jeep Ram
Capitol City Honda

HOWE AVENUE

Downtown Ford Sacramento
Mercedes-Benz of Sacramento
Sprinter of Sacramento

AUBURN BLVD

Jaguar / Land Rover Sacramento
Maita Subaru
Kia of Sacramento (coming soon)
Maita Toyota of Sacramento
Maita Mazda
Niello Audi
Maita Collision
Porsche Sacramento

For sale or lease

Auto Dealership Property

2030 & 2052 FULTON AVENUE
SACRAMENTO, CA 95825

Jones Lang LaSalle Brokerage, Inc.
California Real Estate Lic. 01856260

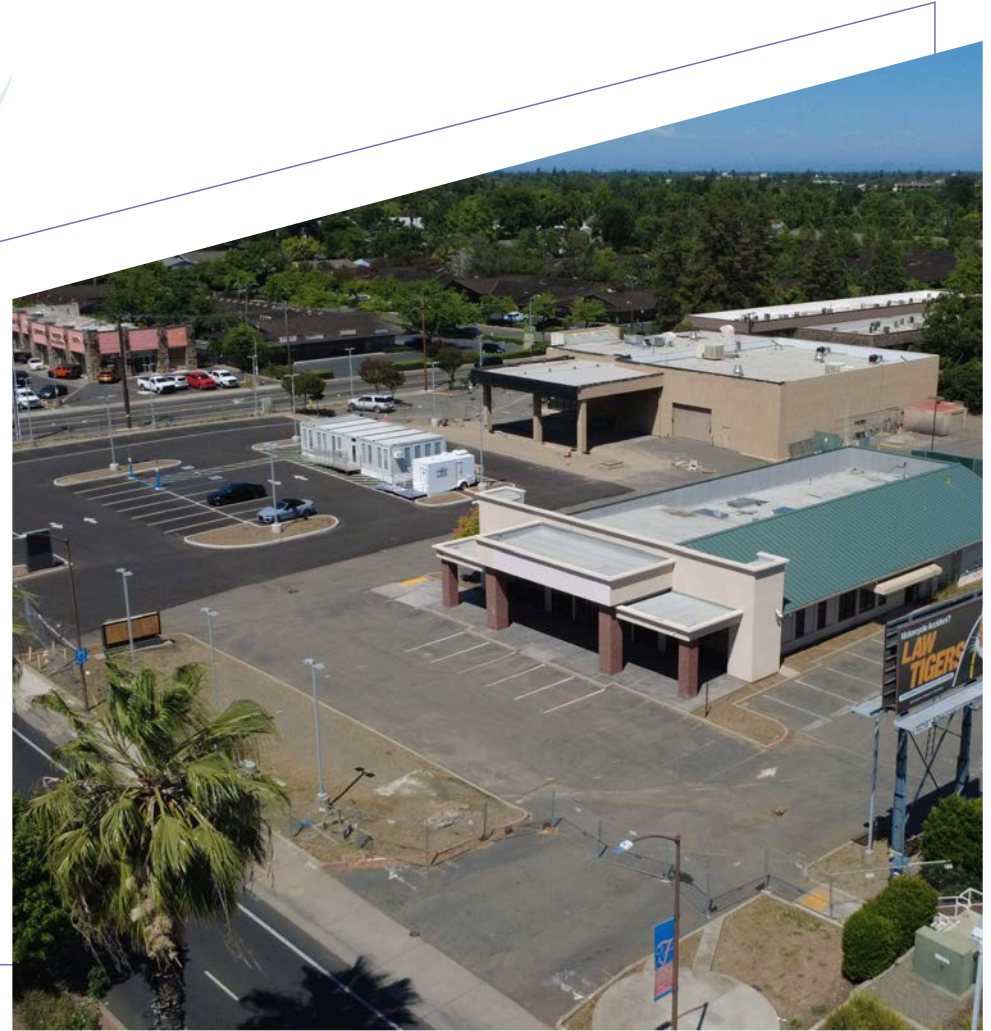

JLL AUTOMOTIVE DEALERSHIP PROPERTIES:

MIKE LUCA, SIOR
Senior Managing Director
Mike.Luca@jll.com
+1 916 214 0466
RE Lic. 01447904

RJ Jimenez
Senior Associate
R.J.Jimenez@jll.com
+1 916 440 1837
RE Lic. 02248675

Dominic Smith
Vice President
Dominic.Smith@jll.com
+1 916 995 9396
RE Lic. 02106714

Although information has been obtained from sources deemed reliable, neither Owner nor JLL makes any guarantees, warranties or representations, express or implied, as to the completeness or accuracy as to the information contained herein. Any projections, opinions, assumptions or estimates used are for example only. There may be differences between projected and actual results, and those differences may be material. The Property may be withdrawn without notice. Neither Owner nor JLL accepts any liability for any loss or damage suffered by any party resulting from reliance on this information. If the recipient of this information has signed a confidentiality agreement regarding this matter, this information is subject to the terms of that agreement. © 2025 Jones Lang Brokerage, Inc. All rights reserved. JMYERS @ADS\Grinzewitsch\Fulton Avenue_2030-2052\Marketing_Brochure

