

North Park Commerce Center

SANFORD, FLORIDA



AVAILABLE OCTOBER 1, 2026

11,500 SF For Lease

3800 Enterprise Way, Sanford, FL

CABOT |

For more information, contact:

CAMERON MONTGOMERY

Executive Vice President

+1 407 473 4906

cameron.montgomery@jll.com

MATT SULLIVAN, SIOR, CCIM

Executive Managing Director

+1 407 930 1802

matt.sullivan@jll.com

BOBBY ISOLA, SIOR, CCIM

Executive Managing Director

+1 407 930 1804

bobby.isola@jll.com



JLL

200 S Orange Ave, Ste 3000

Orlando, FL 32801

jll.com

No warranty or representation, expressed or implied, is made as to the accuracy of the information contained herein, and same is submitted subject to error and omission.

AVAILABLE OCTOBER 1, 2026

11,500 SF For Lease

3800 Enterprise Way, Sanford, FL



Property Overview

TWO INDUSTRIAL BUILDINGS WITHIN SEMINOLE CO SUBMARKET

North Park Commerce Center is a 40-acre development located east of Interstate 4 and north of State Road 46 in Sanford, Florida. It consists of two dock high tilt-wall buildings that share a 190' truck court.

PROPERTY HIGHLIGHTS

- Two convenient access points to Interstate 4
- 3.3 million people within a one-hour drive
- Ample employee parking
- Minutes from the Sanford SunRail station

AVAILABLE OCTOBER 1, 2026

11,500 SF For Lease

3800 Enterprise Way, Sanford, FL

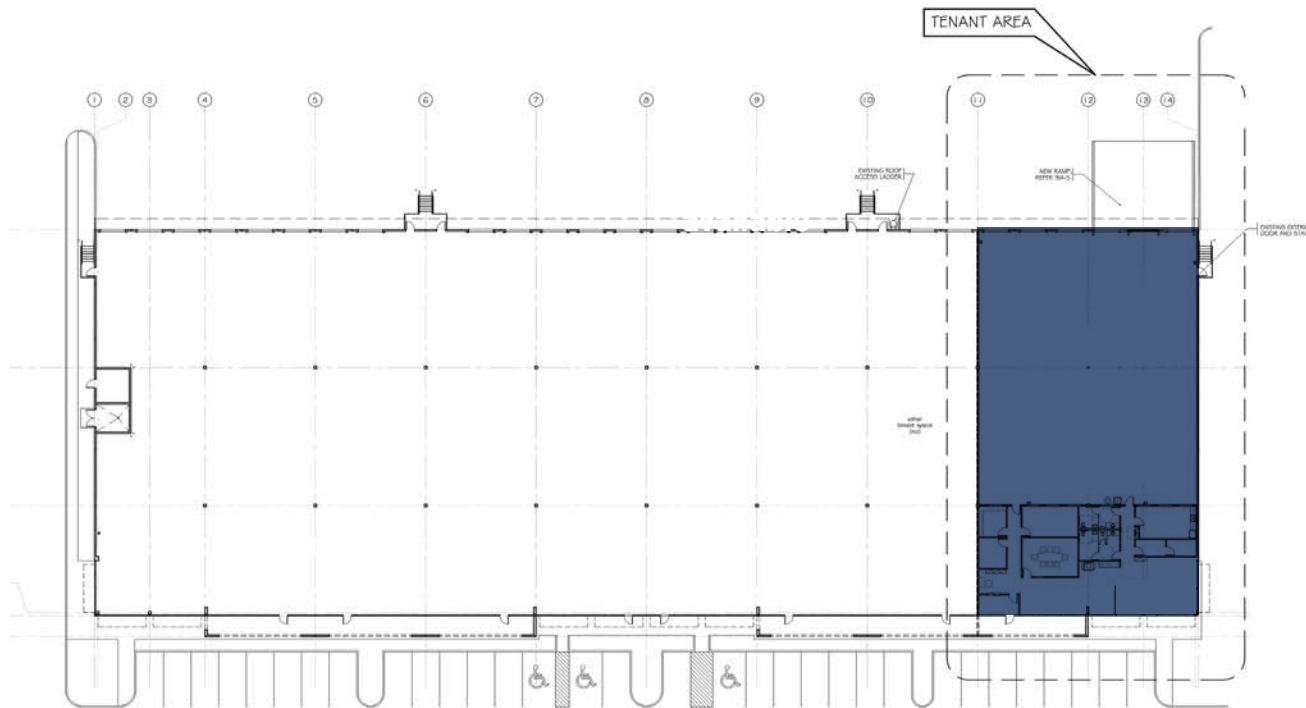

PROPERTY FEATURES

Total Building Size	57,800 SF
Available	11,500 SF
Office	3,680 ± SF
Ceiling Height	24'
Bay Spacing	40'w x 50'd
Car Parking	1.19/1,000 SF
Docks	3
Ramps	1
Loading	Rear

- 190' shared truck court
- ESFR sprinklers
- Zoned PD, City of Sanford

AVAILABLE OCTOBER 1, 2026

11,500 SF For Lease

3800 Enterprise Way, Sanford, FL



Location Overview

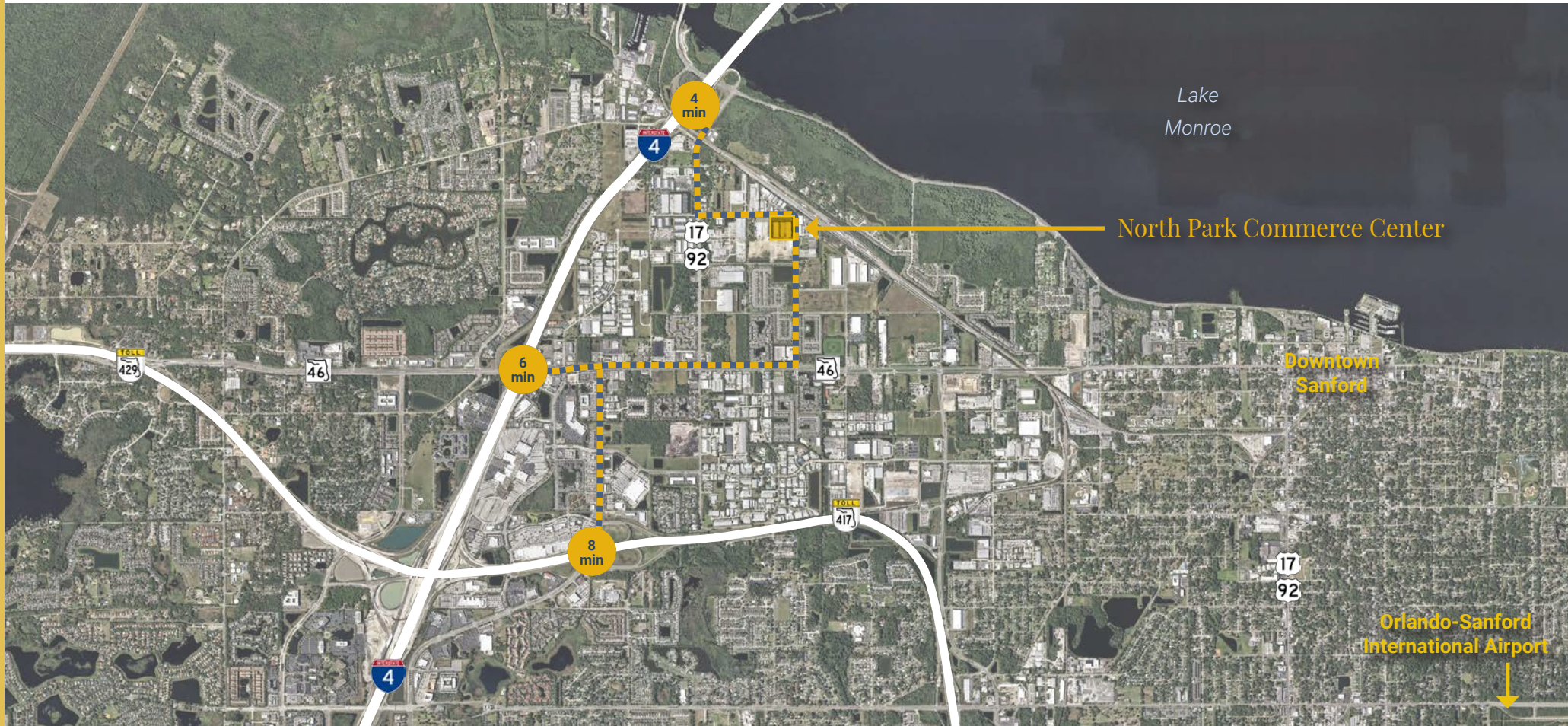

JLL | 200 S Orange Ave, Ste 3000, Orlando, FL 32801 | jll.com

No warranty or representation, expressed or implied, is made as to the accuracy of the information contained herein, and same is submitted subject to error and omission.

AVAILABLE OCTOBER 1, 2026

11,500 SF For Lease

3800 Enterprise Way, Sanford, FL

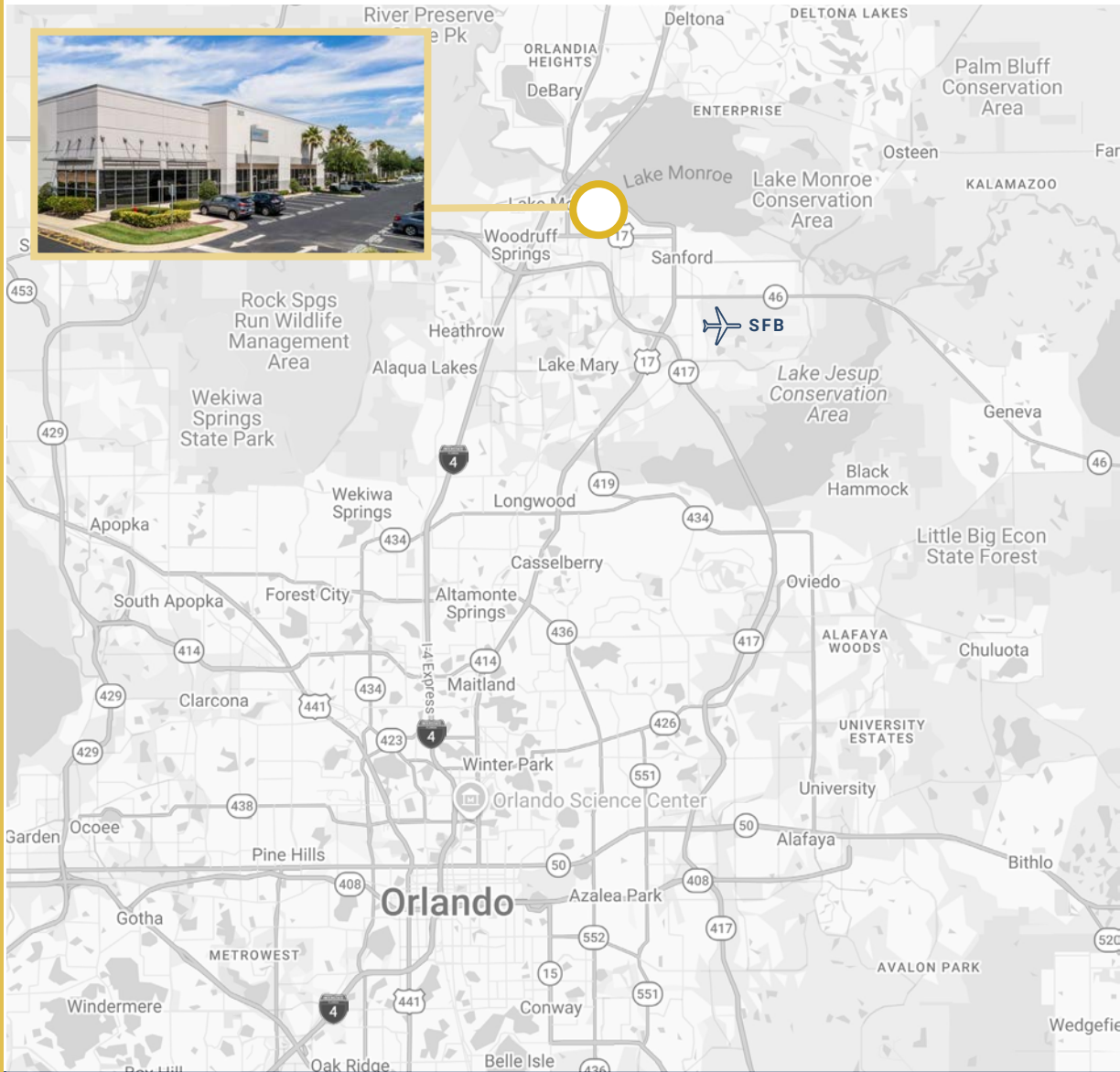

LOCATION HIGHLIGHTS

- Excellent access to Interstate 4, State Road 417, State Road 429 and State Road 46
- Fifteen minutes to Orlando-Sanford International Airport
- Nearby points of interest include Central Florida Zoo and Botanical Gardens, historic downtown Sanford, and Sanford Riverwalk
- Numerous big box retailers, fast food and quick service restaurants within a 3-mile radius

1.4 miles

to Interstate 4

6.6 miles

to Orlando-Sanford International Airport

23.3 miles

to Orlando

JLL | 200 S Orange Ave, Ste 3000, Orlando, FL 32801 | jll.com

No warranty or representation, expressed or implied, is made as to the accuracy of the information contained herein, and same is submitted subject to error and omission.

AVAILABLE OCTOBER 1, 2026

11,500 SF For Lease

3800 Enterprise Way, Sanford, FL



JLL | 200 S Orange Ave, Ste 3000, Orlando, FL 32801 | jll.com

No warranty or representation, expressed or implied, is made as to the accuracy of the information contained herein, and same is submitted subject to error and omission.