



5160 Railroad St

Sylvania, Ohio 43560

Property Highlights

- 11,000 SF available for lease (Dimisable)
- Entire building (21,000 SF) for sale
- Less than a mile from Downtown Sylvania
- Ample parking on site

Property Overview

Currently divided into 6 units (4 heated) with the flexibility to combine units or keep separate. This property sits on 2 acres (providing outdoor storage potential) along with 1 grade level door and 3 dock high doors.

Offering Summary

Sale Price:	\$675,000
Lease Rate:	\$4 - 6 SF/yr (NN)
Building Size:	21,000 SF
Available SF:	3,000 - 11,000 SF
Lot Size:	1.98 Acres

For More Information



Kevin Carr

O: 419 960 4410 x349
kcarr@naitoledo.com

Location Information

Street Address	5160 Railroad St
City, State, Zip	Sylvania, OH 43560
County	Lucas
Market	Toledo
Sub-market	Sylvania
Cross-Streets	Convent Blvd and Railroad St
Signal Intersection	No
Road Type	Gravel
Market Type	Small
Nearest Highway	Interstate 475/US 23
Nearest Airport	Detroit Metro and Toledo Express

Building Information

Building Size	21,000 SF
Building Class	C
Occupancy %	48.0%
Ceiling Height	13'-21'
Number of Grade Level Doors	1 (12' x 12')
Number of Dock High Doors	3
Number of Floors	1
Average Floor Size	21,000 SF
Year Built	1952
Gross Leasable Area	11,000 SF
Construction Status	Existing
Roof	Steel pitched
Floor Coverings	Concrete

Sale Price	\$675,000
------------	-----------

Lease Rate	\$4 - 6 SF/Yr (NN)
------------	--------------------

Property Information

Property Type	Industrial
Property Subtype	Flex Space
Zoning	B-2 General Business District
Lot Size	1.98 Acres
APN #	8204220
Traffic Count	7,920 VPD
Traffic Count Street	Main St (north of location, closer to downtown Sylvania)
Power	240V 3 phase

Parking & Transportation

Ample parking on site

Utilities & Amenities

Security Cameras	Yes
Handicap Access	No
Restrooms	1
Electric	First Energy
Gas	Columbia Gas
Water	City of Sylvania

Taxes & Valuation

2025 Taxes	\$15,378.38
------------	-------------

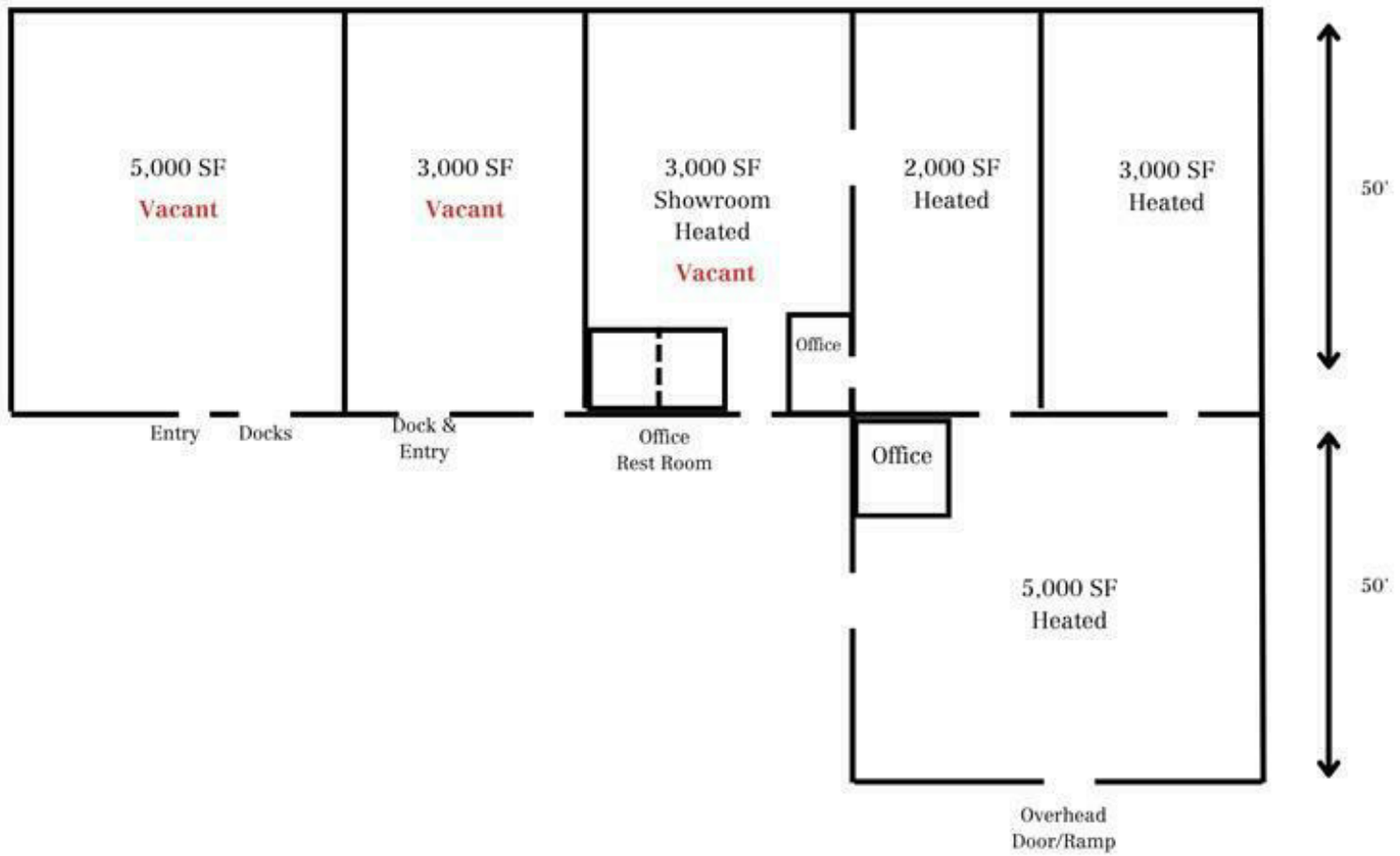



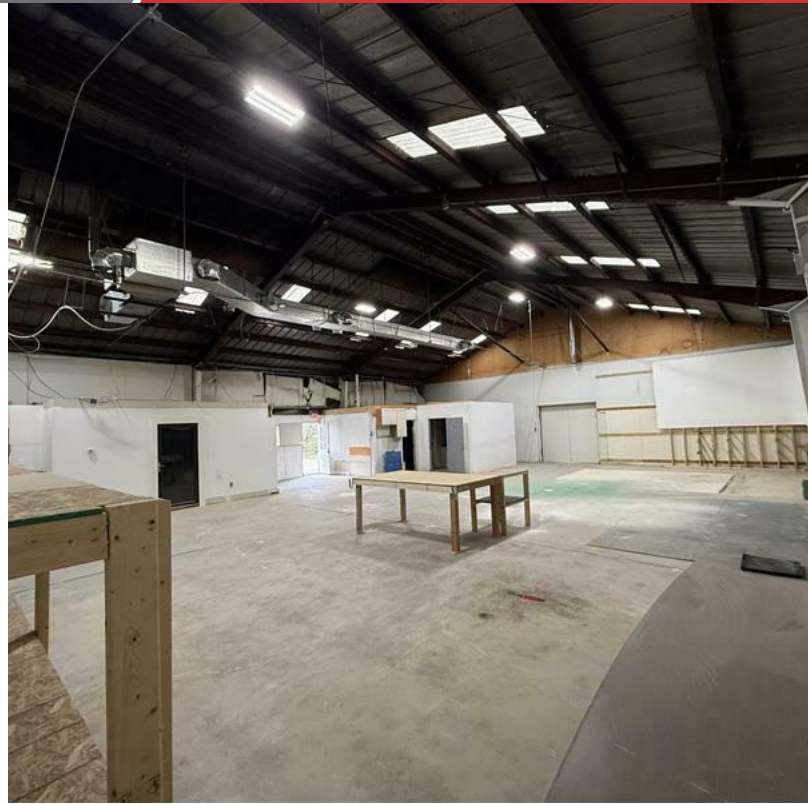



NO WARRANTY OR REPRESENTATION, EXPRESS OR IMPLIED, IS MADE AS TO THE ACCURACY OF THE INFORMATION CONTAINED HEREIN, AND THE SAME IS SUBMITTED SUBJECT TO ERRORS, OMISSIONS, CHANGE OF PRICE, RENTAL OR OTHER CONDITIONS, PRIOR SALE, LEASE OR FINANCING, OR WITHDRAWAL WITHOUT NOTICE, AND OF ANY SPECIAL LISTING CONDITIONS IMPOSED BY OUR PRINCIPALS NO WARRANTIES OR REPRESENTATIONS ARE MADE AS TO THE CONDITION OF THE PROPERTY OF ANY HAZARDS CONTAINED THEREIN ARE TO BE IMPLIED.

4427 Talmadge Rd, Suite A
 Toledo, OH 43623
 419 960 4410 tel
naiharmon.com

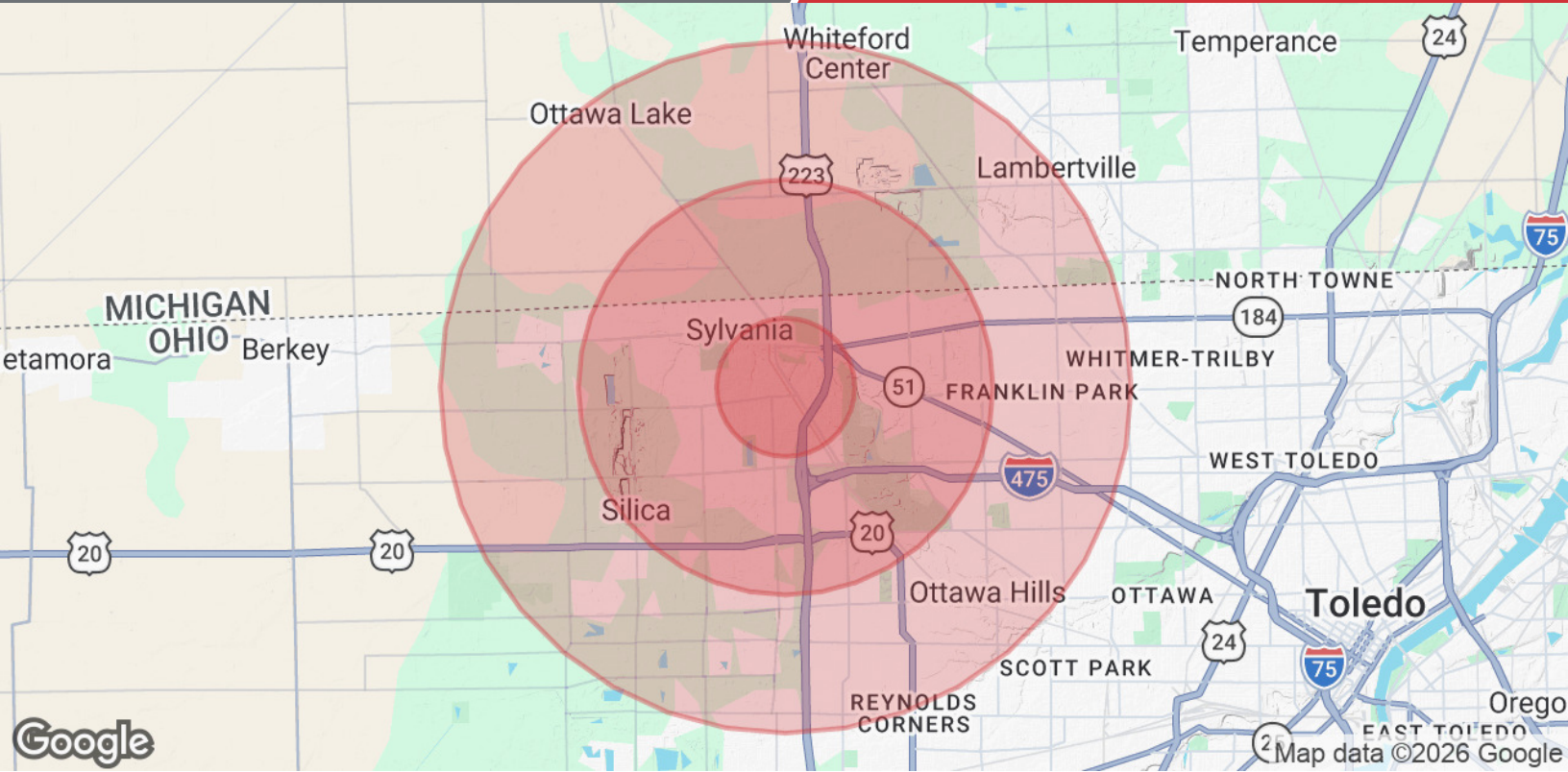

Population	1 Mile	3 Miles	5 Miles
Total Population	7,551	49,056	122,299
Average Age	40.4	42.6	41.2
Average Age (Male)	36.2	40.3	40.2
Average Age (Female)	43.9	45.0	43.0
Households & Income	1 Mile	3 Miles	5 Miles
Total Households	2,968	19,902	51,438
# of Persons per HH	2.5	2.5	2.4
Average HH Income	\$115,881	\$129,944	\$111,800
Average House Value	\$253,284	\$255,067	\$226,010

2023 American Community Survey (ACS)