

# HACIENDA CROSSING

5275 S. Arville Street  
Las Vegas, NV 89118

FOR LEASE

±6,829 SF Office/  
Warehouse Unit Available!

PRICE REDUCED!

100% HVAC  
Showroom &  
Warehouse Space

**CBRE**

**MIKE WILLMORE,**  
Member Associate, Society of  
Industrial and Office Realtors®  
Senior Associate  
+1 702 369 4823  
mike.willmore@cbre.com  
Lic # S.0183520

**KYLE KIRCHMEIER**  
Senior Associate  
+1 702 369 4862  
kyle.kirchmeier@cbre.com  
Lic # S.0197013

**LAUREN WILLMORE,**  
Member Associate, Society of  
Industrial and Office Realtors®  
Senior Associate  
+1 702 369 4825  
lauren.willmore@cbre.com  
Lic # S.0188698

**ALEX STANISIC, SIOR**  
First Vice President  
+1 702 369 4874  
alex.stanisic@cbre.com  
Lic # S.0179950

CALL FOR SPECIAL INCENTIVES!





Located on the NWC of Arville Street and Hacienda Avenue. Prime Southwest location. West of Interstate I-15 and 4 miles from Harry Reid International Airport and North of the 215 Freeway. Hacienda Crossing is a high-end office/showroom and warehouse project, with high traffic visibility.

#### PROPERTY HIGHLIGHTS

- Fully built-out and move-in ready
- Beautiful landscaping and attractive store fronts
- Dock high truck loading
- 120/208, 3-phase power
- LED monument signage
- Fantastic office/showroom/warehouse space
- Fluorescent lighting and skylights
- Built in 1998
- IL Industrial Light (Clark County)
- 2.63/1000 parking ratio (over 200 parking spaces)
- Free covered parking
- Fully Fire Sprinklered
- Evaporative-cooled warehouse
- Some units are 100% HVAC
- APN(s) : 162-30-202-015, 017, 022



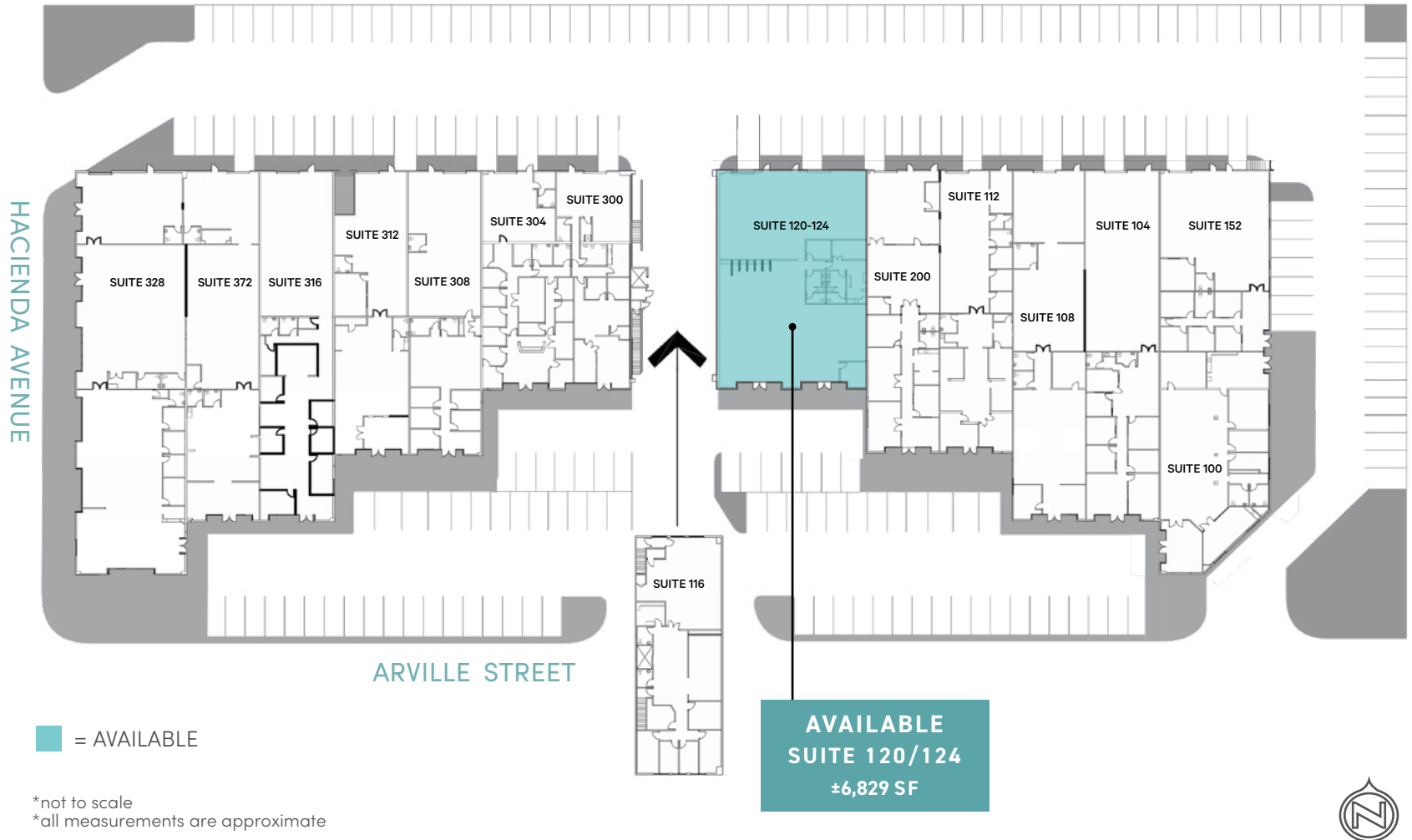

**MIKE WILLMORE,**  
Member Associate, Society of  
Industrial and Office Realtors®  
Senior Associate  
+1 702 369 4823  
mike.willmore@cbre.com  
Lic # S.0183520

**KYLE KIRCHMEIER**  
Senior Associate  
+1 702 369 4862  
kyle.kirchmeier@cbre.com  
Lic # S.0197013

**LAUREN WILLMORE,**  
Member Associate, Society of  
Industrial and Office Realtors®  
Senior Associate  
+1 702 369 4825  
lauren.willmore@cbre.com  
Lic # S.0188698

**ALEX STANISIC, SIOR**  
First Vice President  
+1 702 369 4874  
alex.stanisic@cbre.com  
Lic # S.0179950

## SUITE 120/124 - ±6,829 SF

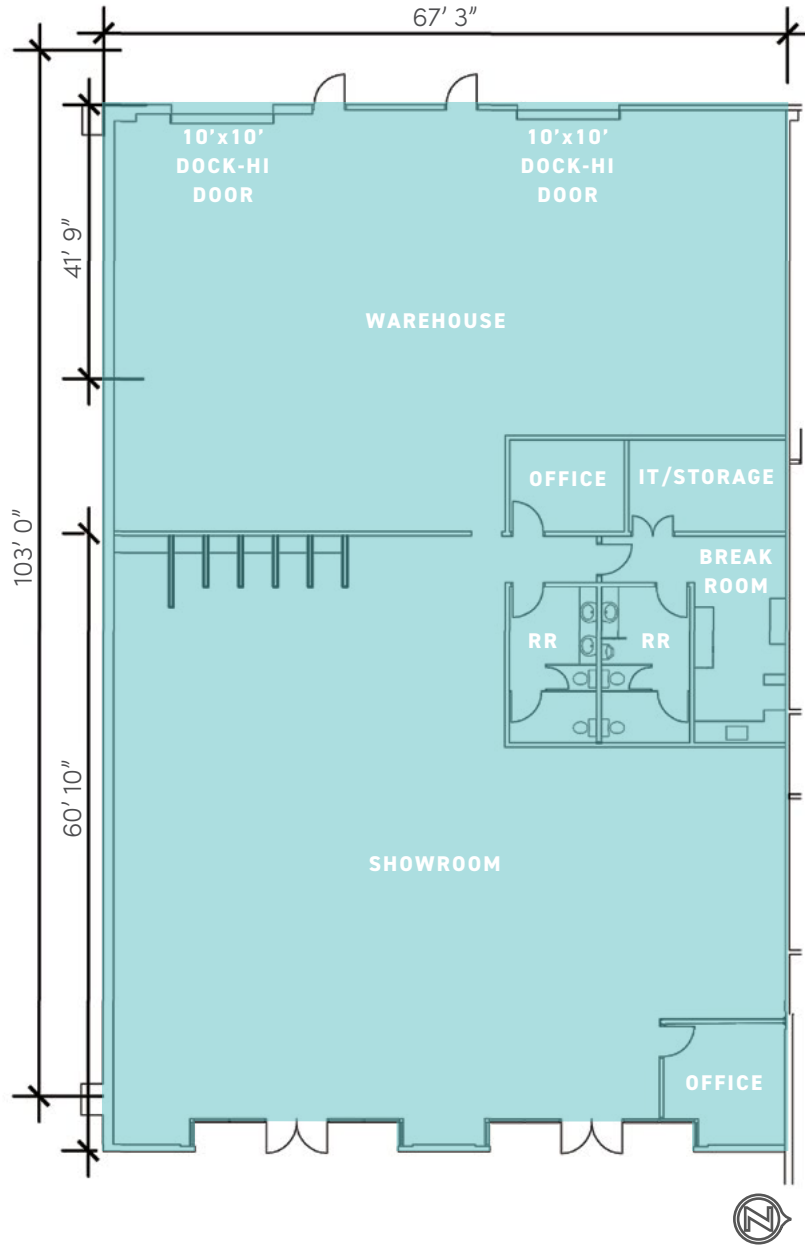

### SUITE HIGHLIGHTS

- ±6,829 Total SF
- 100% HVAC!
- ±4,297 SF of Office/Showroom Space
- ±2,532 SF Warehouse Space
- Two (2) Private Offices
- Two (2) Multi-Stall Restrooms
- Break Room
- IT/Storage Room
- 18' Clear Height
- Two (2) 10' x 10' Dock-Hi Roll-Up Doors
- Move-In Ready!
- Contact Broker regarding Special Incentives!

**LEASE RATE : \$1.29/SF (NNN)**

**2026 CAMS : \$0.328/SF (\*INCLUDES HVAC MAINTENANCE & TRASH REMOVAL)**

**TOTAL MONTHLY : \$11,049.32**

**AVAILABILITY : NOW AVAILABLE!**

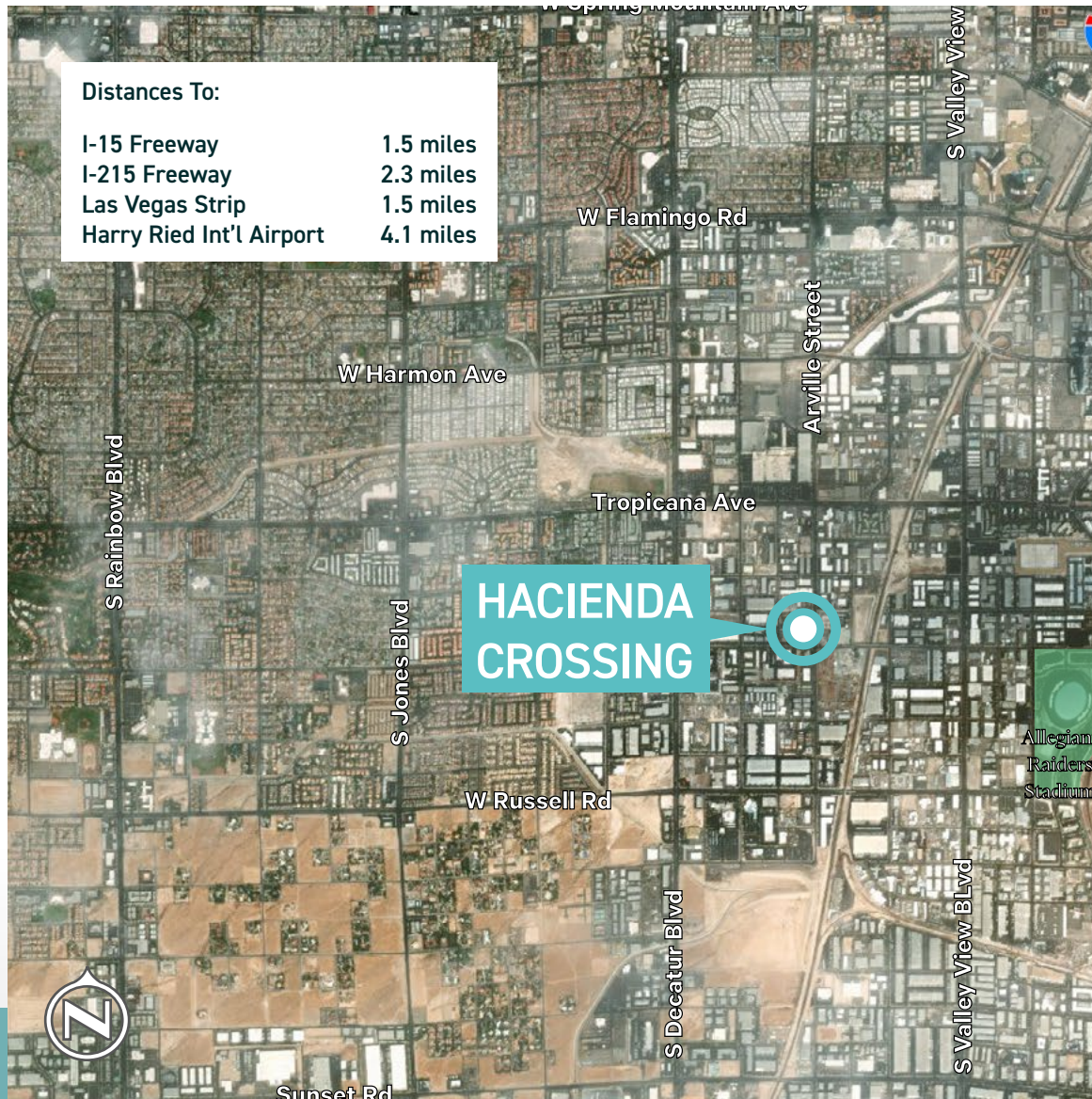

**MIKE WILLMORE,**  
 Member Associate, Society of  
 Industrial and Office Realtors®  
 Senior Associate  
 +1 702 369 4823  
 mike.willmore@cbre.com  
 Lic # S.0183520

**KYLE KIRCHMEIER**  
 Senior Associate  
 +1 702 369 4862  
 kyle.kirchmeier@cbre.com  
 Lic # S.0197013

**LAUREN WILLMORE,**  
 Member Associate, Society of  
 Industrial and Office Realtors®  
 Senior Associate  
 +1 702 369 4825  
 lauren.willmore@cbre.com  
 Lic # S.0188698

**ALEX STANISIC, SIOR**  
 First Vice President  
 +1 702 369 4874  
 alex.stanisic@cbre.com  
 Lic # S.0179950

# CONTACT US

**MIKE WILLMORE,**  
Member Associate, Society of  
Industrial and Office Realtors®  
Senior Associate  
+1 702 369 4823  
mike.willmore@cbre.com  
Lic # S.0183520

**KYLE KIRCHMEIER**  
Senior Associate  
+1 702 369 4862  
kyle.kirchmeier@cbre.com  
Lic # S.0197013

**LAUREN WILLMORE,**  
Member Associate, Society of  
Industrial and Office Realtors®  
Senior Associate  
+1 702 369 4825  
lauren.willmore@cbre.com  
Lic # S.0188698

**ALEX STANISIC, SIOR**  
First Vice President  
+1 702 369 4874  
alex.stanisic@cbre.com  
Lic # S.0179950

## HACIENDA CROSSING

5275 S. ARVILLE STREET | LAS VEGAS, NV 89118

© 2026 CBRE, Inc. All rights reserved. This information has been obtained from sources believed reliable, but has not been verified for accuracy or completeness. You should conduct a careful, independent investigation of the property and verify all information. Any reliance on this information is solely at your own risk. CBRE and the CBRE logo are service marks of CBRE, Inc. All other marks displayed on this document are the property of their respective owners, and the use of such logos does not imply any affiliation with or endorsement of CBRE. Photos herein are the property of their respective owners. Use of these images without the express written consent of the owner is prohibited.