

# NAI Sioux Falls

Sioux Empire Corporate Park  
Building II, 705 E. 60th Street N, Sioux Falls, SD 57104  
**Lease Rate: \$13.00/SF**



2500 W 49th Street Suite 100  
Sioux Falls, SD 57105  
605 357 7100  
naisiouxfalls.com

**Gregg Brown**  
*Managing Director, MBA, SIOR*  
605 906 0394  
gbrown@naisiouxfalls.com

**Troy Fawcett**  
*President, CCIM, SIOR*  
605 321 2199  
tfawcett@naisiouxfalls.com

NAI Sioux Falls

# AMENITIES

Sioux Empire Corporate Park  
Building II, 705 E. 60th Street N, Sioux Falls, SD 57104  
**Lease Rate: \$13.00/SF**

- Ample parking for call center users
- Easy access to highways and airport
- Raised flooring
- Back up generator
- Loading docks
- Walkway connecting to Buildings 1 & 3



## AVAILABILITY

Lease a single floor or the whole building  
61,164 - 124,626 sq. ft.

### LEASE PRICE

\$13.00/ SQ. FT. NNN

### Estimated NNN

\$5.00/ SQ. FT.

Lease Term: 3-10 years

Available: Immediately

Overview	
Building Size	127,332 sq. ft.
Main Floor:	62,583 sq. ft.
Upper Level:	64,749 sq. ft.
Lot size:	28.18 acres
Zoning:	I-1
Year Built:	1986
Office Space:	Main & Second Level
Layout:	Open Plan/ Call Center
Sub-Dividable:	Contact Broker
Parking:	1:189 sq. ft.
HVAC:	Condenser Water System/ Heat Pumps
Roof:	Tar & Gravel
Exterior Finish:	Tilt Up Concrete
Dock Doors:	3 dock doors 1 roll-up door
Elevators:	1 freight, 1 passenger
Column Spacing:	30'
Floor:	Raised System - 16"
Sprinkler System:	Wet
Cafeteria:	Yes - need to arrange services with vendor
Elevators:	1 Freight, 1 passenger
Special Features:	Connected to Building #1 & #3 via walkways

UPS	
Size/ Manufacturer:	500, KVA, Powerware 9315
Items Covered by UPS:	Critical Systems
Battery Type:	Enerys Wet Calls
Generator	
Size/ Manufacturer:	1375/ KVA, Catepillar 3512
Items Covered:	Full Building Systems
CER Cooling:	CRAC Units/ Liebert
Fuel Tanks	
Type	UST - in a cement vault
Total Fuel Tank Capacity	10,000 gal.
Duration Full Load	3.5 days
Area Neighbors	
<ul style="list-style-type: none"> <li>• Amazon</li> <li>• Dakota Silencer</li> <li>• Furniture Mart USA</li> <li>• Daktronics</li> <li>• Diamond Mowers</li> <li>• Sheehan Mac Sales &amp; Service</li> <li>• Presido</li> <li>• Sanford Health</li> <li>• United States Post Office</li> <li>• Gil Haugan Construction</li> </ul>	

# AMENITIES

Sioux Empire Corporate Park  
Building II, 705 E. 60th Street N, Sioux Falls, SD 57104  
Lease Rate: \$13.00/SF



NO WARRANTY OR REPRESENTATION, EXPRESS OR IMPLIED, IS MADE AS TO THE ACCURACY OF THE INFORMATION CONTAINED HEREIN, AND THE SAME IS SUBMITTED SUBJECT TO ERRORS, OMISSIONS, CHANGE OF PRICE, RENTAL OR OTHER CONDITIONS, PRIOR SALE, LEASE OR FINANCING, OR WITHDRAWAL WITHOUT NOTICE, AND OF ANY SPECIAL LISTING CONDITIONS IMPOSED BY OUR PRINCIPALS. NO WARRANTIES OR REPRESENTATIONS ARE MADE AS TO THE CONDITION OF THE PROPERTY OR ANY HAZARDS CONTAINED THEREIN ARE ANY TO BE IMPLIED.

# AREA MAP

**Sioux Empire Corporate Park**  
 Building II, 705 E. 60th Street N, Sioux Falls, SD 57104  
**Lease Rate: \$13.00/SF**

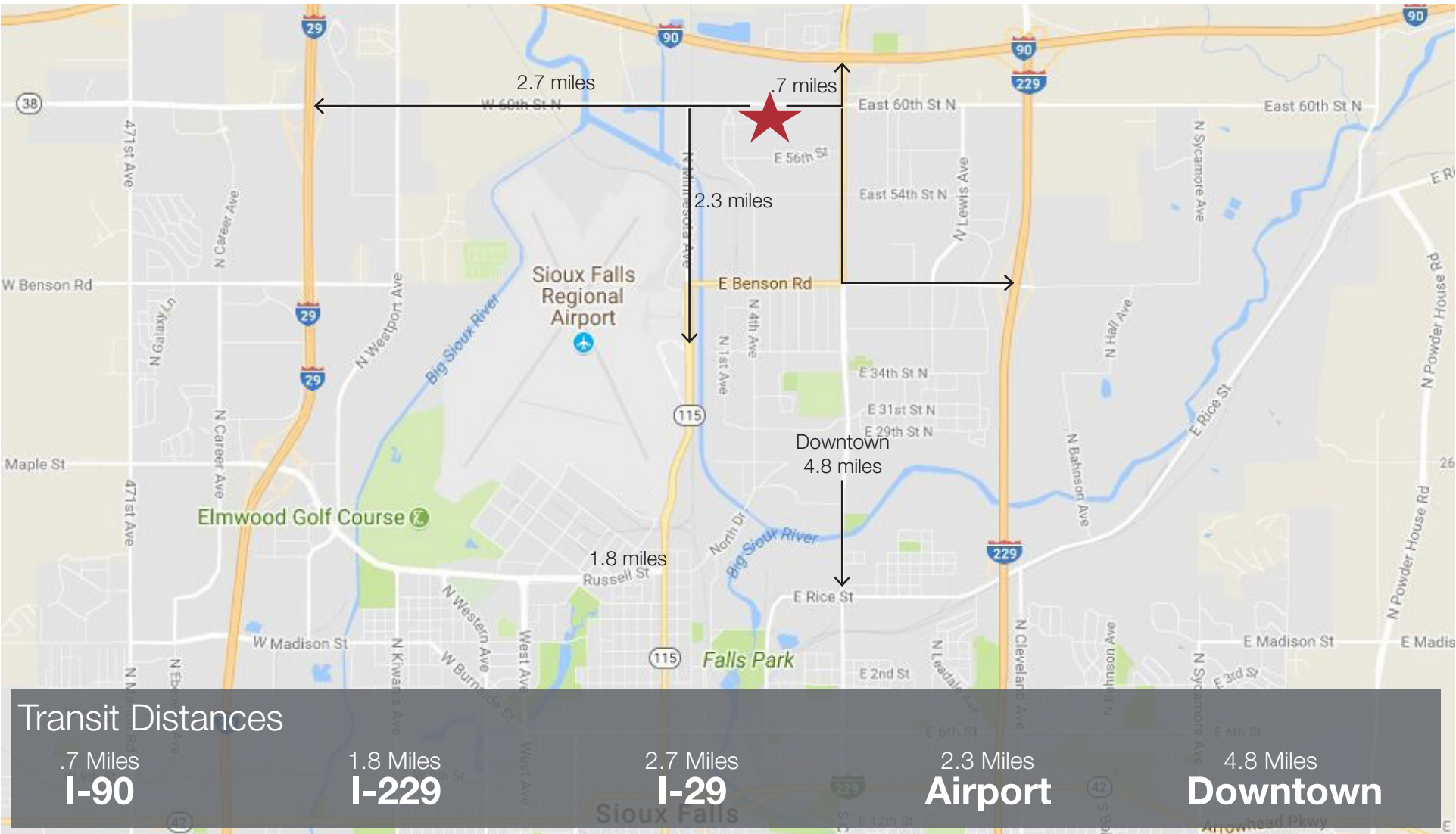

## Transit Distances

0.7 Miles  
**I-90**

1.8 Miles  
**I-229**

2.7 Miles  
**I-29**

2.3 Miles  
**Airport**

4.8 Miles  
**Downtown**

# SITE PLAN

Sioux Empire Corporate Park  
Building II, 705 E. 60th Street N, Sioux Falls, SD 57104  
**Lease Rate: \$13.00/SF**

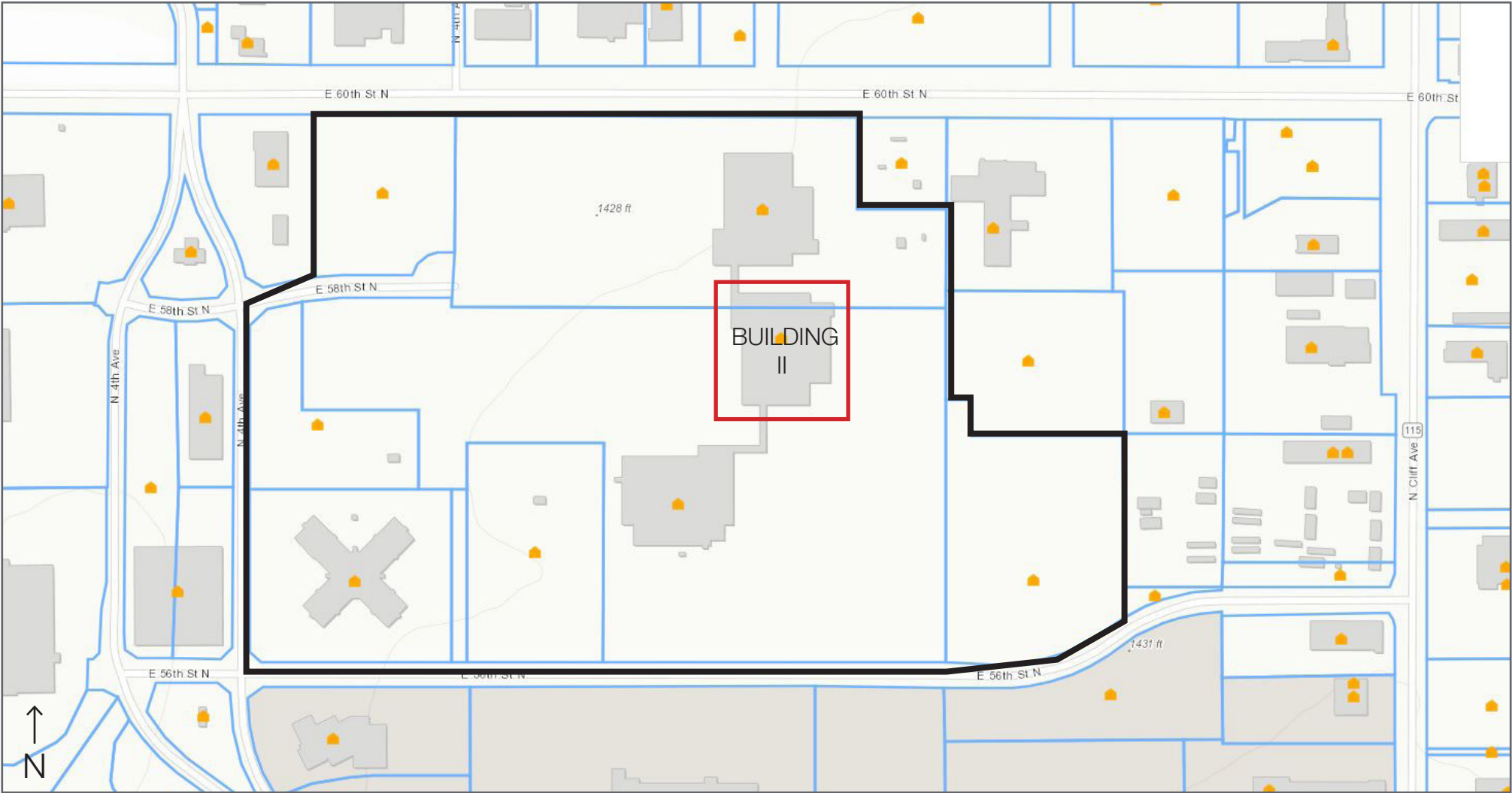

# PHOTOS

Sioux Empire Corporate Park

Building II, 705 E. 60th Street N, Sioux Falls, SD 57104

Lease Rate: \$13.00/SF



# PHOTOS

Sioux Empire Corporate Park

Building II, 705 E. 60th Street N, Sioux Falls, SD 57104

**Lease Rate: \$13.00/SF**



# FLOOR PLANS

Sioux Empire Corporate Park

Building II, 705 E. 60th Street N, Sioux Falls, SD 57104

**Lease Rate: \$13.00/SF**

FIRST FLOOR  
62,583 SQ. FT.

10 Offices  
481 Workstations

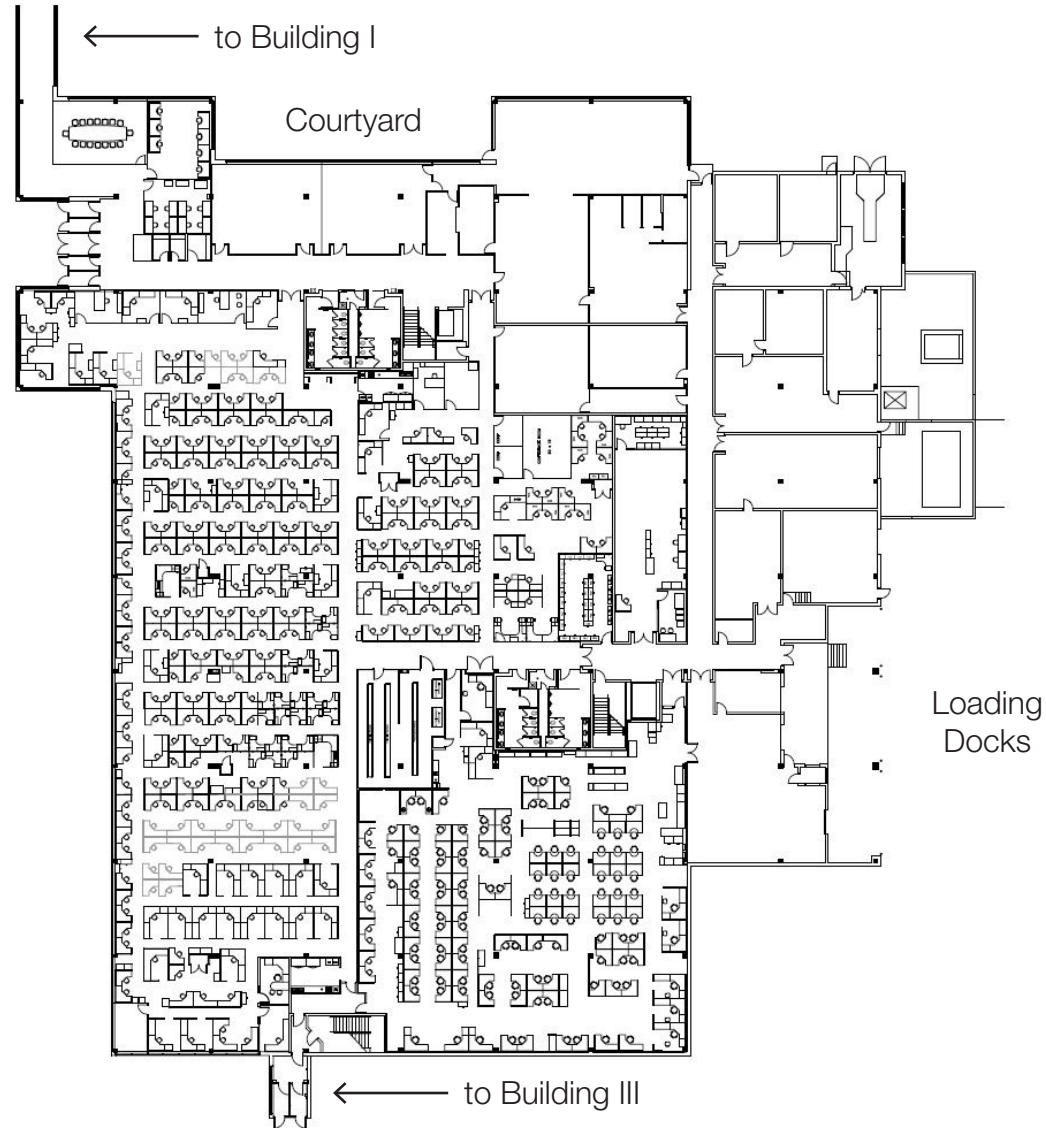

# FLOOR PLANS

Sioux Empire Corporate Park

Building II, 701 E. 60th Street N, Sioux Falls, SD 57104

Lease Rate: \$13.00/SF

SECOND FLOOR  
64,749 SQ. FT.

25 Offices  
853 Workstations  
Raised flooring  
LAN room w/ Liebert Units



Sky walk to Building III

Sky walk to Building I

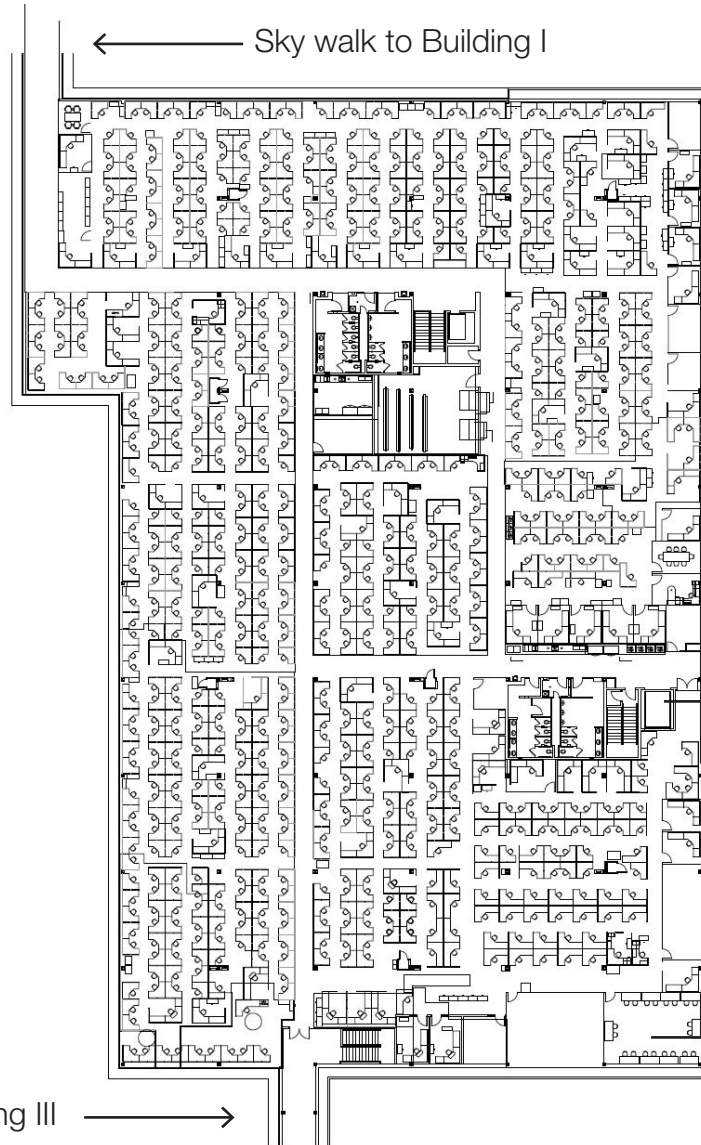

Freight Elevator

Training Room