

AVAILABLE FOR THE FIRST TIME

30,000-200,000 RSF AVAILABLE | VISIBILITY FROM OVER 150,000 VEHICLES PER DAY



2200

2222

KENSINGTON CT.

2200-2222 KENSINGTON COURT, OAK BROOK

2200 2222

KENSINGTON CT.

# exclusive

## PROPERTY UNVEILING

For the first time, 2200–2222 Kensington Court, a notable work by celebrated modernist architect Mies van der Rohe, is opening its doors to new possibilities. This unique building features prominent signage near I-88, ensuring high-visibility, along with direct access to the center of Oak Brook. Its flexible floorplan allows for the creation of a space that meets your specific needs.

- Efficient floor plates with floor-to-ceiling windows
- Large parking ratio
- Back-up generator on-site
- Prominent tollway signage



2200 2222

KENSINGTON CT.

# historic design

AND CENTRALLY LOCATED

- Classic Mies van der Rohe design
- Less than 5 minutes from I-88, I-294, and Route 83
- Close proximity to Oak Brook area amenities
- Connected to Oak Brook walking paths

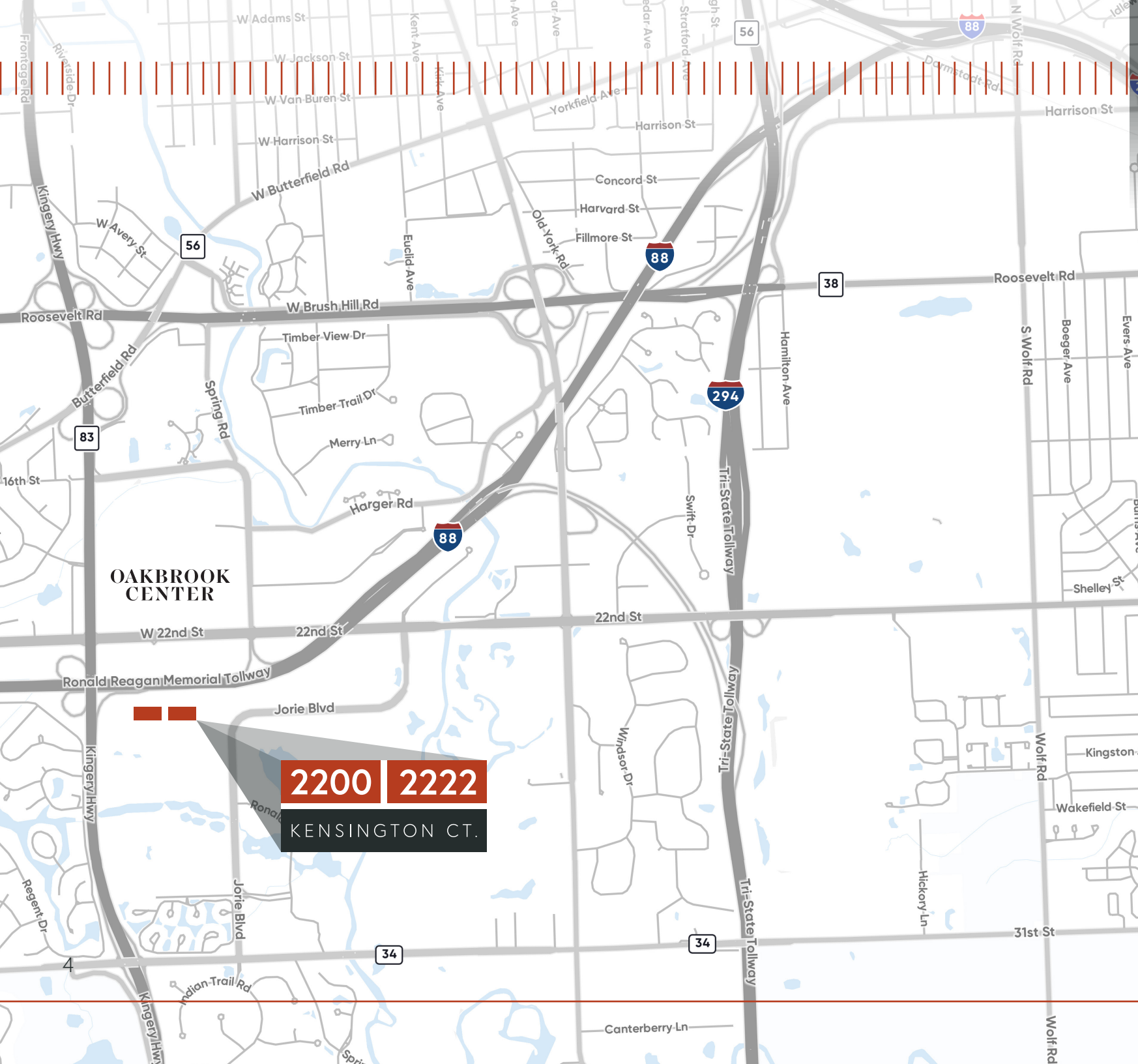

**2200** **2222**

**KENSINGTON CT.**

Single 30,000 SF floors available for lease.

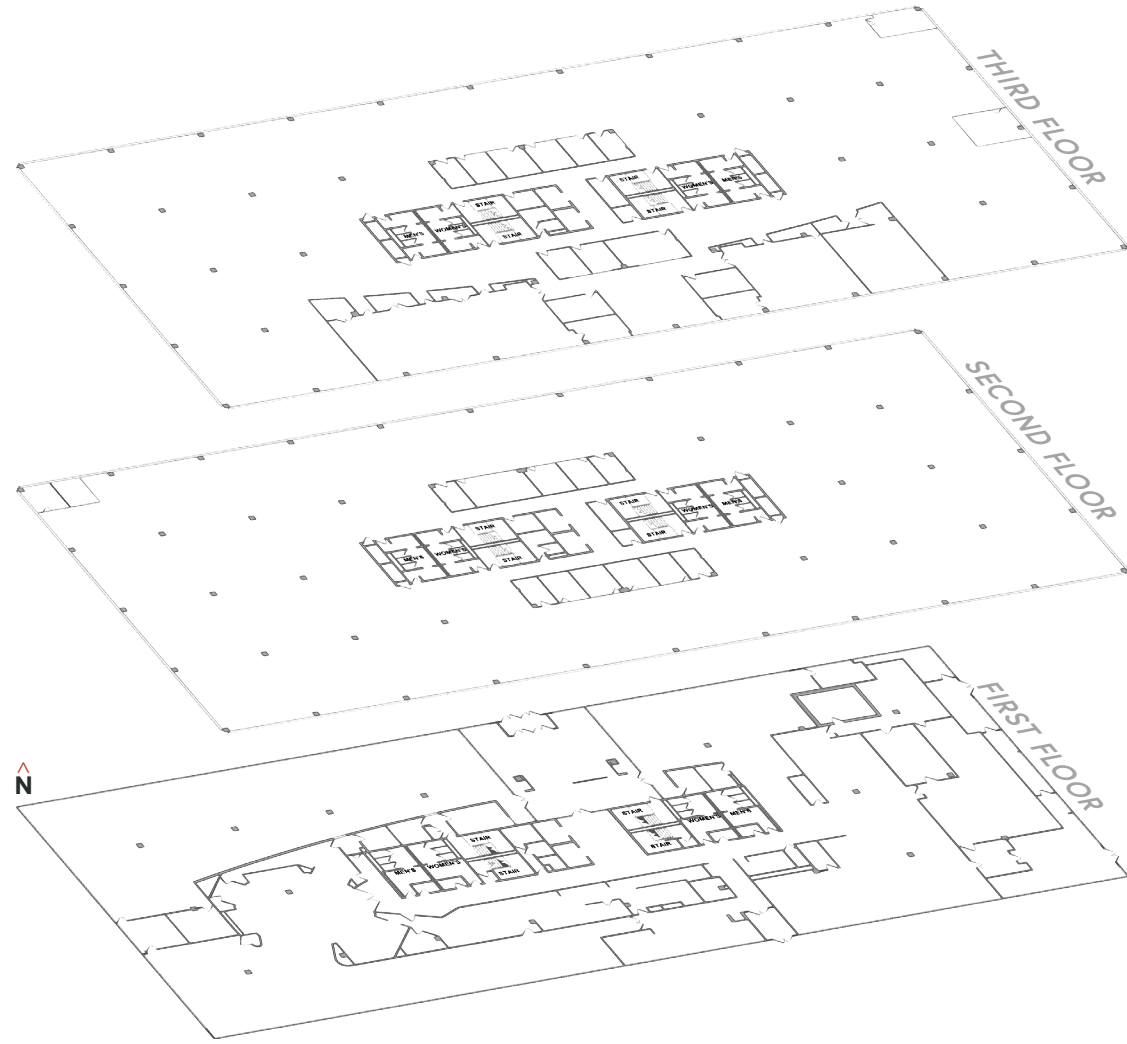

**2200 BUILDING | 105,032 RSF**

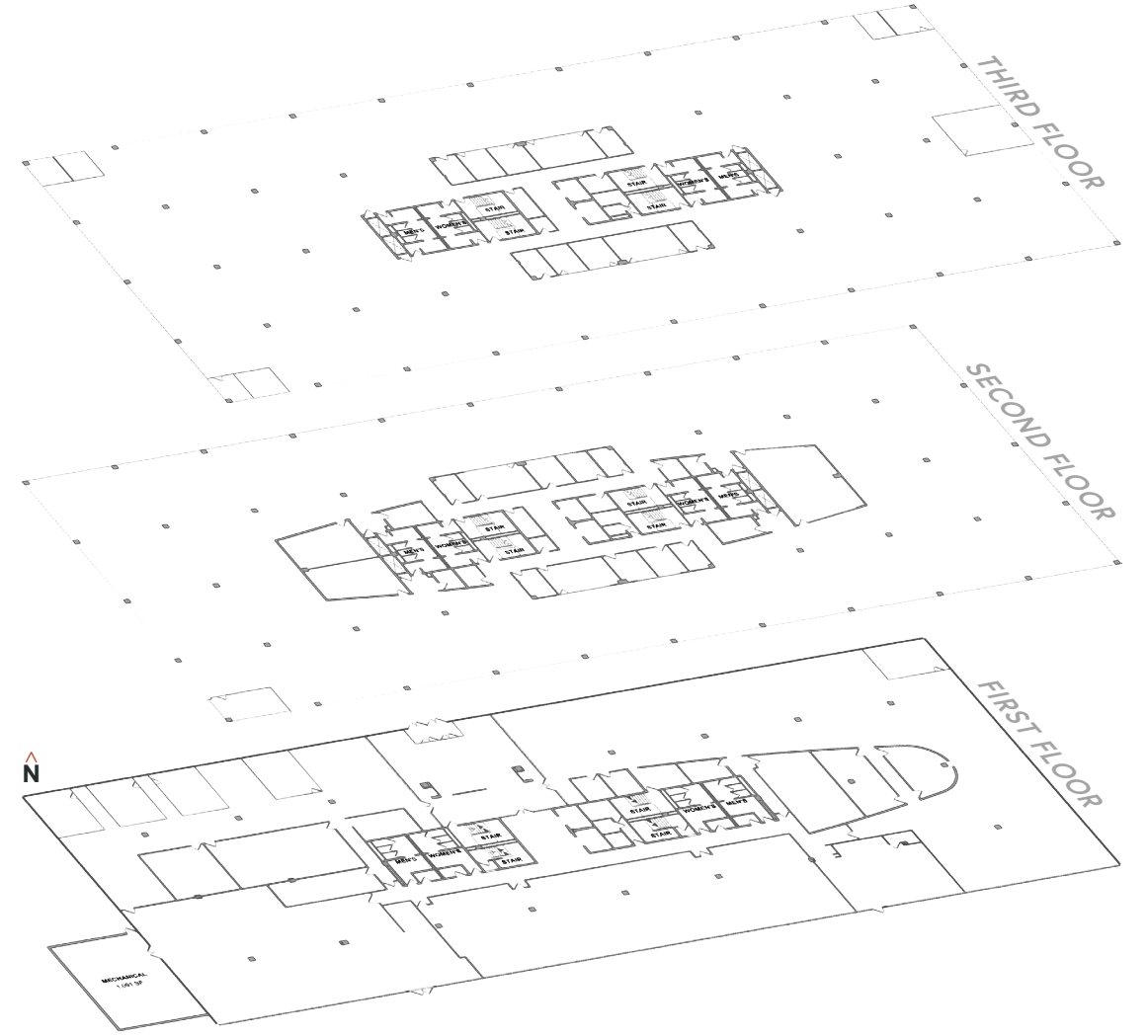

**2222 BUILDING | 105,224 RSF**

2200

2222

KENSINGTON CT.

2200-2222 KENSINGTON COURT  
OAK BROOK, IL 60523

**JOEL BERGER**

jberger@bradfordallen.com

+1 630 225 2600

**NORMAN MURDOCH**

nmurdoch@bradfordallen.com

+1 630 239 4082

[bradfordallen.com](http://bradfordallen.com)