



DINING, ENTERTAINMENT, & RETAIL
AT

UNION STATION



BE A PART OF THE CITY'S PAST, PRESENT,
AND FUTURE GRANDEUR...

UNION STATION

...ONE OF WASHINGTON D.C.'S MOST
ICONIC ARCHITECTURAL MARVELS AND A
LIVING MONUMENT TO THE CITY AND
NATION'S RICH HISTORY

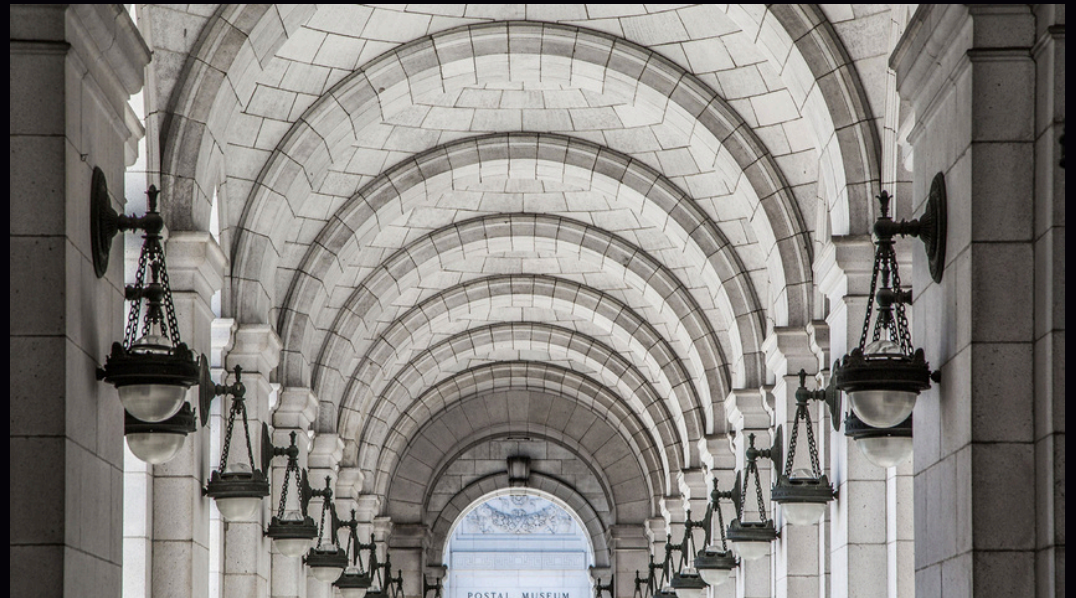
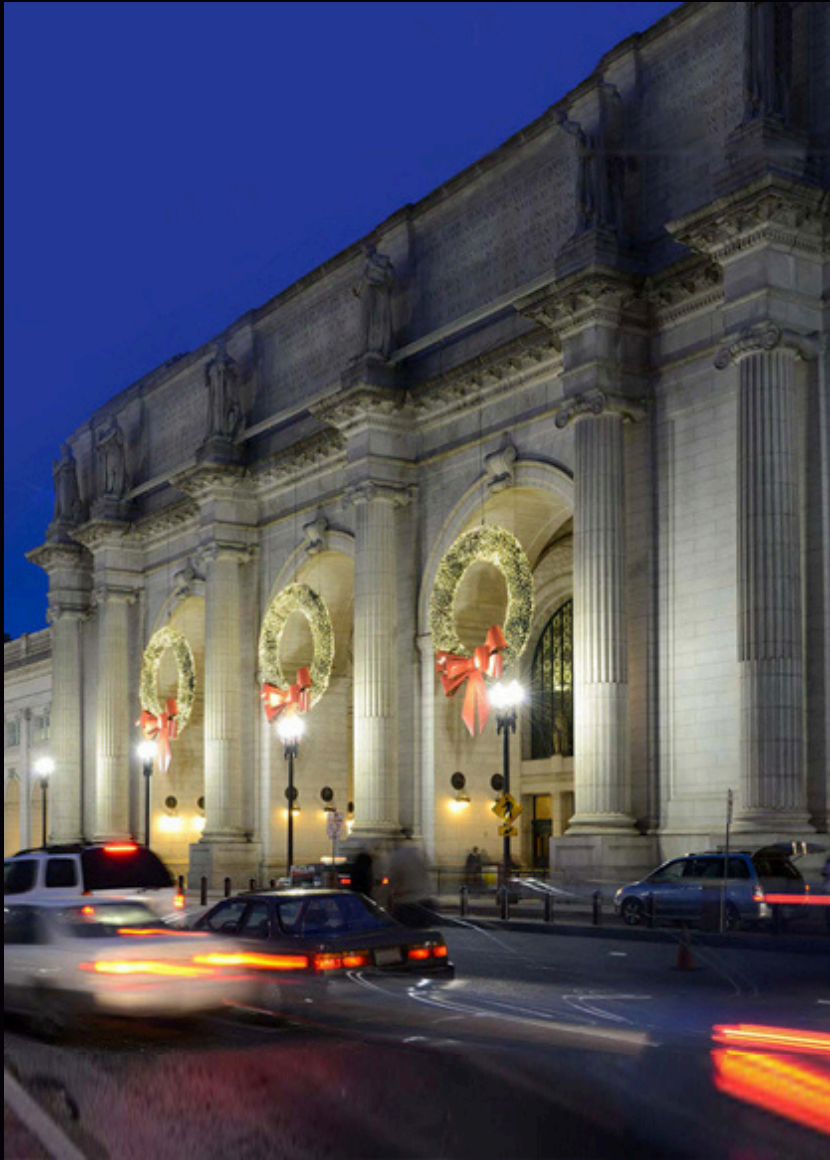

**25.95
MILLION**



visitors come through
Washington, DC annually



**\$10.2
BILLION**
Total Visitor Spending



163

Hotels in
DC Proper

with **35,000+** rooms



Washington, DC

691,893

Residential Population

1,095,660

Daytime Population



Greater DC Area

6,429,395

Residential Population

\$122,325

Median Household
Income (**National
Average: \$79,068**)



Sources: ESRI, Costar, Destination DC

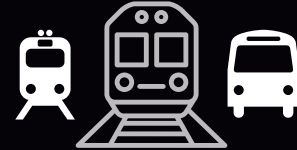

Union Station serves Amtrak, MARC, VRE commuter rail, Metro Rail & Buses, and Regional Buses such as Greyhound, Megabus, & Bolt Bus



The **Union Station Metro Station** is the **highest trafficked station** in the WMATA system



Union Station is a **central hub** for all Washington, DC tour buses



7 million annual ridership



Washington Union Station is the **2nd busiest** rail station in the United States, only behind Penn Station in NYC

Amtrak will be moving their **Headquarters** to the offices at **Union Station** in **2026**, bringing **~1,000 employees** on-site

Sources: WMATA, Amtrak



MAIN LEVEL



LOWER LEVEL

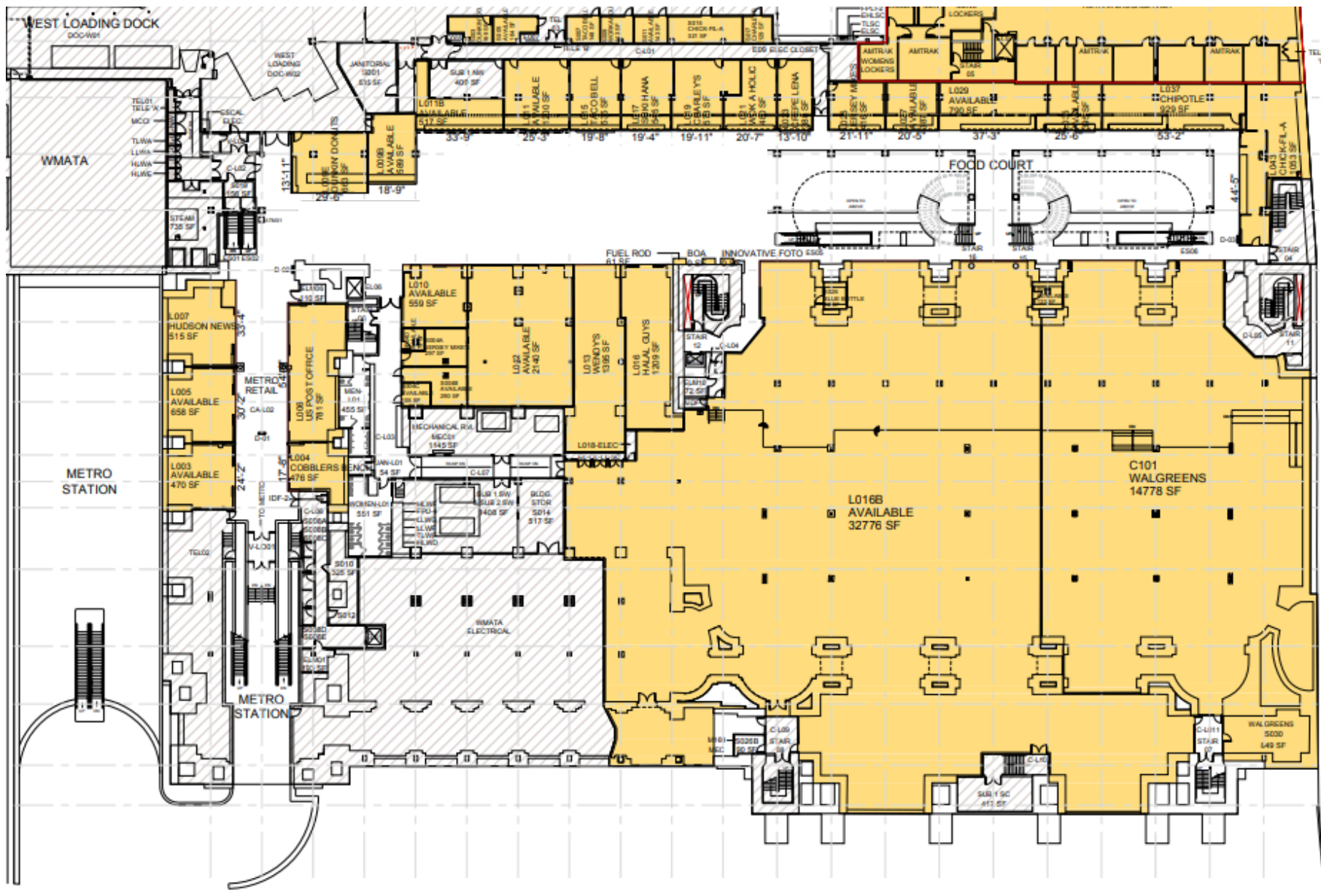

MEZZANINE LEVEL

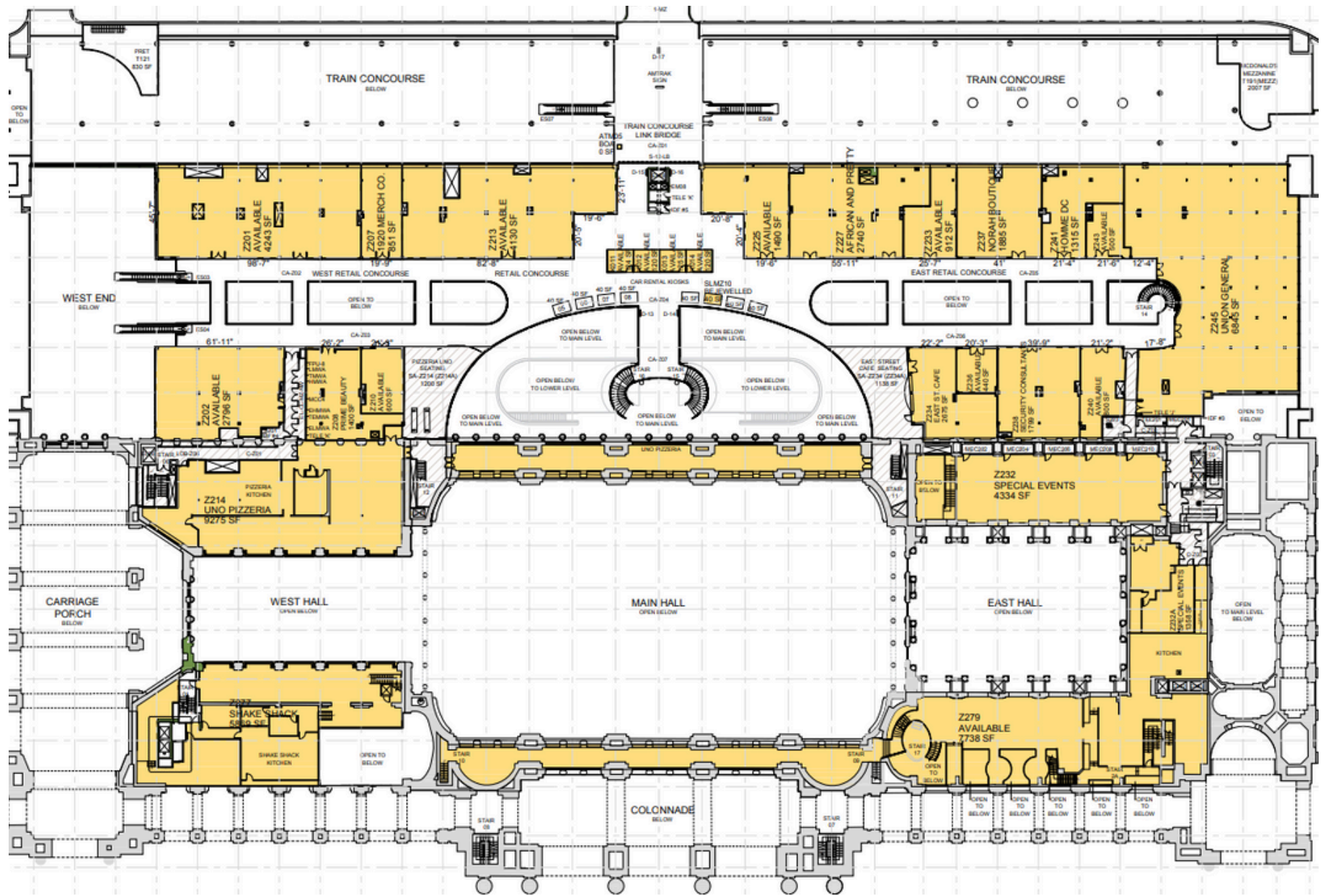

- | | | | | |
|--------------------------------------|---|--|--|--|
| 1 UNION STATION | 7 BOTANIC GARDENS | 13 NATIONAL GALLERY OF ART | 19 US HOLOCAUST MEMORIAL MUSEUM | 25 MARTIN LUTHER KING JR MEMORIAL |
| 2 SMITHSONIAN'S POSTAL MUSEUM | 8 NATIONAL MUSEUM OF THE AMERICAN INDIAN | 14 SMITHSONIAN LIBRARIES | 20 NATIONAL WWII MUSEUM | 26 FDR MEMORIAL |
| 3 COLUMBUS CIRCLE | 9 AIR AND SPACE MUSEUM | 15 WASHINGTON MONUMENT | 21 CONSTITUTION GARDENS | 27 JEFFERSON MEMORIAL |
| 4 UNITED STATES CAPITOL | 10 HIRSHORN MUSEUM | 16 SMITHSONIAN AMERICAN ART MUSEUM | 22 LINCOLN MEMORIAL REFLECTING POOL | 28 NEWSEUM |
| 5 LIBRARY OF CONGRESS | 11 NATIONAL MALL | 17 SMITHSONIAN MUSEUM OF AMERICAN HISTORY | 23 LINCOLN MEMORIAL | 29 CAPITAL ONE ARENA |
| 6 STANTON PARK | 12 SMITHSONIAN CASTLE | 18 THE WHITE HOUSE | 24 KOREAN WAR VETERANS MEMORIAL | 30 NATIONAL BUILDING MUSEUM |

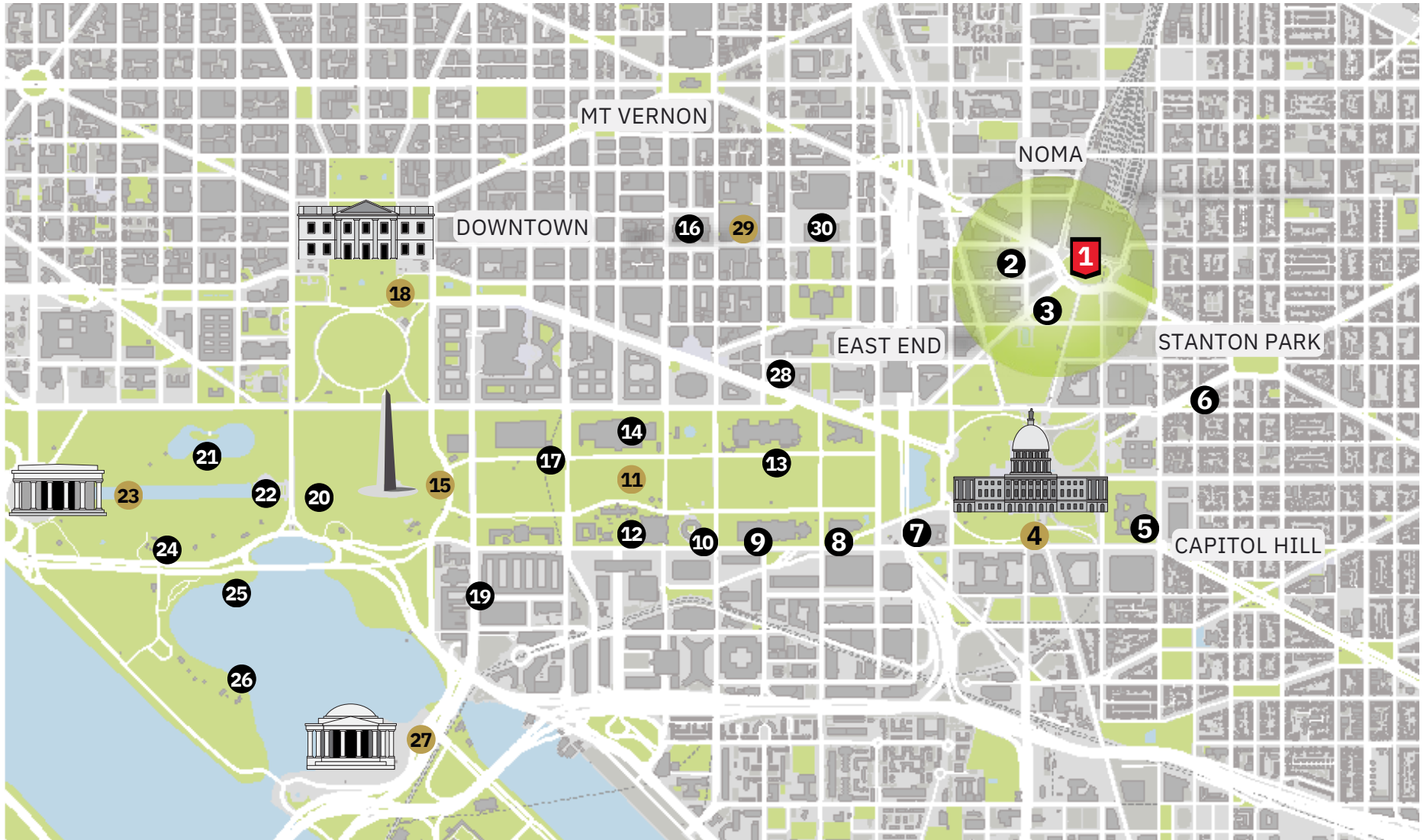

Retail Leasing By:



Thomas Papadopoulos

tpap@papadop.com

O: (202) 466-2200

C: (202) 271-8661

John Gogos

Partner

jgogos@papadop.com

O: (202) 466-2200

C: (202) 365-5589

Adam Bush

Associate

abush@papadop.com

O: (202) 466-2200

C: (703) 268-9504

