

D&D INDUSTRIAL

18501 COLLIER AVENUE, LAKE ELSINORE, CA 92530

FOR LEASE

+/- 2,136 SF - +/- 2,894 SF INDUSTRIAL SPACE



FOR MORE INFORMATION, PLEASE CONTACT:

CAREY PASTOR | Senior Vice President
(951) 297-7434 | cpastor@cbcsocalgroup.com
CalDRE License # 01403298

KELLY ADAIR | Senior Associate
(760) 703-2668 | kadair@cbcsocalgroup.com
CalDRE License # 02212071



**COLDWELL BANKER
COMMERCIAL**
SC

D&D INDUSTRIAL

18501 COLLIER AVENUE, LAKE ELSINORE, CA 92530

FOR LEASE

+/- 2,136 SF - +/- 2,894 SF INDUSTRIAL SPACE

PROPERTY HIGHLIGHTS

- +/- 2,136 SF - +/- 2,894 SF Industrial space available
- 1-12'w x 14'h roll-up door per unit
- 17' clear height
- 200 amp, 3 phase power supply per unit
- Central business location within I-15 corridor
- Retail and restaurant amenities nearby including: Lowe's The Home Depot, Costco, Target, Chili's, Starbucks



D&D INDUSTRIAL

18501 COLLIER AVENUE, LAKE ELSINORE, CA 92530

FOR LEASE

+/- 2,136 SF - +/- 2,894 SF INDUSTRIAL SPACE

AVAILABILITY

UNIT	UNIT SIZE	MONTHLY LEASE RATE	DESCRIPTION
A-100	±2,894 SF	\$4,196.00 Per month	Reception area, open office, 1 restroom and warehouse with 1 roll up door
B-105	±2,136 SF	\$3,097.00 Per month	Reception area, private office, 1 restroom and warehouse with 1 roll up door

FLOOR PLAN B-105

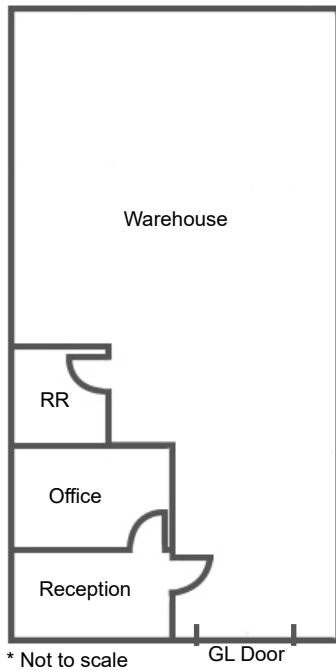

SITE PLAN

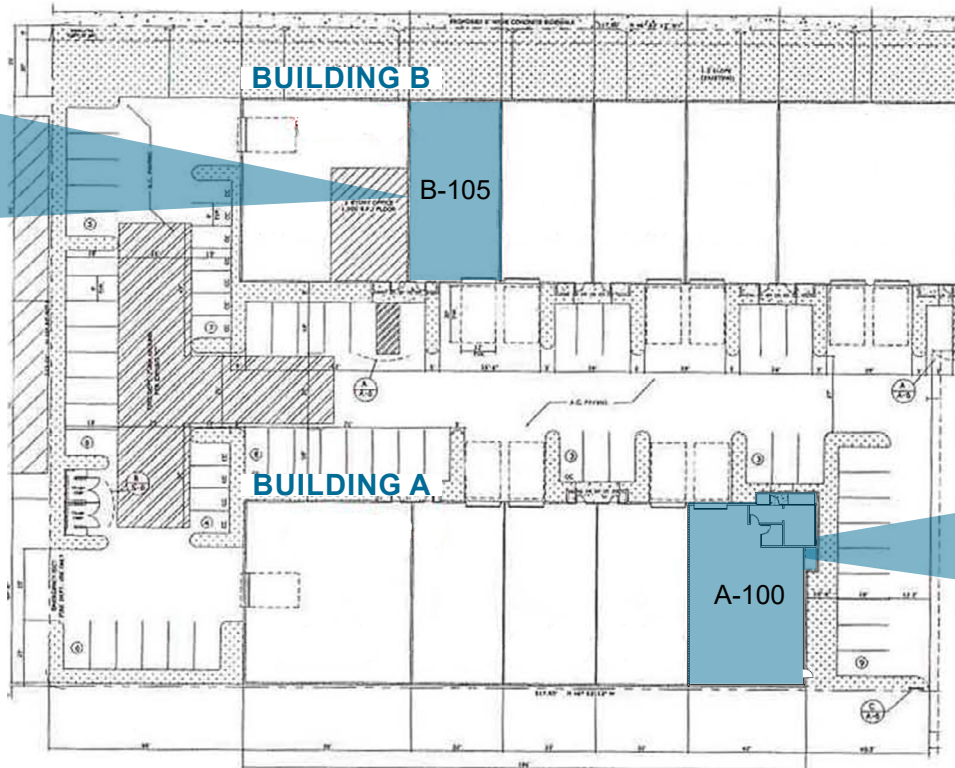

FLOOR PLAN A-100

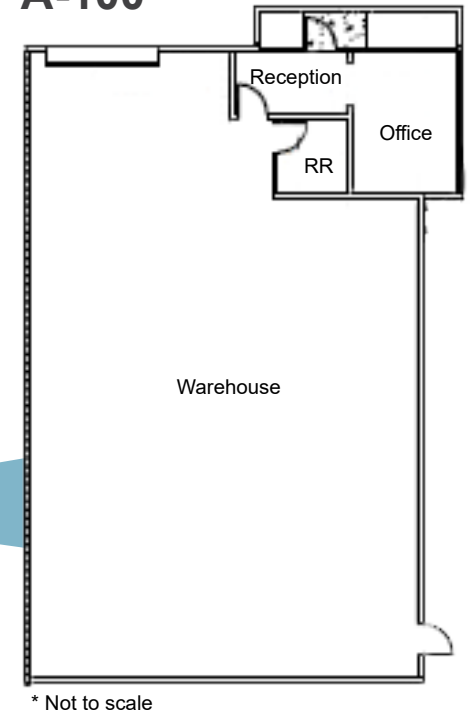

D&D INDUSTRIAL

18501 COLLIER AVENUE, LAKE ELSINORE, CA 92530

FOR LEASE

+/- 2,136 SF - +/- 2,894 SF INDUSTRIAL SPACE

PROPERTY PHOTOS & VIDEOS

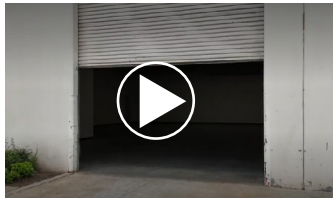

[Click Here to View Video of Warehouse](#)



[Click Here to View Video of Office](#)

D&D INDUSTRIAL

18501 COLLIER AVENUE, LAKE ELSINORE, CA 92530

FOR LEASE

+/- 2,136 SF - +/- 2,894 SF INDUSTRIAL SPACE



D&D INDUSTRIAL

18501 COLLIER AVENUE, LAKE ELSINORE, CA 92530

FOR LEASE

+/- 2,136 SF - +/- 2,894 SF INDUSTRIAL SPACE



Coldwell Banker Commercial and the Coldwell Banker Commercial Logo are registered service marks licensed to Coldwell Banker Commercial Affiliates. Each Office is Independently Owned and Operated. All information contained herein has been obtained from sources deemed reliable. However, no warranty or guarantee is made as to the accuracy of the information.

CalDRE License # 02089395

D&D INDUSTRIAL

18501 COLLIER AVENUE, LAKE ELSINORE, CA 92530

FOR LEASE

+/- 2,136 SF - +/- 2,894 SF INDUSTRIAL SPACE



FOR MORE INFORMATION, PLEASE CONTACT:

CAREY PASTOR

Senior Vice President

951.297.7434

cpastor@cbsocalgroup.com

CaIDRE # 01403298

KELLY ADAIR

Senior Associate

760.703.2668

kadair@cbsocalgroup.com

CaIDRE # 02212071

27368 Via Industria | Suite 102
Temecula | California | 92590
t 951.200.7683 | f 951.239.3147
cbsocalgroup.com



**COLDWELL BANKER
COMMERCIAL**

SC