



## Hilltop Business Center

4785 Elati Street, Unit 15, Denver, CO

Excellent Central industrial facility in Enterprise Zone. Easy access to I-70 and I-25. Access to well-qualified labor base. Short commute to Central Business District and Downtown. Quality showroom / office / warehouse space with fenced loading.

### Highlights

- Available SF:** 7,075 SF
- Office SF:** ±1,316 SF
- Loading:** 1 drive-in door and 1 dock well
- Clear Height:** ±16'
- Columns:** 30'-8" x 38'-3"
- Power:** To be verified by an electrician
- Parking:** 2 : 1,000 SF
- Zoning:** I-B
- 2026 CAM:** \$5.99/SF (estimate)
- Base Rent:** \$10.00/SF NNN

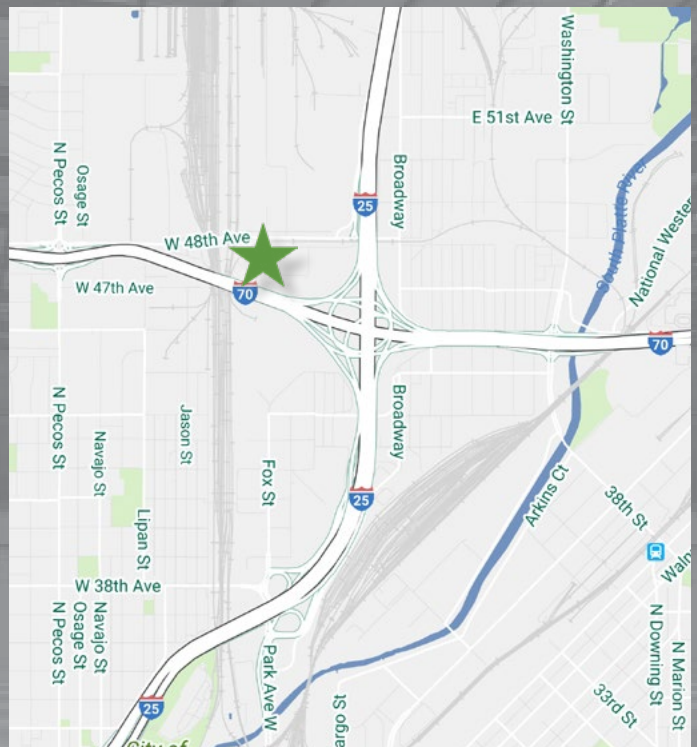

# Hilltop Business Center

4785 Elati Street, Unit 15, Denver, CO

## Space Plan

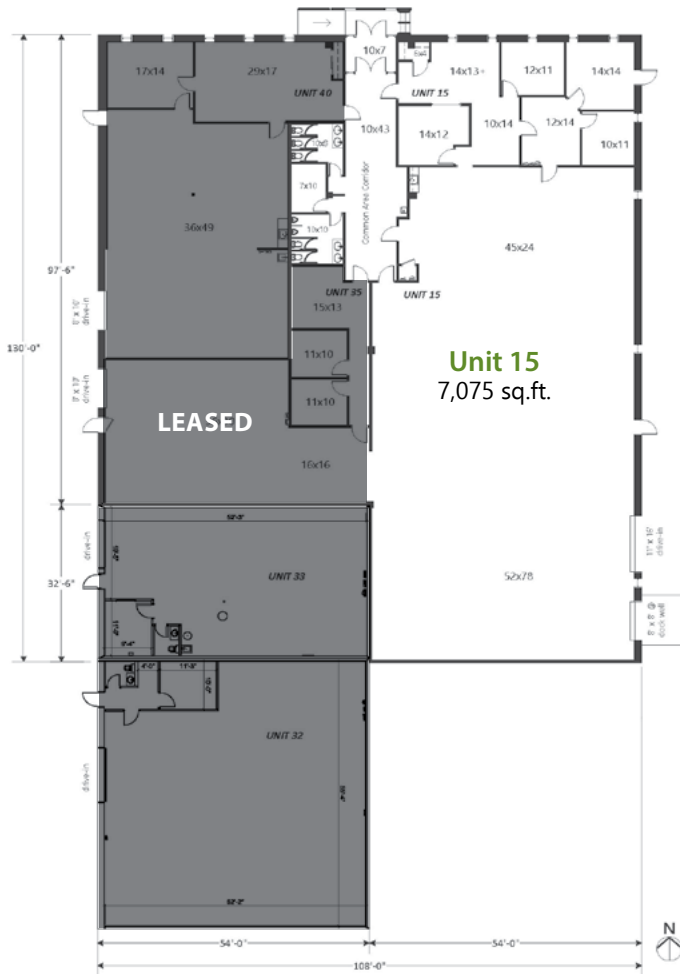

## Broker Contact

Bill Thompson  
(720) 528-6373  
bill.thompson@cbre.com

Matt Kawulok  
(720) 528-6353  
matt.kawulok@cbre.com

# CBRE

[www.cbre.com](http://www.cbre.com)

## Owner Contact

John Strabel  
Regional Director  
8200 Park Meadows Drive, Unit 8226  
Lone Tree, CO 80124  
Direct: (248) 894-3974  
jstrabel@firstindustrial.com

**FIRST**  
INDUSTRIAL  
REALTY TRUST

[www.firstindustrial.com](http://www.firstindustrial.com)